



1335 HOWE

REFINED RESIDENCES



ONNI.COM | 604.689.8535

Developer reserves the right to make modifications to building design, specifications, features, and materials without notice. All renderings and illustrations reflect the artist's interpretation of the project only and may not represent the actual project.



BC CONDOS.NET





IT'S NOT WHAT YOU
SAY ABOUT YOUR HOME.
IT'S WHAT YOUR HOME
SAYS ABOUT YOU.
ELEGANCE LEAVES
A LASTING IMPRESSION.



IT'S NOT WHAT YOU
SAY ABOUT YOUR HOME.
IT'S WHAT YOUR HOME
SAYS ABOUT YOU.
ELEGANCE LEAVES
A LASTING IMPRESSION.



DESIRED & DISTINCTIVE

Located in The Beach District, 1335 Howe offers sweeping and panoramic views of English Bay, False Creek, Vancouver's cityscape and the North Shore Mountains beyond.

S O P H I S T I C A T E D E L E G A N C E

Proudly introducing 1335 Howe by Onni. This modern and sophisticated 40-storey tower is designed by the award-winning IBI Group. A limited collection of refined residences, it's a destination nestled in Vancouver's distinctive Beach District.

With only four homes per floor, each provides between 1,090 – 1,720 square feet of space.

In addition, 1335 Howe offers the rare opportunity to combine and customize homes, for residences ranging from 2,355 – 6,055 square feet to reflect precisely how you want to live.

This new residential tower is an expression of a vision, capturing sweeping views of English Bay and the North Shore Mountains, False Creek and the dynamic cityscapes of Vancouver.



B C C O N D O S . N E T



THE BEACH DISTRICT

INCOMPARABLE ACCESS

Internationally acclaimed restaurants in Yaletown and Marinaside, beloved destinations on Granville Island, and cherished events such as the renowned Jazz Festival are all a short distance from home, as are the crafted, beachfront parks. The choices are as sought-after as the views. Walk, jog, cycle, shop and discover the inspiration of the neighbourhood, where cafes, stores and every imaginable amenity is within reach.

The Beach District appeals to local and global audiences, making it one of the world's most desired destinations. Welcome to a haven for those wishing to balance life with luxury.



With quick access to the bridges of downtown Vancouver and located just a few minutes from the Canada Line SkyTrain station, 1335 Howe is within easy reach of all that Vancouver has to offer.

Sea Wall

A 28-kilometre destination for morning walks, sunset strolls or simply taking in the views.

Granville Island Public Market

A treasure in the city and a beloved choice for shopping, eating, enjoying delectable, fresh baked goods or attending live theatre.

Yaletown

A cosmopolitan jewel of urban living filled with shops, spas and dining.

Robson Shopping District

Local and international stores, cafes and restaurants to discover.

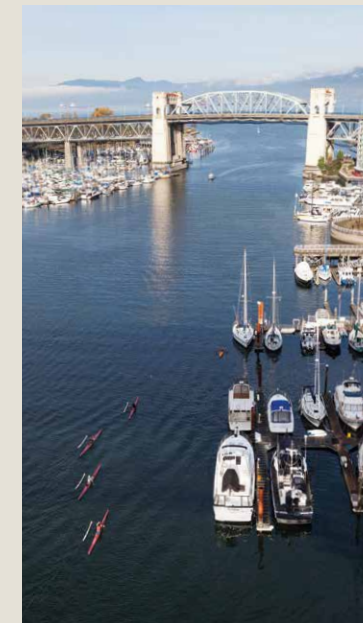

View from the 40th floor.



B C C O N D O S . N E T



- 1 Tartine Bread & Pies
- 2 Prego Caffè e Deli
- 3 Ten Ten Tapas
- 4 TAPshack Burrard Bridge
- 5 Giardino
- 6 Caffè Artigiano
- 7 La Pentola
- 8 Rodney's Oyster House
- 9 Ancora
- 10 Bin 941
- 11 The Sandbar
- 12 Dockside Restaurant
- 13 Edible Canada at the Market
- 14 The Vancouver Fish Company
- 15 Blue Water Café
- 16 Cioppino's Mediterranean Grill
- 17 Honjin Sushi
- 18 Starbucks

- 19 Granville Island Public Market
- 20 False Creek Yacht Club
- 21 Burrard Civic Marina
- 22 Quayside Marina
- 23 Roundhouse Community Arts Centre
- 24 Museum of Vancouver
- 25 Vancouver Maritime Museum
- 26 Vancouver Art Gallery
- 27 Queen Elizabeth Theatre
- 28 Orpheum Theatre
- 29 Canada Place
- 30 BC Place
- 31 Rogers Arena
- 32 Contemporary Art Gallery
- 33 Pacific Centre Shopping Mall

- 34 Shoppers Drug Mart
- 35 Choices Market
- 36 Urban Fare
- 37 Safeway
- 38 Nester's Market
- 39 CIBC
- 40 RBC
- 41 HSBC



CAPTIVATING & CONTEMPORARY



Experience the serenity
of timeless style in homes
that reflect the essence
of refinement.

INSPIRING INTERIORS

Step inside 1335 Howe and enter an enlightened reflection on contemporary living. Gracefully balanced interiors offer two options of warm and sophisticated colour schemes that enhance and harmonize the flow of spaces. The open concept kitchen, living and dining rooms allow natural light to flood the homes, with automated rolling blinds and lighting in the living areas to control the brightness. Expansive, private balconies offer seamless, indoor-outdoor living.

Enter the chef's kitchen and be surrounded by exclusive, integrated appliances from Sub-Zero, Wolf and ASKO. The Sub-Zero under-counter wood-paneled wine fridge holds 46 bottles, and offers two independent temperature zones

allowing both red and white wines to remain at the ideal serving temperatures. Elevated design elements extend throughout the heart of the home with a choice of marble or composite stone countertops with a breakfast bar overhang, overheight backsplash, spacious under-counter shelving, European-inspired custom flat-panel walnut veneer cabinets and under-cabinet lighting. Built-in speakers in the kitchen deliver precise sound control.

Spa-like master bathrooms have NuHeat floor heating systems, marble tile, KOHLER fixtures and floating wood cabinets. The oversized, frameless walk-in showers and deep soaker tubs are surrounded with polished marble tile deck.

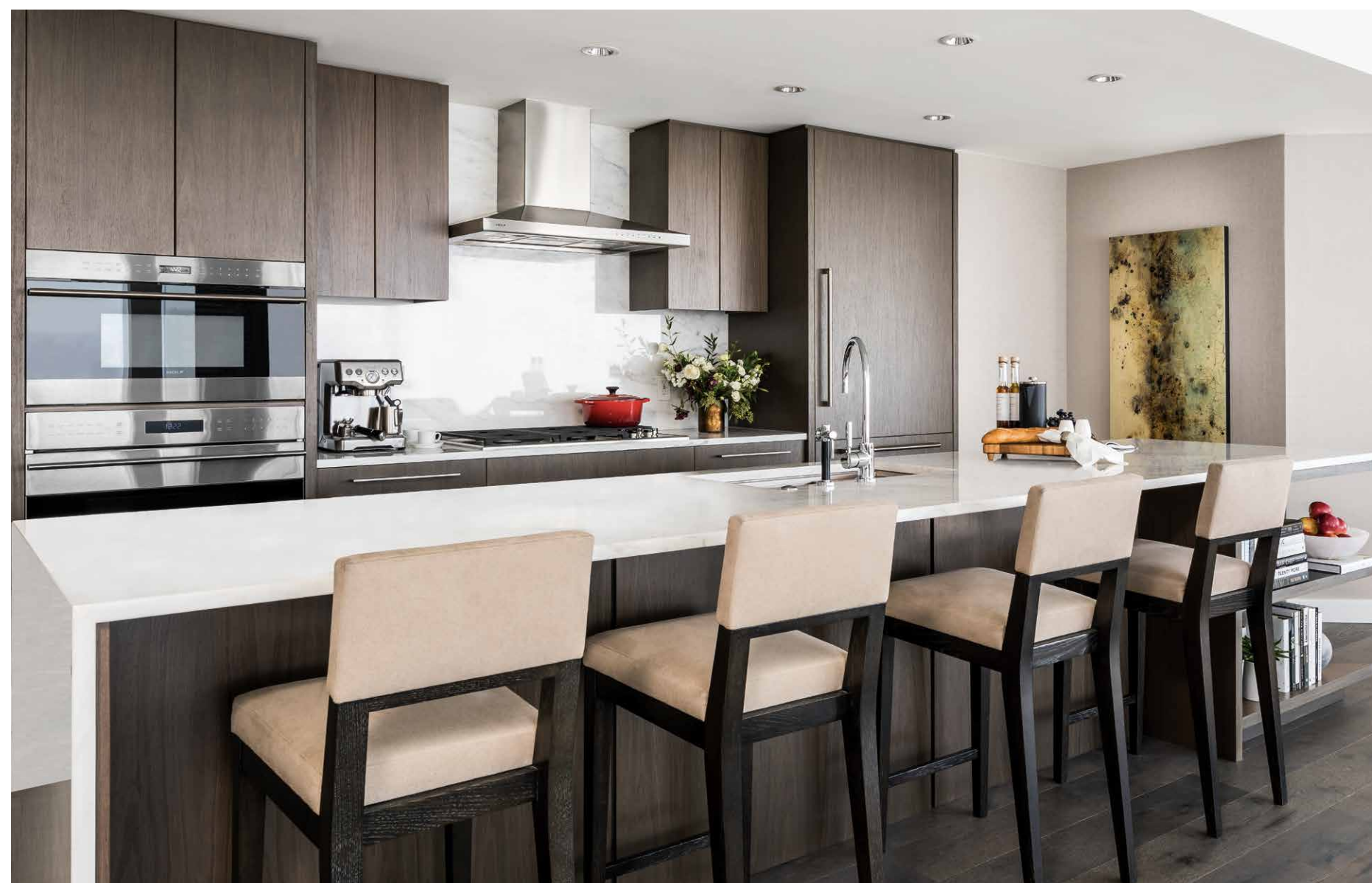

UNRIVALED & UNSURPASSED



The superlative features are meticulously designed to inspire health, wellness and relaxation.

EXCEPTIONAL AMENITIES

Come home to 1335 Howe and enter a crafted destination with extensive, contemporary features. A 24-hour private concierge is available to assist with residents' needs. Meeting rooms extend professional space outside the home. The 8th floor offers more than 8,000 square feet of indoor and outdoor amenities. A large, professionally equipped fitness centre is drenched in natural light.

The outdoor pool and hot tub with cabana style loungers on the pool deck bring resort

amenities home. A collection of beautifully articulated spaces allow for a roof terrace with barbecue area, and an outdoor children's play area. A lounge and party room complete the unparalleled amenities.

The convenient and thoughtfully designed private garages provide ample space for vehicles, as well as the added assurance that parking is always secure.



SELECTIVE & SPACIOUS

FUNCTIONAL FLOORPLANS

1335 Howe is designed to bring luxury to life. Each residence is a two or three bedroom home, ranging from 1,090 - 1,720 square feet. With only four homes per floor, each is a coveted corner space with oversized patios ideal for enjoying the remarkable views.

The expansive residences also provide the rare opportunity to combine homes. The flow and the functionality can extend across two or more homes, creating incomparable spaces ranging from 2,355 - 6,055 square feet, for truly individualized living.

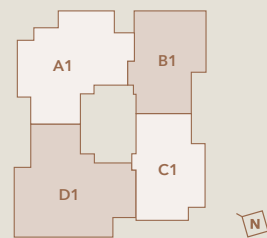

A1	1,610 SQFT	3BED
B1	1,090 SQFT	2BED
C1	1,265 SQFT	2BED
D1	1,720 SQFT	3BED

Each residence is a corner unit
The Beach District is renowned for its scenery, so every home at 1335 Howe offers corner views, to take full advantage of its spectacular location.

Homes that can be combined
The innovative design of 1335 Howe allows for consolidation of homes into expansive urban residences. By combining two or more homes, the captivating spaces flow from corner to corner.

Seamless indoor-outdoor living
Every residence has private, outdoor space, so the freshness and beauty of The Beach District is always within reach.

PLAN A 1

PLAN B 1



PLAN D 1

PLAN C 1



RENOWNED EXPERTISE



The Mark, Vancouver



The Charleson, Vancouver



Central, Vancouver



Oasis, Coquitlam



The Shaughnessy, Port Coquitlam

THE ONNI GROUP

The Onni Group is one of North America's leading private real estate developers, with extensive experience designing, developing, building and managing innovative projects. As a fully integrated company that directly oversees every step in the development process, Onni has built over 10,000 homes. In addition, the company owns and manages more than 7 million square feet of commercial property, more than 5,500 rental apartment units, and has an additional 10 million square feet in various stages of development.

With offices in Vancouver, Toronto, Chicago, Los Angeles, Phoenix and Mexico, Onni continues to expand and diversify into new markets throughout North America.

Each home at 1335 Howe is backed by a comprehensive 2-5-10 year National Home Warranty that provides 2 full years in-home coverage for workmanship and materials, 5-year water penetration coverage and 10-year structural coverage for added peace of mind.

A Limited Collection of
120 Refined Residences Nestled in
The Heart of Downtown Vancouver's
Enviably Beach District.



BC CONDOS . NET

