

STRATA PLAN OF LOT 9,
D. L. 3866, GP. I, N.W.D.,
PLAN 21578.

STRATA PLAN VR 2266

DEPOSITED AND REGISTERED IN
THE LAND TITLE OFFICE AT
VANCOUVER, B.C.
THIS 7TH DAY OF OCTOBER 1988.

SCALE, 1:750

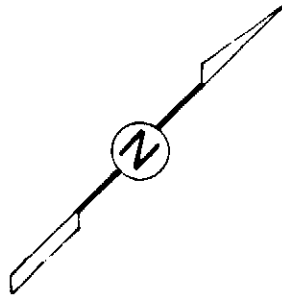
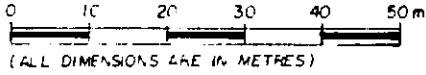

REGISTRAR

"Glacier Lodge"

WHISTLER, B.C.

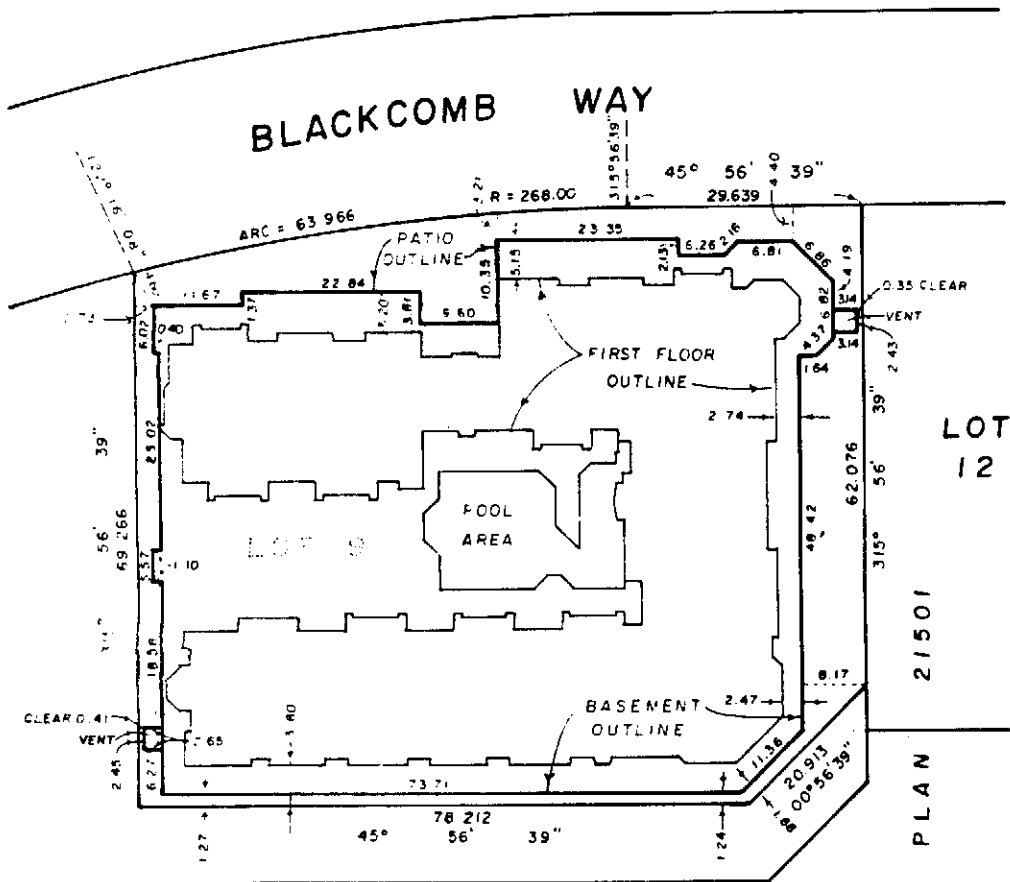

LOT 7

THIS STRATA PLAN CONTAINS LIMITED COMMON
PROPERTY ACCORDING TO SEC. 53(2) OF THE
CONDOMINIUM ACT.

LEGEND

- m² DENOTES SQUARE METRES
- S.L. DENOTES STRATA LOT
- PT. S.L. DENOTES PART OF STRATA LOT
- (C) DENOTES COMMON PROPERTY
- (E-25) DENOTES BALCONY BEING LIMITED COMMON PROPERTY
FOR THE EXCLUSIVE USE OF S.L. 25
- (P-1) DENOTES PATIO BEING LIMITED COMMON PROPERTY
FOR THE EXCLUSIVE USE OF S.L. 1
- (LCP) DENOTES LIMITED COMMON PROPERTY FOR S.L. 103
- (LCP) DENOTES LIMITED COMMON PROPERTY FOR S.L.'S 1 TO 99 AND 103'
- LCP DENOTES LIMITED COMMON PROPERTY FOR S.L.'S 1 TO 99
- (OP) DENOTES OPEN TO STRATA LOT BELOW

I, J.J. WARD OF LANGLEY A
BRITISH COLUMBIA LAND SURVEYOR, HEREBY
CERTIFY THAT THE BUILDING ERECTED
ON THE PARCEL DESCRIBED ABOVE IS
WHOLLY WITHIN THE EXTERNAL BOUNDARIES
OF THAT PARCEL.
DATED AT SURREY, B.C.
THIS 27TH DAY OF SEPTEMBER, 1988.

J.J. Ward B.C.L.S.

THE ADDRESS FOR SERVICE OF DOCUMENTS
ON THE STRATA CORPORATION IS :

THE OWNERS, STRATA PLAN VR
SUITE 201, 3701 EAST HASTINGS STREET
BURNABY, B.C. V5C 2H6

THIS PLAN LIES WITHIN THE SQUAMISH-LILLOOET REGIONAL DISTRICT.

McELHANNEY ASSOCIATES
PROFESSIONAL LAND SURVEYORS
13160 - 88th AVENUE
SURREY, B.C. V3W 3K3
FILE 502 00830-3

STRATA PLAN

CONDOMINIUM ACT

LOT NO.	SHEET NO.	FORM 1	FORM 2	FORM 3
		SCHEDULE OF UNIT ENTITLEMENT	SCHEDULE OF INTEREST UPON DESTRUCTION	SCHEDULE OF VOTING RIGHTS
		UNIT ENTITLEMENT	INTEREST UPON DESTRUCTION	NUMBER OF VOTES
1	5, 10	624 ✓	13,875	1
2	"	576	12,525	1
3	"	566 ✓	12,525	1
4	"	566 ✓	12,525	1
5	"	599	12,525	1
6	5, 10	432 ✓	9,050	1
7	6, 11	577	11,600	1
8	"	620	13,500	1
9	"	625 ✓	13,675	1
10	"	774	16,800	1
11	"	575	12,525	1
12	"	575	12,525	1
13	"	702	15,175	1
14	"	888	19,975	1
15	"	671	15,375	1
16	"	671	15,375	1
17	"	701 ✓	15,700	1
18	"	699 ✓	15,700	1
19	6, 11	670 ✓	15,375	1
20	6, 7, 11	670 ✓	15,375	1
21	6, 11	720	16,400	1
22	6, 7, 11	719	16,100	1
23	5, 12	982 ✓	22,425	1
24	"	926	20,650	1
25	"	924	20,650	1
26	"	924	20,650	1
27	5, 12	922 ✓	20,650	1
28	5, 7, 12	760	16,550	1
29	5, 12	735	16,300	1
30	5, 7, 12	954	20,400	1
31	7, 12	754	16,525	1
32	7, 12	686 ✓	14,575	1
33	6, 7, 13	691 ✓	14,600	1
34	7, 13	701	15,450	1
35	6, 7, 13, 15	882 ✓	20,650	1
36	6, 13	720	15,850	1
37	6, 7, 13	693	15,500	1
38	6, 13	693	15,500	1
39	"	724	15,775	1
40	"	701 ✓	15,750	1
41	"	693	15,500	1
42	"	693	15,500	1
43	"	887	20,475	1
44	"	712	16,250	1
45	"	575	12,200	1
46	"	575	12,200	1
47	"	806	17,175	1
48	"	625 ✓	13,350	1
49	"	620	13,175	1
50	6, 13	577	12,200	1
51	6, 7, 13	811	15,950	1
52	7, 12	724 ✓	16,725	1

STRATA PLAN

CONDOMINIUM ACT

LOT NO.	SHEET NO.	FORM 1	FORM 2	FORM 3
		SCHEDULE OF UNIT ENTITLEMENT	SCHEDULE OF INTEREST UPON DESTRUCTION	SCHEDULE OF VOTING RIGHTS
		UNIT ENTITLEMENT	INTEREST UPON DESTRUCTION	NUMBER OF VOTES
53	5, 7, 12	722 ✓	14,775	1
54	5, 12	599	12,200	1
55	"	576	12,200	1
56	"	576	12,200	1
57	"	576	12,200	1
58	"	559	11,825	1
59	"	469 ✓	10,050	1
60	5, 12	1238 ✓ VP 20 th	22,675	1
61	5, 14, 16	805 ✓	18,800	1
62	"	1074	23,650	1
63	"	1069	23,650	1
64	"	1070	23,650	1
65	5, 14, 16	1068	23,650	1
66	5, 7, 14, 16	859	18,475	1
67	5, 14, 16	854	19,325	1
68	5, 7, 14, 16	1123	25,525	1
69	7, 14, 16	849	18,475	1
70	7, 14, 16	769 ✓	16,675	1
71	7, 15, 17	777 ✓	16,800	1
72	6, 7, 15, 17	772 ✓	16,600	1
73	7, 15, 17	842 ✓	18,550	1
74	6, 15, 17	845 ✓	18,950	1
75	6, 7, 15, 17	773	16,750	1
76	6, 15, 17	775	16,750	1
77	"	899	20,100	1
78	"	907	20,175	1
79	"	757 ✓	16,775	1
80	"	757 ✓	16,775	1
81	"	827	18,600	1
82	"	793 ✓	18,600	1
83	"	739 ✓	16,625	1
84	"	741 ✓	16,625	1
85	6, 15, 17	938 ✓	20,900	1
86	6, 15	625 ✓	14,025	1
87	6, 15, 17	788	17,750	1
88	6, 15, 17	746 ✓	16,625	1
89	6, 7, 15	811	15,675	1
90	7, 15, 17	766 ✓	16,875	1
91	7, 14, 16	894 ✓	20,225	1
92	5, 7, 14, 16	845 ✓	17,925	1
93	5, 14, 16	795	16,625	1
94	"	759	16,625	1
95	"	759	16,625	1
96	"	760	16,625	1
97	"	742	16,200	1
98	5, 14, 16	644	13,550	1
99	5, 14, 16	901	21,200	1
100	5, 6, 7, 8	4,487 ✓	105,000	6
101	5, 10	5,668 ✓	110,556	8
102	5, 7, 10	1,579	27,990	2
103	6, 7, 9, 10, 11	3,267	60,462	4
AGGREGATE		89,723	1,943,483	119

113

STRATA PLAN -----

I, J. J. WARD A BRITISH COLUMBIA LAND SURVEYOR
HEREBY CERTIFY THAT THE BUILDING SHOWN ON THIS
STRATA PLAN HAS NOT AS OF THE 27th DAY OF
SEPTEMBER, 1988, BEEN PREVIOUSLY OCCUPIED.
DATED AT SURREY, B.C. THIS 27th DAY OF SEPTEMBER, 1988.

J. J. Ward B.C.L.S.

ACCEPTED AS TO FORMS 1, 2 AND 3

for Mary R. Revie
SUPERINTENDENT OF INSURANCE REAL ESTATE
THIS 6th DAY OF OCTOBER 1988.

OWNER - DEVELOPER :

BOSA DEVELOPMENT CORPORATION
INCORPORATION N° 337862

[Signature]
AUTHORIZED SIGNATORY

AUTHORIZED SIGNATORY

MORTGAGEE :

NATIONAL TRUST COMPANY

[Signature]
AUTHORIZED ~~VICE-PRESIDENT~~
BRITISH COLUMBIA REGION

[Signature]
EXAMINED FOR ENR...
AUTHORIZED ~~VICE-PRESIDENT~~
VICE-PRESIDENT
BRITISH COLUMBIA REGION

STRATA PLAN

SECTIONS

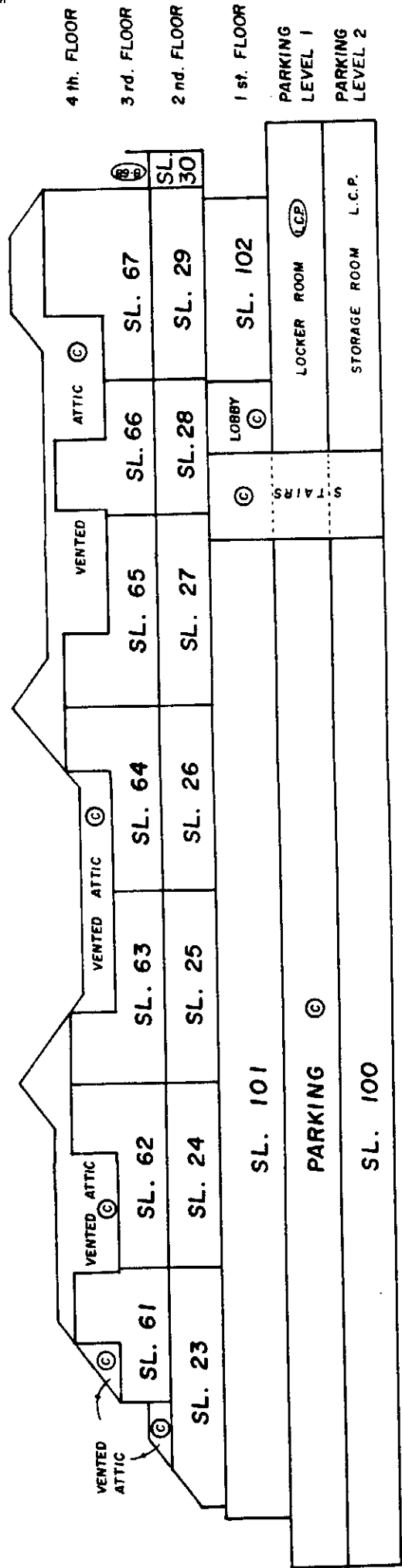
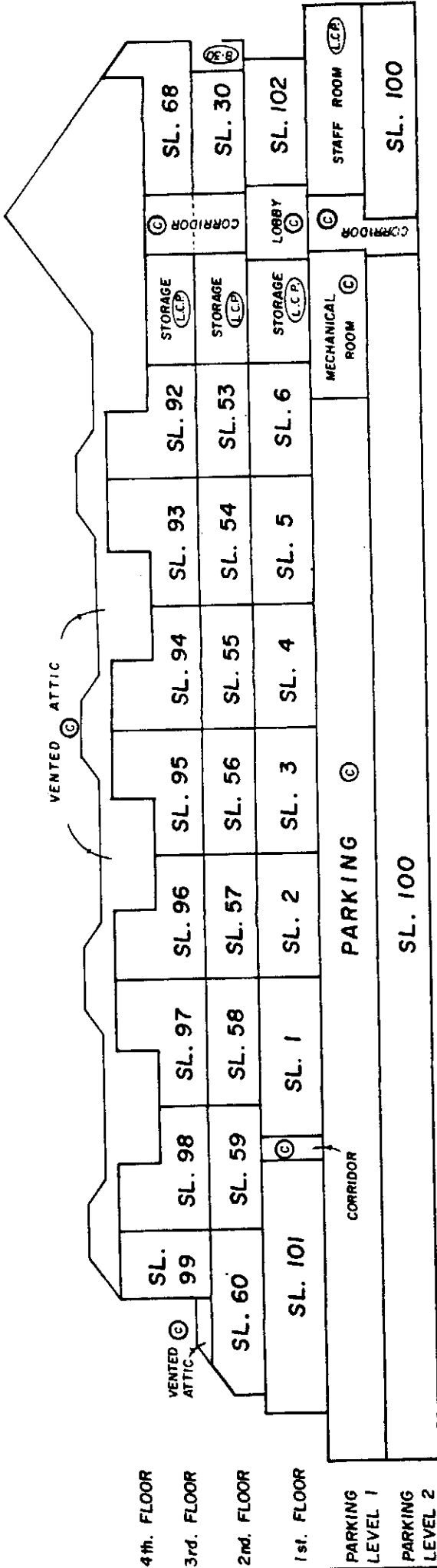
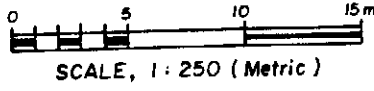

HAIDA - 13757

88 - 09 - 27
FILE 502 00830-3

J. V.

STRATA PLAN

SECTIONS

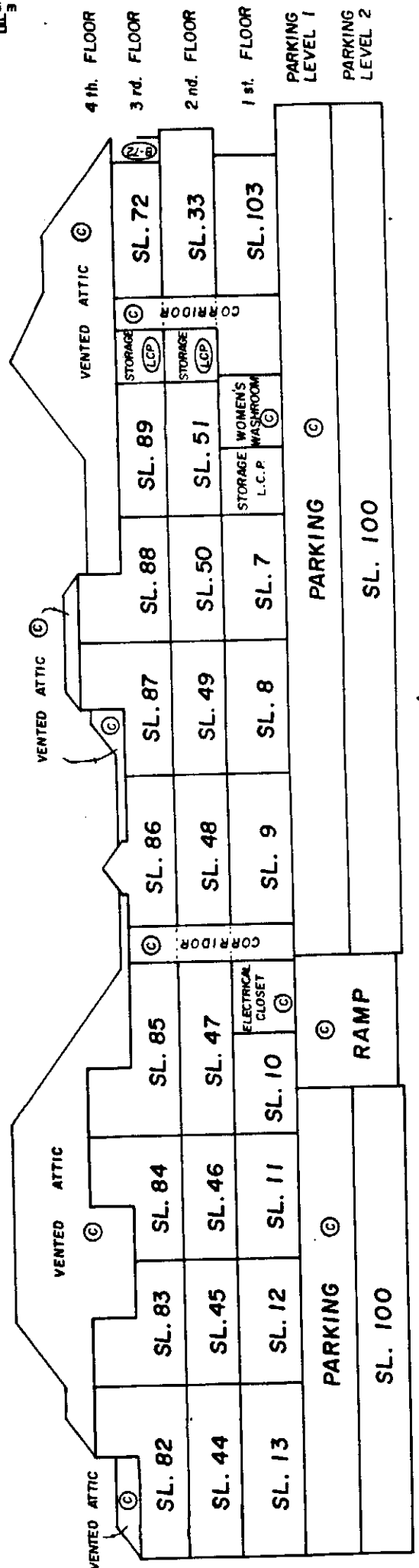
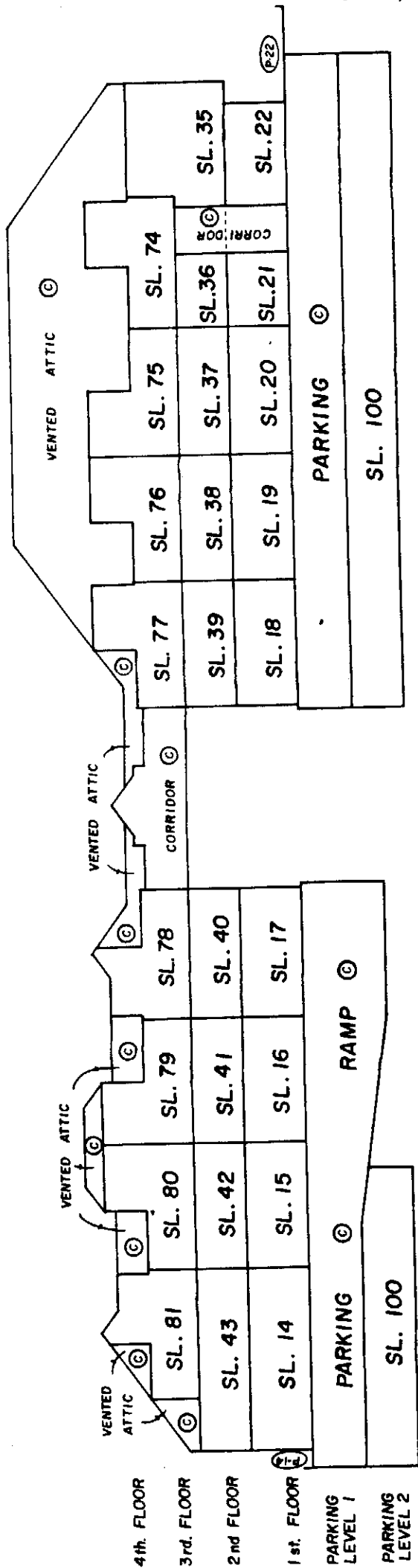
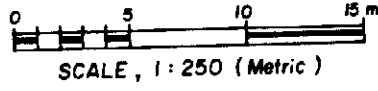

STRATA PLAN

SECTIONS

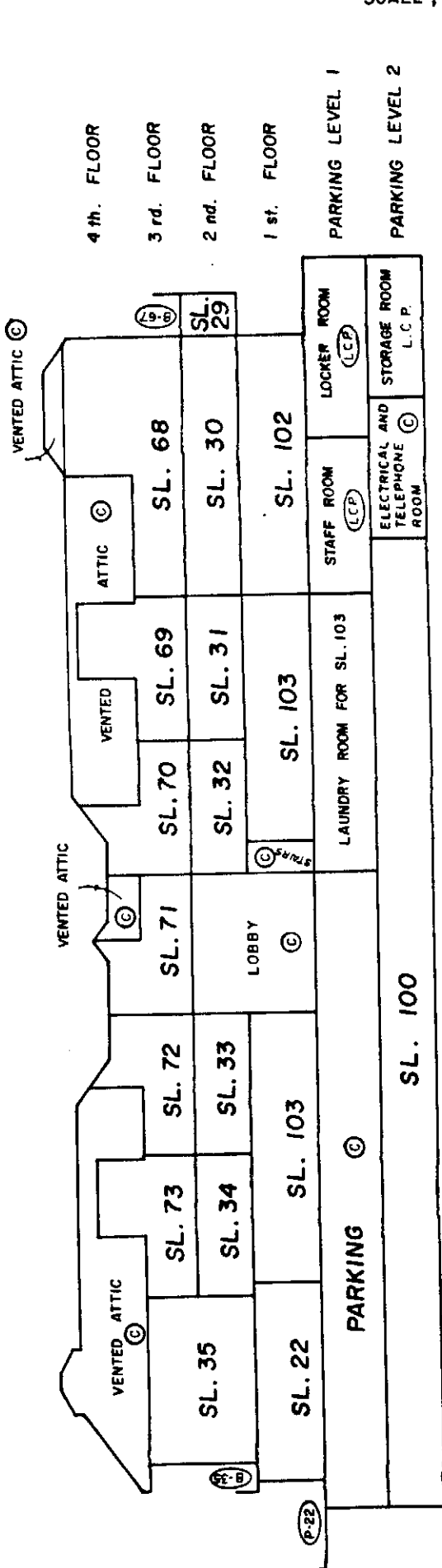
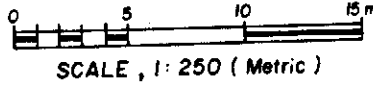

SECTION F-F'

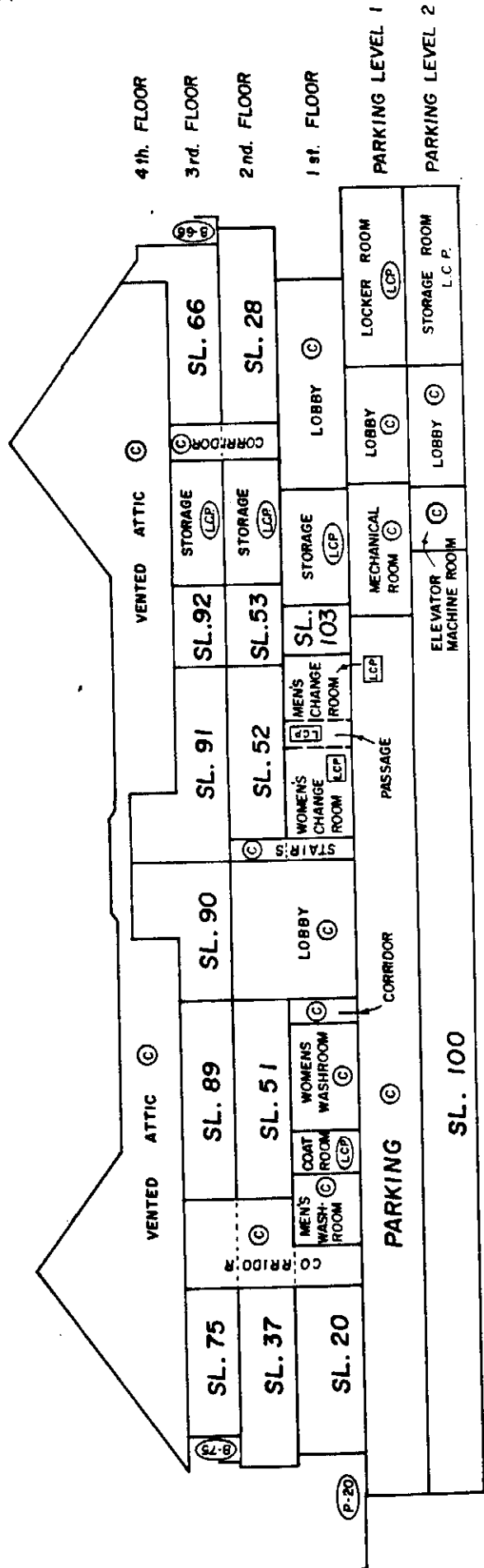

SECTION E-E'

STRATA PLAN

PARKING LEVEL 2

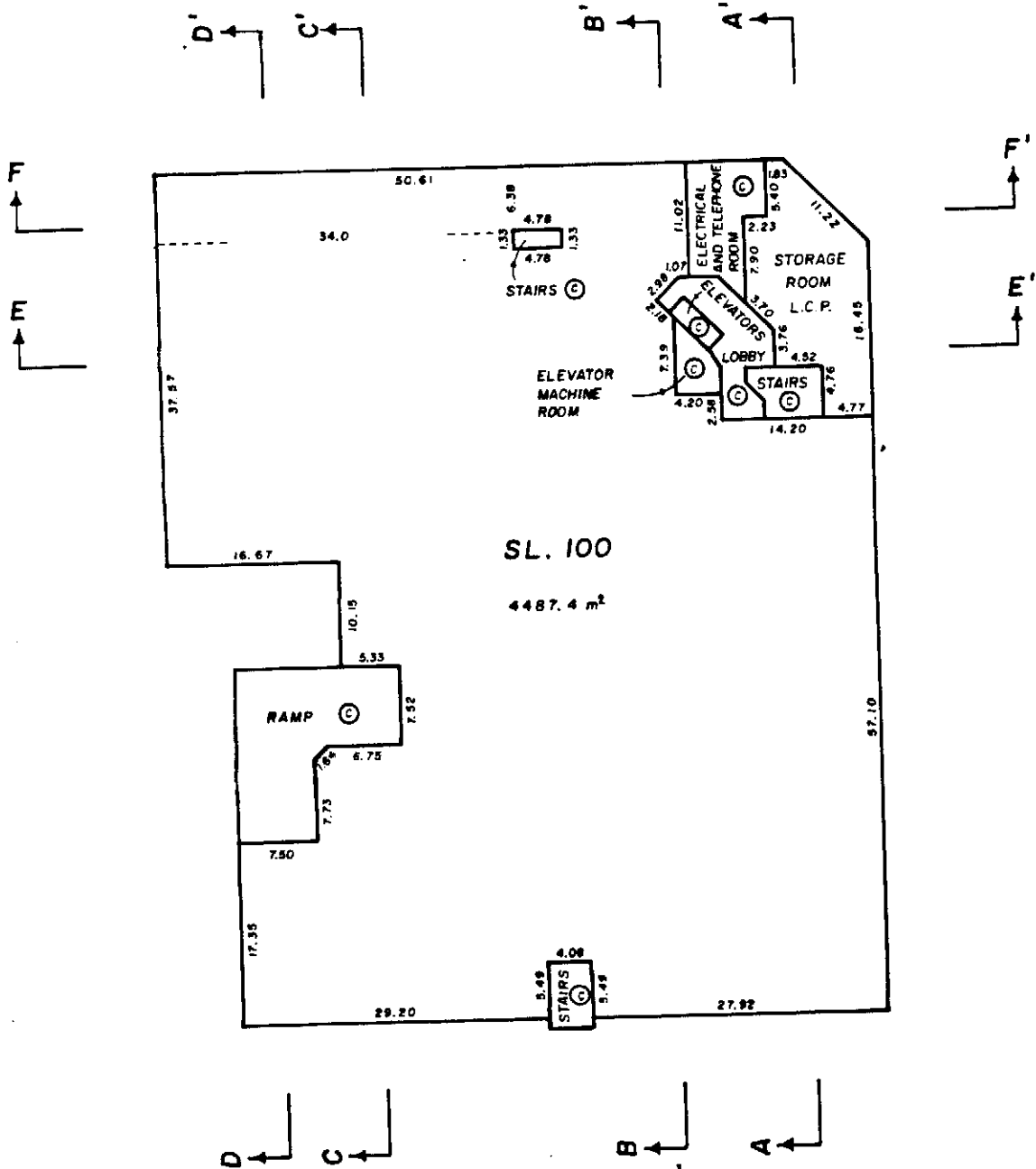
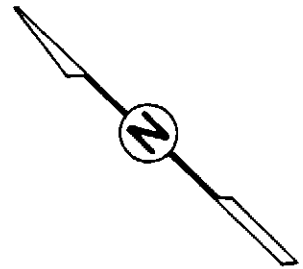
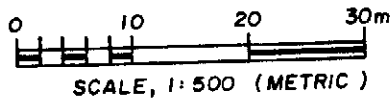

STRATA PLAN

PARKING LEVEL I

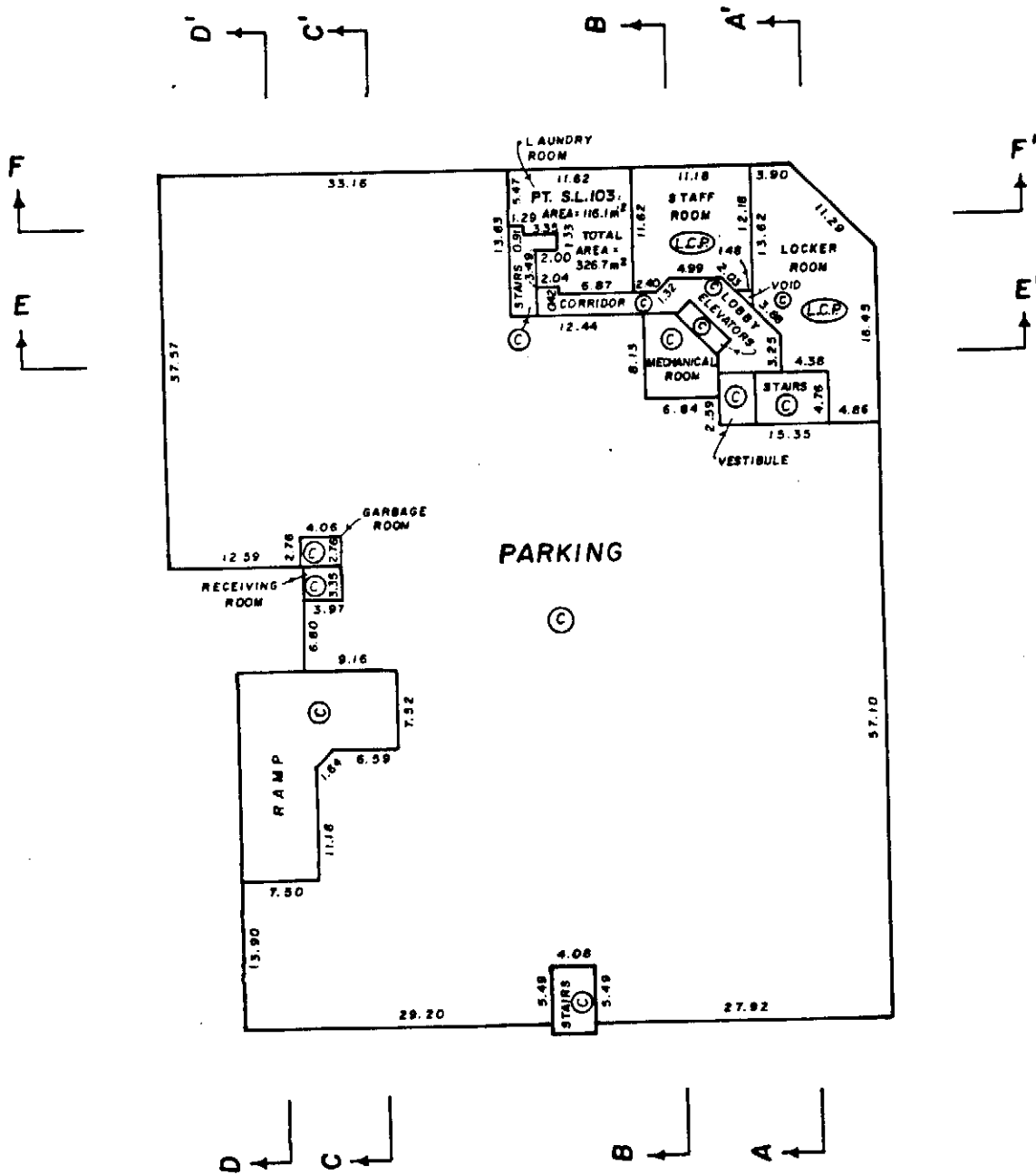
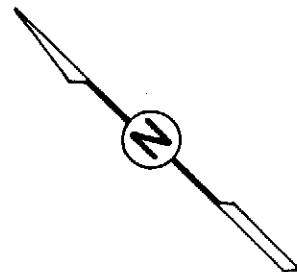
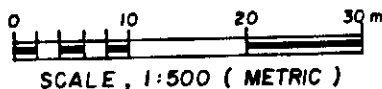

STRATA PLAN FIRST FLOOR "SOUTH HALF"

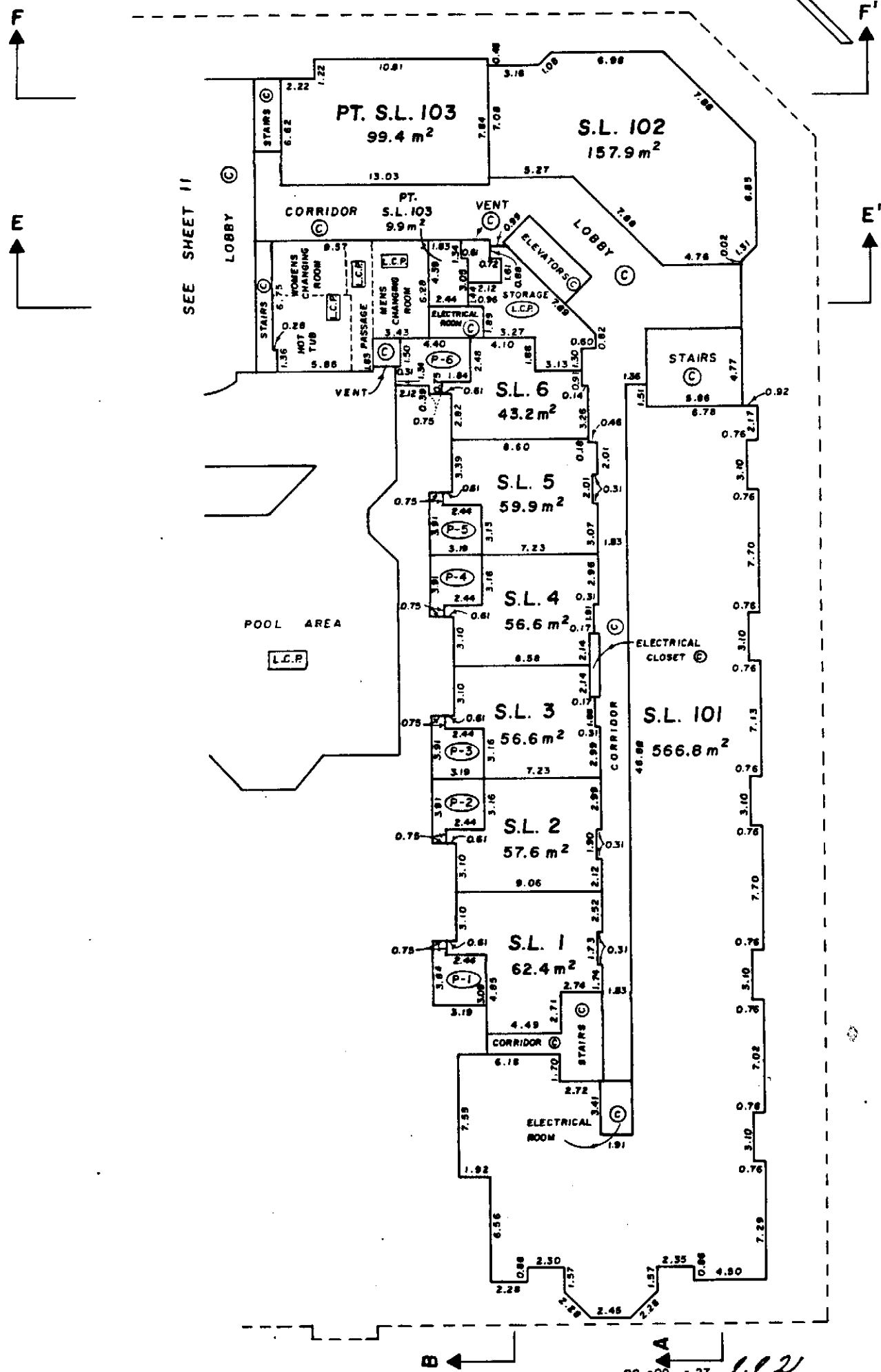
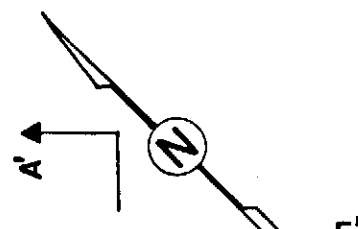
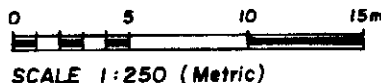

88-09-27 *J.P.V.*
FILE 502 Q0830-3

STRATA PLAN FIRST FLOOR "NORTH HALF"

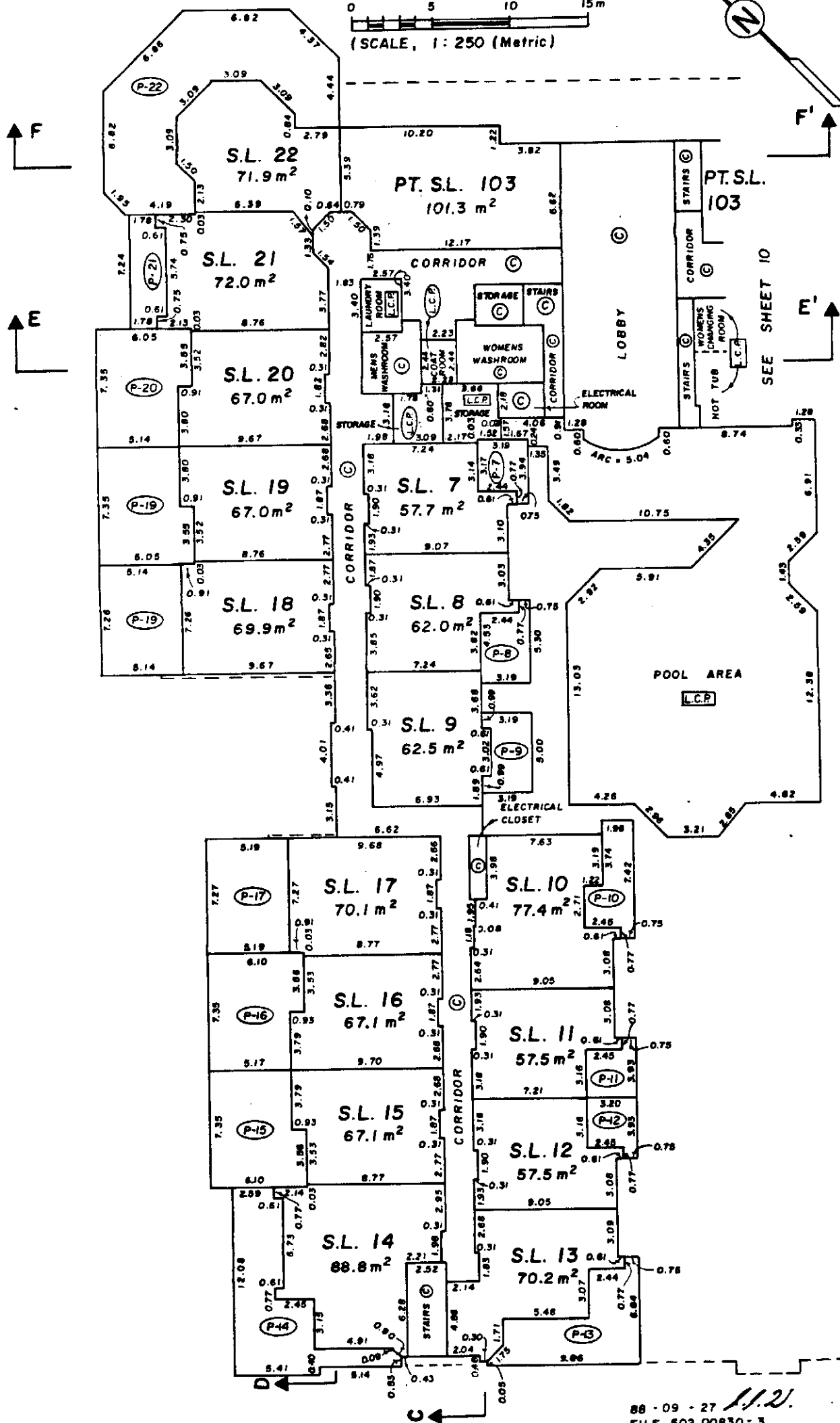
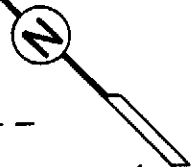
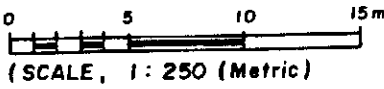

88-09-27 *112*
FILE 502 00830-3

STRATA PLAN
SECOND FLOOR
"SOUTH HALF"

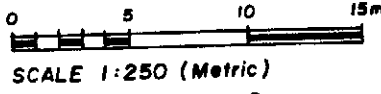

SEE SHEET 13
OPEN TO FLOOR BELOW

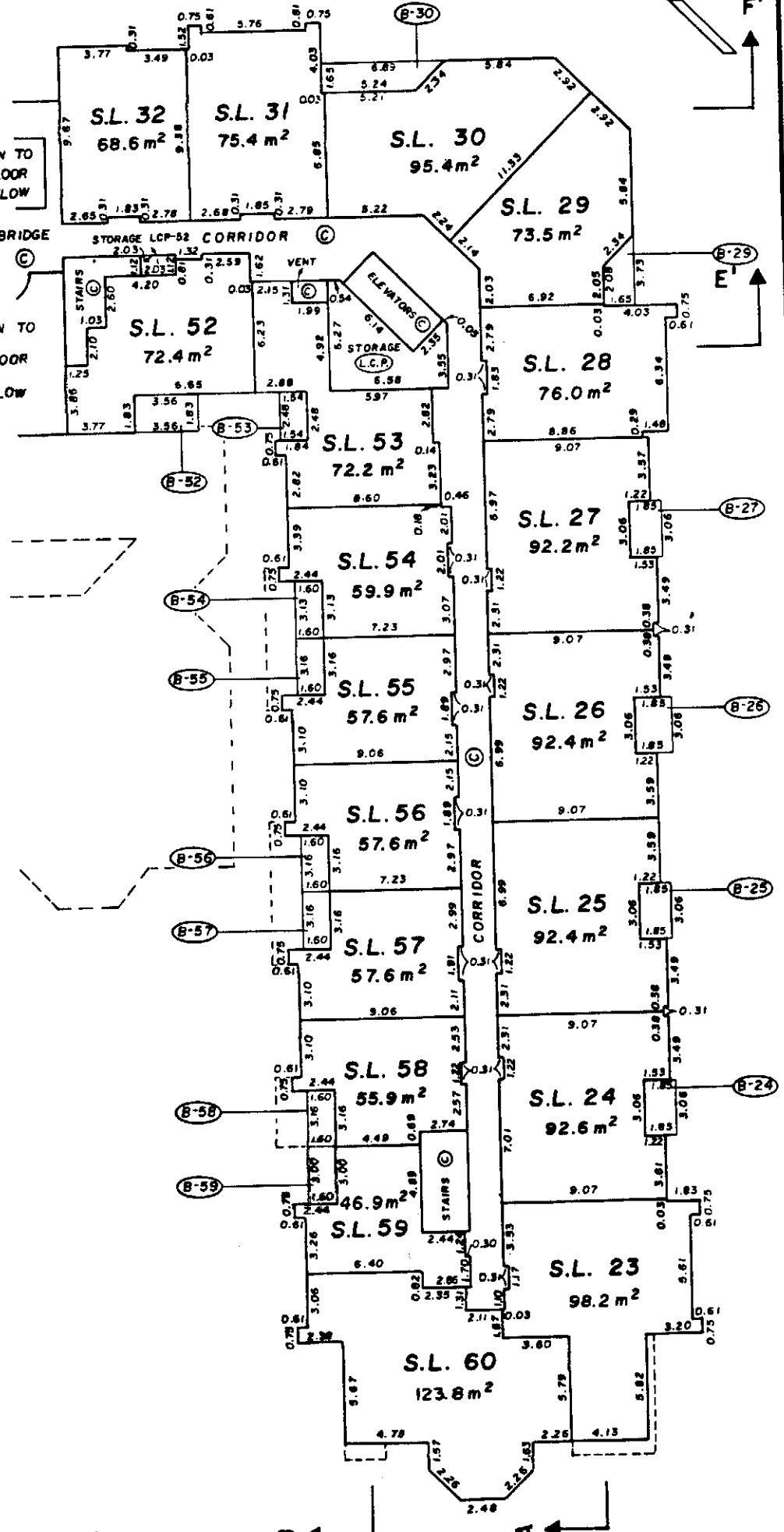

88-09-27 11.2
FILE 502 00830-3

STRATA PLAN SECOND FLOOR "NORTH HALF"

0 5 10 15 m
SCALE, 1 : 250 (Metric)

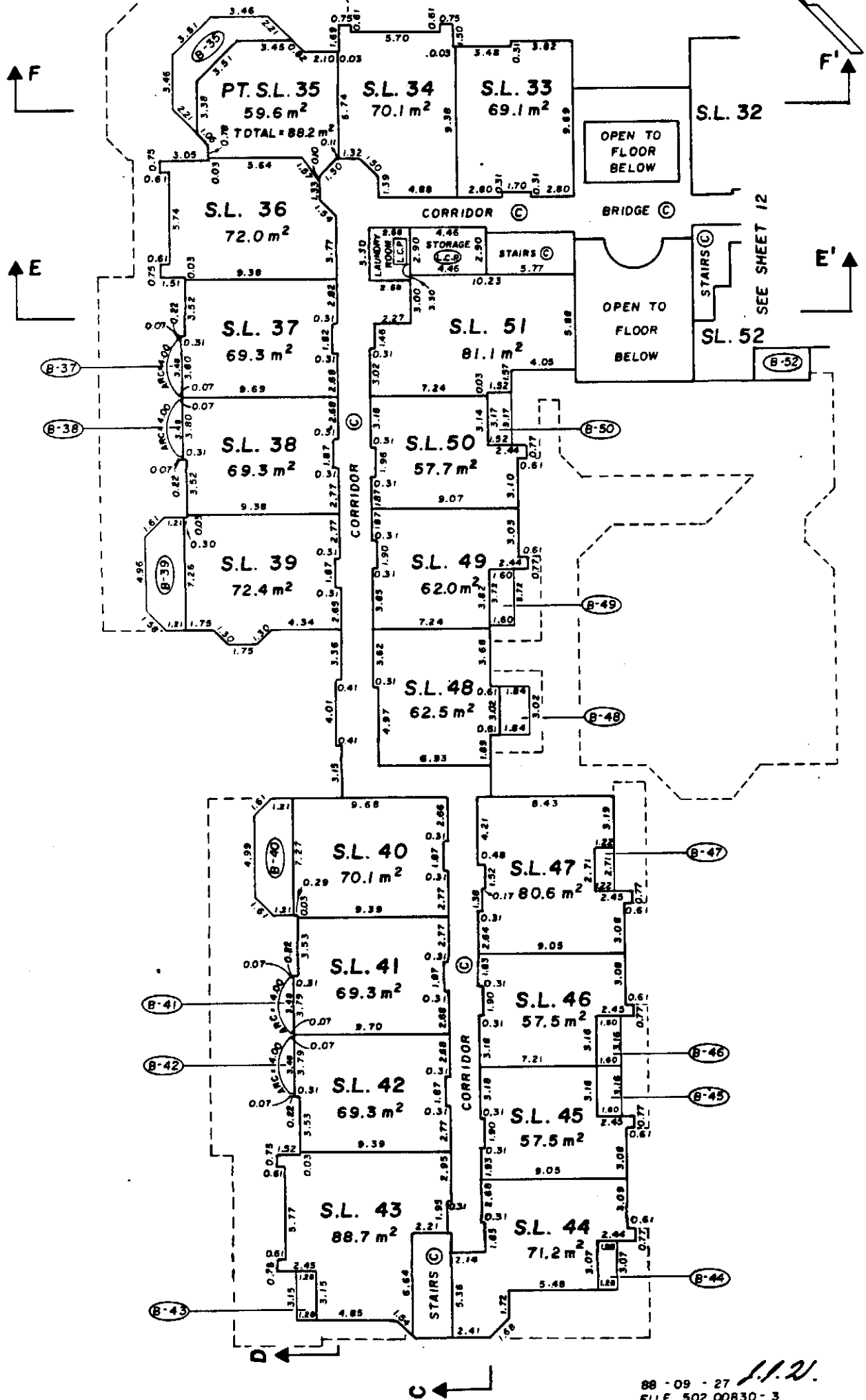

STRATA PLAN
THIRD FLOOR
 "SOUTH HALF"

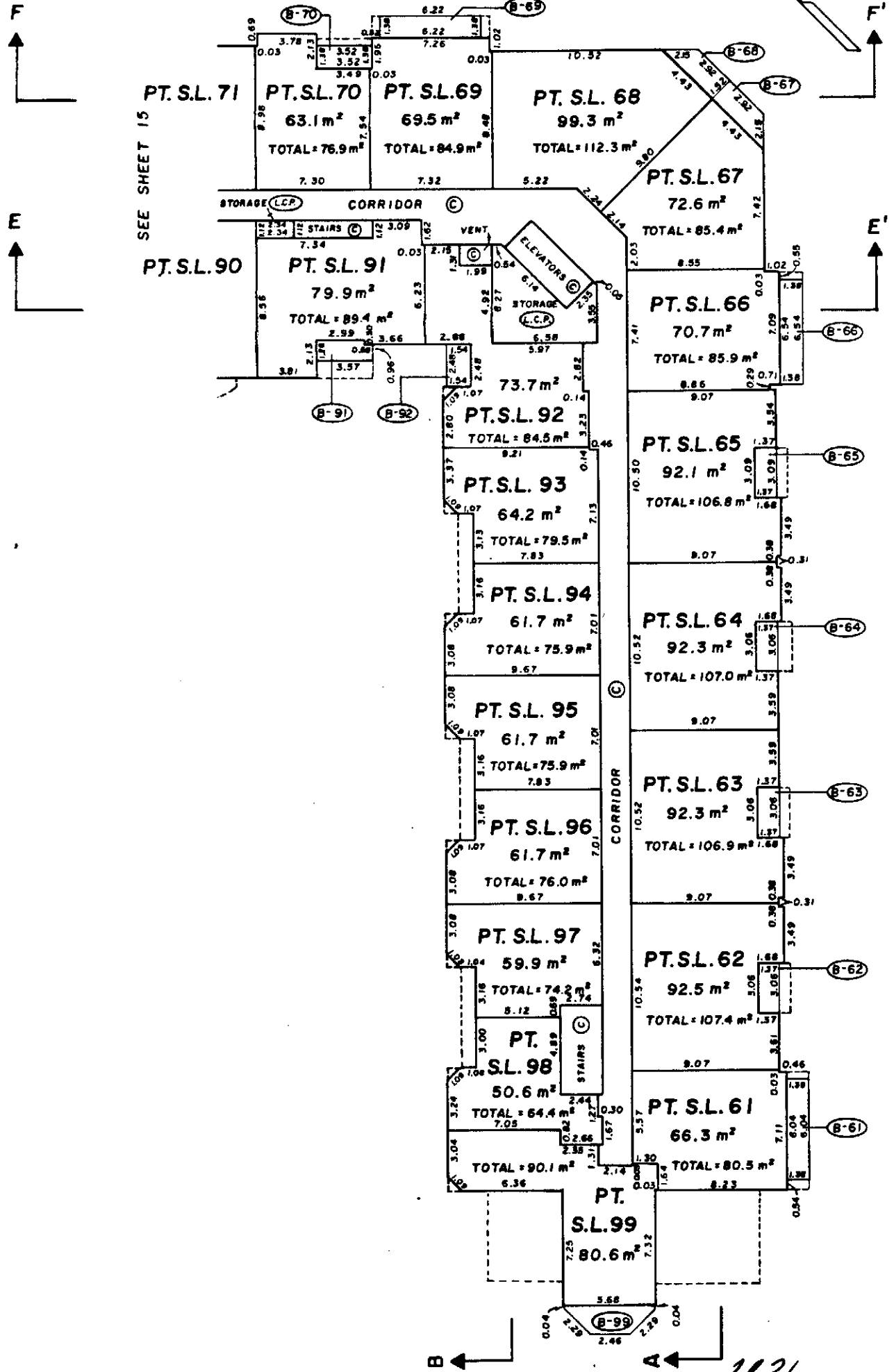
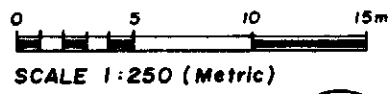

88 - 09 - 27 11.2
 FILE 502 00830 - 3

STRATA PLAN
THIRD FLOOR
 "NORTH HALF"

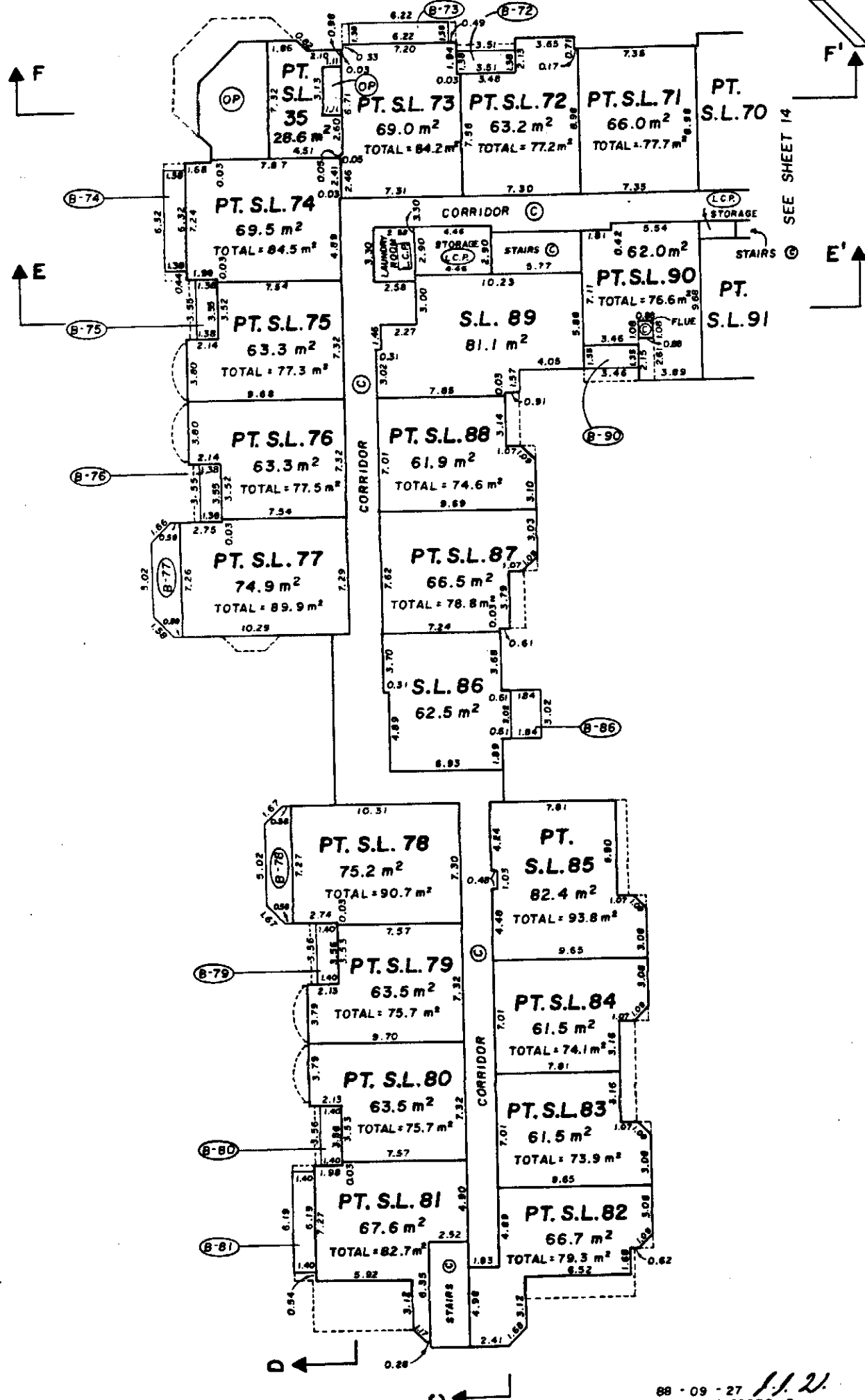
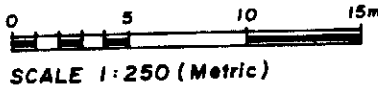

SEE SHEET 14

STRATA PLAN FOURTH FLOOR "SOUTH HALF"

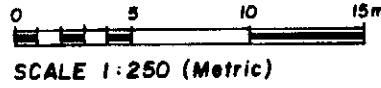

F ↑
E ↑

SEE SHEET 17

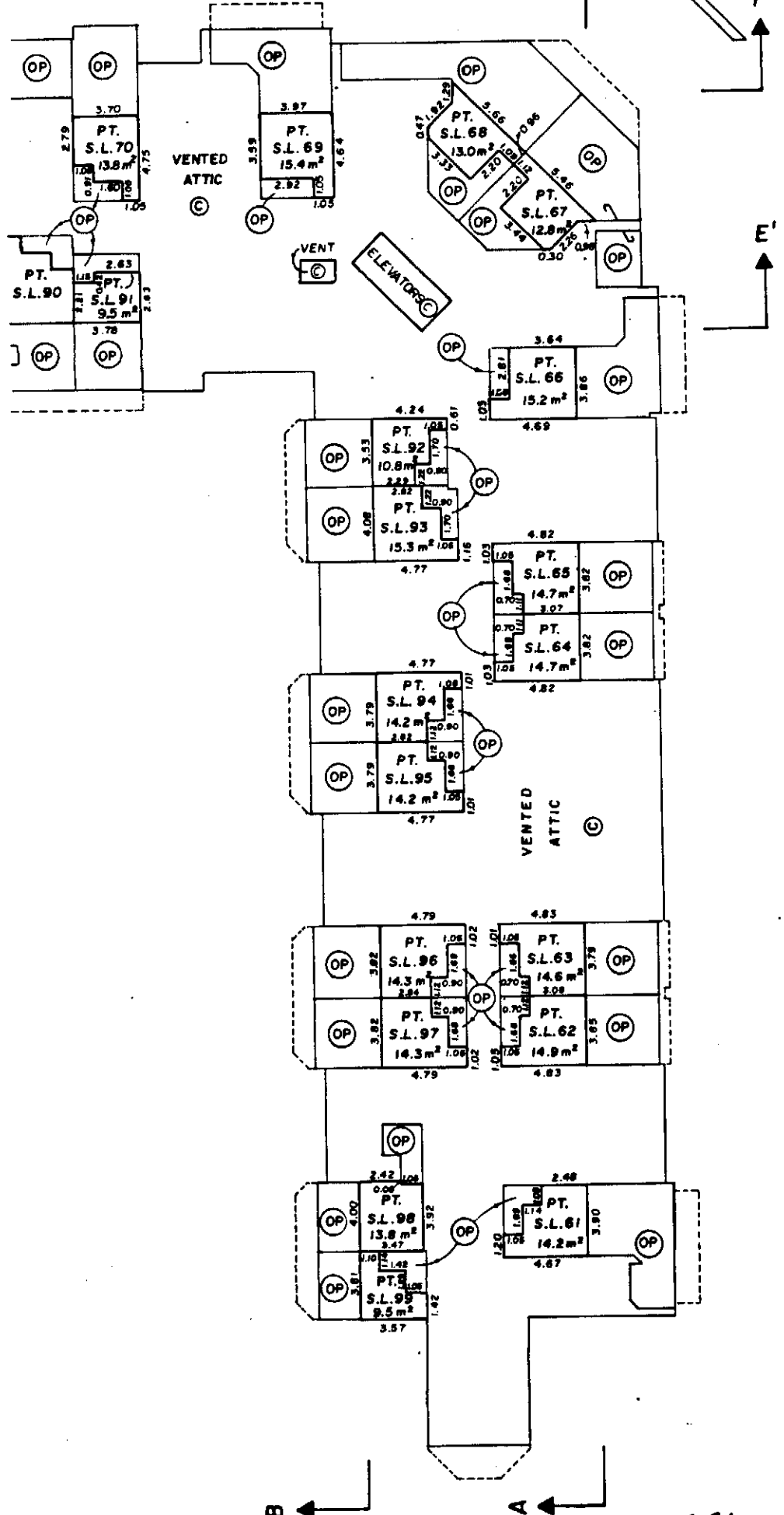

88-09-27 P.A.U.
FILE 502 00830-3

STRATA PLAN
FOURTH FLOOR
 "NORTH HALF"

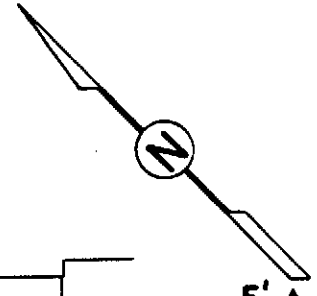
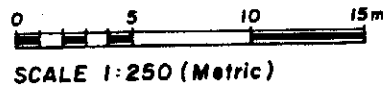

F

E

F'

E'

SEE SHEET 16

