

**SCHEDULE "A"**

**PROPOSED PHASE I:  
STRATA PLAN OF**

First Sheet - Sheet 1 of 21 Sheets

**LOT 13, D.L.'s 4213 And  
3903, Plan 21573**

Strata Plan ..... deposited and  
registered in the Land Title Office at  
B.C. this ..... day of  
..... 198

**Resort Municipality of Whistler**

**SCALE 1:1250 m**

\_\_\_\_\_  
Registrar

The Address for the Service of Documents  
on the 'Strata Corporation' is:  
The Owners' Strata Plan No. V.R. ....

Civic Address is:-  
4705 Glacier Drive,  
Whistler, B.C.  
VONIBO.

No. FELLER DRYSDALE,  
220-1024 Ridgeway Avenue,  
Coquitlam, B.C.  
V3J1S5

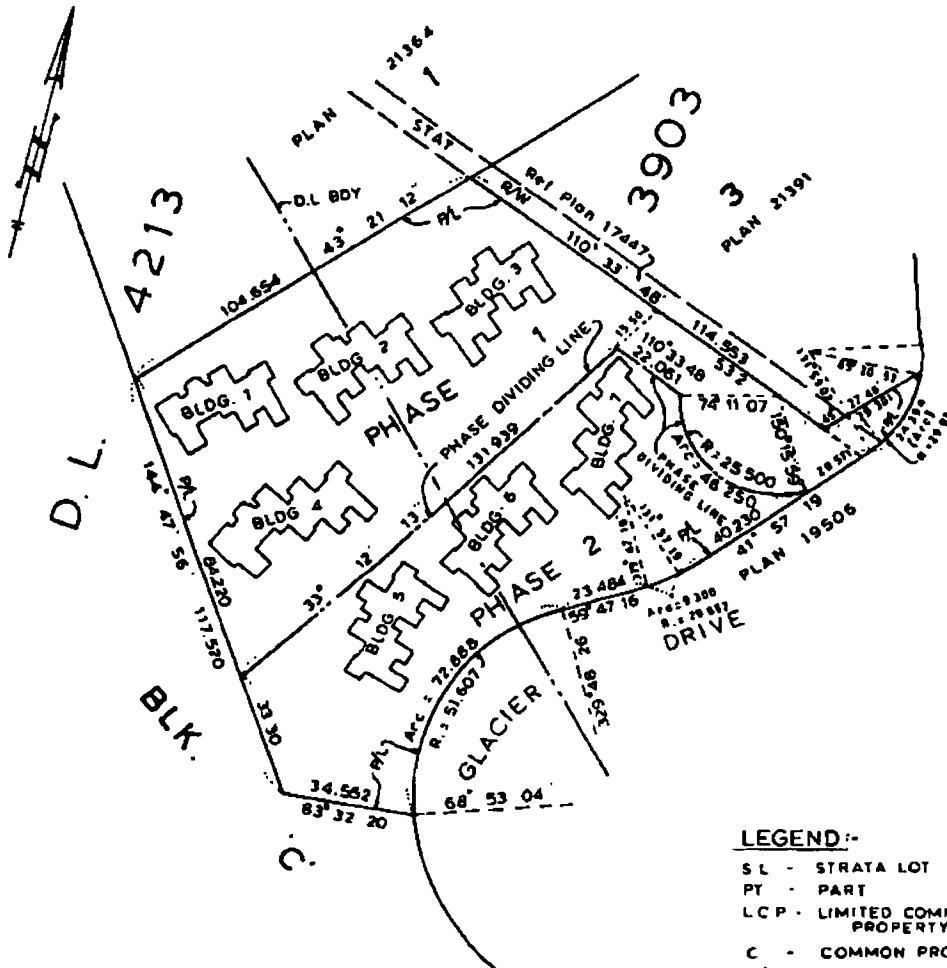

**LEGEND:-**

- SL - STRATA LOT
- PT - PART
- LCP - LIMITED COMMON PROPERTY
- C - COMMON PROPERTY
- m<sup>2</sup> - SQUARE METRES
- PL - PROPERTY LINE

BEARINGS ARE ASTRONOMIC AND DERIVED FROM PLAN 21573

THIS PLAN LIES WITHIN THE  
SQUAMISH-LILLOOET REGIONAL DISTRICT

I, \_\_\_\_\_ of Vancouver, B.C.,  
British Columbia Land Surveyor,  
hereby certify that the building  
erected on the parcel described above  
is wholly within the external boundaries  
of that parcel. Dated at Vancouver on  
this \_\_\_\_\_ day of \_\_\_\_\_, 198

**HERMON BUNBURY & OKE,**  
**PROFESSIONAL LAND SURVEYORS,**  
VANCOUVER & WHISTLER, B.C.

## CONDOMINIUM ACT.

LOT NO	SHEET NO	FORM 1 Schedule Of Unit Entitlement	FORM 2 Schedule Of Interest Upon Destruction	FORM 3 Schedule Of Voting Rights
16	3,4,5,12,13	62	230	
17	3,4,5,12,13	62	230	
18	3,4,5,12,13	62	230	
19	3,4,5,12,13	62	230	
20	6,7,8,12,13	62	230	
21	6,7,8,12,13	62	230	
22	6,7,8,12,13	62	230	
23	6,7,8,12,13	62	230	
24	9,10,11,12,13	62	230	
25	9,10,11,12,13	62	230	
26	9,10,11,12,13	62	230	
27	9,10,11,12,13	62	230	
<b>Aggregate</b>		<b>744</b>	<b>2760</b>	<b>12</b>

CERTIFICATE OF APPROVAL—B.C. Reg 74/78

Approved as Phase 2 of a 2 Phase Strata Plan under the Condominium Act.  
 Dated this \_\_\_\_\_ day of \_\_\_\_\_, 1988

Accepted as to Forms 1, 2 and 3  
on the \_\_\_\_\_ day of \_\_\_\_\_, 1988

\_\_\_\_\_  
 Municipal Approving Officer for the Resort Municipality of Whistler.

\_\_\_\_\_  
Superintendent of Real Estate

STATUTORY DECLARATION:

I/WE, the undersigned, do solemnly declare that:

- 1 I/WE (am/are) the Owner-Developer or the duly authorized Agent of the Owner-Developer
- 2 The Strata Plan is entirely for residential use
- 3 I/WE make this solemn declaration conscientiously believing it to be true and knowing that it is of the same force and effect as if made under Oath

- CERTIFICATE UNDER SECTION 8(1)

I, G.A. McDougall, British Columbia Land Surveyor, hereby certify that the building shown in this Strata Plan has not, as of the 3rd day of October, 1988 been previously occupied.  
 Dated at Vancouver, British Columbia, this 3rd day of October, 1988

Declared before me at Vancouver in the Province of British Columbia, this \_\_\_\_\_ day of \_\_\_\_\_, A.D. 1988

\_\_\_\_\_  
 A Notary Public in and for the Province of British Columbia

BCL 5

<u>Mortgagee</u>	<u>Owner-Developer</u>
Authorized Signatory	Authorized Signatory

October 3rd 1988

STRATA PLAN  
V.R.

BASEMENT  
BUILDING 6

SCALE - 1:200m.

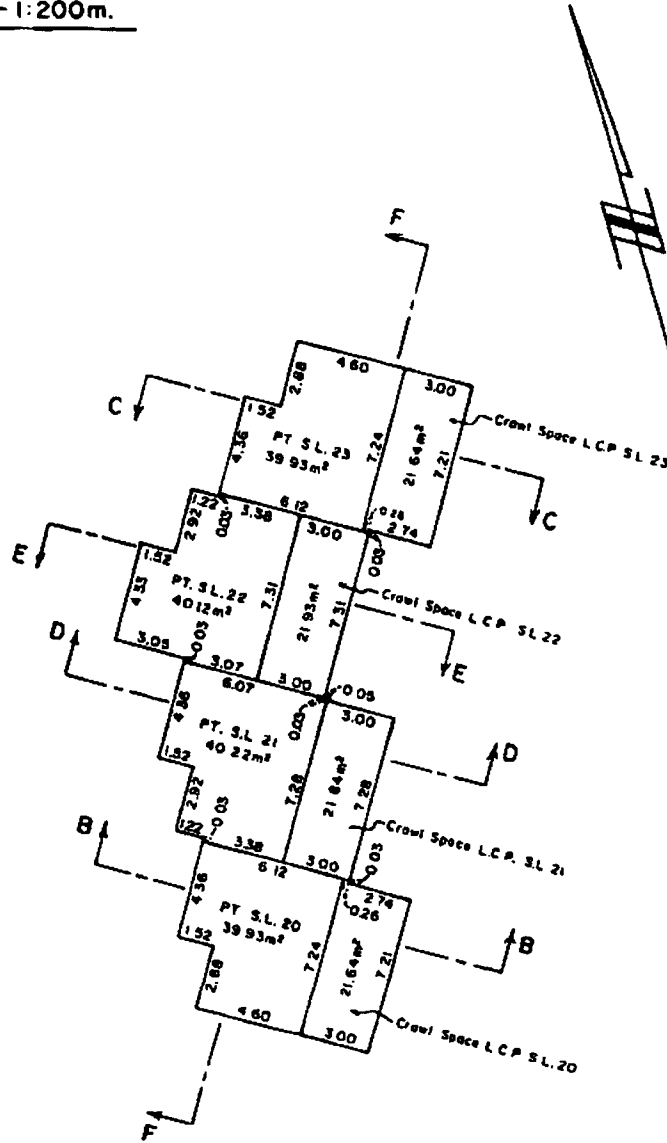

TOTAL AREAS

S.L. 20	156.92m <sup>2</sup>
S.L. 21	155.97m <sup>2</sup>
S.L. 22	155.93m <sup>2</sup>
S.L. 23	156.92m <sup>2</sup>

FIRST FLOOR

BUILDING 6

SCALE - 1:200m.

