

BC OnLine

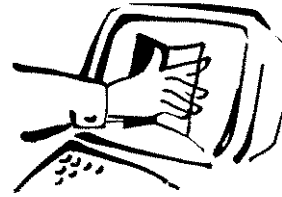

BC OnLine Land Title Internet Service
Provided in co-operation with
Land Title and Survey Authority

LAND TITLE AND SURVEY AUTHORITY - DOCUMENT RETRIEVAL		WEB REQUEST			
CLIENT NAME:	SUTTON GROUP - BROADVIEW REALTY				
ADDRESS:	#301 - 1508 WEST BROADWAY VANCOUVER BC V6J 1W8				
PICK-UP INSTRUCTIONS:					
USER ID:	PA86841	APPLICATION NO.:	VAS2497 VA	PAGES:	013
ACCOUNT NO.:	932051	REQUESTED AT:	06-03-04 14:26		
REFERENCE NO.:	T15417	FOLIO NO.:	ADMINISTRATION		
REMARKS:					

BC OnLine Land Title Fax Service

Help Desk Victoria (250) 953-8200
In B.C. 1-800-663-6102
Administration Office ... (250) 953-8250
Fax Number (250) 953-8222

Persons who need to rely on a plan for legal purposes must examine the official version at the Land Title Office in which the plan is deposited.

The bylaw and common property sheets attached to strata plans have been repealed. Information regarding the bylaws and/or dealings affecting the common property of strata plans must be obtained from the general index and/or common property index on ALTOS. Refer to the BC OnLine user guide for access information.

08

Sheet 1 of 38 Sheets.
**STRATA PLAN
V. R. 2497**

**STRATA PLAN OF
LOT 24, D. L. 3903,
PLAN 21816, GP. 1, N. W. D.,
Resort Municipality of Whistler**

SCALE 1:750

Strata Plan **V. R. 2497** deposited and registered in the Land Title Office at Vancouver, B. C. this 12th day of **OCTOBER, 1989**

The address for the Service of Documents on the "Strata Corporation" is:-
"The Owners" Strata Plan No. V.R. 2497
c/o- DAYAN & CO.,
402-1195 West Broadway,
Vancouver, B.C.
V6E 3X5

Civic Address is:-
4737 Spearhead drive,
Whistler, B.C.
V0N 1B0

Assistant Deputy Registrar
GC 180172

Legend:
B.B. BEARINGS ARE ASTROGNOMIC AND DERIVED FROM PLAN 21816
S.L. STRATA LIT
PT -PLOT
B -BENCH
L.C.P.-LIMITED COMMON PROPERTY
C -COMMON PROPERTY CONTAINING CHIMNEYS
e.m. -EASEMENT
--PROPERTY LINE

THIS PLAN LIES WITHIN THE
"SQUAMISH-LILLOOET" REGIONAL DISTRICT.

HERMON, BUNBURY & OKE,
PROFESSIONAL LAND SURVEYORS
VANCOUVER AND WHISTLER, B.C.

September 22, 1989
S-4953-1

Sheet 2 of 38 Sheets.
**STRATA PLAN
V. R. 2497**

CONDOMINIUM ACT

LOT NO.	SHEET NO.	FORM 1	FORM 2	FORM 3
		Schedule Of Unit Entitlement	Schedule Of Interest Upon Destruction	Schedule Of Voting Rights
1	4, 5, 32	21	234	1
2	4, 5, 32, 35	21	223	1
3	5, 6, 32	29	305	1
4	5, 6, 32	26	273	1
5	5, 6, 32	26	273	1
6	5, 6, 32, 35	29	294	1
7	8, 9, 32	22	223	1
8	8, 9, 32, 35	22	223	1
9	9, 10, 32	29	294	1
10	9, 10, 32	26	273	1
11	9, 10, 32	26	273	1
12	9, 10, 32, 35	29	283	1
13	12, 13, 33	21	223	1
14	12, 13, 33, 35	22	234	1
15	13, 14, 33	27	273	1
16	13, 14, 33	26	272	1
17	13, 14, 33	26	272	1
18	13, 14, 33, 35	29	305	1
19	15, 17, 18, 34, 36	21	240	1
20	16, 17, 18, 34, 36	23	240	1
21	16, 17, 18, 34	34	272	1
22	16, 17, 18, 34	33	272	1
23	16, 17, 18, 34	22	223	1
24	16, 17, 18, 34	20	223	1
25	20, 21, 22, 34, 36	20	223	1
26	20, 21, 22, 34, 36	22	223	1
27	20, 21, 22, 34	33	272	1
28	20, 21, 22, 34	33	272	1
29	20, 21, 22, 34	23	229	1
30	20, 21, 22, 34	21	229	1
31	24, 25, 26, 34, 36	21	229	1
32	24, 25, 26, 34, 36	23	229	1
33	24, 25, 26, 34	33	267	1
34	24, 25, 26, 34	22	218	1
35	24, 25, 26, 34	20	218	1
36	28, 29, 30, 35, 36	20	218	1
37	28, 29, 30, 35, 36	22	218	1
38	28, 29, 30, 35	33	267	1
39	28, 29, 30, 35	23	234	1
40	28, 29, 30, 35	21	234	1
TOTAL		1000	10000	40

September 22, 1989
S4953-2

Second Sheet, Sheet 3 of 38 Sheets.
STRATA PLAN V. R. 2497

CONDOMINIUM ACT.

LOT NO	SHEET NO.	FORM 1	FORM 2	FORM 3
		Schedule Of Unit Entitlement	Schedule Of Interest Upon Destruction	Schedule Of Voting Rights

Accepted as to Forms 1, 2 and 3 on the 12th day of October, 1989

Quidley
Superintendent of Real Estate

STATUTORY DECLARATION:-
I/WE, the undersigned, do solemnly declare that:-
1. I/WE (am/are) the Owner - Developer - or the duly authorised Agent of the Owner - Developer
2. The Strata Plan is entirely for residential use.
3. I/WE make this solemn declaration conscientiously believing it to be true and knowing that it is of the same force and effect as if made under Oath.

Declared before me at Vancouver in the Province of British Columbia, this 22nd day of September A.D. 1989

[Signature]
A Notary Public in and for the Province of British Columbia B.C.L.S.

Mortgagee NATIONAL BANK OF CANADA	Owner - Developer UNITED PROPERTIES LTD.
<i>[Signature]</i> Authorized Signatory	<i>[Signature]</i> Authorized Signatory
<i>[Signature]</i> Authorized Signatory	<i>[Signature]</i> Authorized Signatory

September 22, 1989
S-4953

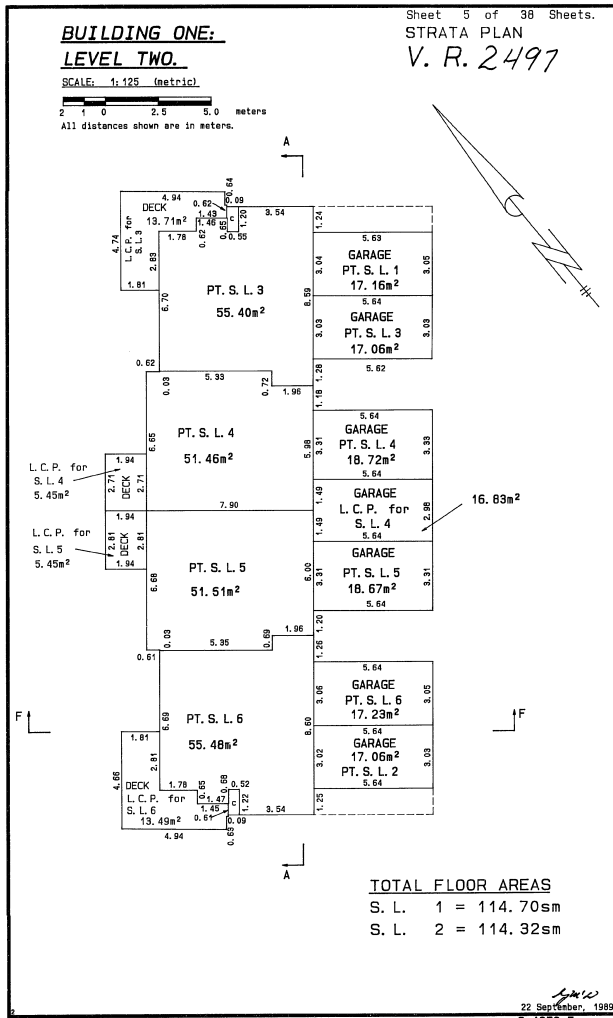
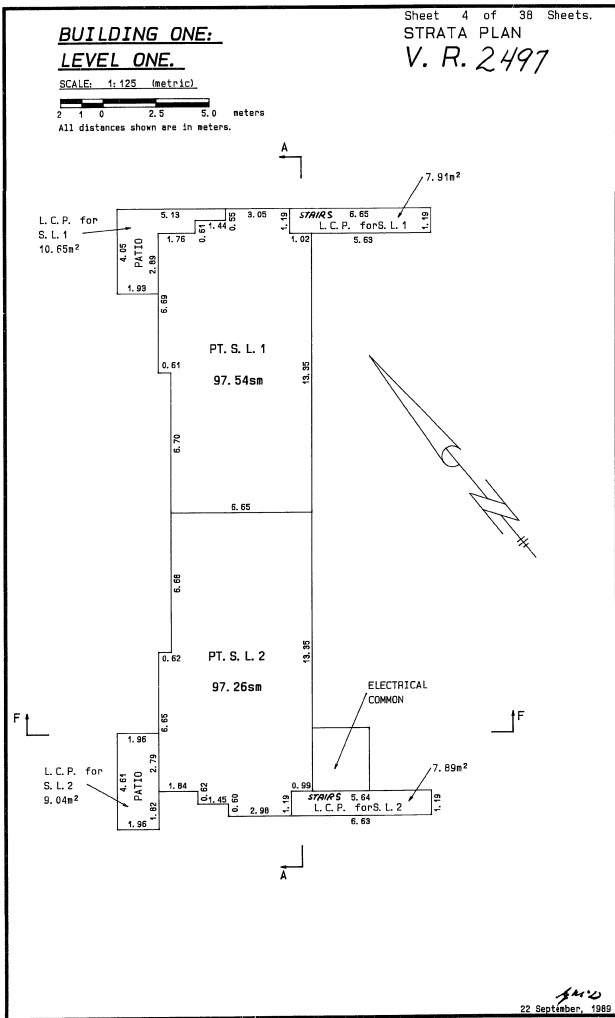

TOTAL FLOOR AREAS

S. L. 1	= 114.70sm
S. L. 2	= 114.32sm

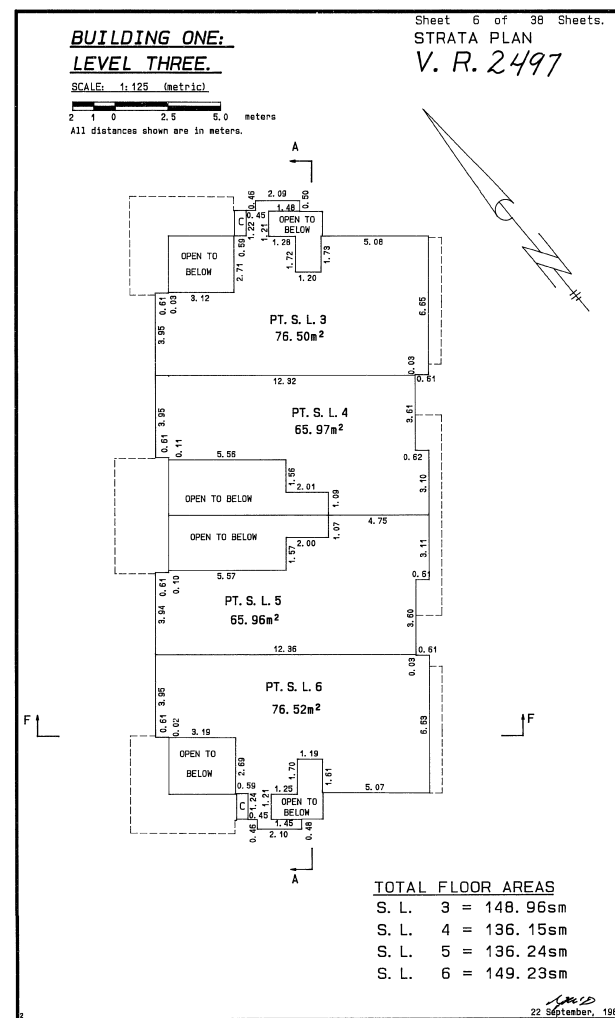

TOTAL FLOOR AREAS

S. L. 3	= 148.96sm
S. L. 4	= 136.15sm
S. L. 5	= 136.24sm
S. L. 6	= 149.23sm

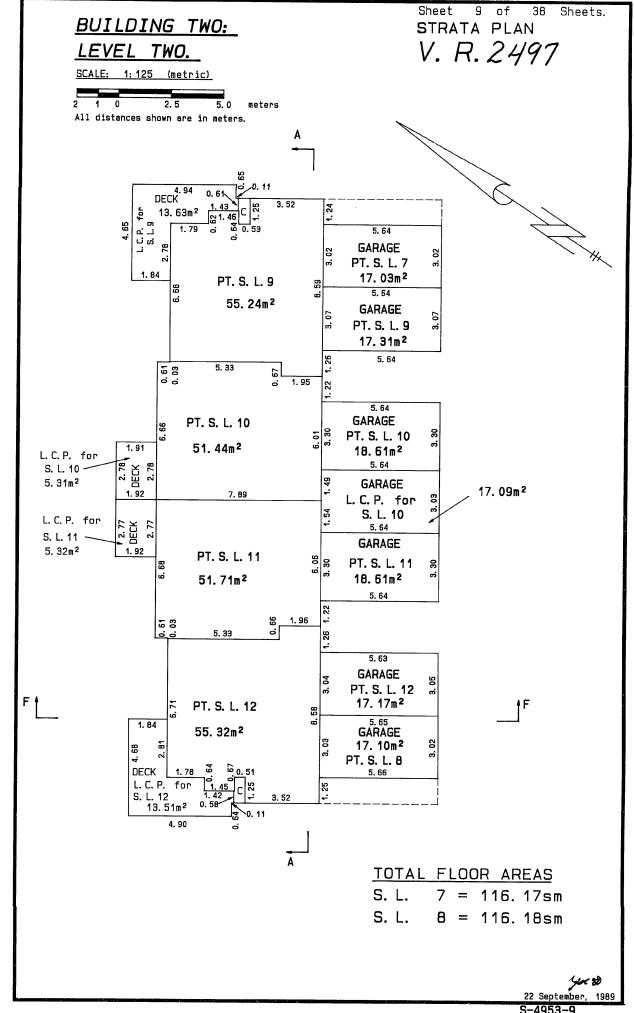
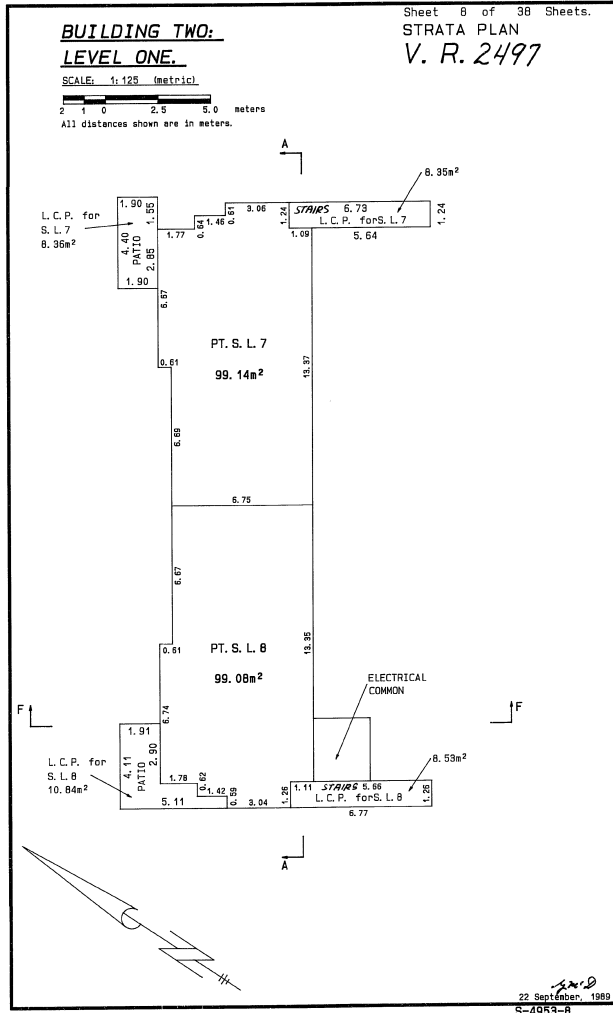
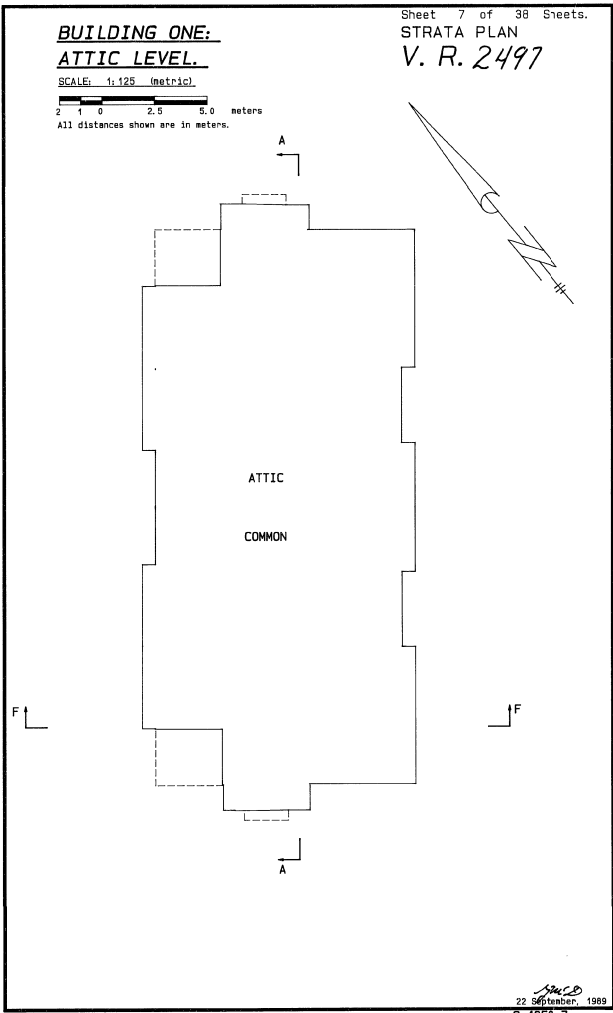

TOTAL FLOOR AREAS
S. L. 7 = 116.17sm
S. L. 8 = 116.18sm

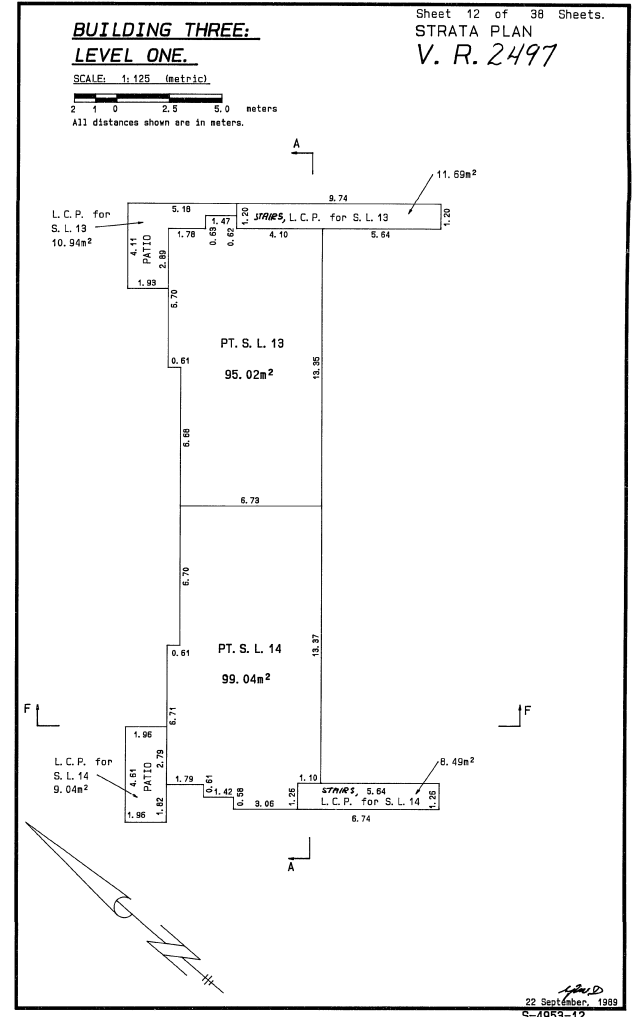
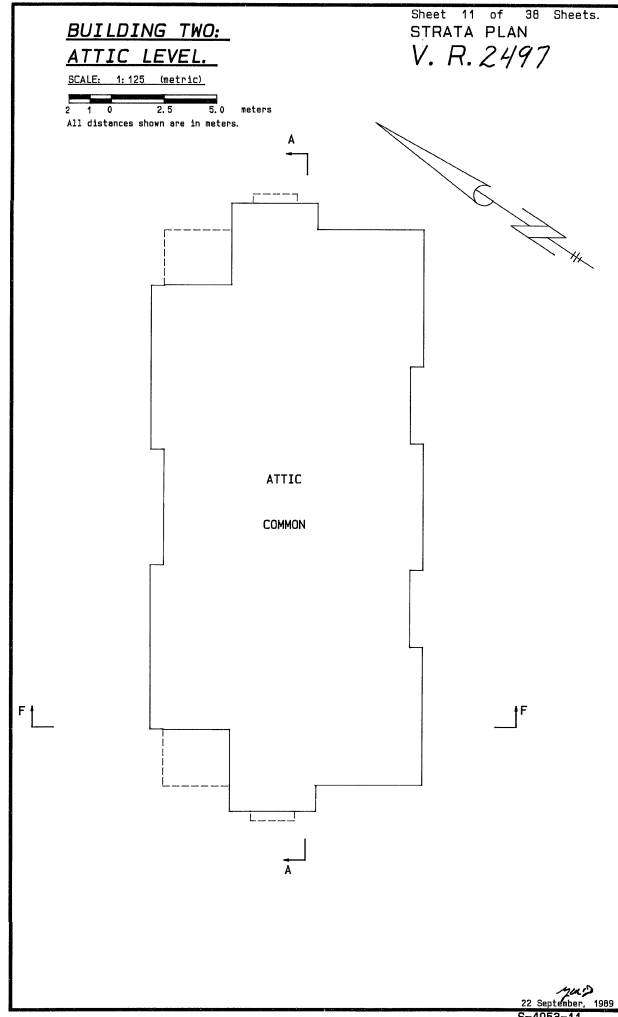
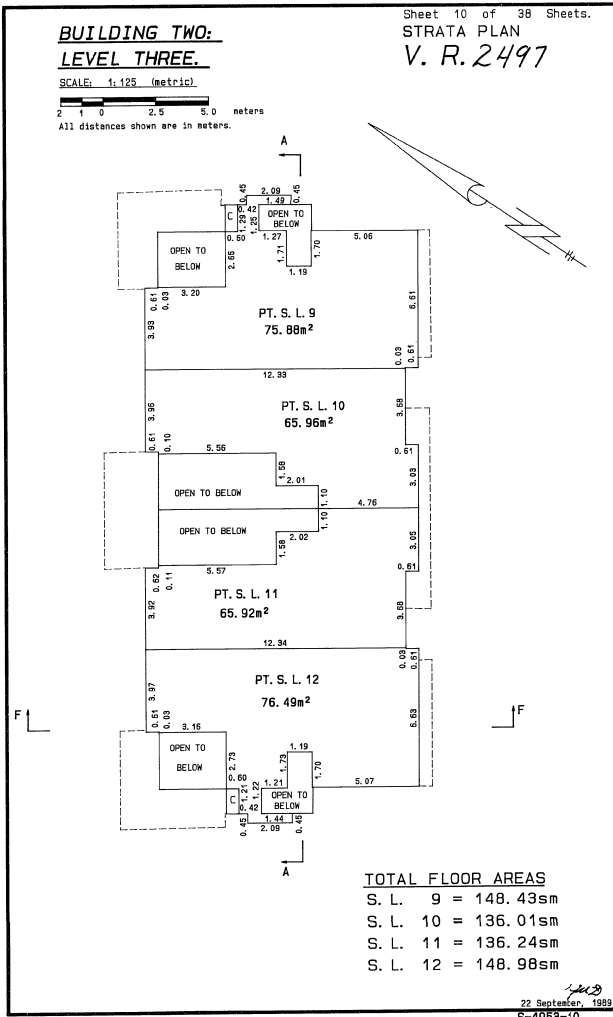

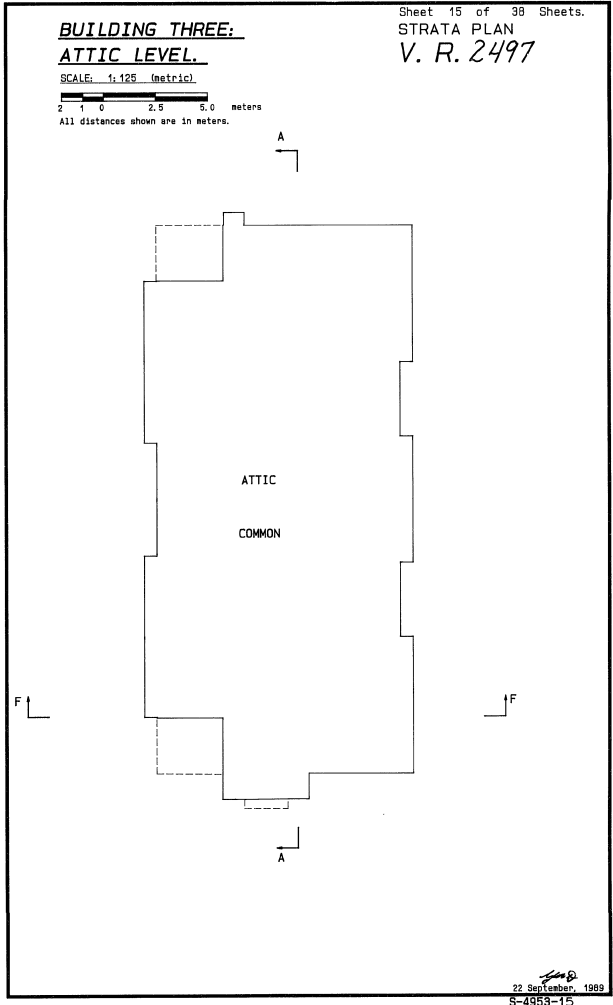
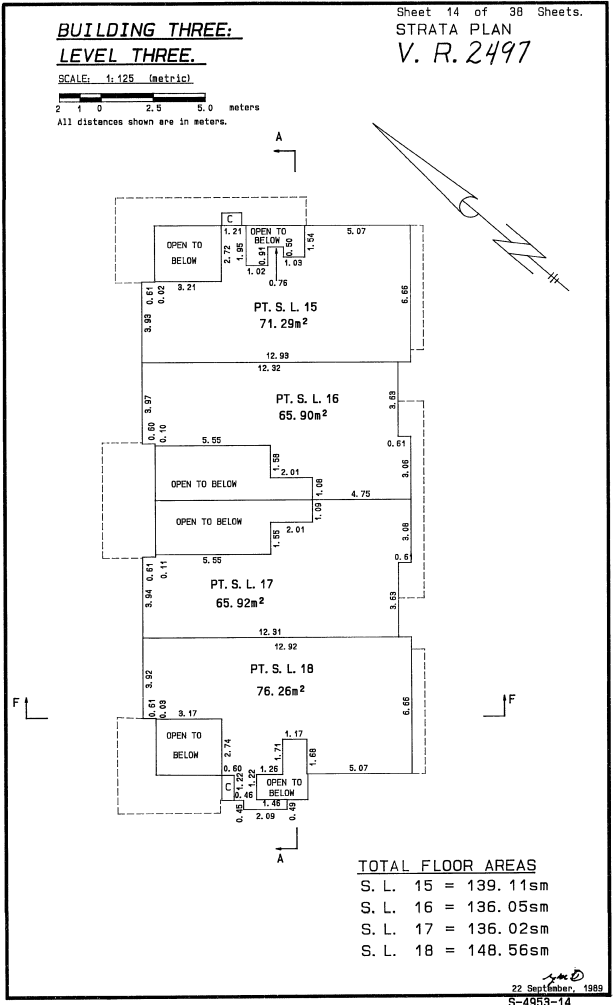
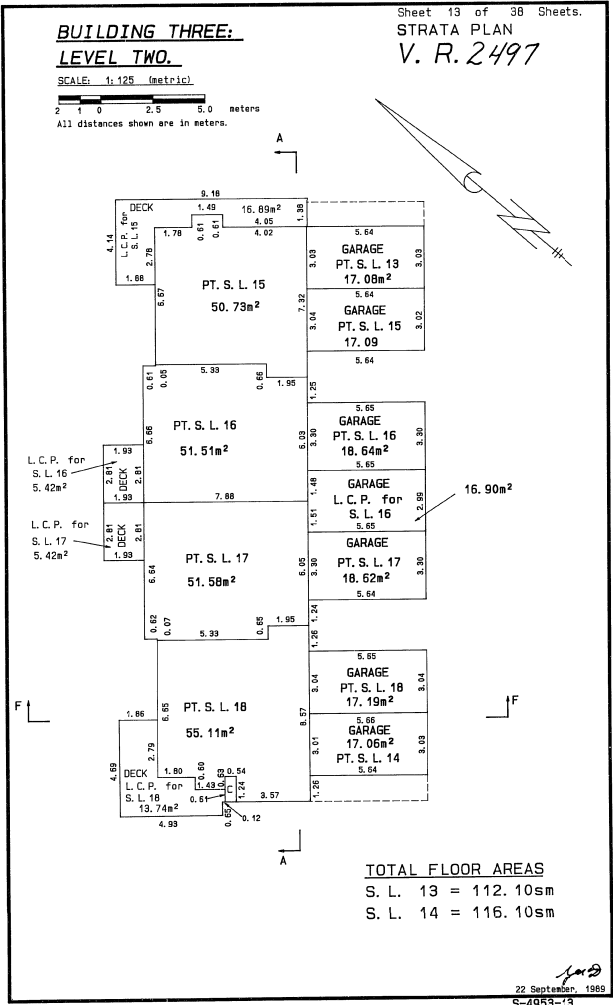

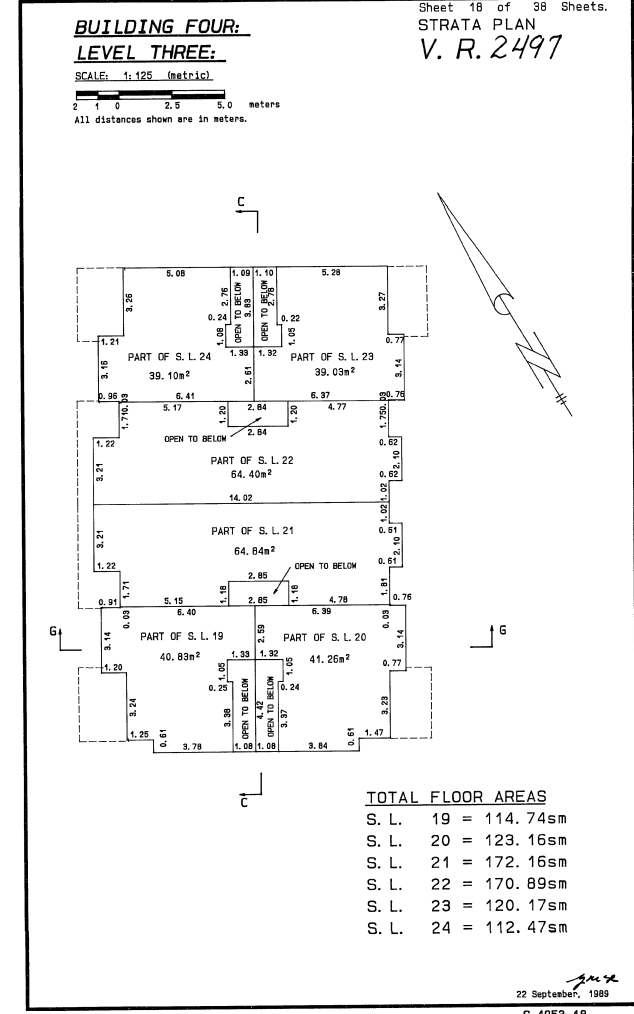
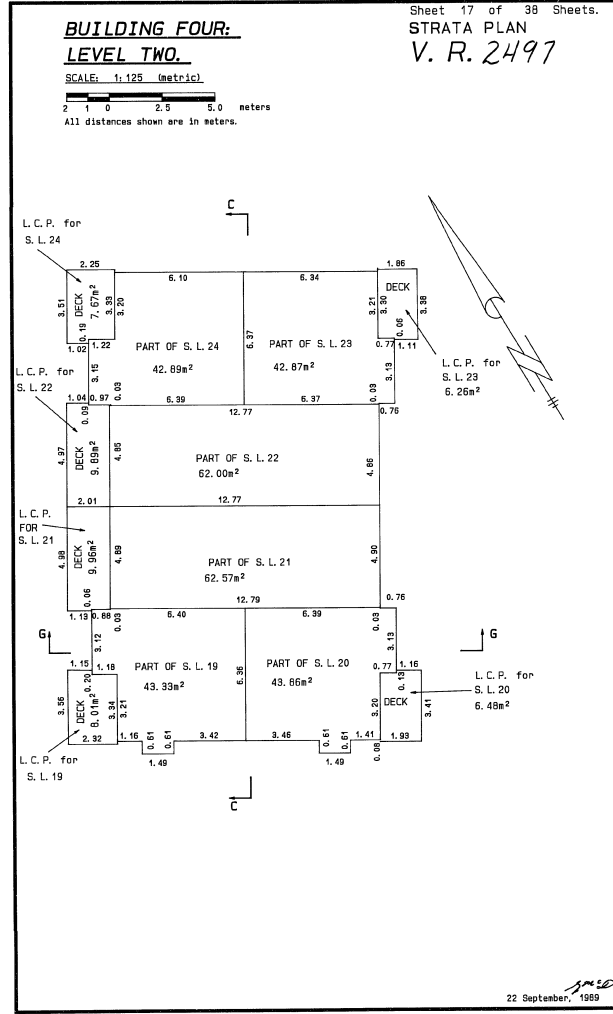
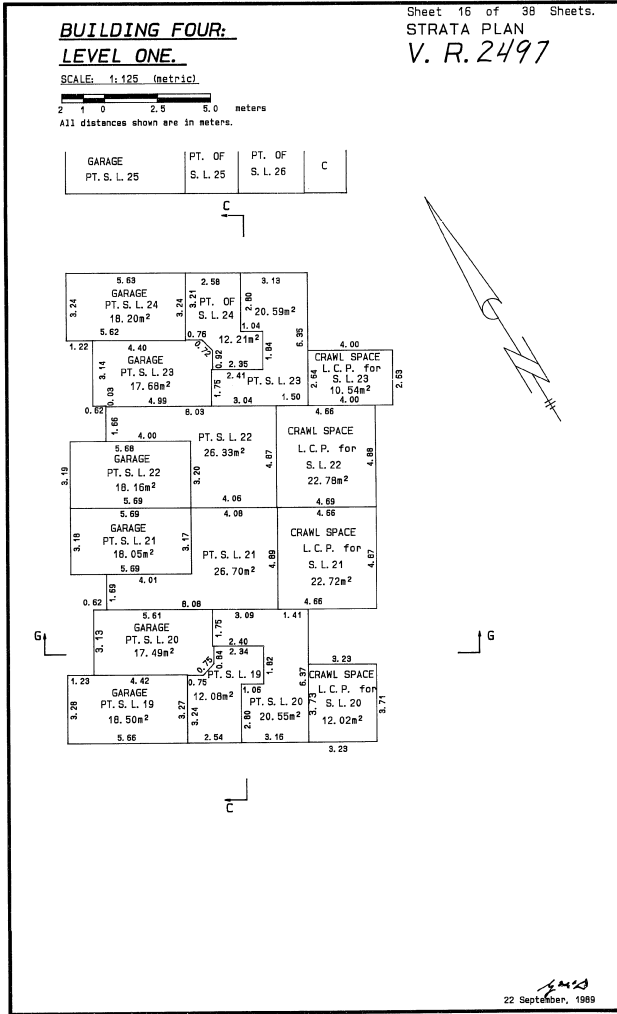

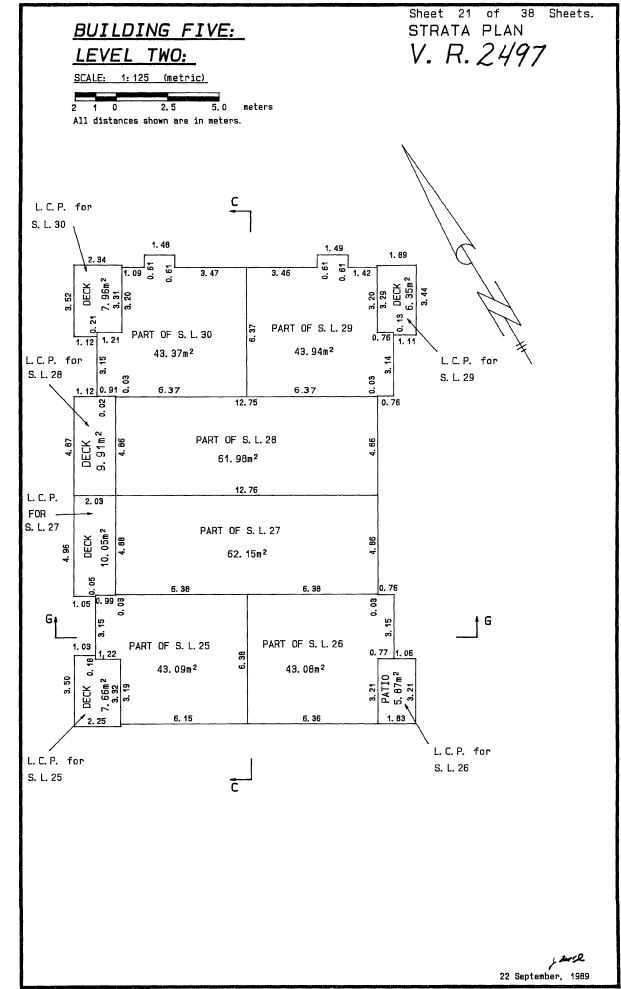
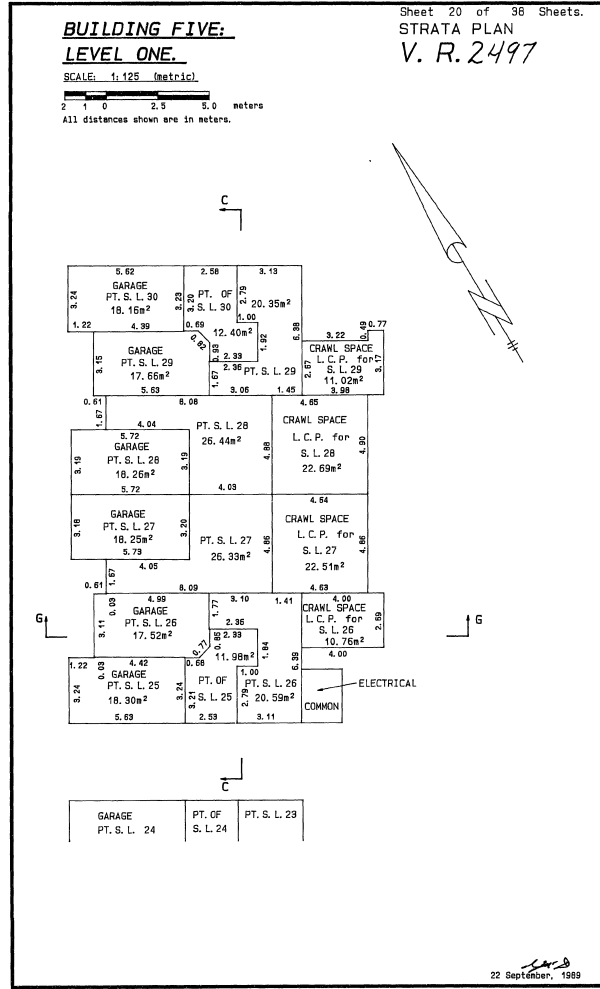
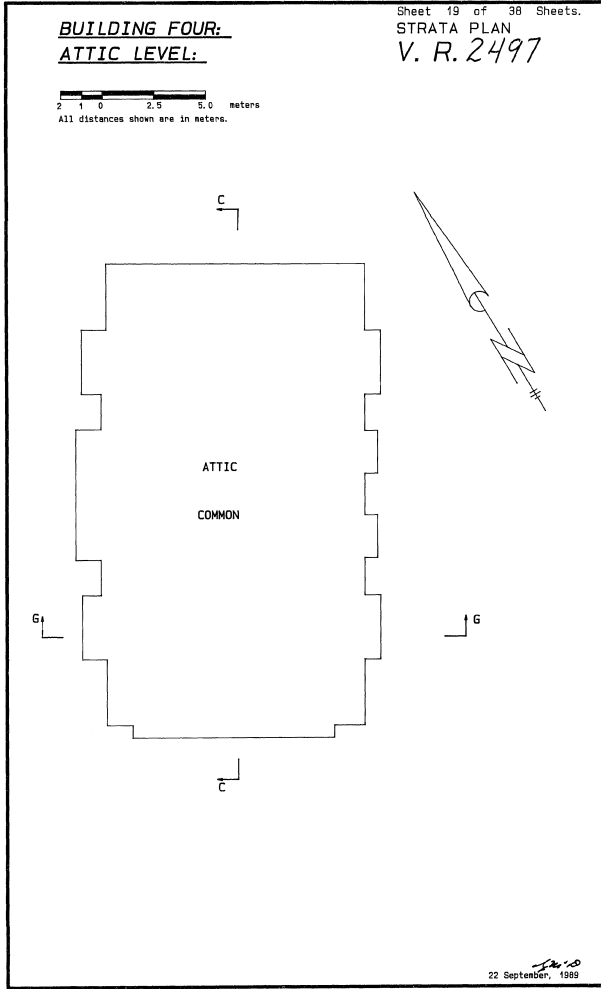

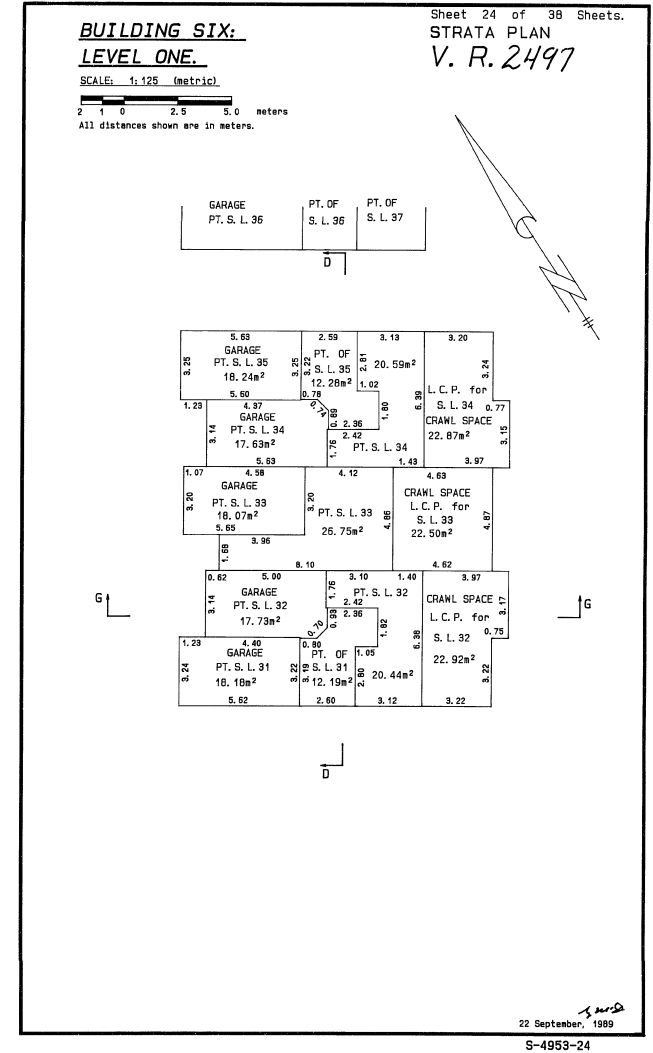
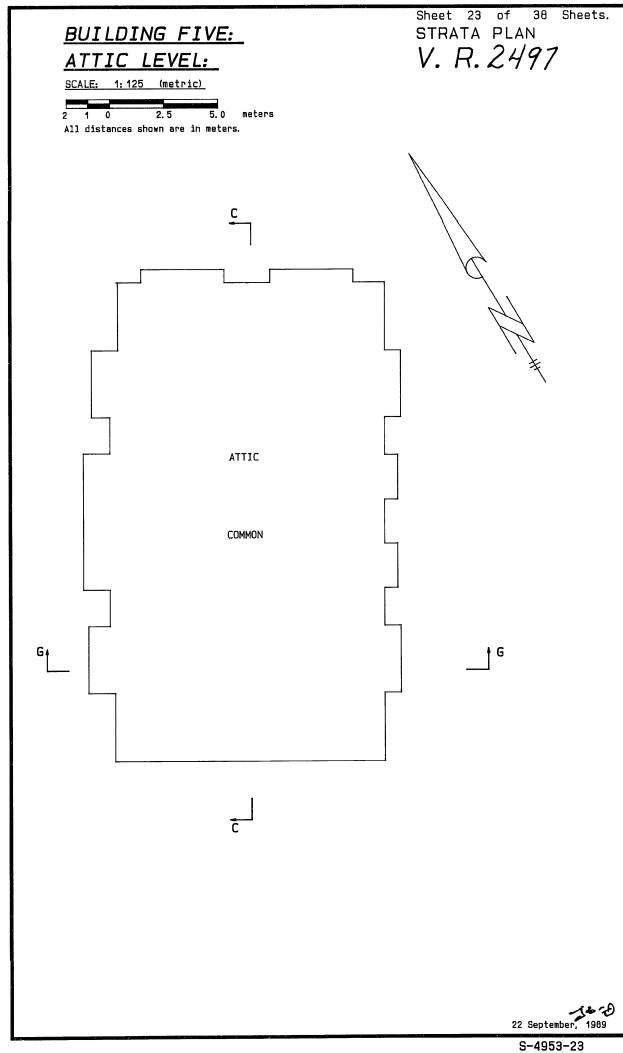
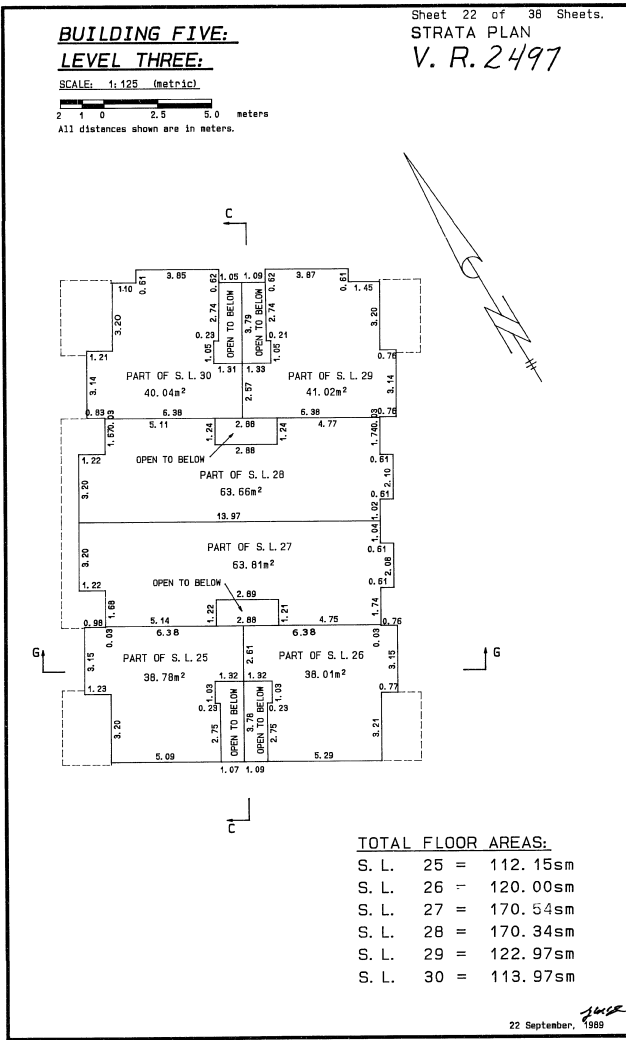

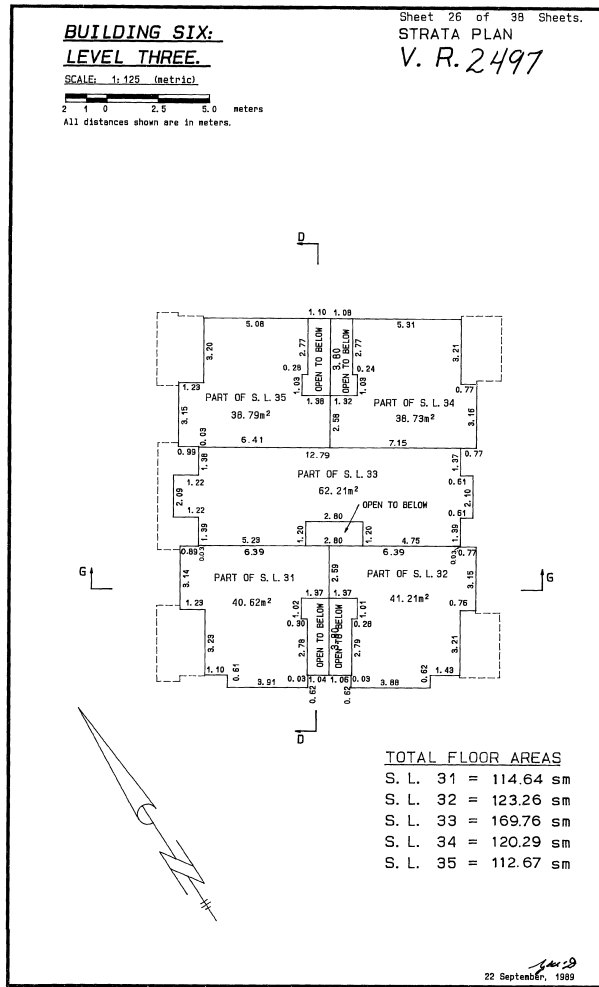
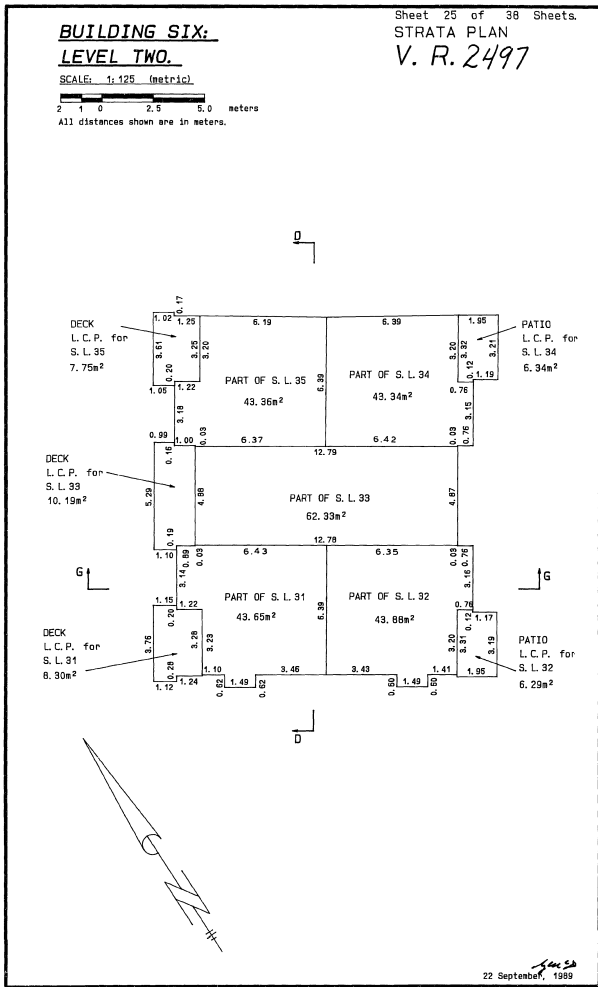

TOTAL FLOOR AREAS

S. L. 31	= 114.64 sm
S. L. 32	= 123.26 sm
S. L. 33	= 169.76 sm
S. L. 34	= 120.29 sm
S. L. 35	= 112.67 sm

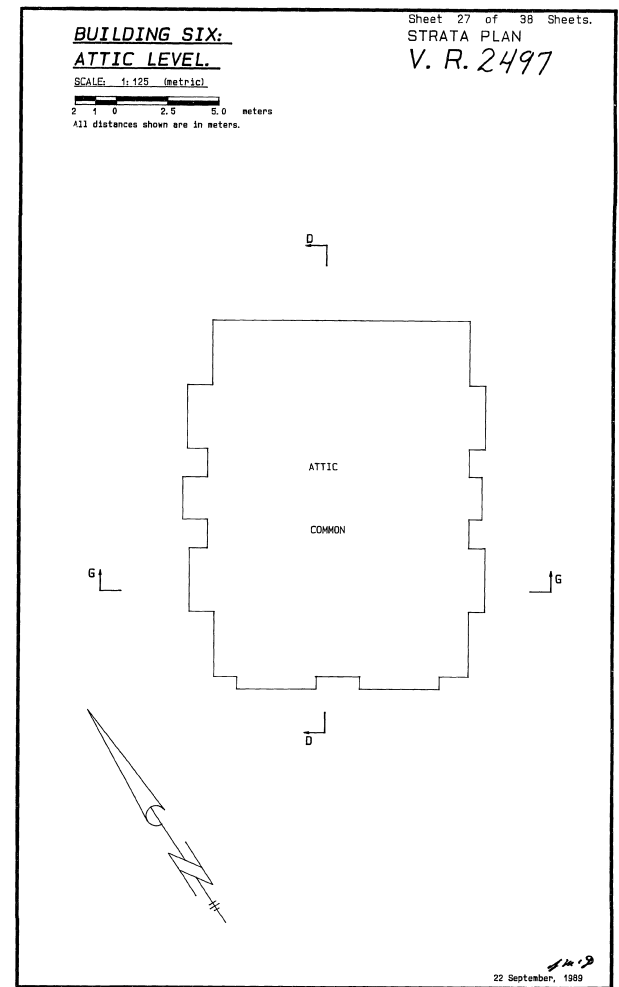

BUILDING SEVEN:
LEVEL ONE.

SCALE: 1:125 (metric)

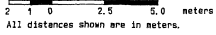

All distances shown are in meters.

Sheet 28 of 38 Sheets.
STRATA PLAN
V. R. 2497

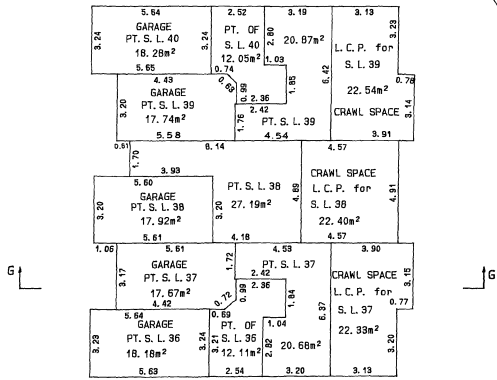

GARAGE	PT. OF S. L. 35	PT. OF S. L. 35	PT. OF S. L. 34	L.C.P. for S. L. 34
5.64	2.52	3.19	3.19	22.54m ²
4.43	2.36	2.42	4.54	5.98
5.60	3.93	4.08	4.57	4.91
5.61	4.18	4.58	3.90	3.15
5.64	3.24	2.54	3.20	3.19

22 September, 1989
S-4953-28

BUILDING SEVEN:
LEVEL TWO.

SCALE: 1:125 (metric)

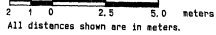

All distances shown are in meters.

Sheet 29 of 38 Sheets.
STRATA PLAN
V. R. 2497

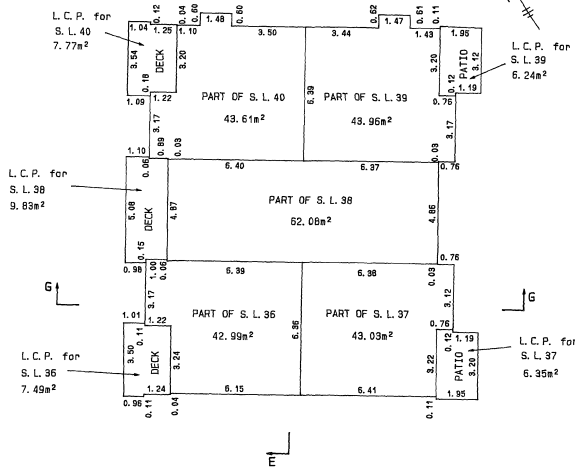

22 September, 1989
S-4953-29

BUILDING SEVEN:
LEVEL THREE.

SCALE: 1:125 (metric)

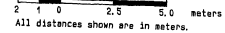

All distances shown are in meters.

Sheet 30 of 38 Sheets.
STRATA PLAN
V. R. 2497

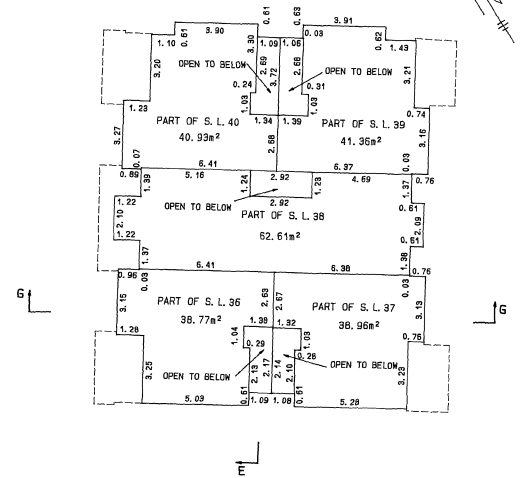

TOTAL FLOOR AREAS

S. L. 36	=	112.07sm
S. L. 37	=	120.34sm
S. L. 38	=	169.80sm
S. L. 39	=	123.93sm
S. L. 40	=	114.87sm

22 September, 1989

S-4953-30

