



# MILLENNIUM WATER

VANCOUVER'S LAST WATERFRONT COMMUNITY

## PLAN U1 LOWER FLOOR

## 128 ATHLETES WAY

3 BEDROOM + FAMILY + 2 ENCLOSED BALCONIES + FLEX

2818 SF LIVING

223 SF BALCONY

1613 SF TERRACE

- 1 Miele 5-zone gas cooktop
- 2 Sub-Zero refrigerator
- 3 Miele wall oven & Miele speed oven
- 4 Miele dishwasher
- 5 Eggersmann of Germany eco-wood cabinetry
- 6 Miele built-in coffee maker with Miele warming drawer
- 7 Sub-Zero wine cooler
- 8 Cabina custom built walk-in closet from Italy

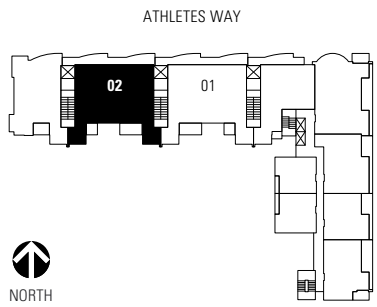

6TH FLOOR

Washer/dryer are optional items. Dimensions, sizes, areas, specifications, layouts and materials are approximate only and subject to change without notice. Floorplates and unit numbers may vary between floors and appliance brands and sizes are subject to change. Please see a sales representative for more details. E.&O.E.





# MILLENNIUM WATER

VANCOUVER'S LAST WATERFRONT COMMUNITY

## PLAN U1 UPPER FLOOR

## 128 ATHLETES WAY

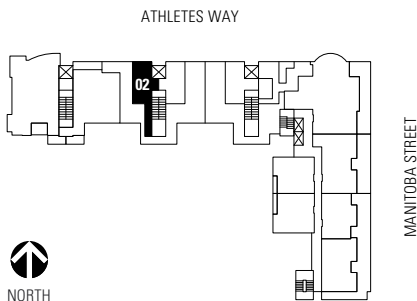
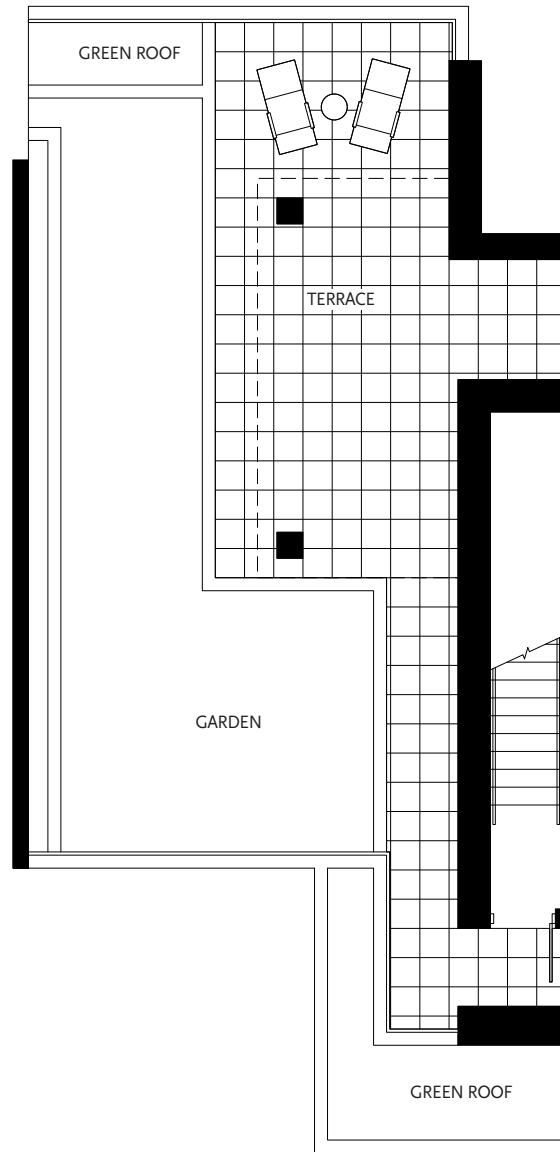

UNIT 602 – UPPER FLOOR

Washer/dryer are optional items. Dimensions, sizes, areas, specifications, layouts and materials are approximate only and subject to change without notice. Floorplates and unit numbers may vary between floors and appliance brands and sizes are subject to change. Please see a sales representative for more details. E.&O.E.

