

## Features

### ADDITION

- Architecture by Henriquez Partners Architects
- Contemporary brick and concrete façade, accented with perforated steel screens and C-shaped concrete fins, framing the elevated exteriors of 3 townhomes
- Original 24' x 22' art mural, featuring a floating stair sculpture with integrated bench seating by Richard Henriquez
- 25 foot-high structural glass lobby entry with exterior wood soffits that extend indoors and cascade down to form a feature wall
- Sculptural living green screen in the courtyard, spanning 45' and rising 3 storeys

### LIVING

- Refined interiors by Kodu Design
- Brushed ash laminate flooring with thermo-acoustic underlay
- 100% wool, 30 oz loop carpet in most bedrooms
- Enclosed balconies with 12" x 24" textured porcelain tile and double-glazed sliding doors
- Grey Charcoal window mullions and matching roller shades with no fascia panels
- Ultra efficient washer and dryer by Blomberg
- Custom bedroom partition in select homes by Friul Intagli, featuring:
  - Concealed cable chase for media

- Full-height, white lacquered doors in a soft-touch, matte finish
- Top track pocket sliding with soft-close
- Integrated stainless steel finger pulls
- Custom bedroom closet with integrated headboard in select homes by Friul Intagli, featuring:
  - Full-height, white lacquered doors in a soft-touch, matte finish
  - Internal pullout pant rack and enclosed drawer storage
  - Inset bedside shelving with USB outlet and recessed LED spotlights
  - Over headboard linen storage and full-length LED strip light
  - Soft-closing doors with recessed finger pulls

### KITCHEN

- Custom cabinetry by Friul Intagli in 2 Addition schemes, featuring:
  - White lacquered doors in a soft-touch, matte finish
  - Surround panels with recessed finger pulls and soft-close hinges
  - Pullout drawer sets with push button access
  - Integrated pullout waste and recycling bin with flip top
  - Under-cabinet and flush-mounted LED strip light
  - Under-mounted steel cover to fully conceal hood vent
  - Removable kick plates for easy cleaning
  - Integrated laundry cabinet with clothes rail

- and adjustable internal shelving in select homes
- 6mm stainless steel counter in a textured chrome finish
- Seamlessly integrated 19" weld-on sink by Vittinox
- Wall-mounted kitchen faucet with swivel spout by Zuchetti
- Stainless steel backsplash to cooktop in a Scotchbrite finish
- High-performance stainless steel appliance package:
  - Liebherr 24" integrated refrigerator with bottom-mount freezer
  - Porter & Charles 4-burner electric cooktop
  - Porter & Charles convection oven
  - Porter & Charles integrated dishwasher
  - Broan integrated hood vent
  - Panasonic microwave and trim kit in select homes
  - Liebherr 24" bar fridge with glass door in select homes

### BATH

- Custom wall-mounted vanities by Friul Intagli, featuring:
  - Acrylic resin sink basin with integrated toiletry holder
  - White lacquered cabinetry in a high-gloss finish
  - Soft-closing drawers with integrated door pulls
  - 6mm aluminum-framed vanity mirror with

- top-mounted LED light
- 12" x 24" Brilliant White glossy wall tile and tub surround
- 12" x 24" Seashell textured porcelain tile flooring
- Polished chrome faucets and fixtures throughout
- Low-flow dual flush toilet with soft-closing seats
- Bathtub with inclined backrest

### CONVENIENCE

- Clima Canal forced-air heating, cooling, and ventilation system with removable, brushed aluminum grills, and custom powder-coated galvanized steel casing without rivets
- Smartforme building energy management with advanced in-suite metering technology and occupancy-detecting thermostats
- Heat Recovery Ventilation for continuous fresh and comfortable air circulation
- Amenity lounge with courtyard patio for meeting, entertaining, and relaxing
- Double-height, fully-equipped fitness room, overlooking the courtyard
- Shaded outdoor BBQ patio with outdoor seating, fireplace, garden plots, and children's play area
- Key Fob access, interphones, cameras at key entry points, and elevators with restricted floor access
- Secured underground bicycle storage and optional storage lockers
- 2-5-10-year Travelers Home Warranty

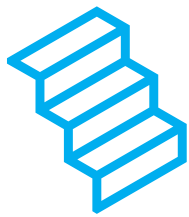

# addition

PLAN A 501-534 SF

1 Bedroom

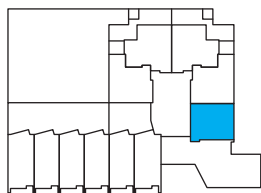

HELMCKEN STREET

LEVEL 2  
HORNBY STREET



HELMCKEN STREET

LEVEL 3  
HORNBY STREET

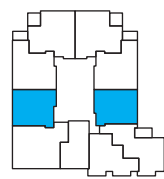

HELMCKEN STREET

LEVEL 5  
HORNBY STREET

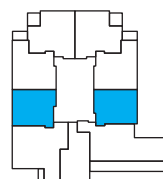

HELMCKEN STREET

LEVEL 6  
HORNBY STREET

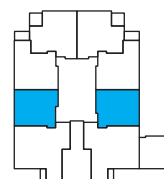

HELMCKEN STREET

LEVEL 7  
HORNBY STREET

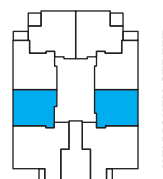

HELMCKEN STREET

LEVELS 8-19  
HORNBY STREET

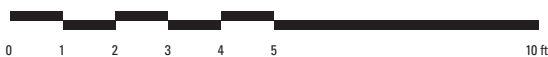

Dimensions, sizes, areas, specifications, layouts and materials are approximate only and subject to change without notice. E.&O.E.



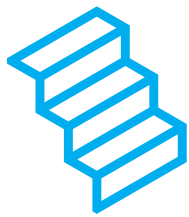

# addition

PLAN A1 601 - 619 SF

1 Bedroom + Flex

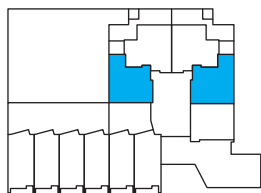
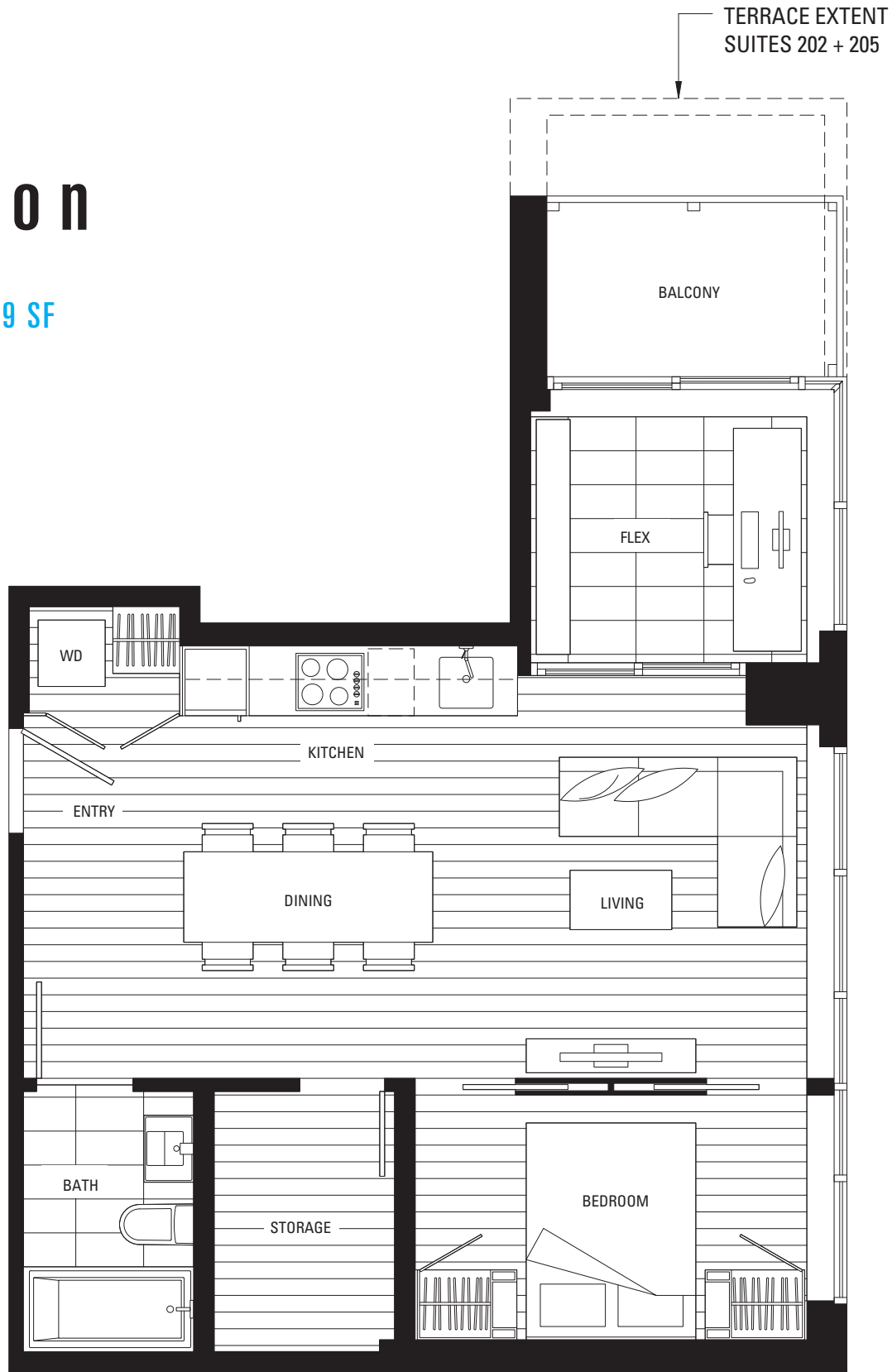

LEVEL 2  
HORNBY STREET



LEVEL 3  
HORNBY STREET

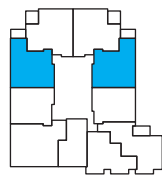

LEVEL 5  
HORNBY STREET

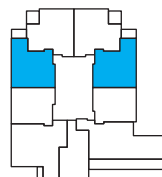

LEVEL 6  
HORNBY STREET

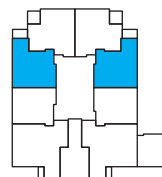

LEVEL 7  
HORNBY STREET

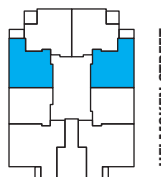

LEVELS 8-19  
HORNBY STREET

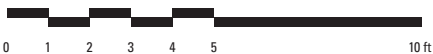

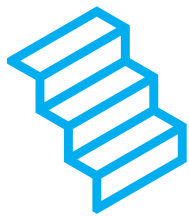

# addition

PLAN B 653 SF

1 Bedroom + Flex

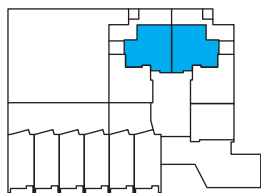
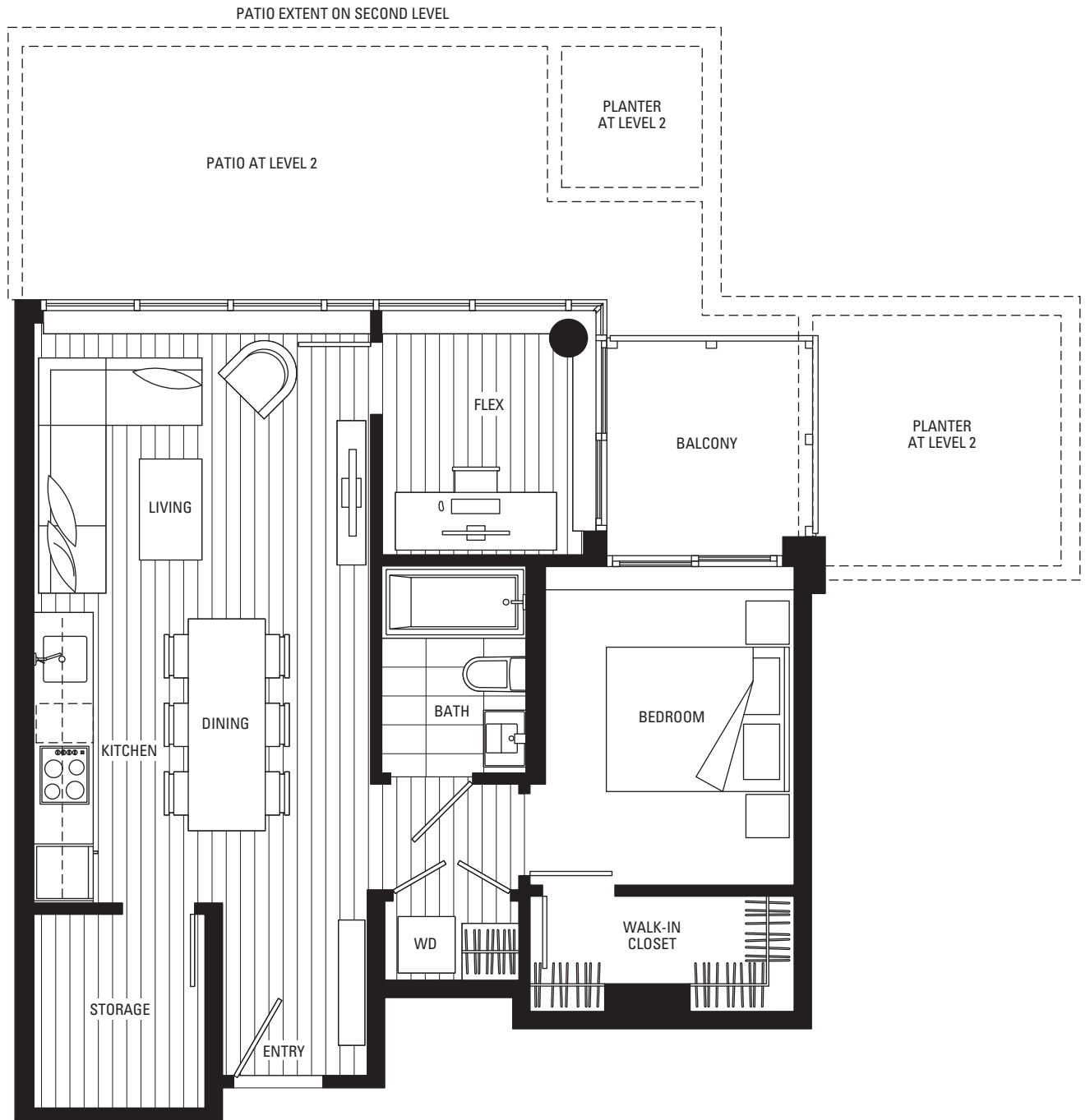

LEVEL 2  
HORNBY STREET

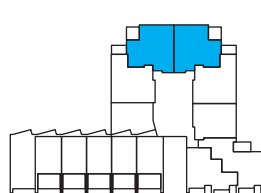

LEVEL 3  
HORNBY STREET

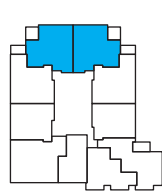

LEVEL 5  
HORNBY STREET

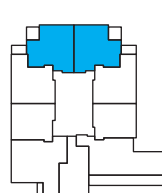

LEVEL 6  
HORNBY STREET

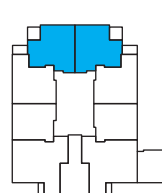

LEVEL 7  
HORNBY STREET

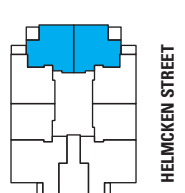

LEVELS 8-19  
HORNBY STREET



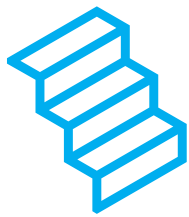

# addition

PLAN C 871-874 SF

2 Bedroom + Flex

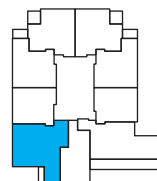

HELMCKEN STREET

LEVEL 6  
HORNBY STREET

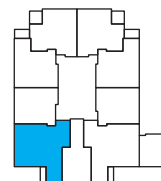

HELMCKEN STREET

LEVEL 7  
HORNBY STREET

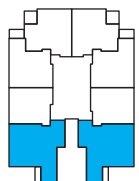

HELMCKEN STREET

LEVELS 8-19  
HORNBY STREET

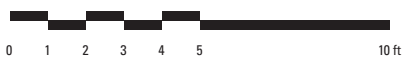

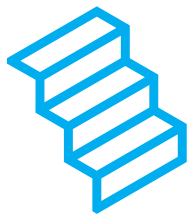

# addition

PLAN C1 874 SF

2 Bedroom + Flex

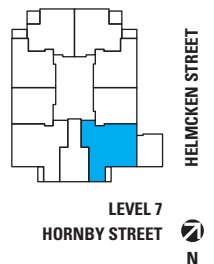

Dimensions, sizes, areas, specifications, layouts and materials are approximate only and subject to change without notice. E.&O.E.

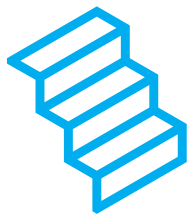

# addition

PLAN D 487 SF

Studio

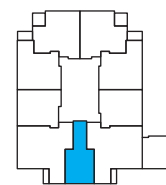
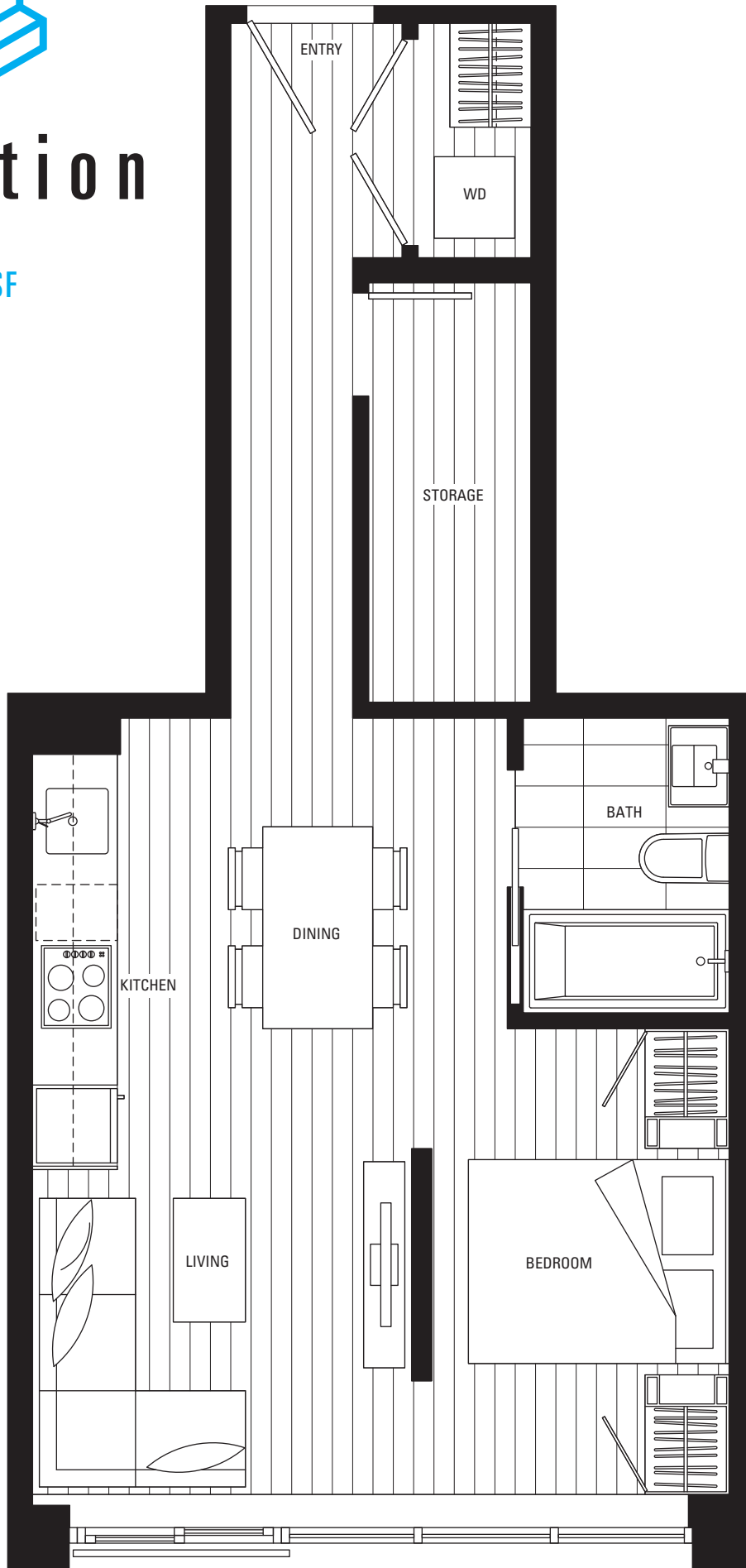

LEVEL 7  
HORNBY STREET

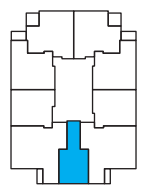

LEVELS 8-19  
HORNBY STREET



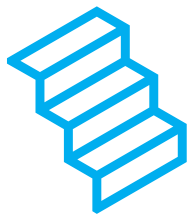

# addition

PLAN J 1,054 SF

3 Bedroom

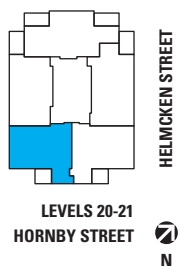
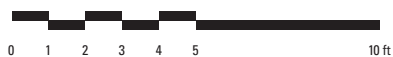

Dimensions, sizes, areas, specifications, layouts and materials are approximate only and subject to change without notice. E.&O.E.



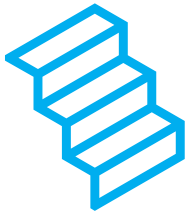

# addition

PLAN J1 1,054 SF

3 Bedroom

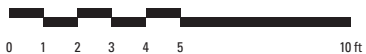
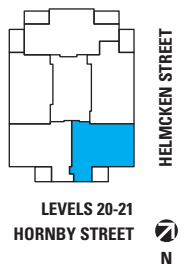

Dimensions, sizes, areas, specifications, layouts and materials are approximate only and subject to change without notice. E.&O.E.

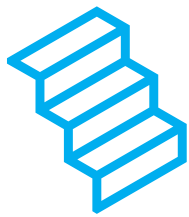

# addition

PLAN K 1,038 SF

2 Bedroom

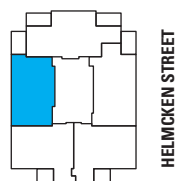
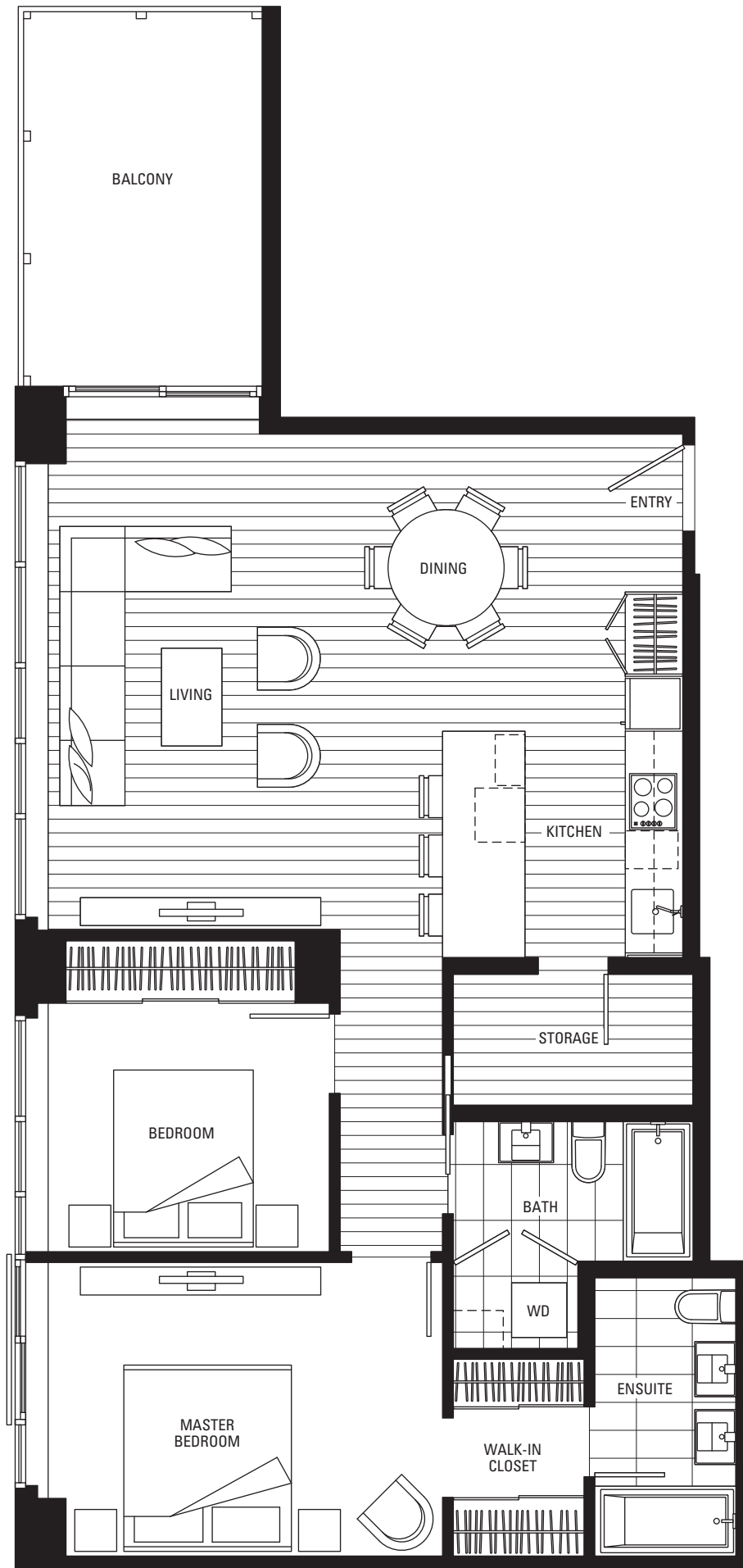

LEVELS 20-21  
HORNBY STREET

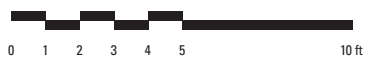

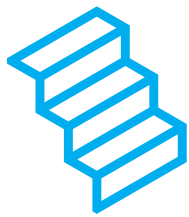

# addition

PLAN K1 1,149 SF

2 Bedroom + Flex

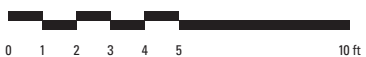

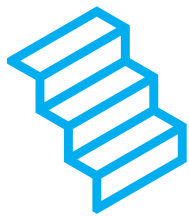

# addition

PLAN L 1,161 SF

3 Bedroom

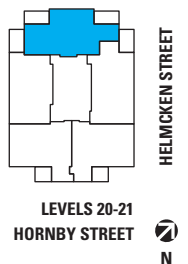
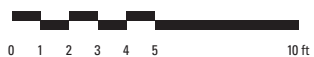
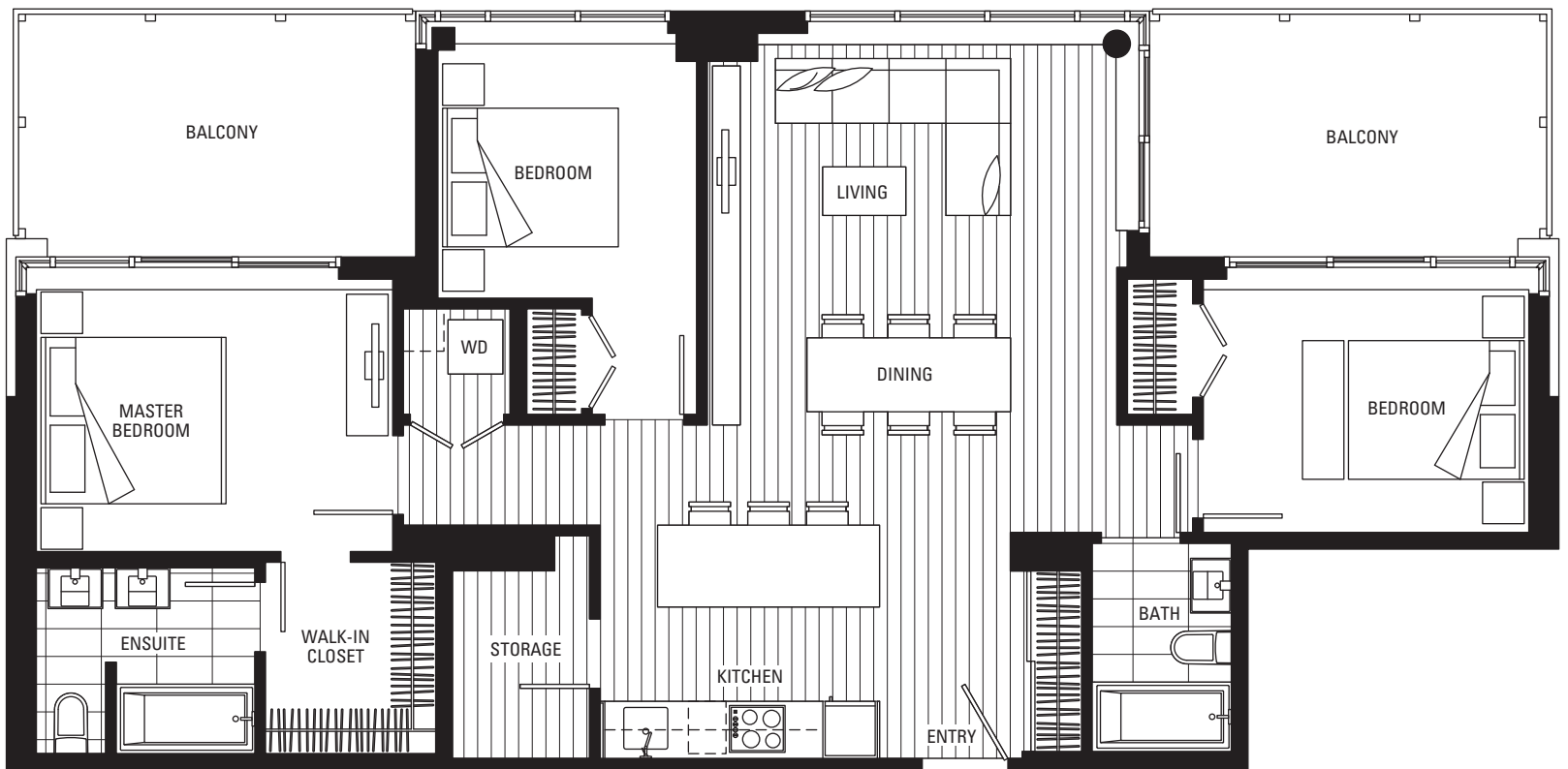

LEVELS 20-21  
HORNBY STREET

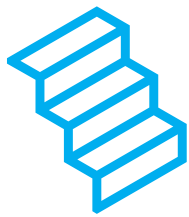

# addition

PLAN THA 1,255 SF

3 Bedroom

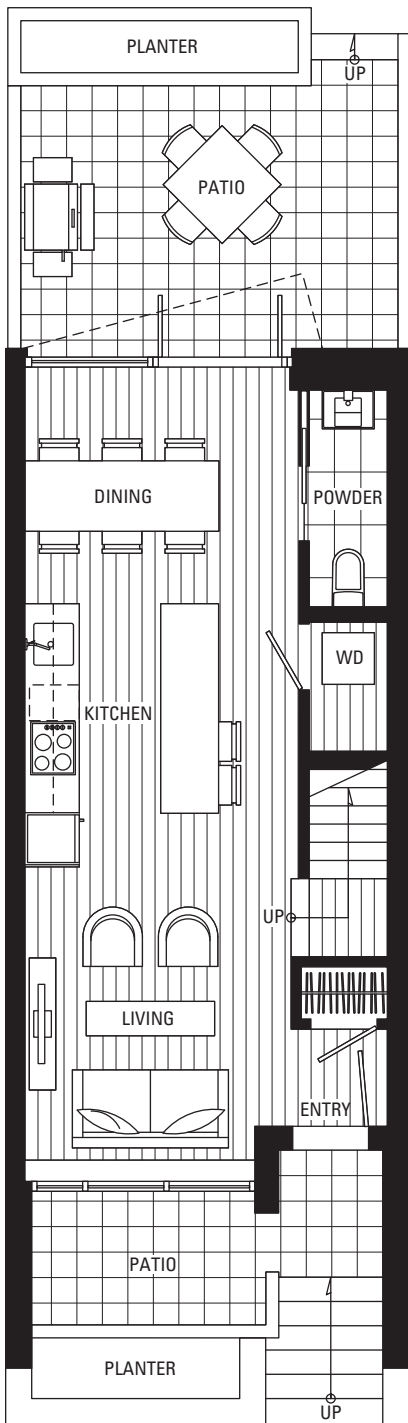

GROUND FLOOR

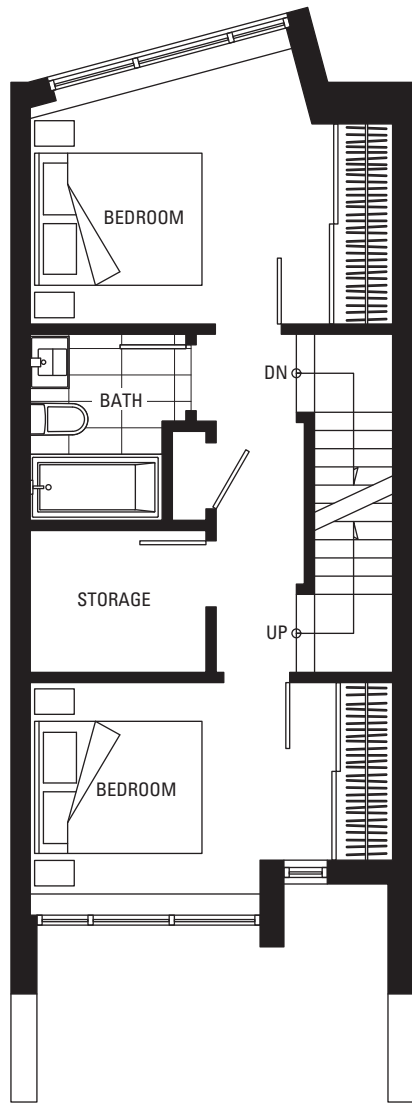

SECOND FLOOR

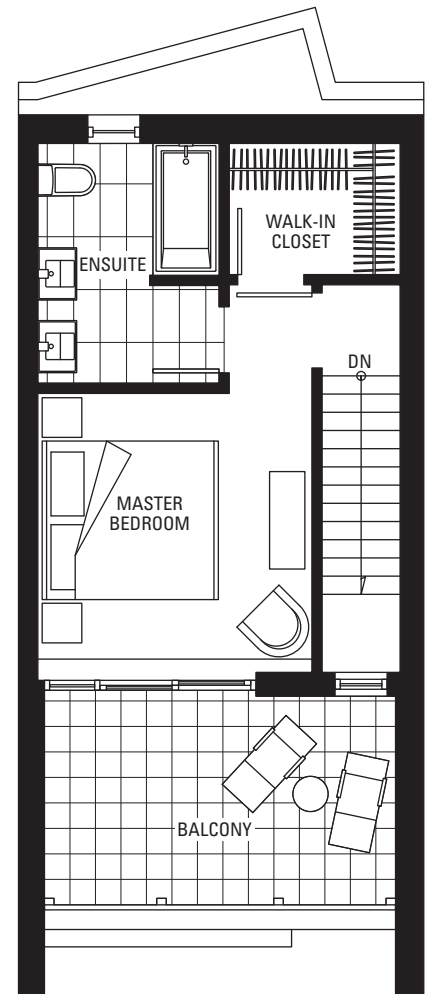

THIRD FLOOR

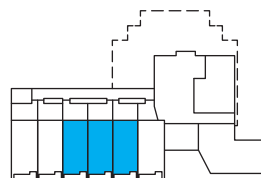

LEVEL 1  
HORNBY STREET

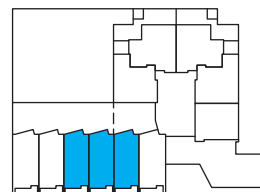

LEVEL 2  
HORNBY STREET



LEVEL 3  
HORNBY STREET



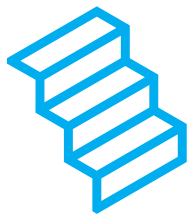

# addition

PLAN THA1 1,255 SF

3 Bedroom

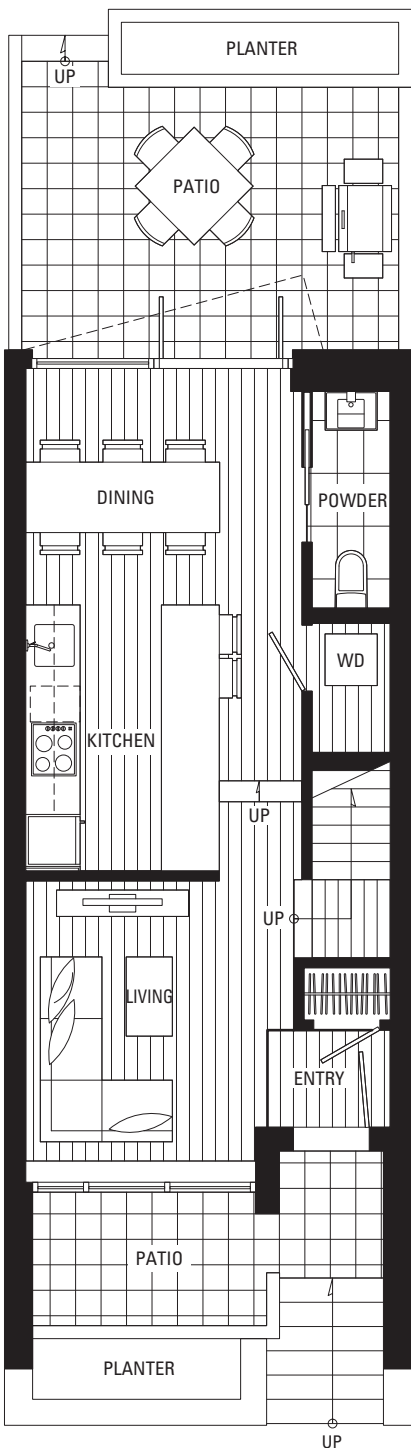

GROUND FLOOR

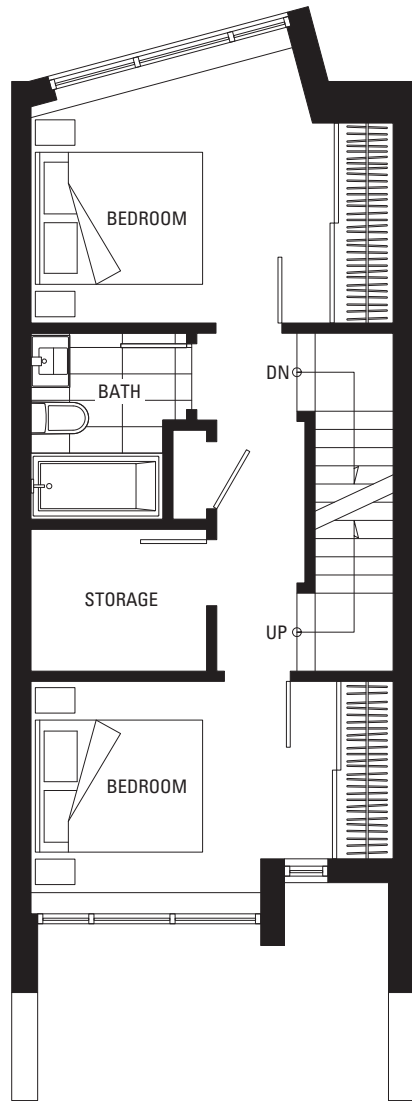

SECOND FLOOR

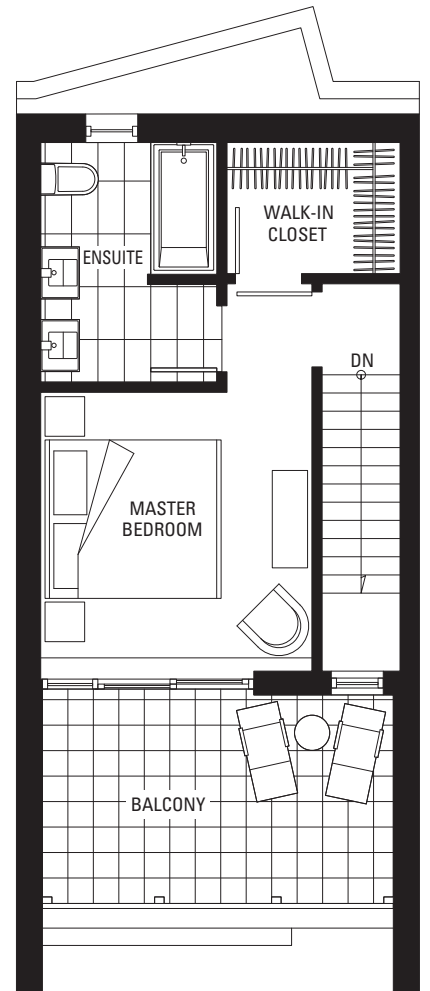

THIRD FLOOR

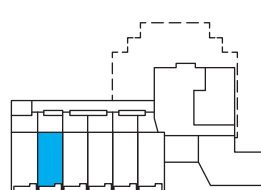

LEVEL 1  
HORNBY STREET

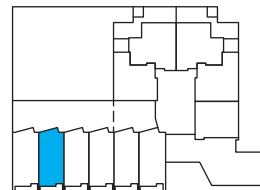

LEVEL 2  
HORNBY STREET

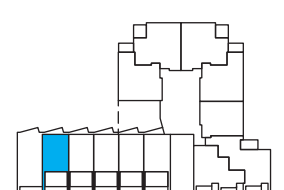

LEVEL 3  
HORNBY STREET



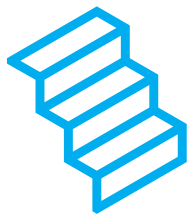

# addition

PLAN THA2 1,292 SF

3 Bedroom

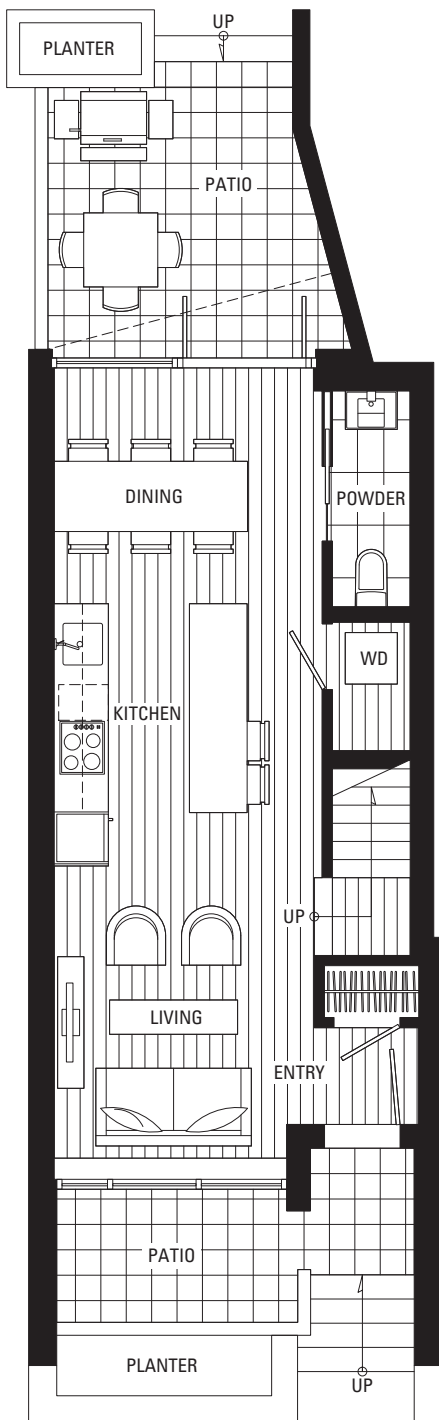

GROUND FLOOR

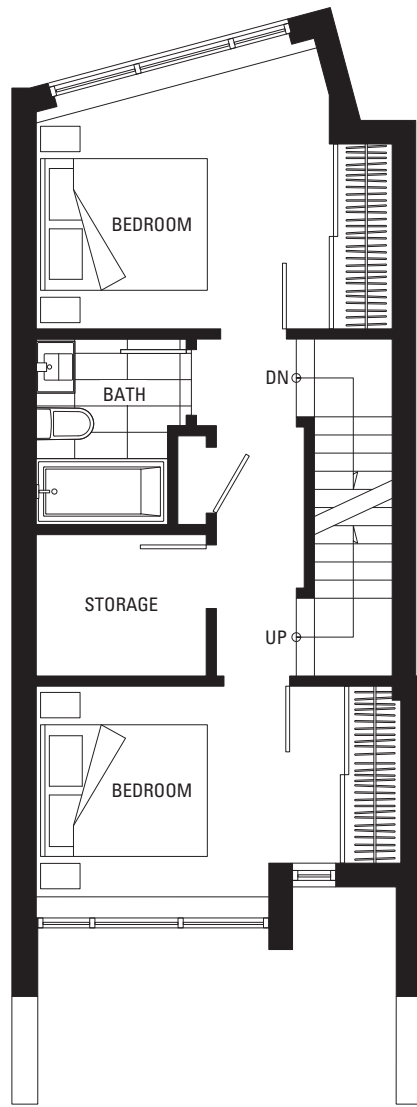

SECOND FLOOR

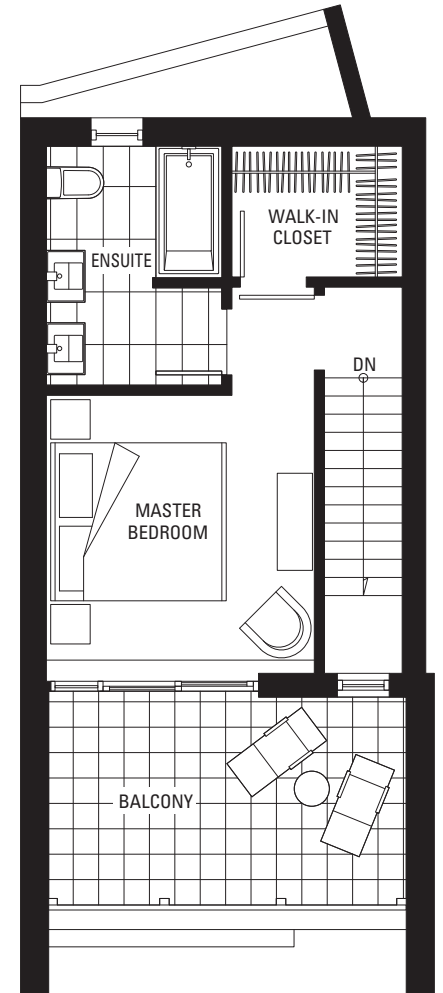

THIRD FLOOR

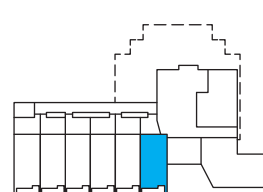

LEVEL 1  
HORNBY STREET

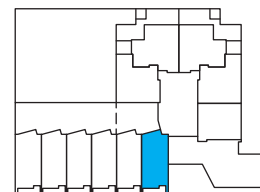

LEVEL 2  
HORNBY STREET

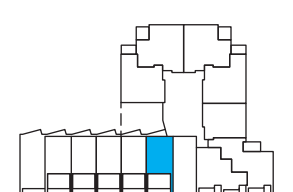

LEVEL 3  
HORNBY STREET

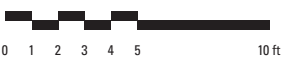

HELMCKEN STREET

HELMCKEN STREET

HELMCKEN STREET



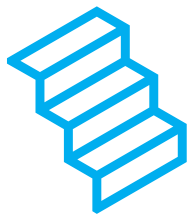

# addition

PLAN THB 1,015 SF

2 Bedroom

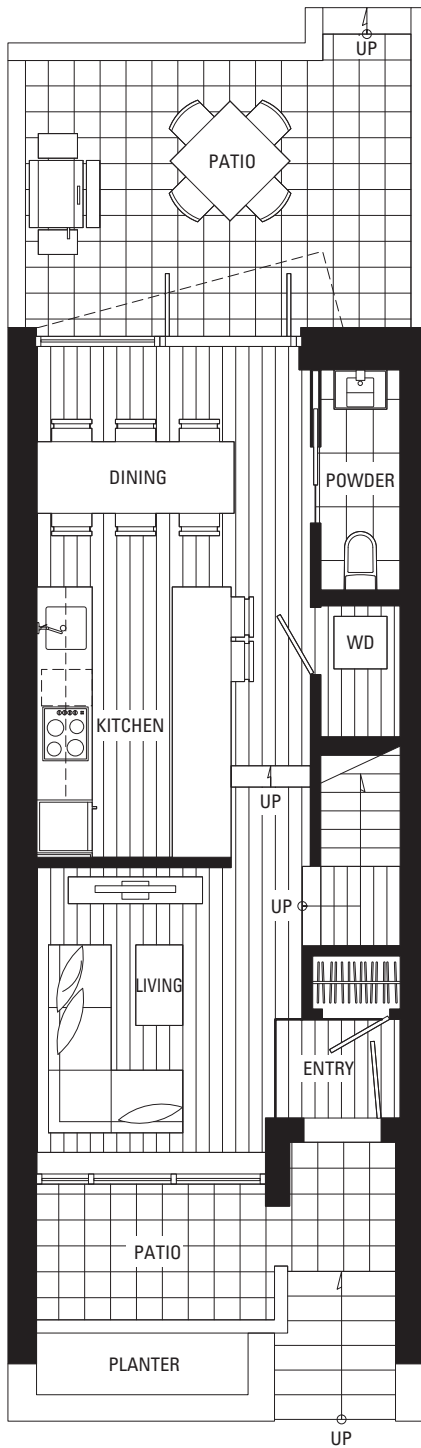

GROUND FLOOR

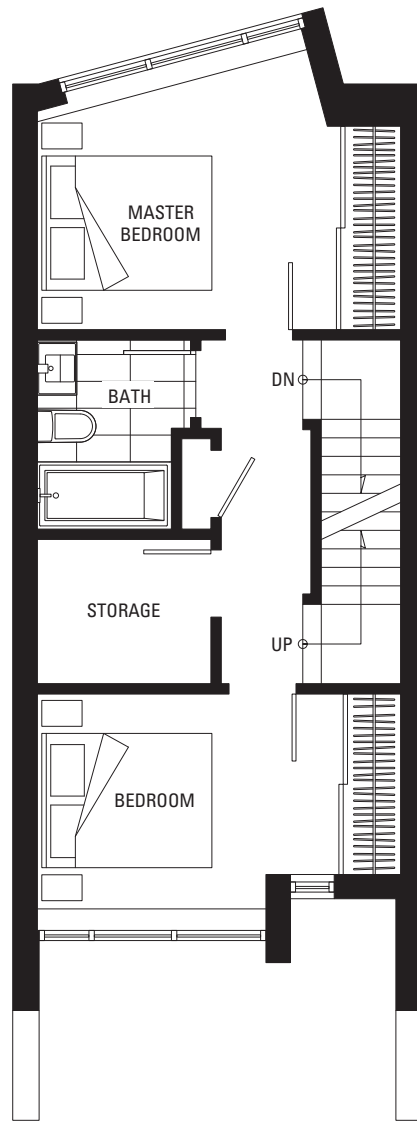

SECOND FLOOR

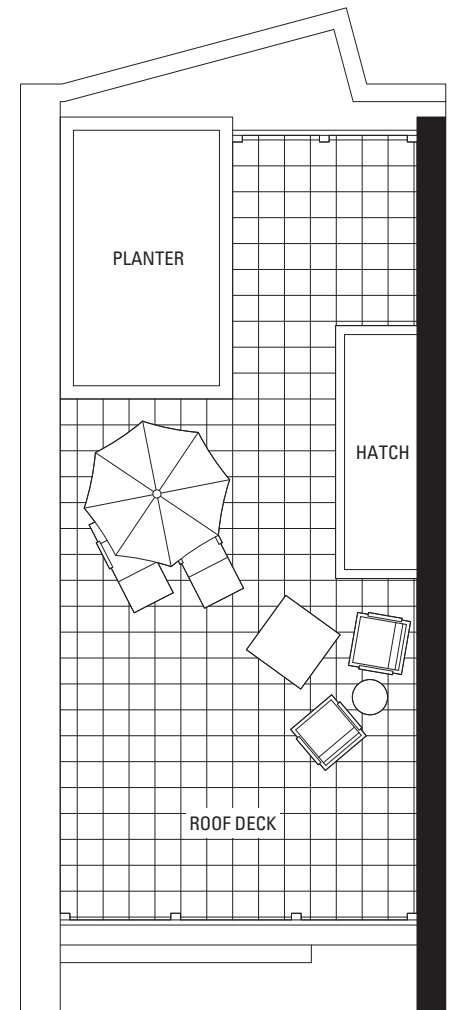

THIRD FLOOR

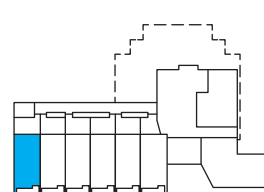

LEVEL 1  
HORNBY STREET

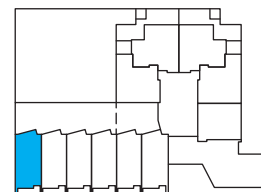

LEVEL 2  
HORNBY STREET



LEVEL 3  
HORNBY STREET

