

GAVIN HUGHES

REAL ESTATE TEAM

LOVE YOUR NEIGHBOURHOOD

2740 Chesterfield Avenue
North Vancouver, BC, V7N 3M4

Year Built: 1996
BC Assessment: 2,932 Sq Ft
Land Size: 7,725 Sq Ft

UPPER FLOOR: 1,148 SQ FT
4 BEDROOMS + 2 BATHROOMS
MAIN FLOOR: 1,665 SQ FT
1 BATHROOM
LOWER FLOOR: 185 SQ FT
TOTAL INTERIOR: 2,998 SQ FT
TOTAL: 4 BEDROOMS + 3 BATHROOM
TOTAL EXTERIOR: 1,636 SQ FT
CRAWLSPACE: 525 SQ FT
DECK: 522 SQ FT
GARAGE: 394 SQ FT
CRAWLSPACE: 195 SQ FT

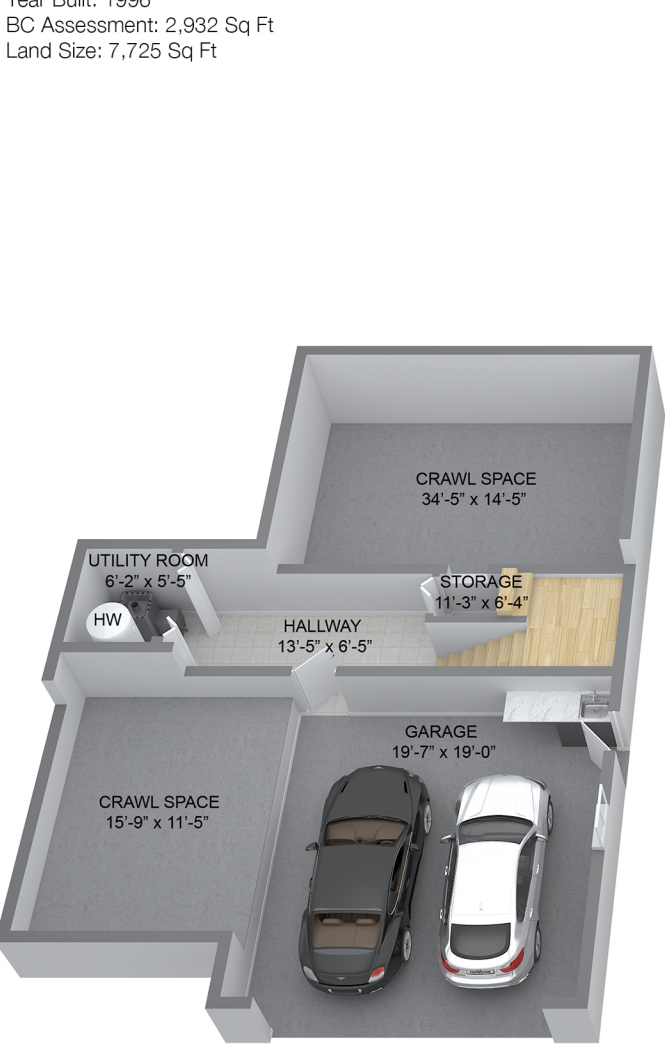

CEILING HEIGHT 6'-9" - 8'-0"
LOWER FLOOR
185 SQ FT

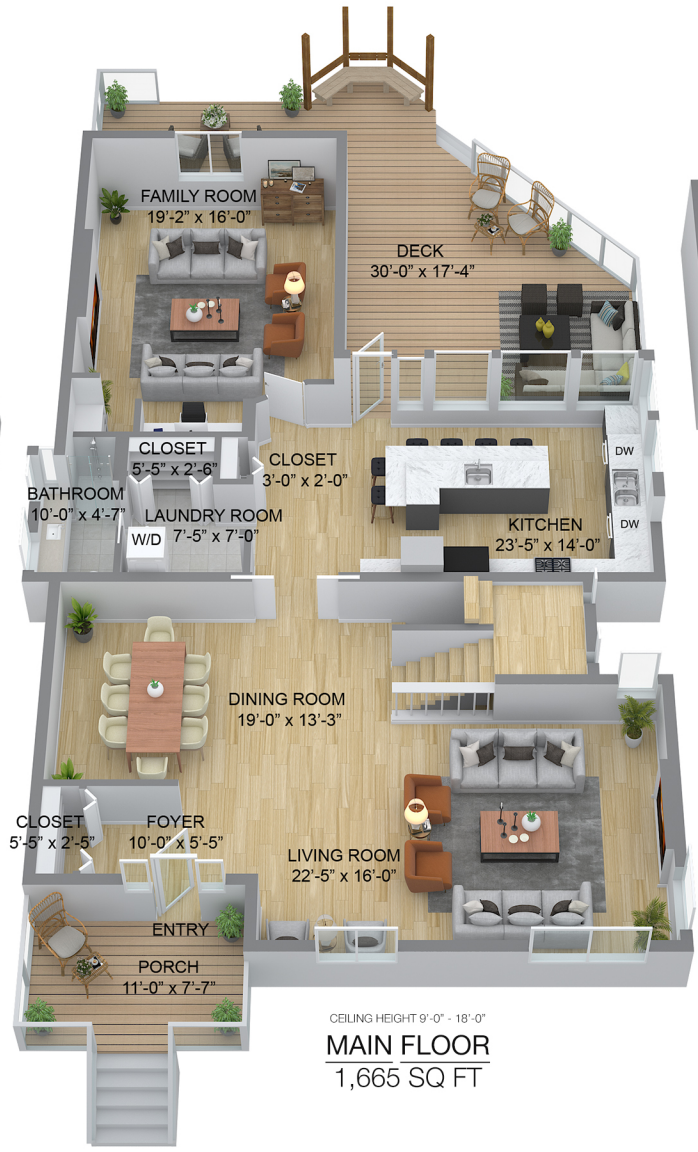

CEILING HEIGHT 9'-0" - 10'-0"
MAIN FLOOR
1,665 SQ FT

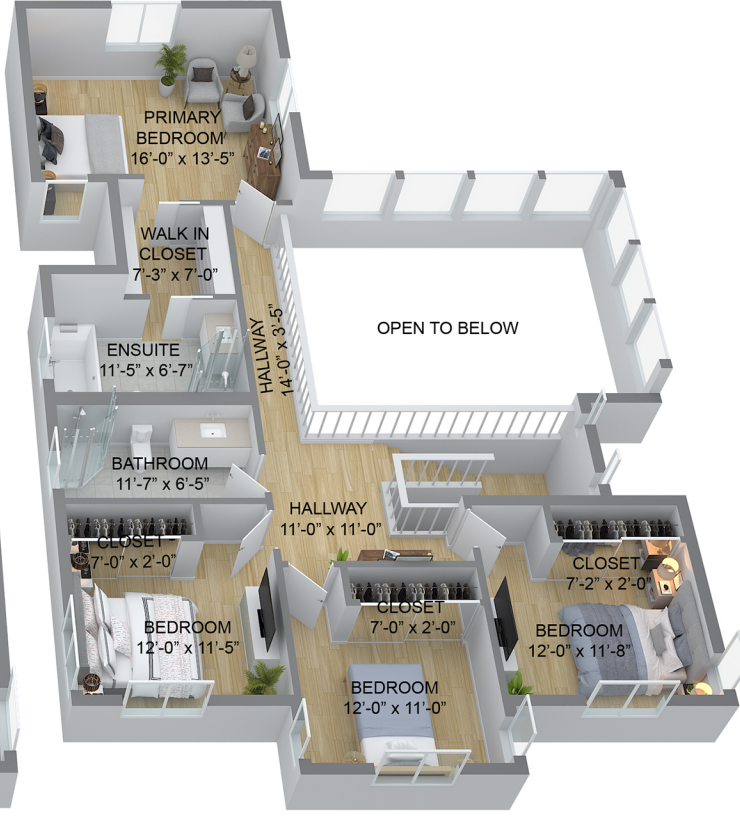

CEILING HEIGHT 8'-0"
UPPER FLOOR
1,148 SQ FT



Developed On: April 3, 2024 - Valid Until: October 3, 2024



This floor plan is intended for marketing purposes only and should not be used nor relied upon for architectural or construction. Total area is based on interior measurements inclusive of exterior walls and open to below areas, while the information contained within this floor plan is deemed to be correct it is not guaranteed. Adding rooms size will not match the total square footage. All efforts are made to ensure dimensions and room sizes are displayed accurately. BC Assessment or other plan may have been used for total square footage. This floor plan is covered under ESO (3% M.O.E) and cannot be reproduced, published, or distributed (in whole or parts) or incorporated with any other work. All room dimensions and floor areas must be considered approximate and are subject to independent verification. All rights reserved for Realty Studios & VLGFS Inc. Six inch walls were used for all floors and the garage and crawlspaces.