

PA 14890

Patent 14890

H

FORM 30 (REVISED)
DEPT. LANDS AND FORESTS
TORONTO, ONTARIO

PLAN AND FIELD NOTES
SUMMER RESORT LOCATION
EB 1774 BEING PART OF ISLAND G 1867
NORTH OF TOWNSHIP OF MORSON
DISTRICT OF KENORA

FILE: 140888

KEY PLAN: SCALE 1 INCH = 40 ch.

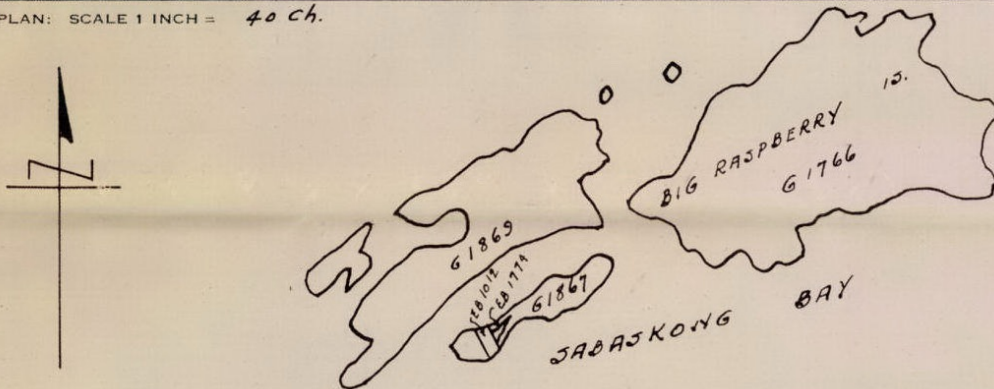

DETAIL PLAN: SCALE 1 INCH = 100'

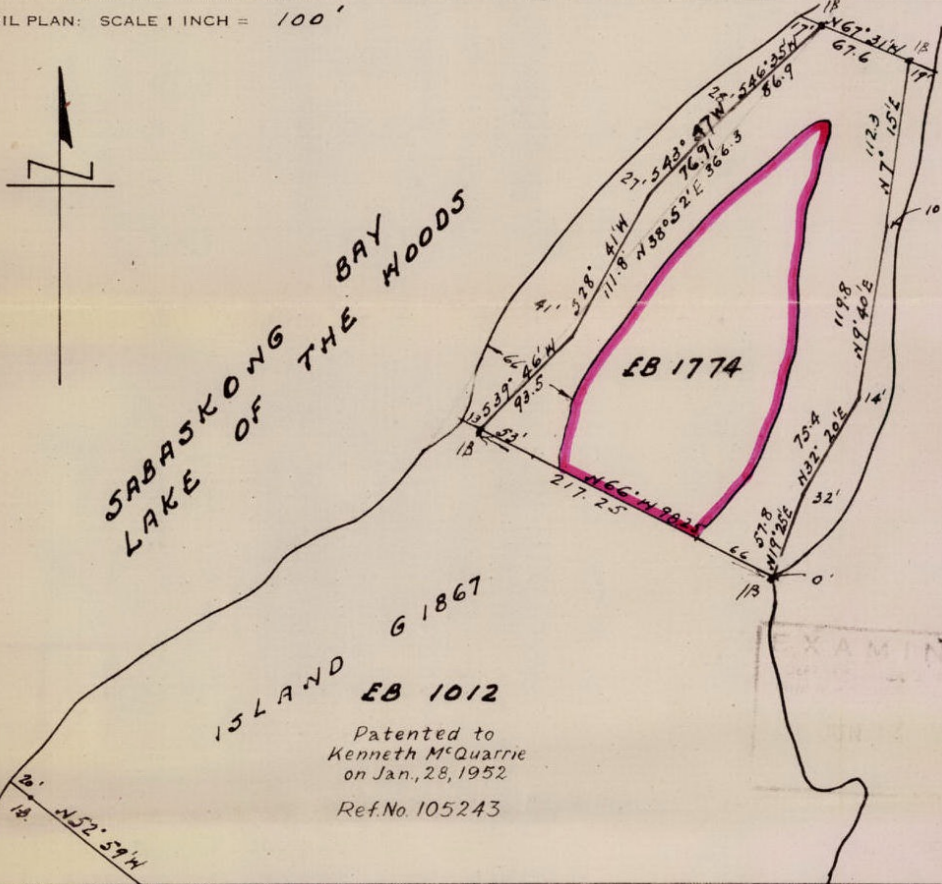

AREA: 0.57 AC.	SHORELINE: Rocky
FRONTAGE: 615'±	TIMBER: J.P. Sp. BALSAM
APPLICANT: F.S. CALLAN	CLOSURE: LAT. 012 DEP. 030
SOIL: Rocky	BEARINGS DERIVED FROM: the Northerly limit of Summer Resort Location EB 1012 having an astronomic course of N66°00'W.
SURVEY POST DATA:	DATE OF COMPLETION OF SURVEY: OCT. 30, 1956

SURVEYOR'S CERTIFICATE
I HEREBY CERTIFY THAT THIS PLAN AND FIELD NOTES ARE CORRECT, AND ARE PREPARED FROM AN ACTUAL SURVEY PERFORMED UNDER MY PERSONAL SUPERVISION, AND THAT I WAS IN MY OWN PROPER PERSON PRESENT ON THE GROUND DURING THE PROGRESS OF SUCH SURVEY.

KENORA, ONTARIO.
OCT 30 19 56

Chris D. Sewell
ONTARIO LAND SURVEYOR