

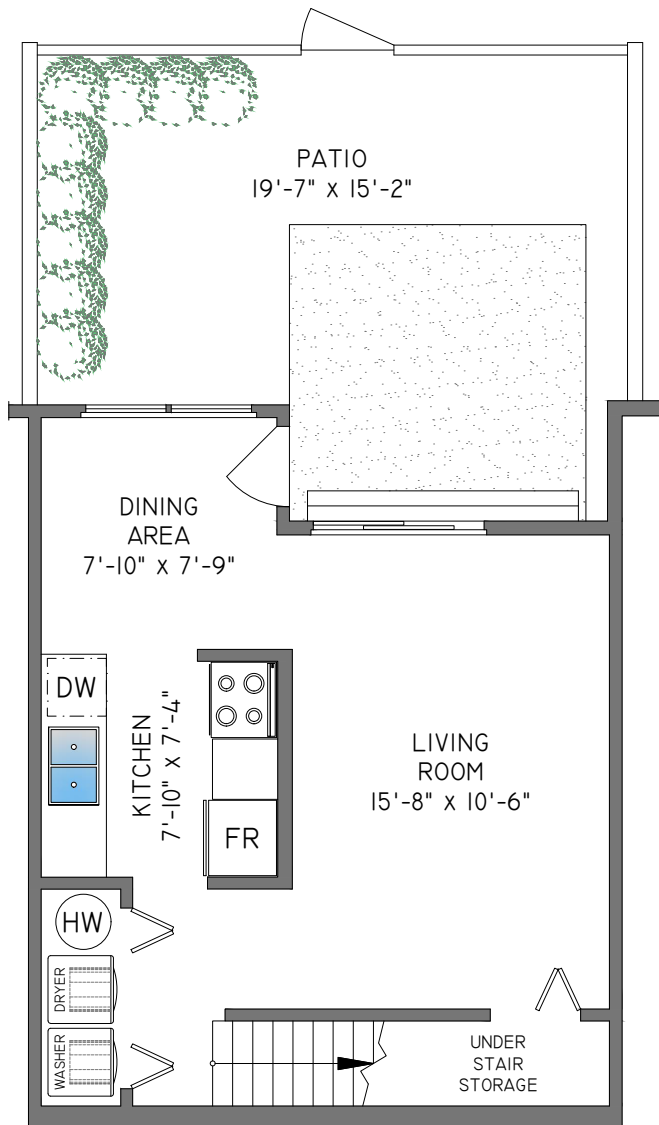

MAIN FLOOR
421 SQ. FT.
 8'-0" CEILING HEIGHT

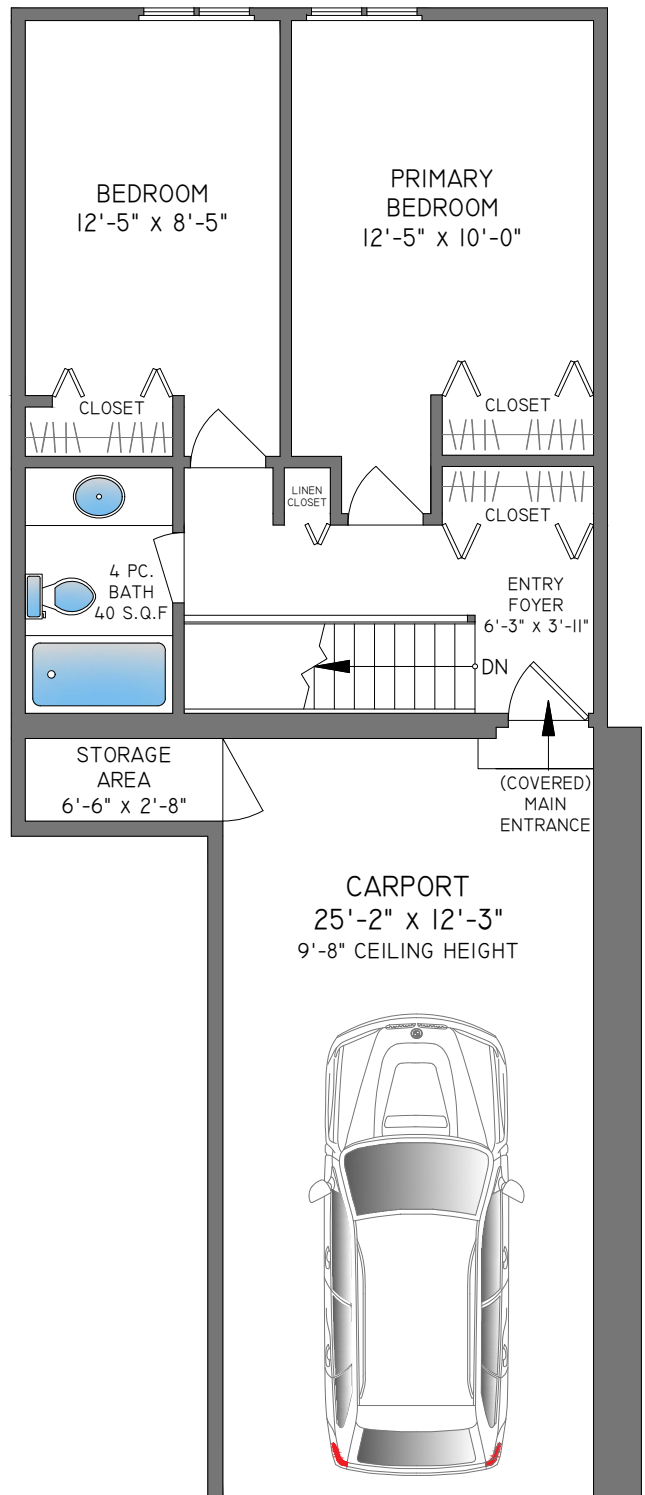

UPPER FLOOR
470 SQ. FT.
 7'-0" - 8'-0" CEILING HEIGHTS



P Booked on the Pixilink App™

8234 ROSSWOOD PLACE, BURNABY

FLOOR	AREA (SQ. FT.)		
	FINISHED	CARPORT	PATIO
MAIN	421	-	268
UPPER	470	344	-
TOTAL	891	344	268



THE REPRESENTED FLOOR PLANS ARE NOT SUITABLE FOR CONSTRUCTION/ARCHITECTURAL PURPOSES. EVERY EFFORT HAS BEEN MADE TO REPRESENT ALL DIMENSIONS ACCURATELY. E&O. ISSUED. FINAL SQUARE FOOTAGE MAYBE OBTAINED FROM STRATA PLAN.