

MAIN FLOOR
1343 SQ. FT.
 8'-0" CEILING HEIGHT

DETACHED GARAGE
578 SQ. FT.

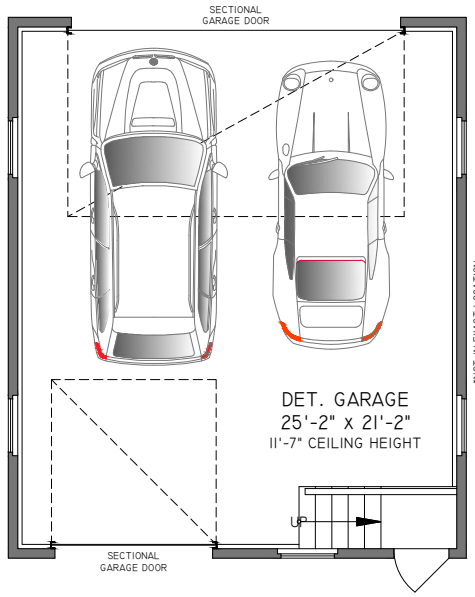

LOWER FLOOR
1343 SQ. FT.
 7'-0" - 8'-0" CEILING HEIGHTS

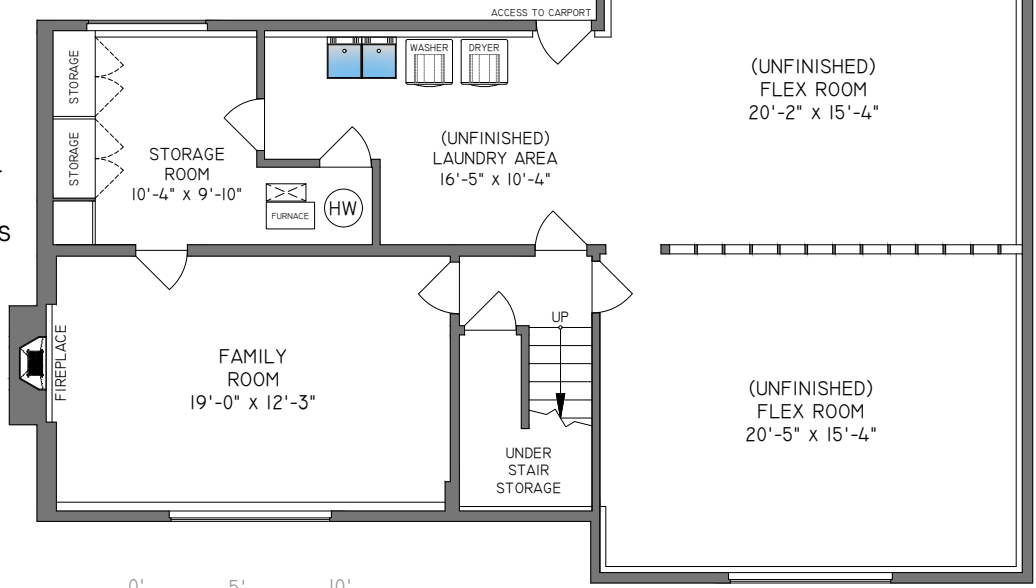

Booked on the Pixilink App™

5020 VENABLES STREET, BURNABY

FLOOR	AREA (SQ. FT.)		
	FINISHED	UNFINISHED	DET. GARAGE
MAIN	1343	-	578
LOWER	514	829	-
TOTAL	1857	829	578
TOTAL SQ.FT. = 2686			



THE REPRESENTED FLOOR PLANS ARE NOT SUITABLE FOR CONSTRUCTION/ARCHITECTURAL PURPOSES. EVERY EFFORT HAS BEEN MADE TO REPRESENT ALL DIMENSION ACCURATELY. E&O INSURED.