

#113 – 3098 Guildford Way, Coquitlam, B.C.

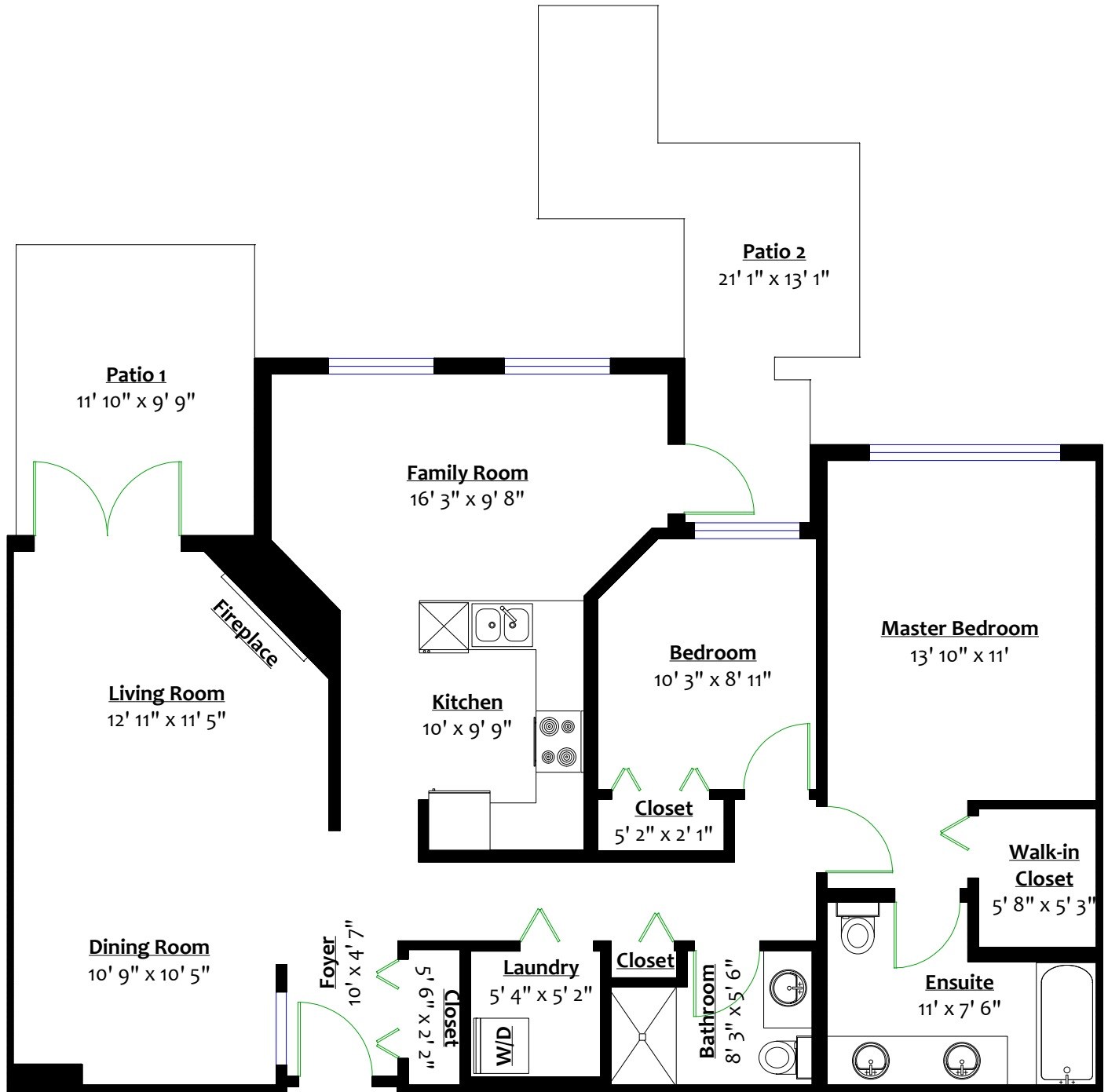

Totals**

Main Level:	1,189 sq. ft.	Patio 1:	115 sq. ft.
		Patio 2:	142 sq. ft.
		Total:	257 sq. ft.



MAIN LEVEL

Floor Area: 1,189 Sq. Ft.



Booked on
the Pixelink App™

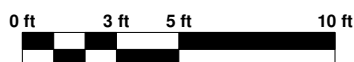

** Approx. based on interior measurements to exterior walls
** Total square footage not taken from original blueprints