



RE/MAX
TREELAND REALTY

RAY BERNIER

BUS: 604-533-3491

**26579 28A AVENUE,
ALDERGROVE, BC**

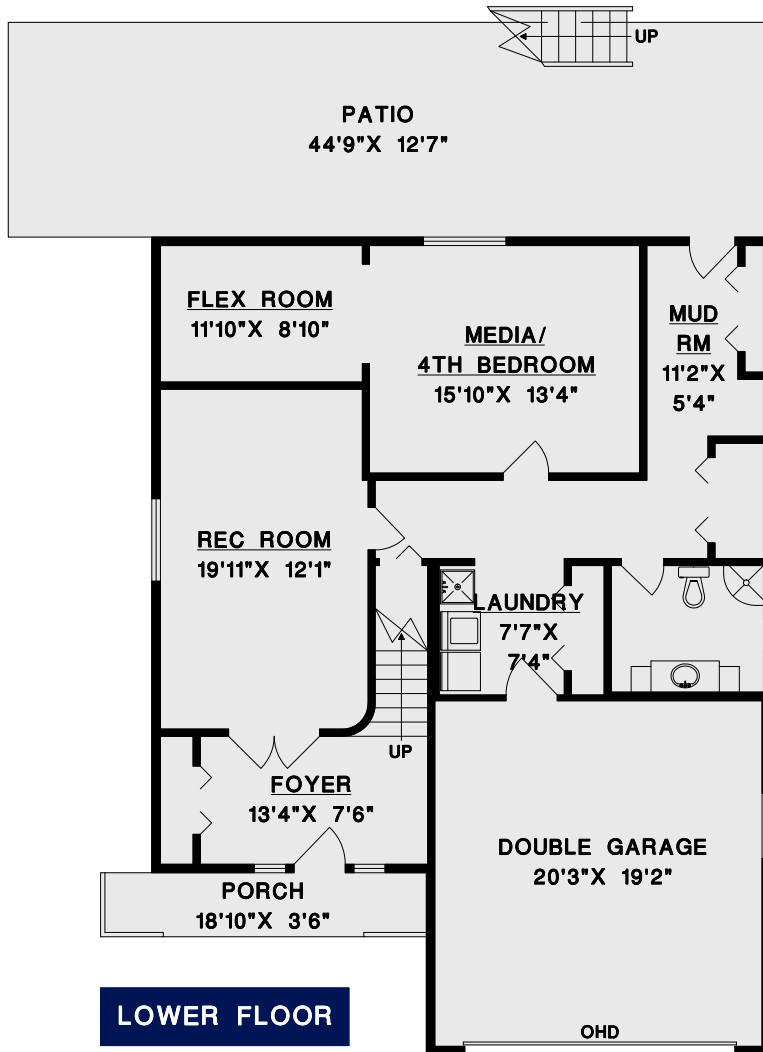

MAIN FLOOR

MAIN FLOOR	1 296	SQ. FT.
LOWER FLOOR	1 154	SQ. FT.
FINISHED AREA	2 450	SQ. FT.

GARAGE	4 15	SQ. FT.
DECK	2 54	SQ. FT.
PATIO	5 63	SQ. FT.
PORCH	7 2	SQ. FT.



DRAWN BY: CN
DATE: SEPTEMBER 2019
REVISED:

