

#54 – 15833 26th Avenue, Surrey

Totals**

Main Level: 549 sq. ft.
 Upper Level: 552 sq. ft.
 Lower Level: 41 sq. ft.
 Top Level: 49 sq. ft.
 TOTAL: 1,191 sq. ft.

Others Areas

Garage: 539 sq. ft.
 Deck: 62 sq. ft.
 Roof Top Deck: 453 sq. ft.
 TOTAL: 1,054 sq. ft.

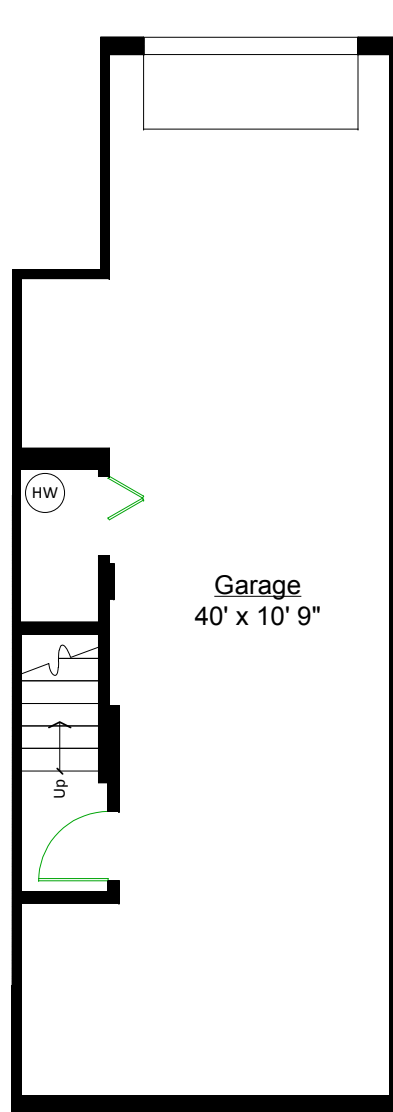

LOWER LEVEL

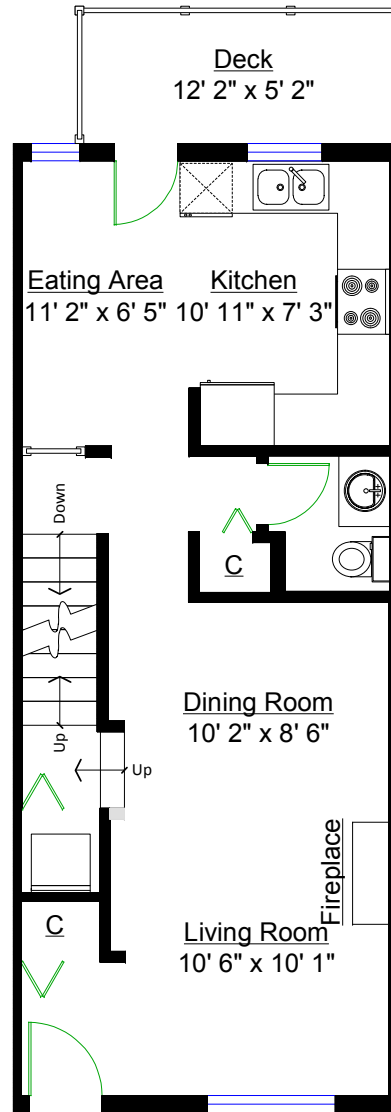

MAIN LEVEL

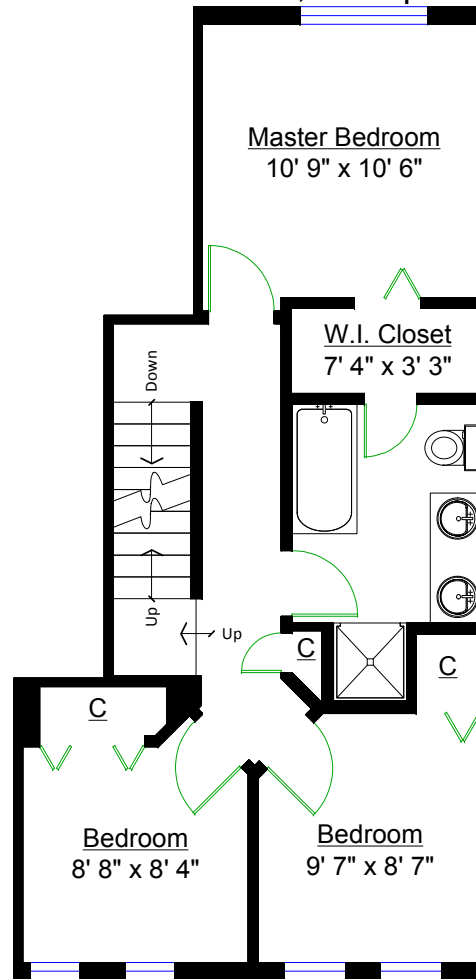

UPPER LEVEL

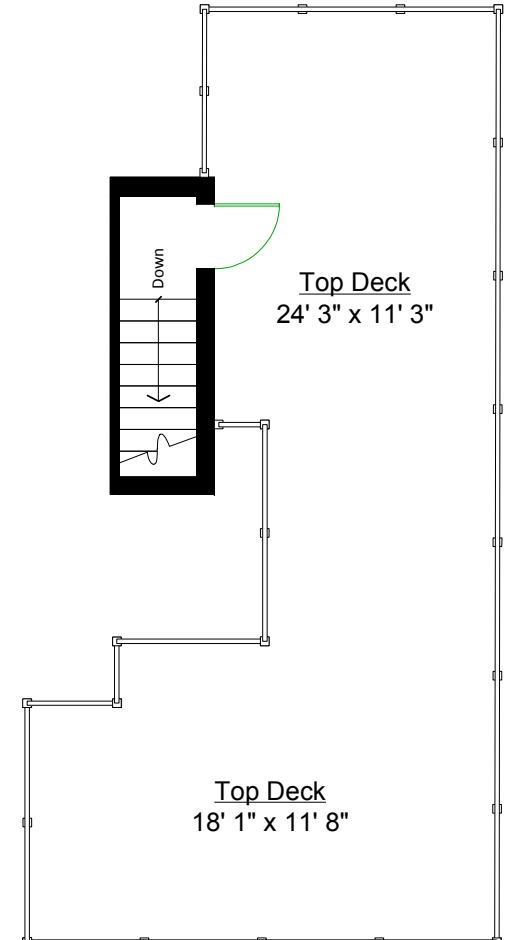

TOP LEVEL