

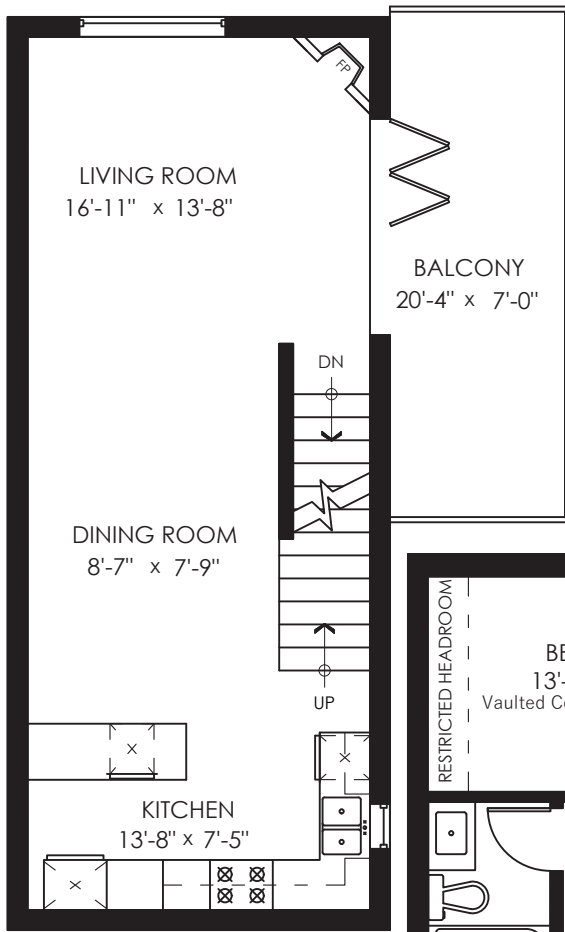

**STONEHOUSE**  
TEAM

Rick Stonehouse PREC\*  
Dwayne Launt PREC\*  
Shaun Gregory PREC\*  
Krystian Thomas

1025 Keefer St.  
Vancouver, BC



Main Floor: 553 Sq.Ft.  
Ceiling Height: 7'-11"

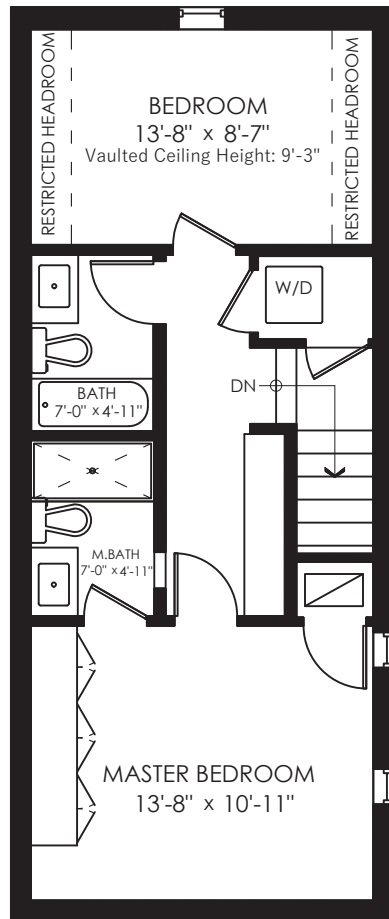

Upper Floor: 507 Sq.Ft.  
Ceiling Height: 8'-1"

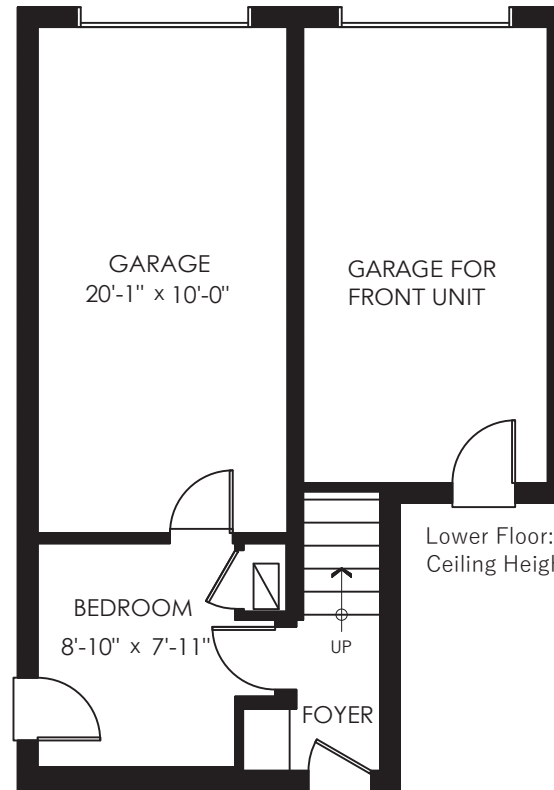

Lower Floor: 163 Sq.Ft.  
Ceiling Height: 7'-11"

Main Floor	553 SQ.FT.
Upper Floor	507 SQ.FT.
Lower Floor	163 SQ.FT.
<b>Total</b>	<b>1223 SQ.FT.</b>

Balcony	147 SQ.FT.
Garage	201 SQ.FT.
<b>Total Extras</b>	<b>348 SQ.FT.</b>

<b>Restricted Headroom</b>	<b>46 SQ.FT.</b>
----------------------------	------------------

