

2302 PARK RIDGE PLACE

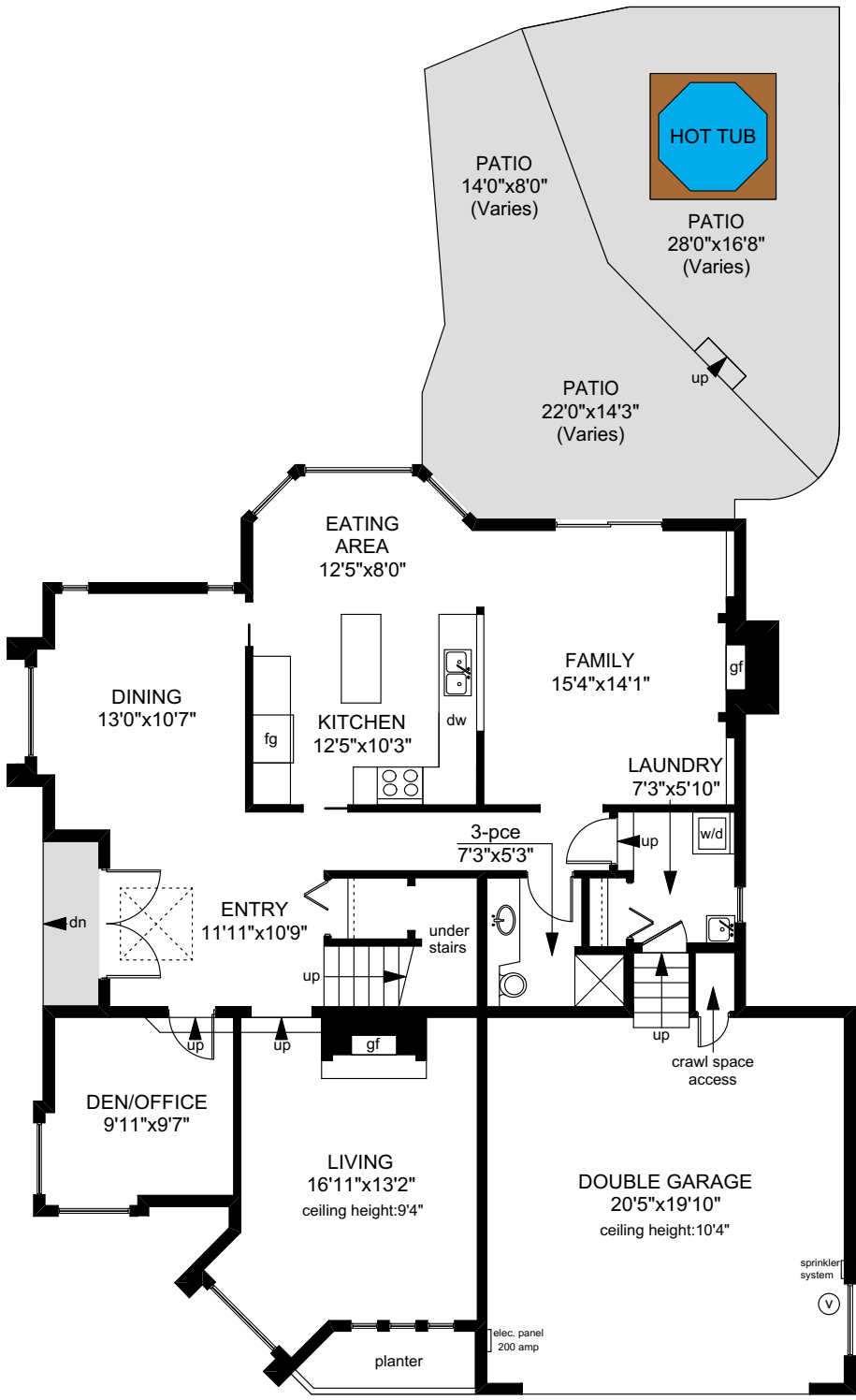

MAIN FLOOR
1415 SQ.FT

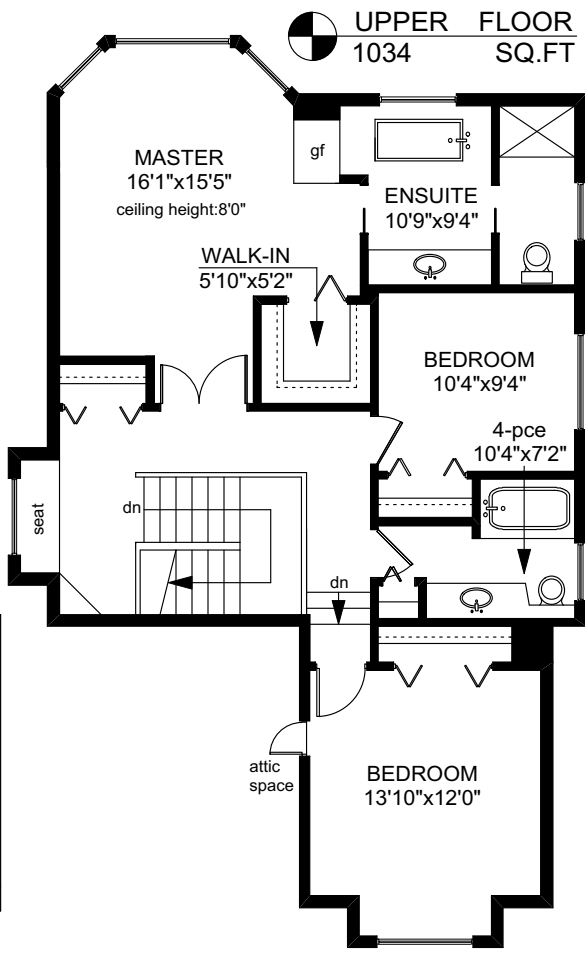

	FINISHED SQ. FT.	UNFINISHED SQ. FT.	TOTAL SQ. FT.
MAIN	1415	0	1415
UPPER	1034	0	1034
TOTAL	2449	0	2449
GARAGE	0	469	469
PATIOS	0	605	605

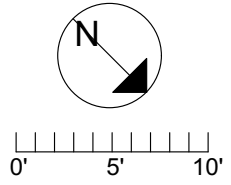

PREPARED FOR THE EXCLUSIVE USE OF
 JASON CRAVEIRO/NICO CRAVEIRO OF
 ROYAL LEPAGE COAST CAPITAL REALTY

MEASURED ON: 06/28/16
 DRAWING FILE: 14060

Tafe Measure VICTORIA, B.C.
 Ph. 883.8894
 www.tafemeasure.com