



Offered at
\$399,000



Lot 49 Lillooet Lake Estates

Live the lake life! This home offers great lake and mountain views and is a very short walk to the beach, it would provide an excellent full time home base or easy recreational getaway. Only a 2.5-hour drive from Vancouver and 50 minutes to Whistler! It is a cozy home and has plenty of potential to personalize and make it your own.

Features

- 2.5 Bedrooms
- 2 Bathrooms
- Lake access
- Airtight wood stove
- Propane furnace
- 21,780 sq ft lot
- Community water
- Private

WHISTLER
REAL ESTATE
COMPANY

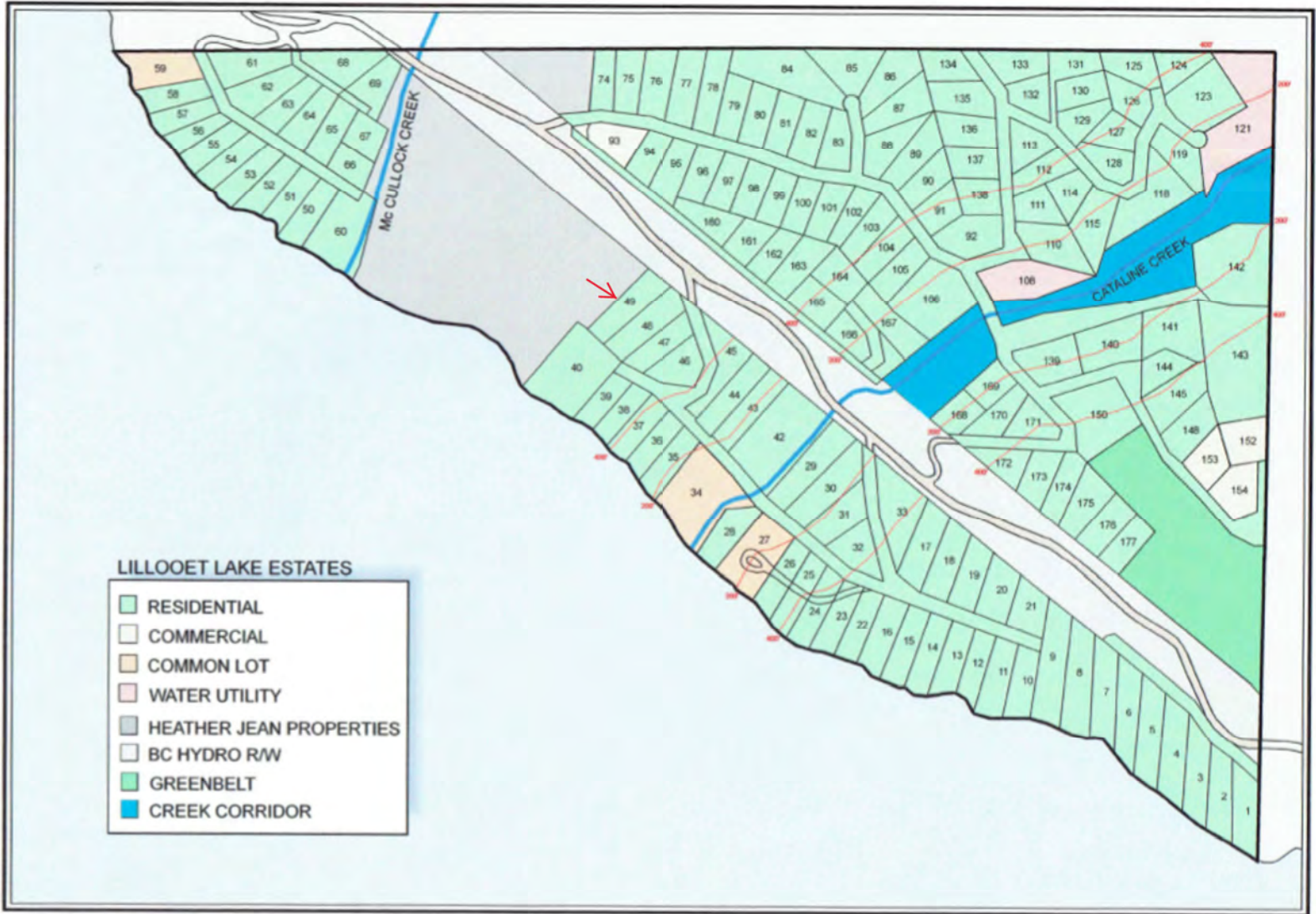

SCALE 1: 5 000

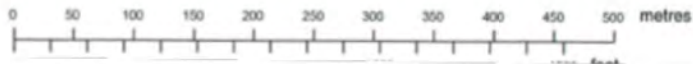

LILLOOET LAKE ESTATES

NUMBER OF SHARES *1*
CERTIFICATE NUMBER 49-A(3)
CLASS "A" Voting Common
PAR VALUE NPV
DATE OF ISSUE Nov 10, 2017

COMPANY LILLOOET LAKE ESTATES LTD.
REGISTERED HOLDER Kathryn Anne Wesley
TRANSFER (OR ALLOTMENT) FROM Transfer from #49-A(2R)
(Hamilton)

CERTIFICATE RECEIVED
DATE 20
Signature _____

CERTIFICATE NUMBER
49-A(3)

CLASS
"A" Voting Common

PAY VALUE
NPV

DATE OF ISSUE
Nov. 10, 2017

TRANSFER OF THESE SHARES IS RESTRICTED

LILLOOET LAKE ESTATES LTD.

THIS CERTIFIES THAT **KATHRYN ANNE WESLEY**

is the registered holder of the number and class of shares described hereon, such shares being fully paid up and non-assessable in the Capital of the Company, and subject to the Notice of Articles and Articles of the Company, transferable on the books of the Company by the registered holder in person, or by Attorney duly authorized in writing, upon surrender of this Certificate properly endorsed.

IN WITNESS WHEREOF the Company has caused this Certificate to be signed by its duly authorized officer(s), and, where required, to be sealed with its common seal, on the date of issue.

The shares represented by this certificate and the benefits accruing to the holder are subject to the provisions of a Land Use Contract made the 8th day of June, 1976 and a Trust Indenture annexed thereto as amended by Agreement dated as of the 1st day of January, 1999 and as may be further amended from time to time.

SOLICITOR

(Title)

NUMBER OF SHARES
1

NUMBER OF SHARES *1*
CERTIFICATE NUMBER 49-B4(3)
CLASS "B4" Non-Voting Common
PAR VALUE NPV
DATE OF ISSUE Nov 10, 2017

COMPANY LILLOOET LAKE ESTATES LTD.
REGISTERED HOLDER
Kathryn Anne Wesley
TRANSFER (OR ALLOTMENT) FROM
Transfer from #49-B4(2R)
(Hamilton)

CERTIFICATE RECEIVED
DATE _____
Signature _____

A BRITISH COLUMBIA COMPANY

CERTIFICATE NUMBER
49-B4(3)

CLASS
"B4" Non-Voting Common

PAR VALUE
NPV

DATE OF ISSUE
Nov. 10, 2017

TRANSFER OF THESE SHARES IS RESTRICTED

LILLOOET LAKE ESTATES LTD.

THIS CERTIFIES THAT **KATHRYN ANNE WESLEY**

is the registered holder of the number and class of shares described hereon, such shares being fully paid up and non-assessable in the Capital of the Company, and subject to the Notice of Articles and Articles of the Company, transferable on the books of the Company by the registered holder in person, or by Attorney duly authorized in writing, upon surrender of this Certificate properly endorsed.

IN WITNESS WHEREOF, the Company has caused this Certificate to be signed by its duly authorized officer(s), and, where required, to be sealed with its common seal, on the date of issue.

The shares represented by this certificate and the benefits accruing to the holder are subject to the provisions of a Land Use Contract made the 8th day of June, 1976 and a Trust Indenture annexed thereto as amended by Agreement dated as of the 1st day of January, 1999 and as may be further amended from time to time.

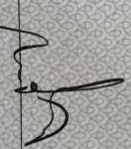
SOLICITOR
(Title)