

Measurement Report

PROPERTY
 4716 Fordham Cres SE, Calgary

CLIENT
 Mike Baylis

MEASUREMENT DATE
 January 31, 2021

JOB #
 017060

Area	Methodology	Value
Total Floor Area Above Grade (RMS Value)	RMS	1,782.7 ft²
Floor Area Main Level	RMS	1,782.7 ft ²
Floor Area Below Grade (Including Basement)	Finished Area	797.0 ft ²
Other Non-RMS Areas (e.g. Separate Structures)	Finished Area	N/A or Not Measured
Finished Area Measured	RMS + Finished Area	2,579.7 ft ²

Room Dimensions

Room	Dimensions	Level	Room	Dimensions	Level
Kitchen	14'4" x 14'10"	Main	Primary Bedroom	15'2" x 12'9"	Main
Dining	12'3" x 12'1"	Main	Walk-in Closet	6'3" x 3'10"	Main
Entry	11'3" x 4'4"	Main	Bathroom 4P	8'8" x 5'7"	Main
Living	20'4" x 13'10"	Main	Storage - Unfinished	7'6" x 3'11"	Basement
Suite - Living	9'4" x 12'3"	Main	Flex Room	7'3" x 7'8"	Basement
Suite - Ensuite 4P	5'0" x 8'8"	Main	Mechanical/Laundry - Unfinished	11'11" x 12'4"	Basement
Suite - Walk-in Closet	5'0" x 5'0"	Main	Bathroom 3P	8'0" x 4'11"	Basement
Suite - Kitchen	10'8" x 17'8"	Main	Bedroom	8'10" x 11'10"	Basement
Suite - Bedroom	14'7" x 9'8"	Main	Bedroom	8'10" x 11'6"	Basement
Deck	10'0" x 24'1"	Main	Family Room	19'10" x 11'7"	Basement
Deck	22'8" x 11'4"	Main			
Deck	9'7" x 19'4"	Main	Detached Garage	45'11" x 23'5"	

Bathrooms

1-Pc Bath	2-Pc Bath	3-Pc Bath	4-Pc Bath	5-Pc Bath	6-Pc Bath
		1	1		
1-Pc Ensuite	2-Pc Ensuite	3-Pc Ensuite	4-Pc Ensuite	5-Pc Ensuite	6-Pc Ensuite
			1		

MEASUREMENT DETAILS

Detached/Attached	Exterior Wall Thickness
Detached	6.5 "

RMS Areas

Level	Total Area	Exclusions	Total Exclusions	RMS Area
Main	1,782.7 ft ²			1,782.7 ft ²
TOTAL				1,782.7 ft²

Non-RMS Areas

Level/Space	Total Area	Unfinished Areas	Total Unfinished	Finished Area
Basement	971.6 ft ²	Storage - 30.2 ft ² Mechanical/Laundry - 144.4 ft ²	174.6 ft ²	797.0 ft ²
TOTAL			174.6 ft²	797.0 ft²

SUPPORTING PLANS

Main

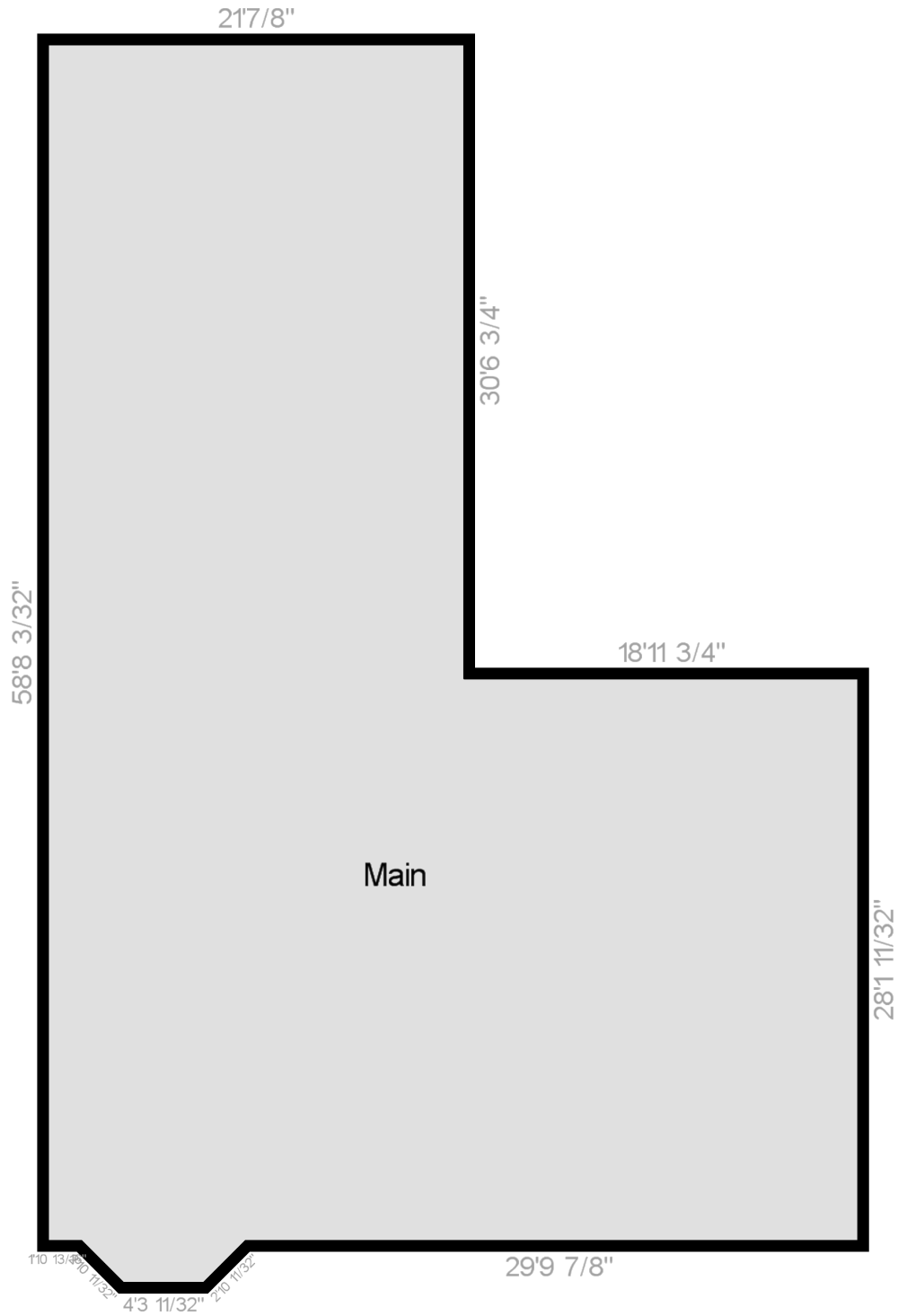

SUPPORTING PLANS

Basement

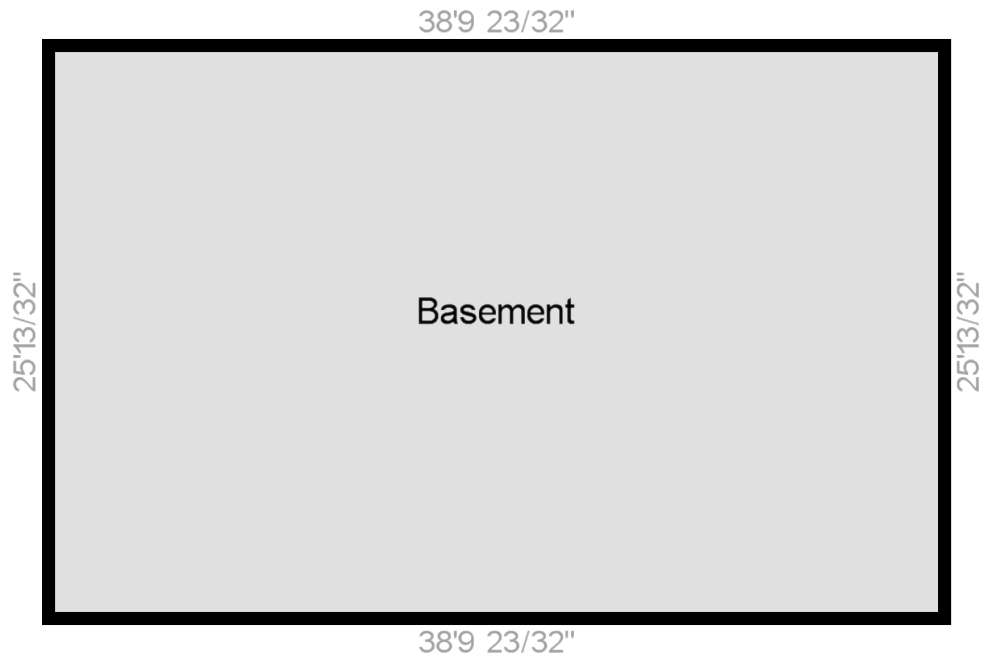

Mechanical/Laundry - Unfinished

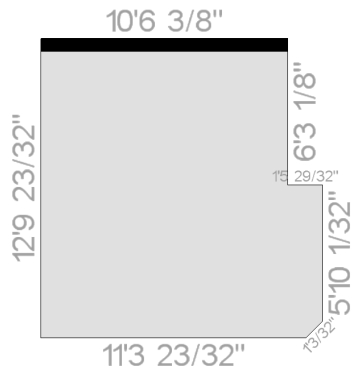

Storage - Unfinished

