

1738 Balaclava Street,
Vancouver, B.C.

Main Floor:	740 sq.ft.
Lower Floor:	625 sq.ft.
Upper Floor:	299 sq.ft.
Total:	1,664 sq.ft.
Restricted H.R.:	46 sq.ft.

Auxiliary Area

Porch:	68 sq.ft.
Deck:	63 sq.ft.
Balcony:	97 sq.ft.

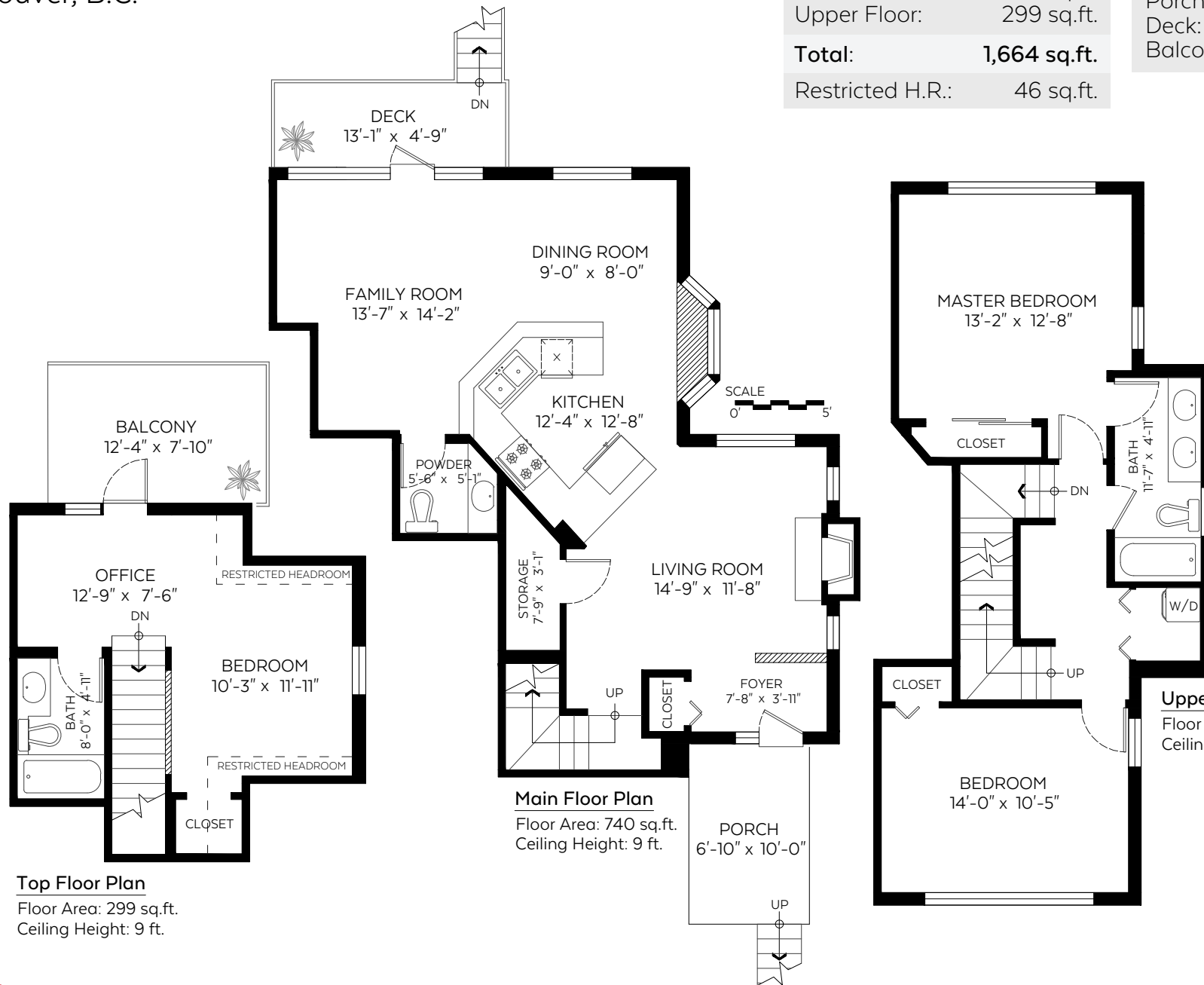

Upper Floor Plan
Floor Area: 625 sq.ft.
Ceiling Height: 8 ft.

Top Floor Plan
Floor Area: 299 sq.ft.
Ceiling Height: 9 ft.

Main Floor Plan
Floor Area: 740 sq.ft.
Ceiling Height: 9 ft.

Valid Until: October 19, 2021



The floor plan is not suitable for architectural/construction and is covered under E&O. © Excelsior Measuring Inc. 2021. All rights reserved for Excelsior Measuring Inc. Users shall not publish and distribute such material (in whole or in part) and/or incorporate it in other works in any form.

