



PIER
WEST

A BOSA PLATINUM ADDRESS

THE FLAGSHIP OF A VIBRANT WATERFRONT COMMUNITY

Pier West, by visionary Bosa Development, is a modern architectural landmark for Metro Vancouver and a striking addition to the New Westminster skyline. The tallest waterfront residential property in the Lower Mainland, Pier West is set within an 11+ acre park on New West's celebrated waterfront boardwalk, connecting the city's vibrant downtown just a block away. Reaching soaring heights of up to 53 storeys, this collection of homes is poised to be the most coveted address in the region.



A COMPLETE WATERFRONT EXPERIENCE



Pier West is more than an addition to the New Westminster skyline. Architecture also engages with the boardwalk at the pedestrian level. The four-acre development complements and completes the public esplanade with extensive additional park space and over 15,000 sf of new waterfront dining, shops and services, creating the place to be in the city.

COMMUNITY & RETAIL

This modern three-storey building includes a 40 space childcare facility as well as space for retail providers at ground level that will enhance the waterfront experience – rent a bike, grab a latté or get a quick bite to eat before strolling the river path.

DOWNTOWN CONNECTIONS

New public pathways connect Pier West and the waterfront to Columbia Street, the heart of downtown New Westminster just a block away, inviting the greater community here.

DESTINATION DINING

The west residential tower features a stunning double height restaurant space, with floor-to-ceiling windows, sun-kissed interiors and a spacious riverfront patio that ensure this is the place to see and be seen on the water.

ART & ARCHITECTURE

Dramatic and engaging architectural details at the boardwalk level enhance the public waterfront experience. These small but significant design details allow the base to be set back, giving a more spacious feel to the ground-level amenities.

CELEBRATED WATERFRONT

This is the final link in New Westminster's award-winning waterfront, connecting Westminister Pier Park with the River Market, and creating 2.5 km of continuous greenspace, viewpoints, playgrounds, benches and art that create one of the best waterfront experiences in Metro Vancouver.

A GREEN OASIS

Over half of Pier West is dedicated back to the city as an extension to Westminister Pier Park, resulting in 11+ acres of pathways, green space and lush landscaping that will be a green oasis for residents, and an inviting destination for the community. Pier West is not near a park, it's in one.



A MEMORABLE ARRIVAL AND AN INSPIRED ENTRANCE

Surrounded on all sides by Westminster Pier Park, the private entrance lobby at Pier West is a stylish and welcoming extension of your living space. This is the starting point for a lifestyle that emphasizes comfort, elegance and ease. Your double-height, glass-walled lobby is attended 24 hours a day to receive and safely store deliveries while you're out, and assist with anything else you need to support your lifestyle. From amenity bookings and coordinating utility appointments to dry cleaning services or calling a taxi, everything you need is here.



THE OWNERS' CLUB

INSPIRED BY THE BEST PRIVATE CLUBS, THIS IS A NATURAL EXTENSION OF YOUR HOME Each tower features an Owners' Club; a dramatic two-storey space with an exclusive amenities collection designed to elevate everyday living. Central to each space, the lounge is ideal for catching the big game on large-format screens, spending some quiet time by the fireside, or making new connections with your neighbours. You've got the perfect place to mix classic cocktails, coordinate a catered party and host friends for unforgettable all-day or evening happenings.



PRIVATE DINING

Adjacent to the lounge is an elegantly designed private dining room, with a full kitchen featuring top-of-the-line, chef-inspired Wolf gourmet appliances. The kitchen connects to a private deck with views of the river and a custom built-in bbq. Whether you want to grill the perfect filet mignon or hire a celebrity chef to create an exclusive meal for 20, everything is here to create unforgettable memories. This is the epitome of luxurious entertaining.



HEALTH AND WELLNESS

The high-performance fitness facility will get your heart rate up, while a serene yoga and stretching space will help you find your zen. Fitness spaces are complemented by a co-ed steam room and sauna, and fully-equipped change rooms. Exceptional water views add inspiration at any time of day or night.



OUTDOOR LOUNGE SPACES WITH WATERFRONT VIEWS

Waterfront is the ultimate, irreplaceable luxury. Expansive outdoor lounges with unobstructed riverfront views are the crown jewel of the Owner's Club and are reserved for the exclusive use of residents and your guests. The dramatic double-height lounge opens seamlessly to outdoor space designed to maximize views and create intimate areas to relax in private or to meet and socialize with friends old and new. In this unforgettable setting, hovering over the waterfront, you can take in the happenings of the boardwalk, watch the sunset over the river, or cozy up beside the fire at day's end.



PIER WEST | PROJECT OVERVIEW

JANUARY 12, 2018



DEVELOPER	Bosa Development	
ARCHITECT	Hossein Amanat Architect	
NUMBER OF HOMES	West Tower: 364 units East Tower: 301 units Total: 665 units	
CONSTRUCTION	Two residential towers of 53 and 43 storeys	
ELEVATORS	4 per tower	
SIZE RANGES	TYPICAL	
	1 Bedroom & 1 Bedroom with Flex	580 - 650 sf
	2 Bedroom	860 - 1,005 sf
	2 Bedroom + Den	1,190 - 1,230 sf
	3 Bedroom	1,185 sf
	SKY	
	1 + Den	800 sf
	2 Bedroom	950 - 1,350 sf
	2 Bedroom + Den	1,260 - 1,495 sf
	Sub PH & PH	TBD
	Limited offering of park townhomes	1,400 - 1,800 sf
SPECIAL FEATURES	<ul style="list-style-type: none"> · Air conditioning · Ceiling height over 9' · Kitchens designed by Inform Interiors · Interior design by BBA Design · Premium Bosch appliance package throughout · Quartz waterfall countertop · Sizable balconies 	
AMENITIES	<p>Over 10,000 sf of combined amenity space, with each building offering:</p> <ul style="list-style-type: none"> · 24-hour concierge to assist with amenity bookings, utility appointments, dry cleaning services, and ordering a taxi · The Owners' Club - lounge · Elegantly designed dining room · Full kitchen featuring Wolf gourmet appliances · State of the art BBQ · Outdoor lounge with views · High-performance fitness facility, yoga and stretching space · Fully-equipped change rooms · Steam room and sauna <p>15,000 sf of commercial space, including:</p> <ul style="list-style-type: none"> · Childcare facility · 7,000 sf of waterfront dining · Shops and retail 	
	Located within the new 11+ acre Westminster Pier Park completing 2.5 km of boardwalk	

ESTIMATED COMPLETION Early 2022

660 QUAYSIDE TYPICAL COLLECTION DRAFT

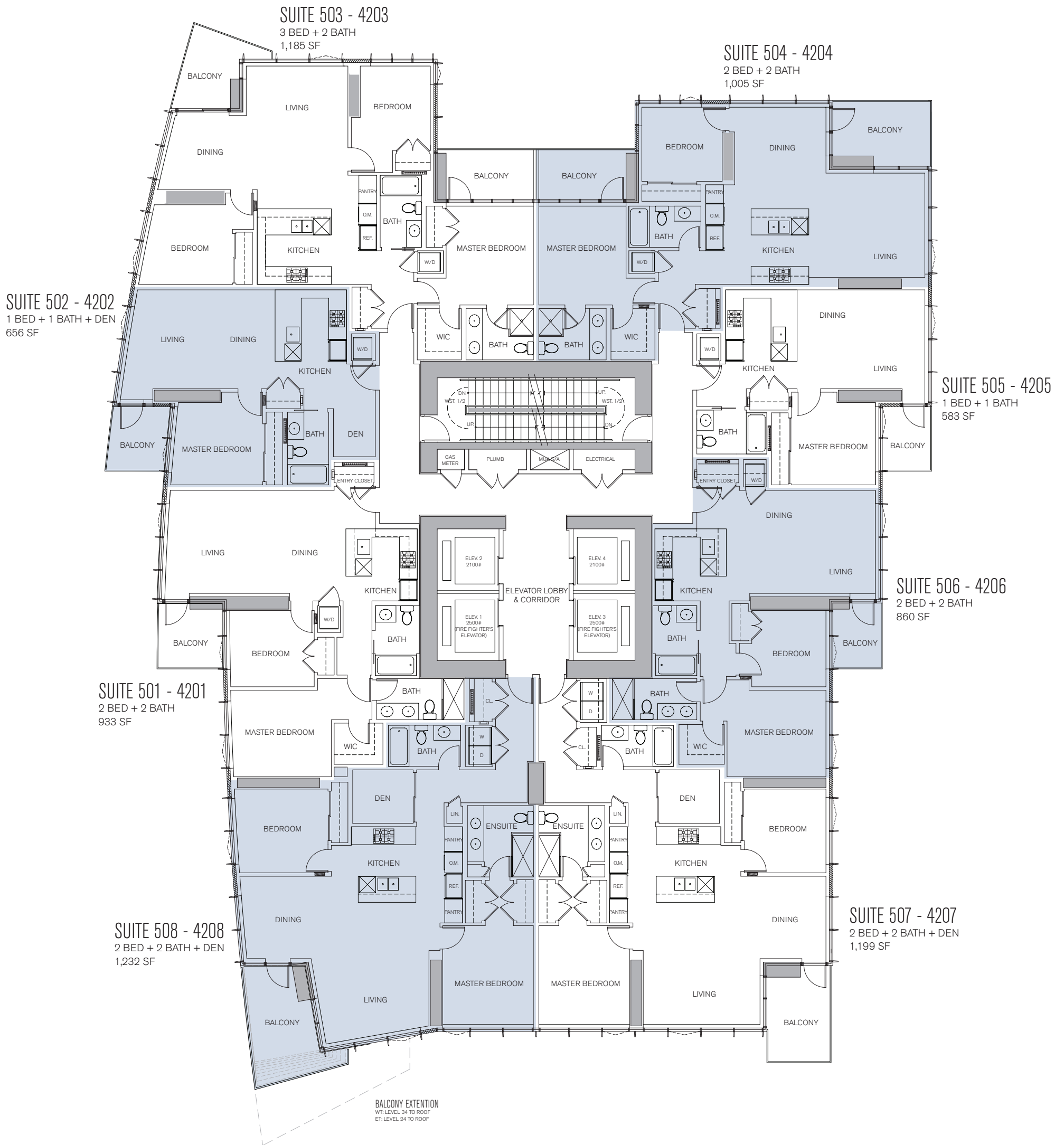

660 QUAYSIDE SKY COLLECTION DRAFT

