

Note: The lands shown in grey shading on this schedule are currently situated within the Development Control Area of the Niagara Escarpment Commission.



Chatsworth ZONING SCHEDULE 19

By-Law No. 2015 - 61
 Date Passed November 18, 2015
 Mayor Original Signed
 Clerk Original Signed

- A1 Rural
- A2 Restricted Rural
- C1 General Commercial
- C2 Rural Commercial
- C3 Local Commercial
- I Institutional
- M1 General Industrial
- M2 Rural Industrial
- M3 Extractive Industrial
- M4 Local Industrial
- OS1 Open Space 1
- OS2 Open Space 2
- R1 Rural Residential
- R2 Urban Residential
- R3 Lake Residential
- R4 Multiple Residential
- T Tent and Trailer Campground
- NEP NEP
- Wetlands Protection Wetlands Protection
- Environmental Protection Environmental Protection
- No Development No Development

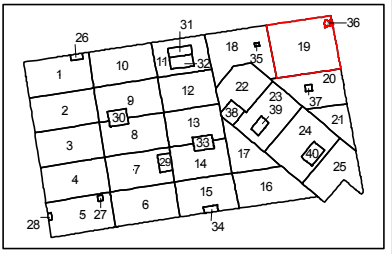

Scale: 25,000
 Grey County - November 18, 2015