

810 - 220 Missinnihe Way

Stylish, Brand New 1 Bedroom + Den, 1 Bathroom Lakeview Suite with Parking/Locker at Brightwater II in Port Credit Village Fab Locale! Steps to Lake Ontario, J.C. Saddington Park, Waterfront Trails, Shopping, Restaurants, GO Station/Future LRT, Farm Boy+++

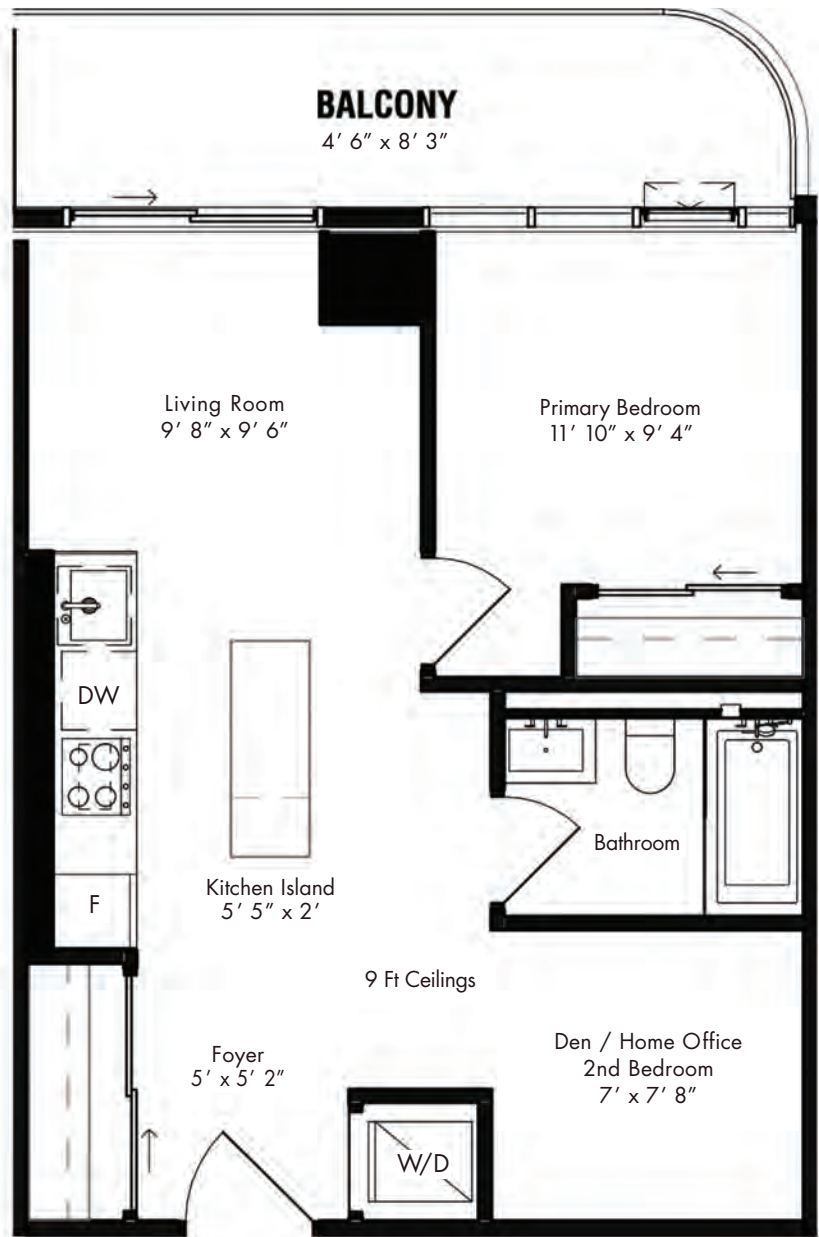

Scan For HD Video Tour
& More Information

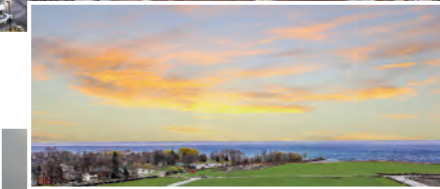

JeffJohnston.com

Sales Representative, B.A., SRS, ABR
RE/MAX Lifetime Achievement - RE/MAX Hall of Fame
RE/MAX Titan Team Award - RE/MAX Chairman's Club
RE/MAX Platinum Club - Top 1% Gross Condo Sales

Tel 416.203.6636

Cell 647.284.5333

web www.jeffjohnston.net email jeff@jeffjohnston.net

RE/MAX CONDOS PLUS
CORP. BROKERAGE
45 Harbour Square, Toronto, Ontario M5J 2G4