

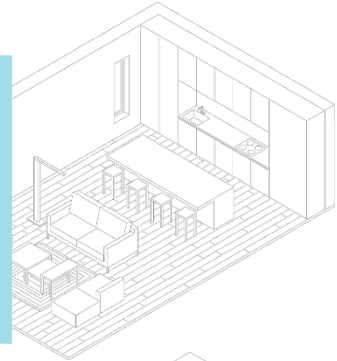

Address 1 - 2406 17a Street SW, Calgary, AB
Date January 20, 2020
Name Chase Olsen | Re/Max First
Email chase@chasinghomes.ca
Phone 403.606.0340

FLOOR TOTALS

Main Level	499.90 sqft / 46.44 m2	Exterior Assumption	
Upper Level	501.33 sqft / 46.57 m2	Main Level	549.15 sqft / 51.02 m2
RMS Total	1001.23 sqft / 93.01 m2	Upper Level	551.24 sqft / 51.21 m2
Basement Total	432.61 sqft / 40.19 m2	Total	1100.39 sqft / 102.23 m2
*Finished Total	354.35 sqft / 32.92 m2	Basement Total	513.23 sqft / 47.68 m2
Total w/Basement	1433.84 sqft / 133.20 m2	*Finished Total	434.97 sqft / 40.41 m2
Order Procedure	RECA RMS	Total w/Basement	1613.62 sqft / 149.91 m2
Order Type	Attached Single Family	Exterior Wall Size	2 X 6



ROOM DIMENSIONS

Kitchen	11'8" X 10'3" ft/in	M	Utility / Laundry	10'0" X 6'10" ft/in	B
Dining Area	8'10" X 7'9" ft/in	M	Wet Bar	10'2" X 4'7" ft/in	B
Living Room	12'6" X 12'6" ft/in	M	Patio	13'0" X 10'6" ft/in	M
Family Room	10'6" X 9'8" ft/in	B			
Foyer	4'6" X 3'8" ft/in	M			
Rec Room	13'8" X 8'7" ft/in	B			



BEDROOM DIMENSIONS

Master	12'10" X 11'2" ft/in	U	Additional	0'0" X 0'0" ft/in	NA
Bedroom Two	11'4" X 9'9" ft/in	U			

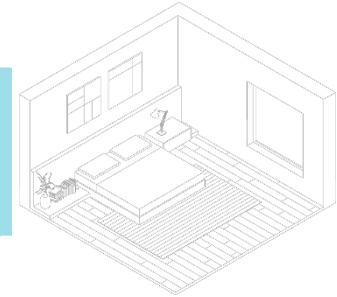

BATHROOM PIECES AND ADDITIONAL ROOMS

0 - One Piece	NA	Additional	0'0" X 0'0" ft/in	NA
1 - Two Piece	M			
1 - Three Piece (Ensuite)	U			
1 - Four Piece (Ensuite)	U			
0 - Five Piece	NA			

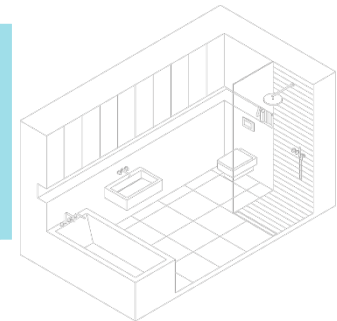

*Insured measurements are based on local guidelines.