

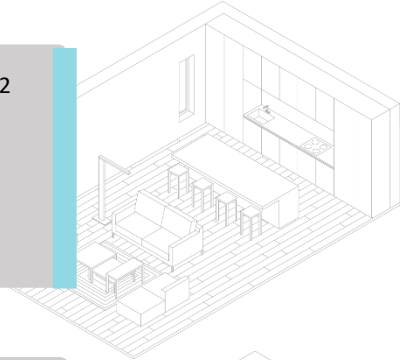

Address 4208 – 279 Copperpond Common SE, Calgary, AB
Date April 15, 2021
Name Chase Olsen | Re/Max First
Email chase@chasinghomes.ca
Phone 403.606.0340

FLOOR TOTALS

Main Level	803.73 sqft / 74.66 m2	Total Size	803.73 sqft / 74.66 m2
Upper Level	000.00 sqft / 00.00 m2	Order Procedure	RECA RMS
Lower Level	000.00 sqft / 00.00 m2	Exterior Wall Size	NA
Finished Total	000.00 sqft / 00.00 m2	Order Type	Conventional Condo



ROOM DIMENSIONS

Kitchen	12'8" X 8'5" ft/in	M	Laundry	3'4" X 3'0" ft/in	M
Dining Area	0'0" X 0'0" ft/in	M	Utility Room	0'0" X 0'0" ft/in	NA
Living/Dining	16'0" X 12'6" ft/in	M	Storage Room	0'0" X 0'0" ft/in	NA
Family Room	0'0" X 0'0" ft/in	NA	Balcony	11'0" X 6'3" ft/in	M
Foyer	0'0" X 0'0" ft/in	NA	Porch	0'0" X 0'0" ft/in	NA
Mud Area	0'0" X 0'0" ft/in	NA	Garage	0'0" X 0'0" ft/in	NA



BEDROOM DIMENSIONS

Master	12'0" X 9'9" ft/in	M	Bedroom Five	0'0" X 0'0" ft/in	NA
Bedroom Two	12'4" X 8'10" ft/in	M	Bedroom Six	0'0" X 0'0" ft/in	NA
Bedroom Three	0'0" X 0'0" ft/in	NA	Bedroom Seven	0'0" X 0'0" ft/in	NA
Bedroom Four	0'0" X 0'0" ft/in	NA	Bedroom Eight	0'0" X 0'0" ft/in	NA

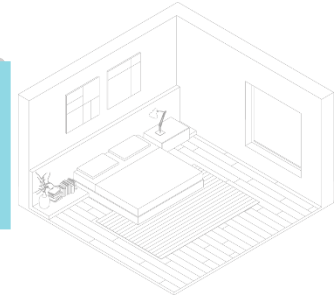

BATHROOM PIECES AND ADDITIONAL ROOMS

Two Piece	0'0" X 0'0" ft/in	M	Two Piece	0'0" X 0'0" ft/in	NA
Three Piece	8'0" X 5'0" ft/in	M	Three Piece	0'0" X 0'0" ft/in	NA
Four Piece	8'6" X 8'1" ft/in	NA	Four Piece	0'0" X 0'0" ft/in	NA
Five Piece (Ensuite)	0'0" X 0'0" ft/in	NA	Five Piece	0'0" X 0'0" ft/in	NA

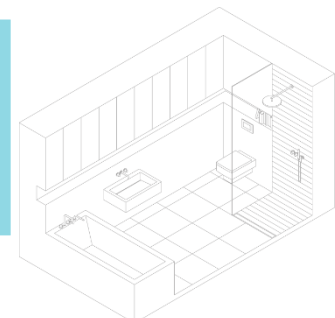

*Insured measurements are based on local guidelines.