

**B.C. Land Surveyor's Building Location Certificate
Showing Location of Foundation Situated on
Strata Lot 4, (PID 028 031 326), Sections 108
and 109, Esquimalt District, Strata Plan VIS6842.**

Scale 1:250

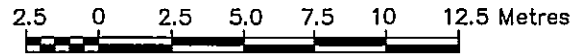

Legend:

All distances are in metres and decimals thereof unless otherwise indicated.
Dimensions are derived from Land Title Office records.

The following documents are registered on title and may affect the location of improvements.

Covenants:

FB291698, FB291701, FB291717

Statutory Rights of Ways:

FA141812, FA141813, FB63634

Easement:

FB291731



This plan was prepared for municipal purposes and is for the exclusive use of our client. This document shows the relative location of the surveyed structures and features with respect to the boundaries of the parcel described above. This document shall not be used to define property lines or property corners. This building location certificate has been prepared in accordance with the Manual of Standard Practice and is certified correct this 16th day of April 2010.

B.C.L.S.

This document is not valid unless originally signed and sealed
COPYRIGHT © Michael J. McIlvaney B.C.L.S. 2010

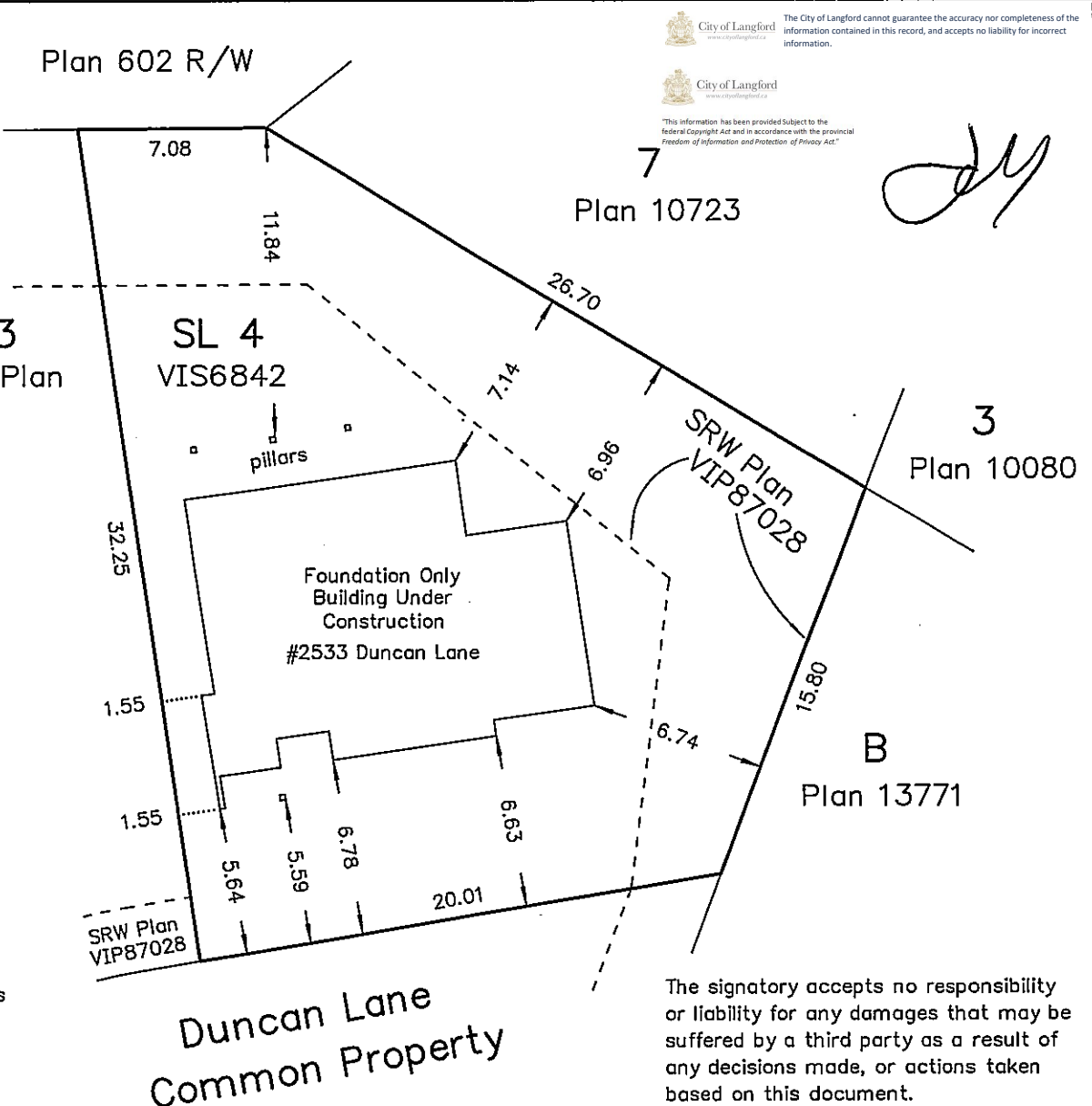

City of Langford
The City of Langford cannot guarantee the accuracy nor completeness of the information contained in this record, and accepts no liability for incorrect information.
City of Langford
This information has been provided Subject to the federal Copyright Act and in accordance with the provincial Freedom of Information and Protection of Privacy Act.

The signatory accepts no responsibility or liability for any damages that may be suffered by a third party as a result of any decisions made, or actions taken based on this document.
All rights reserved. No person may copy, reproduce, transmit or alter this document in whole or in part without the consent of the signatory.

ENTERED

**Michael J. McIlvaney
Land Surveying Inc.**
#113 - 2244 Sooke Road
Victoria, B.C. V9B 1X1
(250) 474-5538

File: 4203BLC
Client: Krupa