

MANUFACTURER INFORMATION/ INFORMATION DU MANUFACTURIER

MANUFACTURER/ Fabricant: **TRIPLE "M" HOUSING**
DATE OF MANUFACTURE/ Date du fabricant: **MARCH / 2017**
FACTORY ADDRESS/ Adresse de l'usine: **LETHBRIDGE, ALBERTA**

PROJECT NAME OR MODEL NUMBER: **MRD1460-8736-C**
MODULE SERIAL NUMBER OR PRODUCT CODE: **560-008-736**
CSA A277 CERTIFICATION LABEL NUMBER / CSA A277 étiquette de certification QAI numérotée: **#007675 / B.C. #101488**

DESIGN DATA/ DONNÉES DE CONCEPTION

PRODUCT TYPE: Type de produit (choisir un seul)
 PREFABRICATED BUILDING/Bâtiment Modulaire (PART 9) (PART 4)
 PREFABRICATED MODULE / Module Préfabriqué
 PREFABRICATED PANELS / Panneau
 ELECTRICAL FEATURES ONLY / Structures des seules caractéristiques électriques
 RELOCATABLE UNIT (ALBERTA PART 10) / Unité Relocalisable

FOUNDATION TYPE/ CHECK ONE: Type de Fondation (choisir un seul)
 PERIMETER FOUNDATION WALL/ Mur de fondation périmétrique
 PIERS/ Pieux/piliers 1/50 WIND PRESSURE/Pression du vent: _____ (kPa)
 (For resistance to overturning without anchorage / Pour résistance au renversement sans ancrages)
 ANCHORAGE/ Ancrage: (YES/NO): _____

FLOOR LIVE LOAD/ charge au plancher: **1.93** (kPa)
 SPECIFIED SNOW LOAD/ (1/50): **68.9** PSF
 Charge de neige spécifiée

SEISMIC RESPONSE $S_s(0.2)$: **1.0**
 Réponse sismique
 CLIMATE ZONE **B.C. ZONE 4**
 Zone Climatique

HOURLY WIND PRESSURE (1/50): **0.50** (kPa)
 (For resistance to racking & uplift / Pour la résistance au soulèvement par le vent)

ENVELOPE EFFECTIVE THERMAL RESISTANCE: (CHECK ONE)
 Enveloppe résistance thermique effective (choisir un seul)

PRESCRIBED/Imposé
 WALLS / Mur: **R22** (RSI)
 FLOORS / Plancher: **R40** (RSI)
 CEILING / Plafond: **R60** (RSI)

WINDOWS/DOORS/SKYLIGHTS THERMAL CHARACTERISTICS:
 Caractéristiques thermiques des fenêtres, puits, et portes de lumière

MAX. U-VALUE: **1.48** W/(m².K)
 coefficient U de transfert thermique
 ENERGY RATING: **28**
 Cote énergétique

TRADE OFF/ Compromis: ASSEMBLIES AFFECTED/ Zones affectées **N/A**
 AREAS AFFECTED/ Zones affectées (m²): **N/A**

OUTSIDE DESIGN TEMPERATURE:
 Température extérieure de conception

HEAT LOSS/ Perte thermique: **28,479 BTU @ -45°C**
 HEAT GAIN/ Gain thermique: **N/A** (°C)

CAPILLARY BREAK IN CLADDING: (YES/NO) **N/A**
 Fuite capillaire dans le parement

FACTORY INSTALLED APPLIANCES / APPAREILS INSTALLÉS À L'USINE

APPLIANCE TYPE	MAKE / MARQUE	MODEL / MODÈLE	FUEL / COMBUSTIBLE
FURNACE	INTER THERM	M15B-066ABW	OIL
WATER HEATER	BRAD FORD	M240 S8D SIN CPP	ELECTRIC
FRIDGE	GENERAL ELECTRIC	PNE25 JG6 B KBB	ELECTRIC
RANGE	GENERAL ELECTRIC	JOB 635 D52 BB	ELECTRIC
DISHWASHER	GENERAL ELECTRIC	GDF 630 S G K O B B	ELECTRIC
WASHER	GENERAL ELECTRIC	GTW 220 B M K I W W	ELECTRIC
DRYER	GENERAL ELECTRIC	GTB 40 F B M K O W W	ELECTRIC
N/A	N/A	N/A	N/A

**SITE INSTALLED COMPONENTS, ASSEMBLIES, AND SYSTEMS
 COMPOSANTES, ASSEMBLAGES ET SYSTÈMES INSTALLÉS SUR PLACE**

COMPLIANCE / CONFORMITÉ

Units bearing this label were manufactured in the above indicated factory address and have been constructed to the following building code(s) and standards.
 L'unité portant cette étiquette a été fabriquée à l'adresse de l'usine apparaissant plus haut et a été construite en conformité aux normes et codes du bâtiment

Homes are built to conform to CSA Standard A277, B.C. Building Code (2015), National Building Code of Canada (2015), Canadian Electrical Code of Canada (2015), B.C. Plumbing Code (2012)

ELECTRICAL SYSTEM / ÉLECTRIQUE: Volts: **20/240** Hertz: **60** Hz Amps: **100** A

PLUMBING SYSTEM / PLOMBERIE: Supply water system tested at 700 kPa (100 PSI) / Installation sous pression éprouvée à 700 kPa (100 PSI)
 Drainage system tested at 35 kPa (5 PSI) / Installation sous pression éprouvée à 35 kPa (5 PSI)

NOTES:

- Any additions or modifications to factory installed systems must be authorized by the appropriate provincial or municipal authorities having jurisdiction. Toute addition ou modification aux installations doit être autorisée par les autorités provinciales ou municipales compétentes.
- Call listing only covers the systems noted above only when installed by the manufacturer in a factory / L'inscription de QAI ne couvre que les systèmes mentionnés ci-dessus et seulement lorsque installés en usine par le fabricant.
- (NA) Under the heading "Factory Installed Appliances" indicates that appliances are not factory installed. (NA) Sous l'en-tête « Appareils installés à l'usine » indique des appareils non installés à l'usine.
- This specification nameplate and the exterior QAI label provide the only evidence of Listing. Cette plaque signalétique ainsi que l'étiquette extérieure QAI constituent les seules preuves de la certification QAI.
- Those portions of the Modular Building to be completed on site are subject to inspection by local building inspectors (A277 A1.2). Les parties de la maison modulaire qui doivent être achevées sur l'emplacement sont sujettes à l'inspection par les inspecteurs des bâtiments locaux (A277 A1.2).
- It is recommended that highway authorities be consulted on regulations applicable to areas into which this unit may be moved, especially in regard to permits and maximum allowable weights and widths. Il est recommandé de consulter les autorités locales au sujet des règlements applicables dans les régions à l'intérieur desquelles cette unité peut être transportée, particulièrement en ce qui concerne les longueurs maximales admissibles.
- Nameplate must be applied to a location that is readily visible after completion of the building / Dûit être appliqué à toutes les parties encore visibles après la fin du bâtiment.
- In the case of multi-unit or multi-suite buildings, each unit or suite shall have this label / Dans le cas de bâtiments à unités multiples ou à suites multiples, chaque unité ou suite devra recevoir cette étiquette.

**DO NOT REMOVE
 NE PAS ENLEVER**

NAMEPLATE SERIAL #: **1068-0001268**



S60-008-736

WARNING
THE WATER PIPING SYSTEM
OF THIS HOME IS DESIGNED
FOR:
**MAXIMUM PRESSURE OF
100 P.S.I. &
MAXIMUM TEMPERATURE OF
180 F**

 **Triple M Housing**
www.triplemhousing.com
This house has been designed to meet
or exceed the requirements of the
Z-240.10.1 Foundation Standard

 **BRITISH COLUMBIA**
REGISTRATION NUMBER
101488
Issued under the Manufactured Home Act

 **Triple M Housing**
Sales Inspected by Ruslan
Made in Lethbridge, Alberta



101488

Foundation Details

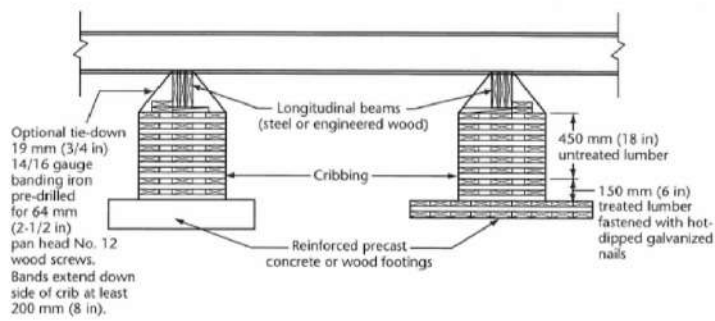
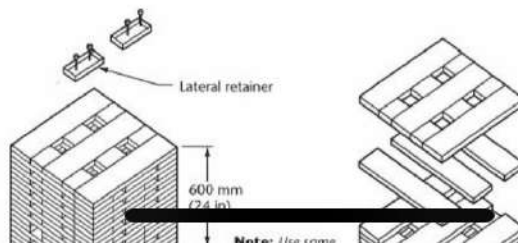

Figure B.5
Wood-crib pier foundation
(See Clauses 6.4.2, 6.4.6, and B.6.)

Foundation Details



Building Code requirements.

- Perimeter drainage to be directed to a location approved by the Building Inspector.
- All plumbing work to be completed in accordance with the BC Plumbing Code.

Site Preparation

A.1 General

A typical example of site preparation for concrete pile or surface pier foundation systems is shown in Figure A.1.

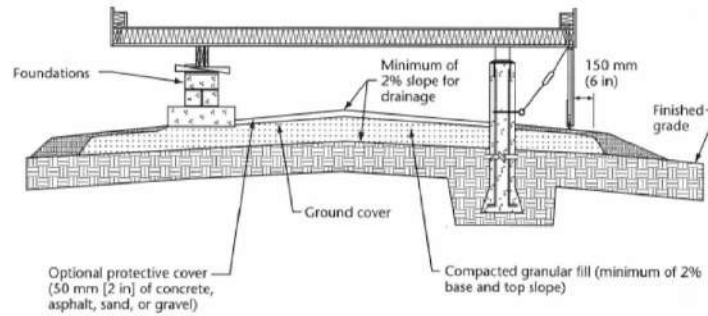

Notes:

- (1) The ground cover extends at least 150 mm (6 in) past the sides of the manufactured home.
- (2) The backfill base and ground cover are graded centre to outside or from side to side with a minimum slope of 2%.
- (3) The surrounding finished grade slopes away from the home.

Figure A.1
Site preparation
(See Clauses 5.1.2 and A.1.)

Foundation Details

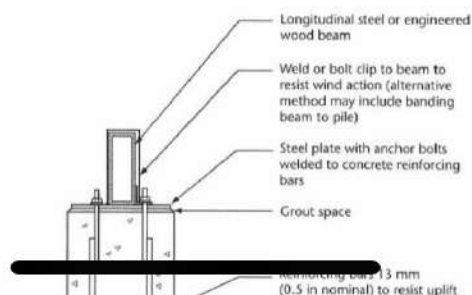

Anchorage Details

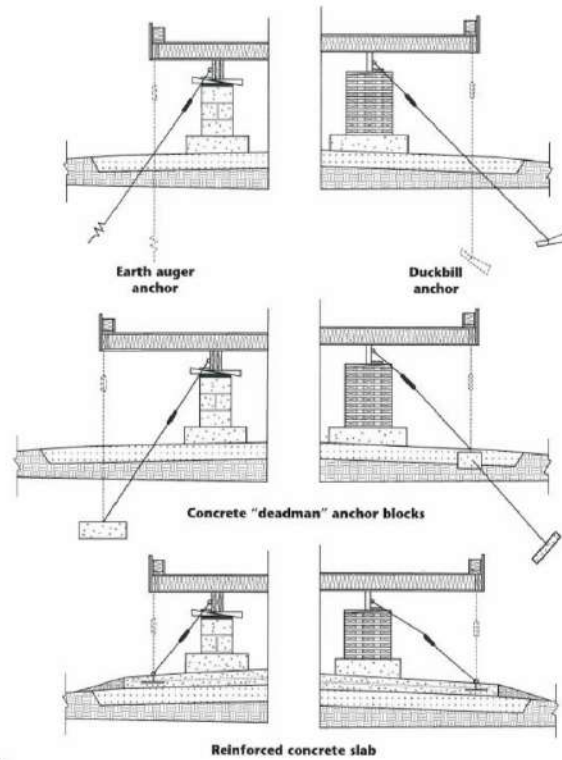

Notes:

- (1) Diagonal tie-downs are effective in limiting lateral sliding on foundation piers.
- (2) Vertical tie-downs directly connected to the wall studs provide the most effective resistance to uplift and overturning forces and should be considered for use at high-wind-load sites, particularly on the prevailing windward sides of an installation.

Figure C.4
Typical anchorage system arrangements
 (See Clause C.3.)

Skirting Details

E.1 General

Skirting helps keep debris from accumulating under a home and should be used. Skirting also helps prevent penetration of cold air; however, it should not be considered adequate protection for exposed waterlines.

E.2 Designs

Skirting designs vary depending on the skirting material, lot contours, and foundation system. Some skirting systems include channels and take-up devices. Typical systems are shown in Figures E.1 to E.3.

