

The Corporation of the District of North Cowichan

P.O. Box 278, Duncan, BC  
Building Department  
Phone: 746-3100 • Fax: 746-3154

**BUILDING  
PERMIT**

Folio No. 5386-102

DEPT. FILE COPY

6841

VALIDATION

DATE JAN. 29 20 07

PERMIT NO. 5-07

APPLICANT RAJ MINHAS

ADDRESS 

PERMIT TO New Building (TYPE OF IMPROVEMENT)

( ) STORY Single family (PROPOSED USE)

NUMBER OF DWELLING UNITS 1

AT (LOCATION) 6166 Sayward (NO.) (STREET)

Boad

ZONING DISTRICT Somenos

Somenos land district

R6 zone.

SUBDIVISION Plan VIP 79400

LOT 2

Sec BLOCK 1

R6.5 LOT SIZE 569 m<sup>2</sup>

This permit is granted on the express condition that the said construction shall, in all respects, conform to the Ordinances of this jurisdiction including the Zoning Ordinance, regulating the construction and use of buildings, and may be revoked at any time upon violation of any provisions of said ordinances. THE BUILDING SHALL CONFORM IN CONSTRUCTION TO THE REQUIREMENTS OF THE BRITISH COLUMBIA CODE AND ATTACHED PLAN CORRECTION SHEET

REMARKS: AS PER APPROVED PLANS - SEE ATTACHED INFO

BUILDING AREA

ESTIMATED VALUE \$ 128,810

PERMIT FEE \$ 945.00

OWNER / AG



ADDRESS

BUILDING DEPT. BY [Signature]

The Corporation of the District of North Cowichan

P.O. Box 278, Duncan, BC  
Building Department  
Phone: 746-3100 • Fax: 746-3154

Folio No. 5386-102

DUNCAN WATER. 27/Nov/07 147  
S.E. - SEWER.  
CERTIFICATE ISSUED  
DATE Oct. 5/07.

**BUILDING PERMIT -  
CERTIFICATE OF OCCUPANCY**

DATE JAN. 29 20 07 PERMIT NO. 5-07

APPLICANT RAJ MINHAS ADDRESS [REDACTED]

PERMIT TO New Building (TYPE OF IMPROVEMENT) NO. ( ) STORY Single family (PROPOSED USE) NUMBER OF DWELLING UNITS 1

AT (LOCATION) 6166 Sayward Road (NO.) (STREET) ZONING DISTRICT Somenos R6 zone.

SUBDIVISION: Plan V1P79400 LOT 2 BLOCK 1 Sec 1 Reg 5 LOT SIZE 569 m<sup>2</sup>

This permit is granted on the express condition that the said construction shall, in all respects, conform to the Ordinances of this jurisdiction including the Zoning Ordinance, regulating the construction and use of buildings, and may be revoked at any time upon violation of any provisions of said ordinances. THE BUILDING SHALL CONFORM IN CONSTRUCTION TO THE REQUIREMENTS OF THE BRITISH COLUMBIA CODE AND ATTACHED PLAN CORRECTION SHEET

REMARKS: As Per Approved Plans - See Attached Info

The inspection on which this certificate is based is made to further municipal interests, and not for the benefit of the owner. The inspector and municipality disclaim any responsibility to the owner for the effectiveness of the inspection, and they make no representation by this certificate.

BUILDING AREA [REDACTED] 120,810 945.00

OWNER / AGE [REDACTED]

ADDRESS [REDACTED]

*[Handwritten Signature]*

JLID NUMBER: **5386-102**  
 THE CORPORATION OF THE DISTRICT OF NORTH COWICHAN  
 ADDRESS: **204.3**  
**6166**  
 SAYWARD ROAD

LOT BLK RGE SEC PLAN DISTRICT SOMENOS  
**2** **5** **1** **1** **VIP 79400** **SOMENOS**  
 MUNICIPAL SERVICES RECORD

WATER SEWER DRAIN CULVERT GAS HYDROTEL

METER SERIAL No. \_\_\_\_\_  
 INSTALLATION DATE: **SPRING/SUMMER 2005**

SIZE OF SERVICE: **19mm** **100mm** **100mm**

TYPE OF PIPE: **COPPER** **PVC** **PVC**

CONNECTION LENGTH: **9.7m** **3.1m** **7.8m**

METER SIZE & TYPE

DEPTH AT P/L (INVERT): **0.7m** **(19.01m ELEV)** **1.0m**

DEPTH AT MAIN: **1.2m** **5m** **1.2m**

LOCATION AT P/L: **0.4m SOUTH OF I.P. 1/2** **9.5m WEST, 2.2m SOUTH FROM IP 1/2** **9.8m WEST 1.5m SOUTH FROM IP 1/2**

LOCATION AT MAIN: **24.0m D/S FROM EXIST SMH** **75.5m U/S FROM DMH A** **UG AT IP 1/2**

REVISION DATE

COMMENTS

SEE REVERSE FOR SKETCH: COLOR CODE: W - BLUE, S - RED, D - GREEN

**18 JAN 07**  
**2005-27/06**

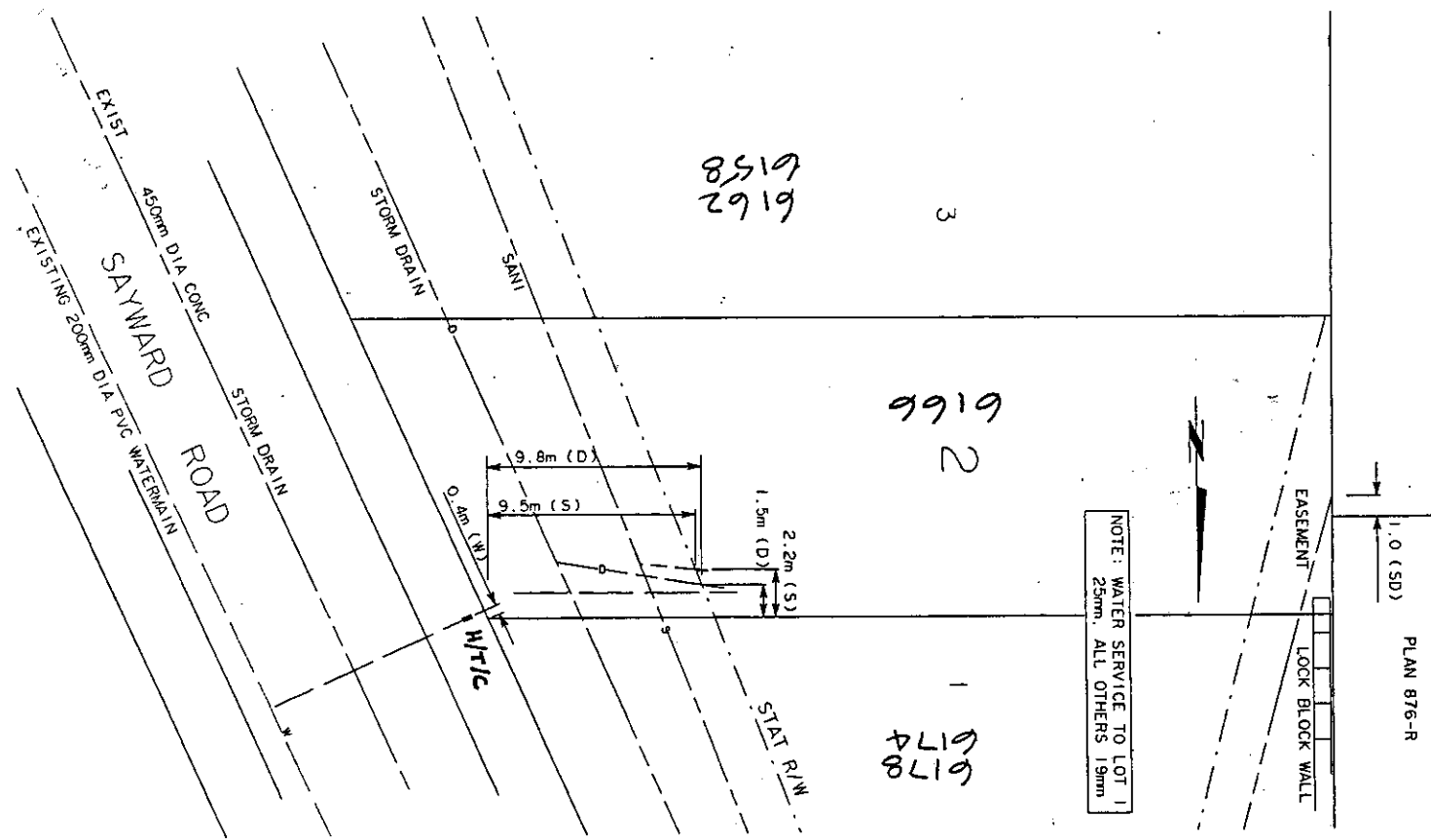

DELETES 8216

8396

D. 4.3

FOLIO NUMBER: 05386-102						THE CORPORATION OF THE <b>DISTRICT OF NORTH COWICHAN</b>	ADDRESS		
LOT	BLK	RGE	SEC	PLAN	DISTRICT		6166	SAYWARD ROAD	
2	-	5	1	VIP 79400	SOMENOS				
<b>MUNICIPAL SERVICES RECORD</b>									
WATER			SEWER		DRAIN		CULVERT	GAS	HYDRO/TEL

METER SERIAL No.	
------------------	--

INSTALLATION DATE	SPRING/SUMMER 2005					
-------------------	--------------------	--	--	--	--	--

SIZE OF SERVICE	19mm	100mm	100mm			
-----------------	------	-------	-------	--	--	--

TYPE OF PIPE	COPPER	PVC	PVC			
--------------	--------	-----	-----	--	--	--

CONNECTION LENGTH	9.7m	3.1m	7.8m			
-------------------	------	------	------	--	--	--

METER SIZE & TYPE						
-------------------	--	--	--	--	--	--

DEPTH AT P/L (INVERT)	0.7m	(19.01m ELEV)	1.0m			
-----------------------	------	---------------	------	--	--	--

DEPTH AT MAIN	1.2m	.5m	1.2m			
---------------	------	-----	------	--	--	--

LOCATION AT P/L	0.4m SOUTH OF I.P. 1/2	9.5m WEST, 2.2m SOUTH FROM IP 1/2	9.8m WEST 1.5m SOUTH FROM IP 1/2			
-----------------	------------------------	-----------------------------------	----------------------------------	--	--	--

LOCATION AT MAIN		24.0m D/S FROM EXIST SMH	75.5m U/S FROM DMH A			UG AT IP 1/2
------------------	--	--------------------------	----------------------	--	--	--------------

REVISION DATE	SEP 2006					
---------------	----------	--	--	--	--	--

COMMENTS	SINGLE FAMILY LOTS 3,4,5,6 CONVERTED TO DUPLEX LOTS A,B,C

SEE REVERSE FOR SKETCH: COLOR CODE: W - BLUE, S - RED, D - GREEN

1.0 (SD)

EASEMENT

LOCK BLOCK WALL

A

2

1

2.2m (S)

5m (D)

STAT R/W

SANI

STORM DRAIN

0.4m (W)

OIP

EXIST

450mm DIA CONC

STORM DRAIN

SAYWARD ROAD

EXISTING 200mm DIA PVC WATERMAIN