

PLAN OF SURVEY OF
PART OF LOT 349
REGISTERED PLAN N^o 24
TOWN OF PICTON
 COUNTY OF PRINCE EDWARD
 SCALE 1"= 20' B. ROGER PICKARD O.L.S. 1990.

PLAN 47R-5087
 RECEIVED AND DEPOSITED
 DATE Nov. 30 1990
R. Pickard
 LAND REGISTRAR FOR
 THE REGISTRY DIVISION OF
 PRINCE EDWARD (N^o 47)

I REQUIRE THIS PLAN TO BE DEPOSITED
 UNDER THE REGISTRY ACT.
 DATE October 26, 1990
B. Roger Pickard
 B. ROGER PICKARD O.L.S.

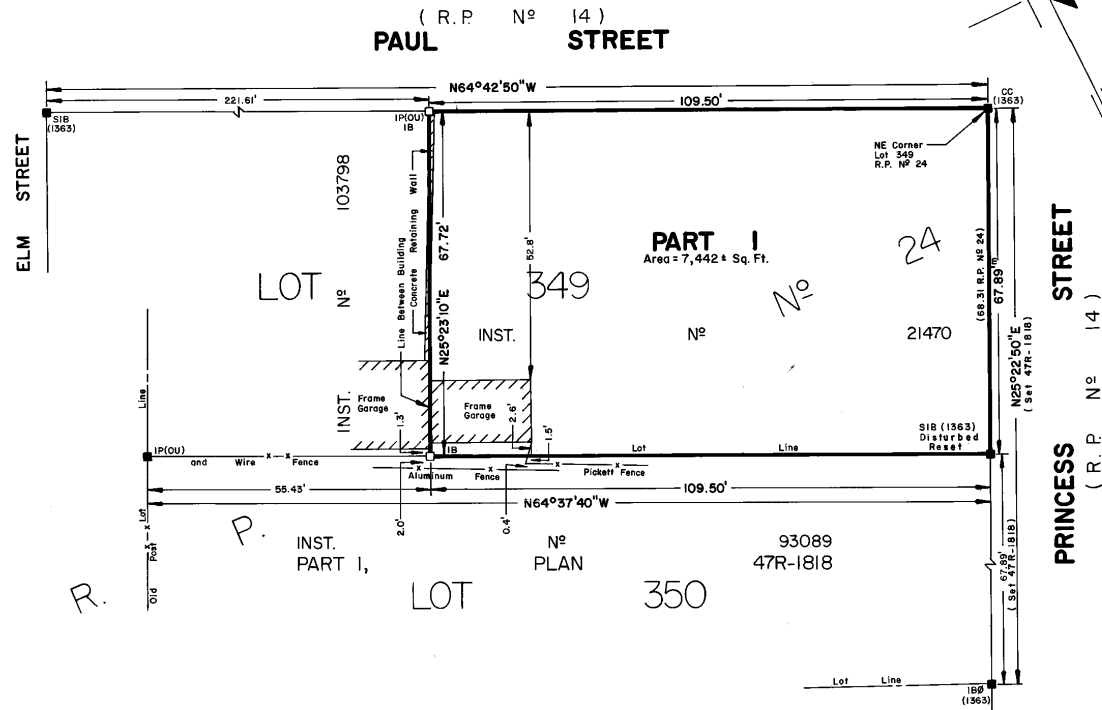

SCHEDULE

PART	DESCRIPTION	INST. N ^o	REMARKS
1	Part of Lot 349 R.P. N ^o 24	21470	

CAUTION

THIS PLAN IS NOT A PLAN OF SUBDIVISION
 WITHIN THE MEANING OF THE PLANNING ACT.

NOTE

Bearings are astronomic and are derived from
 the westerly limit of Princess Street shown on
 Plan 47R-1818 as N25°22'50\" E.

LEGEND

- denotes Survey Monument Planted
- " Survey Monument Found
- INST. N^o " Instrument Number
- m. " Measured
- IP " Iron Pipe
- CC " Cut Cross
- R.P. N^o " Registered Plan Number
- OU " Origin Unknown

SURVEYOR'S CERTIFICATE

- I CERTIFY THAT :
- This survey and plan are correct and in accordance with THE SURVEYS ACT and THE REGISTRY ACT and the regulations made thereunder .
 - The survey was completed on the 23rd day of October, 1990.

October 24, 1990
B. Roger Pickard
 B. Roger Pickard
 Ontario Land Surveyor

HUME and PICKARD LTD. Ontario Land Surveyors 248 Church St., Belleville (613) 966-4343 199 Main St., Picton (613) 476-2213	DRAWN BY : D. Daley
	PARTY CHIEF : M. McConnell
	PROJECT N ^o : 908593
	(Empty space)

308593