

**2867 Panorama Drive,
North Vancouver, B.C.**

Totals**

Main Level:	1,033 sq. ft.	Porch:	29 sq. ft.
Upper Level:	851 sq. ft.	Main Deck:	136 sq. ft.
Lower Level:	554 sq. ft.	Upper Deck:	56 sq. ft.
Bottom Level:	37 sq. ft.	Master Deck:	33 sq. ft.
Total:	2,475 sq. ft.	Lower Deck:	579 sq. ft.
		Garage:	457 sq. ft.
		Total:	1,290 sq. ft.

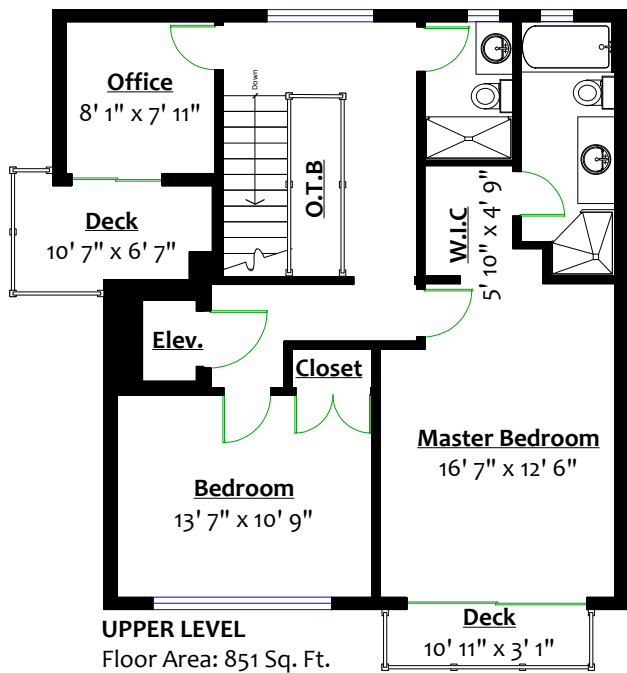

LOWER LEVEL
Floor Area: 554 Sq. Ft.

