

Christy Laniado



INSTITUTE for LUXURY HOME MARKETING\*

MEMBER

ROYAL LEPAGE SUSSEX

# 8591 Seascape Drive, West Vancouver, B.C.

## Totals\*\*

Main Level:	813 sq. ft.
Lower Level:	812 sq. ft.
Basement Level:	773 sq. ft.
Storage:	264 sq. ft.

## Other Areas\*\*

Garage:	394 sq. ft.
Porch:	103 sq. ft.
Deck:	106 sq. ft.
Balcony:	62 sq. ft.
Balcony:	67 sq. ft.

**Total: 2,662 sq. ft.**

**Total: 732 sq. ft.**

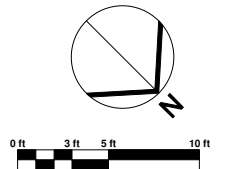
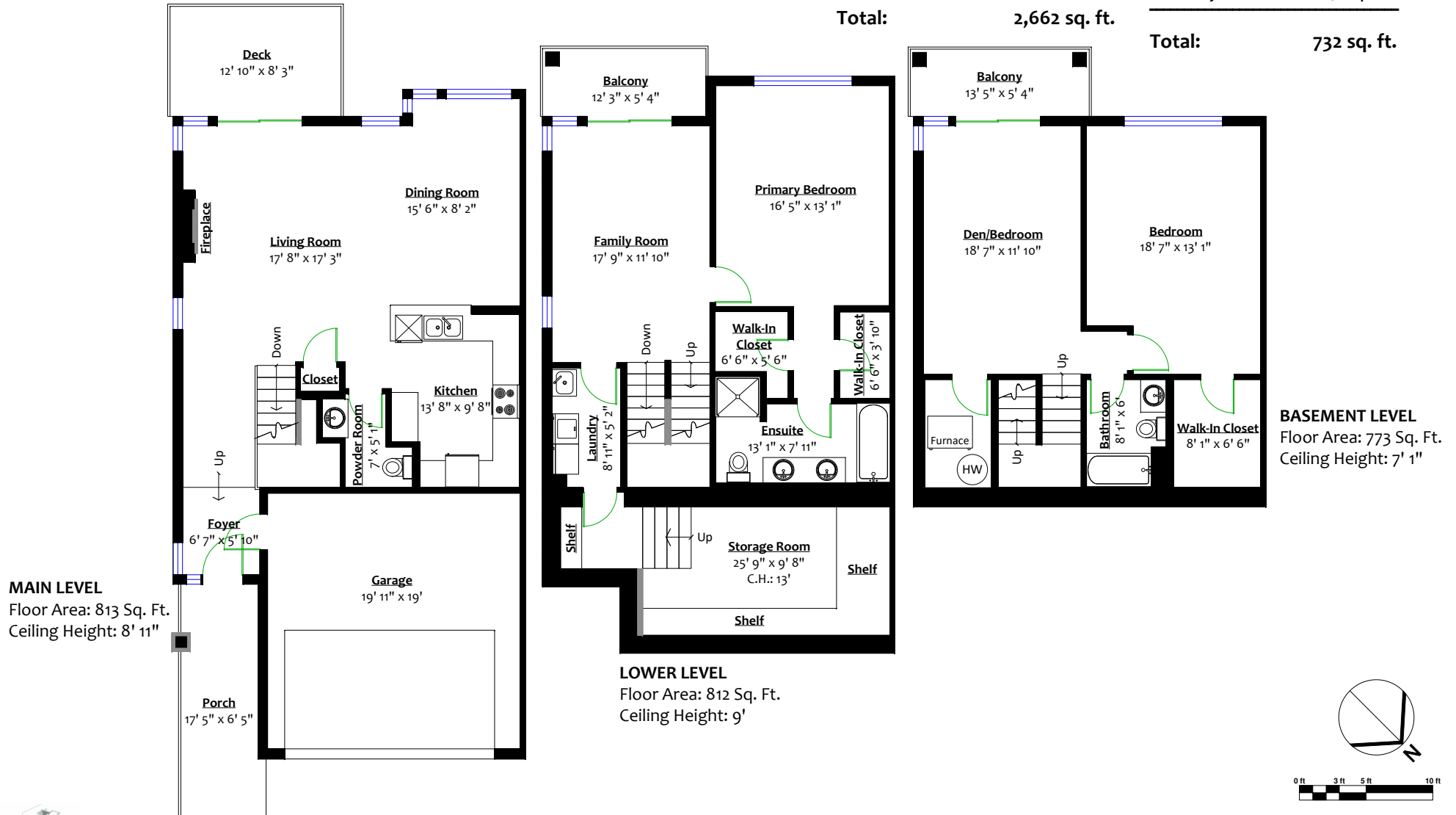

\*\* While all reasonable attempts have been made to ensure accuracy and the square footage and room dimensions are believed to be correct to ANSI Standards, due to the possibility of human error the information cannot be guaranteed. E&O Insured for \$1,000,000