

# 1987 CEDAR VILLAGE CRESCENT NORTH VANCOUVER, BC

UPPER LEVEL:	793 SF
MAIN LEVEL:	901 SF
LOWER LEVEL:	194 SF
FINISHED FLOOR AREA:	1888 SF
UNFINISHED LOWER LEVEL:	148 SF
TOTAL FLOOR AREA:	2036 SF
UNDERHEIGHT / UNFINISHED LOWER LEVEL:	581 SF
GARAGE:	433 SF

FLOOR AREAS ARE NOT DERIVED FROM THE STRATA PLAN  
STRATA PLAN TAKES PRECEDENCE

ALL INFORMATION FURNISHED REGARDING THIS PROPERTY  
IS FROM SOURCES DEEMED RELIABLE BUT NO WARRANTY  
OR REPRESENTATION IS MADE TO THE ACCURACY THEREOF.

UPPER LEVEL



MAIN LEVEL

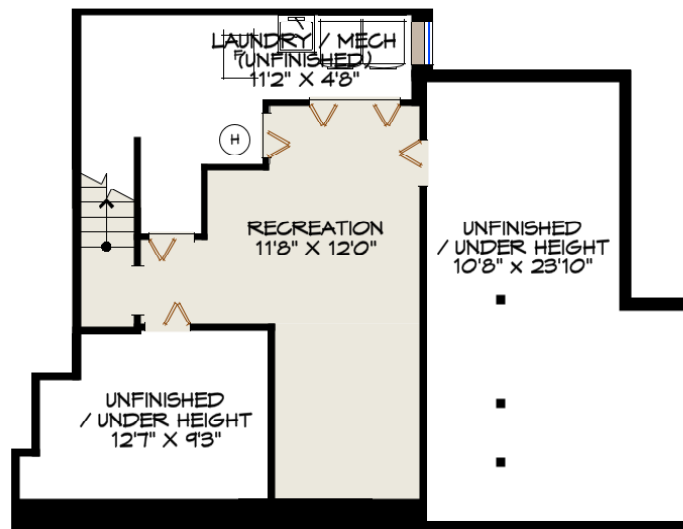

LOWER LEVEL

**TRUESPACE DESIGN**  
PREMIUM REAL ESTATE PLANS  
604-986-8649 / 778-628-5072  
WWW.TRUE-SPACE.CA

