

MAIN FLOOR
2681 SQ. FT.
10' CEILING HEIGHT

UPPER FLOOR
2332 SQ. FT.
9' CEILING HEIGHT

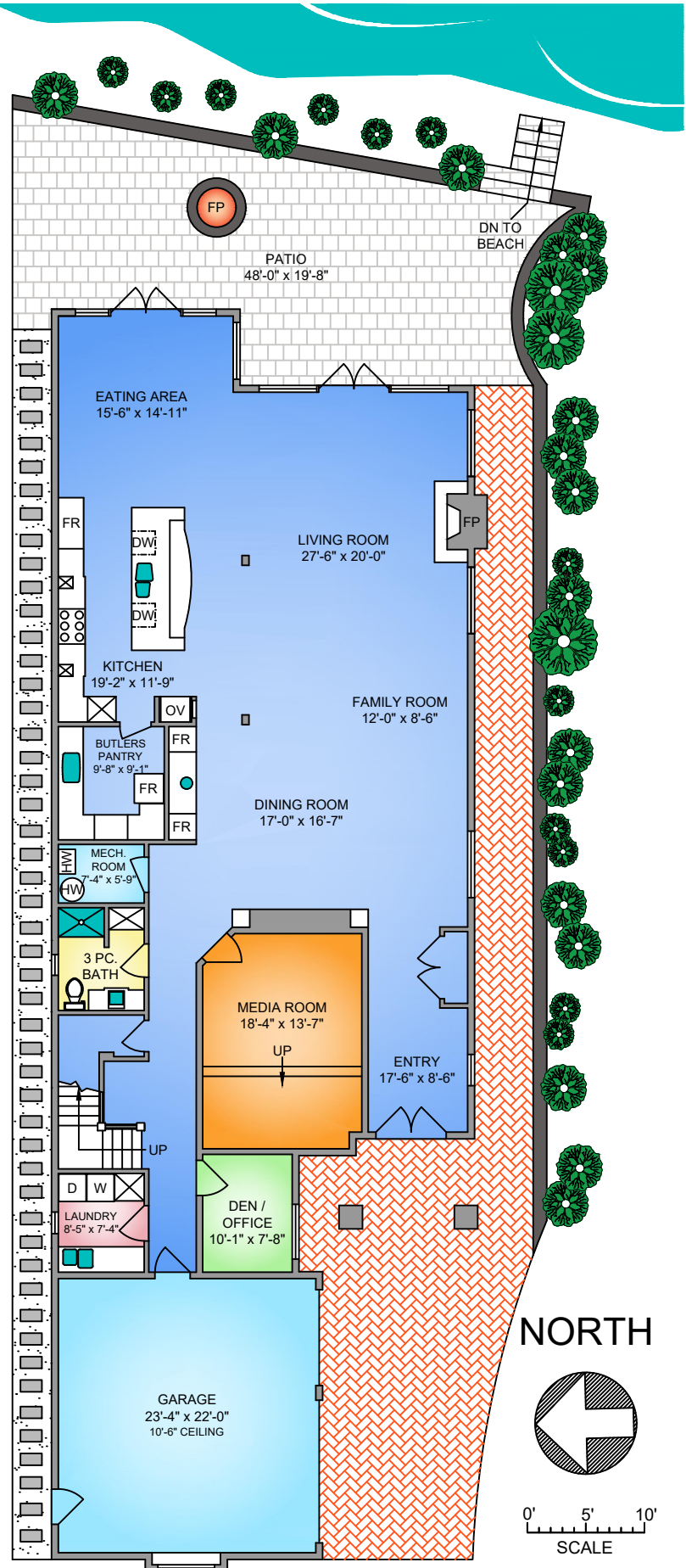
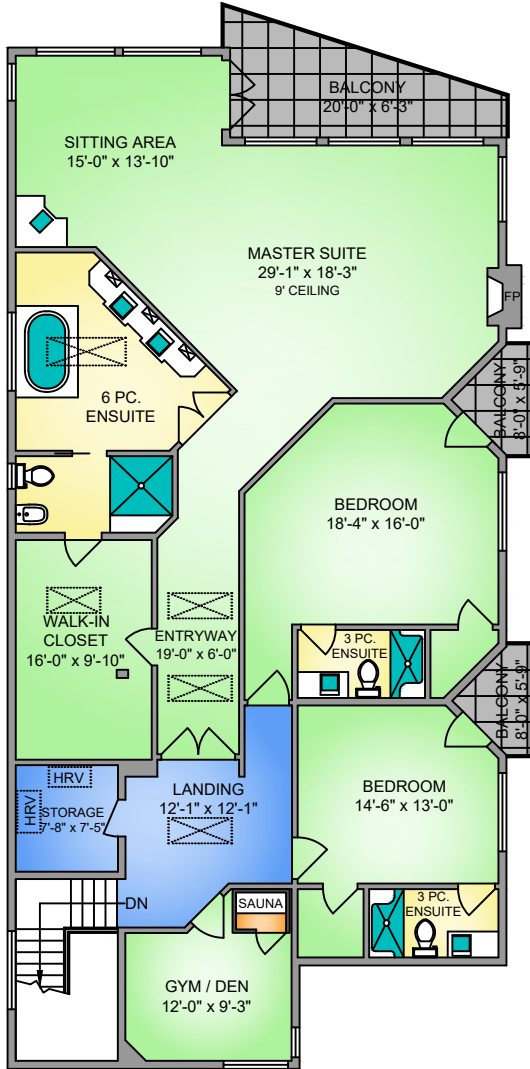

5185 AGATE LANE
 FEBRUARY 4, 2019
 PREPARED FOR THE EXCLUSIVE USE OF
 PLANS MAY NOT BE 100% ACCURATE, IF CRITICAL BUYER TO VERIFY.

FLOOR	AREA (SQ. FT.)		
	FINISHED	GARAGE	BALCONY / PATIO
MAIN	2681	562	745
UPPER	2332	-	185
TOTAL	5013	562	930

