

UNIT 325 - 1610 STORE STREET

613 SQ. FT.

11'-0" CEILING HEIGHT

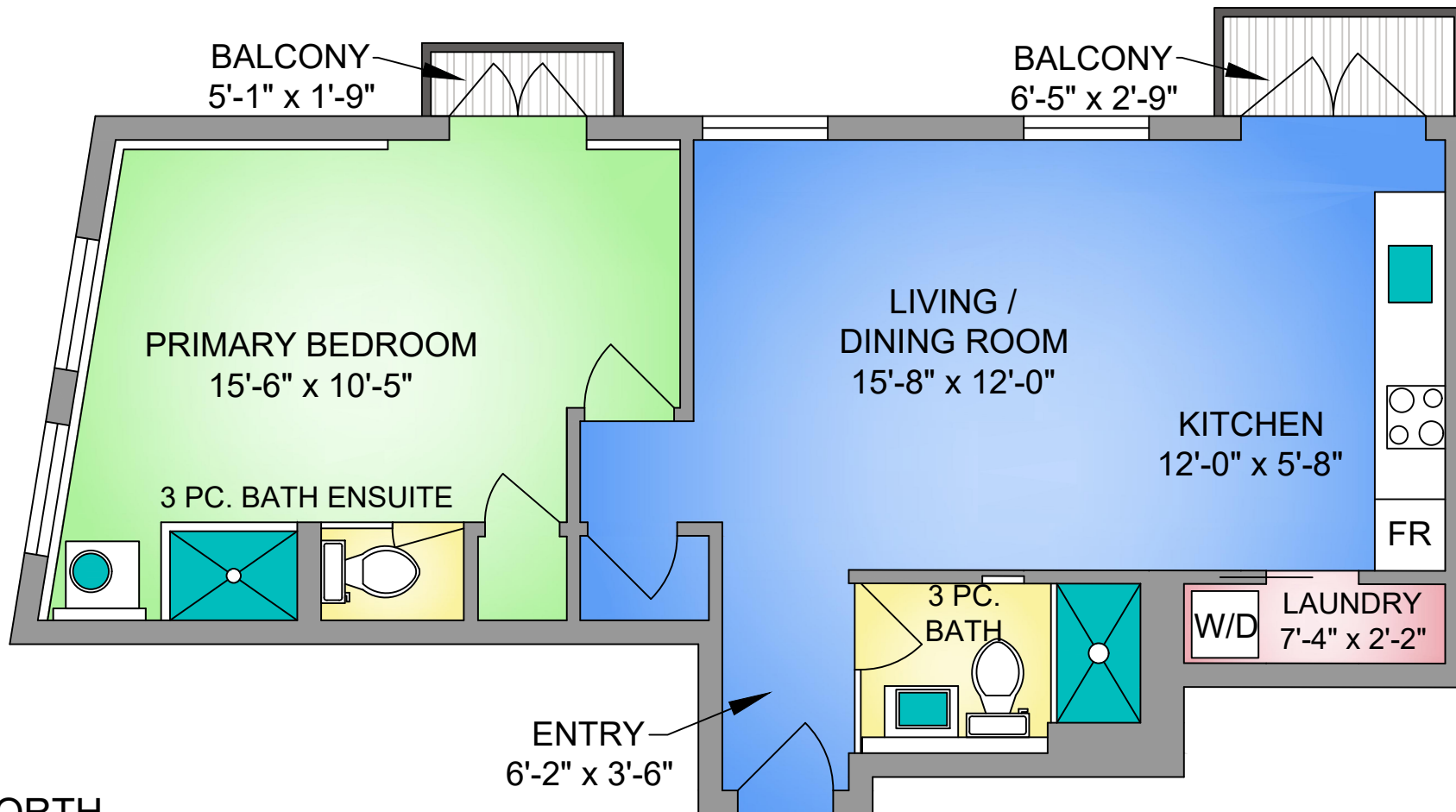

NORTH

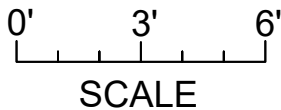
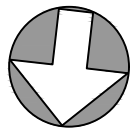

250-884-9753
 matt@propermeasure.com
 www.propermeasure.com

ENGEL & VÖLKERS[®]
LEBLANC · PIERCY GROUP

| UNIT 325 - 1610 STORE STREET | | |
|--|----------------|---------|
| APRIL 22, 2021 | | |
| PREPARED FOR THE EXCLUSIVE USE OF LEBLANC · PIERCY GROUP | | |
| PLANS MAY NOT BE 100% ACCURATE, IF CRITICAL BUYER TO VERIFY. | | |
| FLOOR | AREA (SQ. FT.) | |
| | FINISHED | BALCONY |
| THIRD | 613 | 27 |