

#112 225 E 6th Street,
North Vancouver, BC

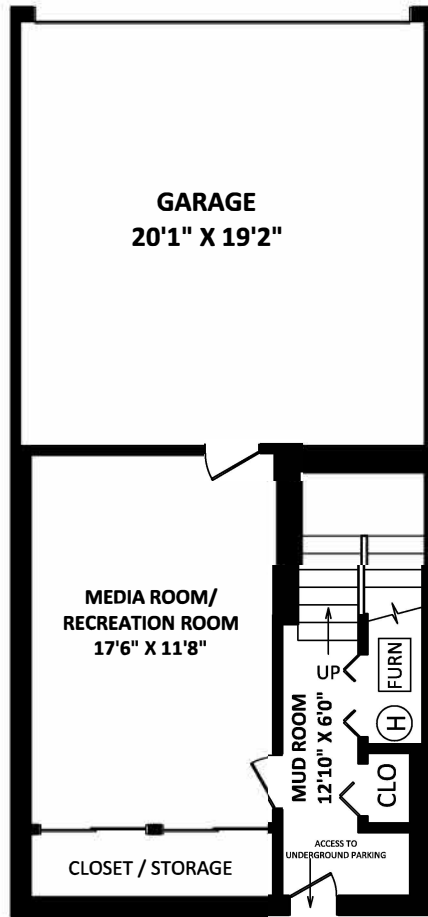

LOWER FLOOR: 436 SQ.FT.

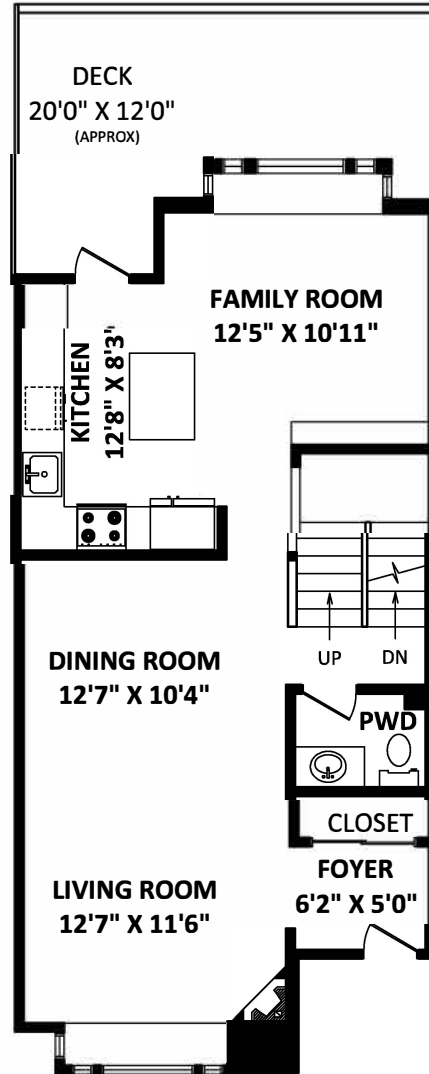

MAIN FLOOR: 731 SQ.FT.

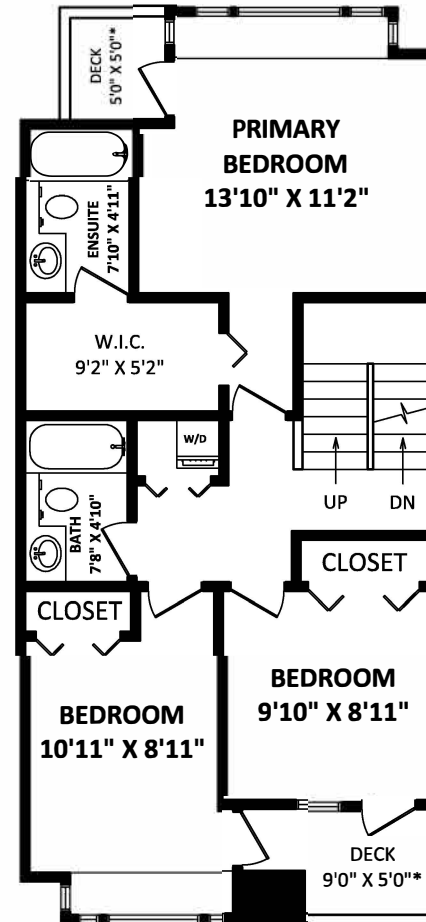

UPPER FLOOR: 731 SQ.FT.

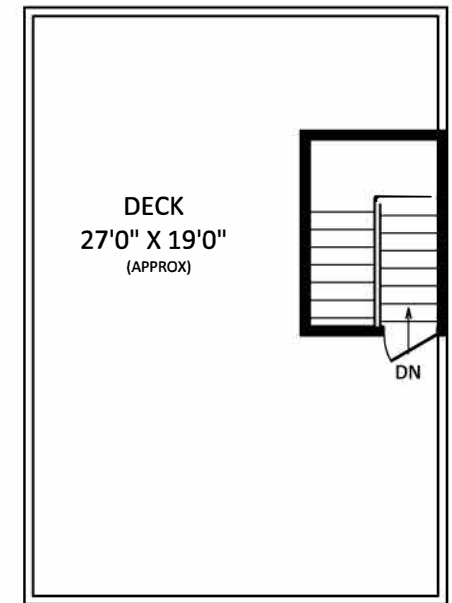

TOP FLOOR: 60 SQ.FT.

TOTAL FINISHED AREA: 1958 SQ.FT.

OTHER AREA(S)

| | |
|--------------------|--------------------|
| GARAGE: | 408 SQ.FT. |
| DECKS: | 252 SQ.FT.* |
| ROOF DECKS: | 480 SQ.FT.* |

FLOOR PLAN BY:

[JUNE 27, 2018]



TEL: 604-575-1244
www.seevirtual360.com

DISCLAIMER:

1. MEASUREMENTS ARE FOR PROMOTIONAL USE ONLY & ARE NOT INTENDED FOR CONSTRUCTION USE. ROOM DIMENSIONS ARE APPROXIMATE. MEASUREMENTS & CALCULATIONS FOR FINISHED AREAS ARE E&O INSURED.
 2. FINISHED AREAS ARE ENCLOSED AREAS IN A HOUSE THAT ARE SUITABLE FOR YEAR-ROUND USE, EMBODYING WALLS, FLOORS, AND CEILINGS THAT ARE SIMILAR TO THE REST OF THE HOUSE. (ANSI Z765-2003)
 3. THIS FLOOR PLAN MAY ONLY BE REPRODUCED WITH PERMISSION OF THE REALTOR(S) ON THIS FLOOR PLAN.
 * ANY MEASUREMENT WITH AN ASTERISK (*) OR (APPROX) ARE APPROXIMATE AND FOR ILLUSTRATION PURPOSES ONLY AND ARE NOT E&O INSURED.

SCALE:

