

Morgan DuVernet

604.209.1230

**#1801 - 1135 Quayside Drive,
New Westminster, B.C.**

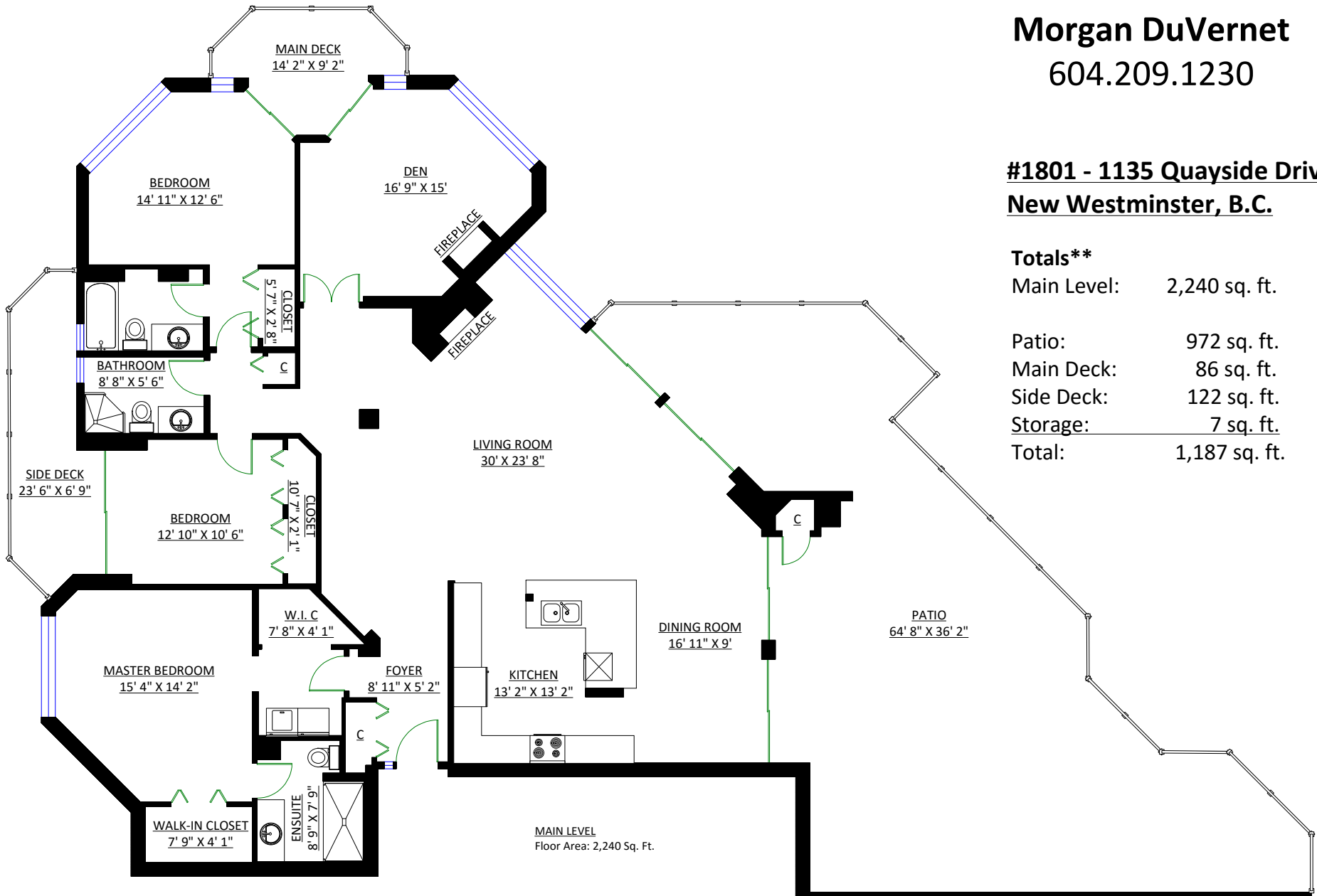

Totals**

Main Level:	2,240 sq. ft.
Patio:	972 sq. ft.
Main Deck:	86 sq. ft.
Side Deck:	122 sq. ft.
Storage:	7 sq. ft.
Total:	1,187 sq. ft.