

304-1678 PULLMAN PORTER STREET, VANCOUVER, BC

MAIN FLOOR TOTAL: 1,175 SQ. FT.
BALCONY: 203 SQ. FT.

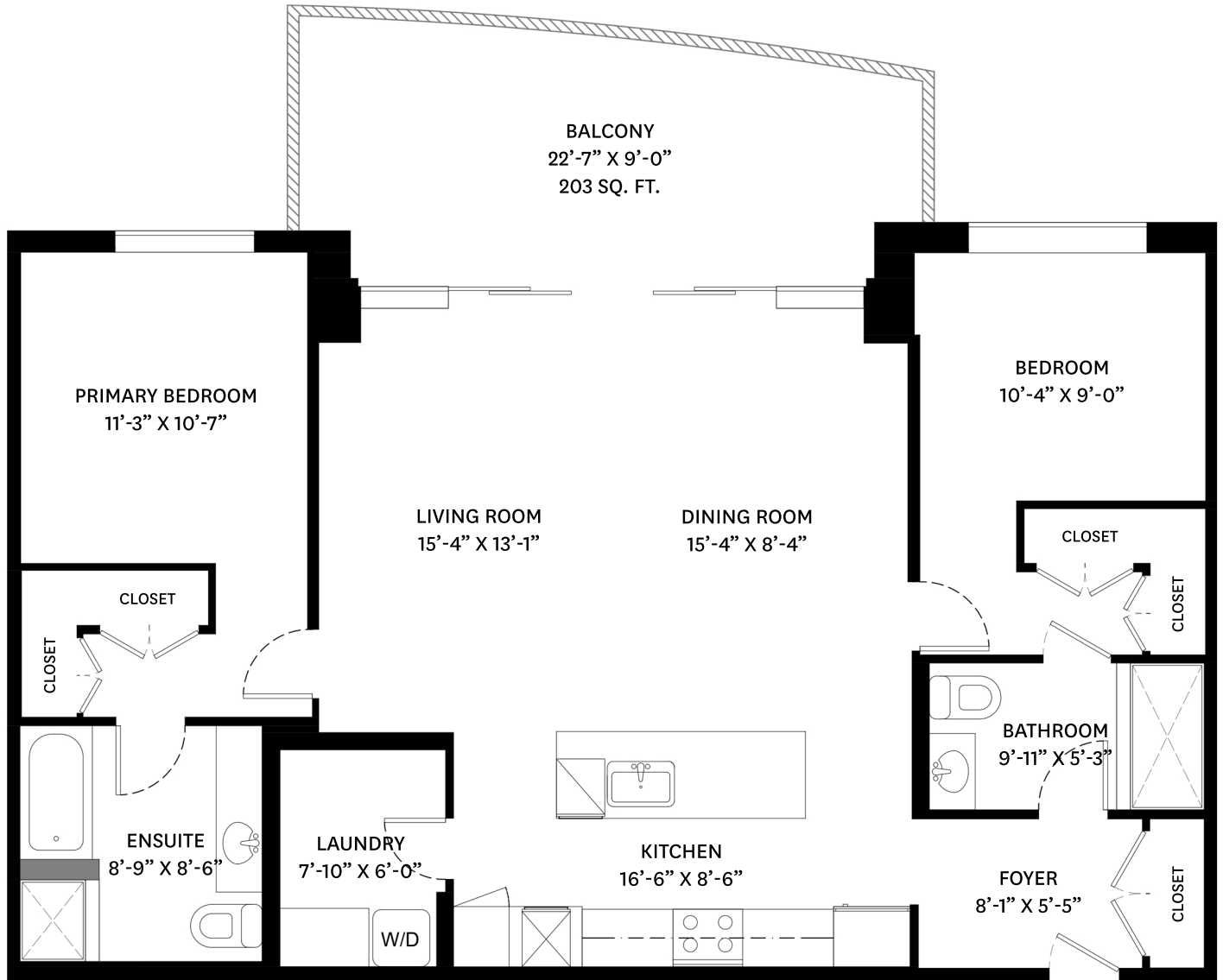

MAIN FLOOR PLAN
Ceiling Height: 8'-6"

ENTRANCE



KELSIE & MORGAN

REAL ESTATE GROUP

www.KelsieAndMorgan.com

floor plan designed by
ishot.ca Enterprises Inc.
604-368-7979
<http://ishot.ca>