

# BC LAND SURVEYORS SITE PLAN OF:

**Civic: 746 Front Street**

Legal Lot B, Section 31,  
Esquimalt District, Plan VIP56046

Parcel Identifier: 018-178-723  
in the City of Victoria

**LEGEND**

Elevations are geodetic and referenced  
to the CVD28BC datum.

### + - denotes - existing elevation

Lot Area = 311 m<sup>2</sup>



William Street

Front Street

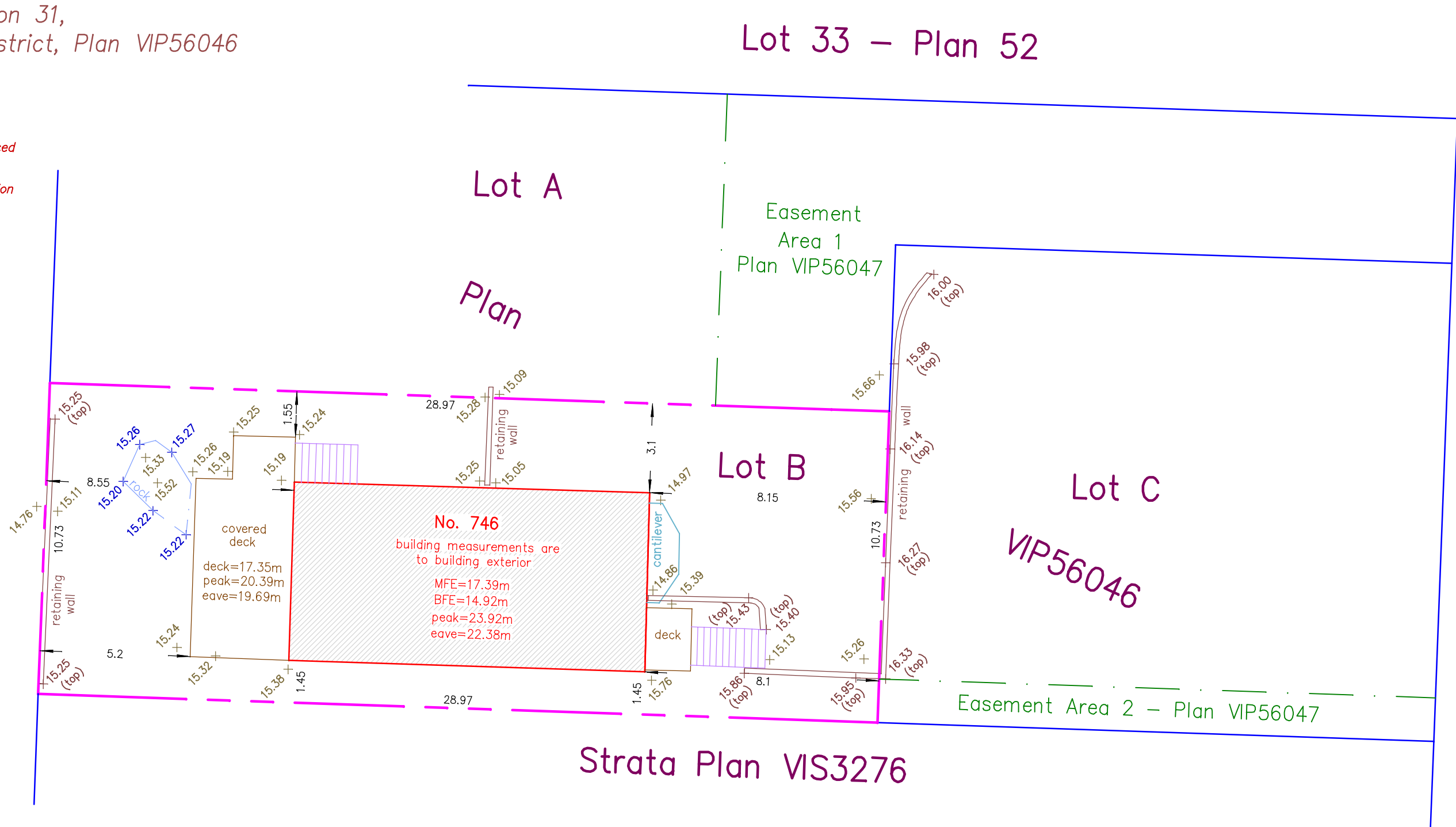

Date	July 22, 2022
File	13806-18
<b>POWELL &amp; ASSOCIATES</b> BC Land Surveyors 250-2950 Douglas Street Victoria, BC V8T 4N4 phone (250) 382-8855	

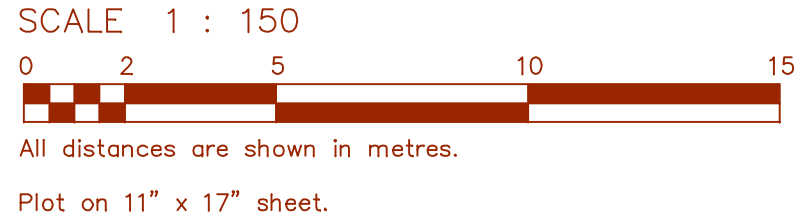

The following non-financial charges are shown on the current title and may affect the property.  
 EG84406 - Statutory Right of Way  
 EG22873 - Covenant

Setbacks are derived from field survey.

Parcel dimensions shown hereon are derived from Land Title Office records.

No original lot posts found.

Property Lines and setbacks shown may vary upon completion of a lot reposting and preparation of a legal survey plan.

This document shows the relative location of the surveyed features and shall not be used to define property boundaries.