

MAIN FLOOR

1238 SQ. FT.

14'0"-9'0" CEILING

LOWER FLOOR

1238 SQ. FT.

(FINISHED + UNFINISHED)

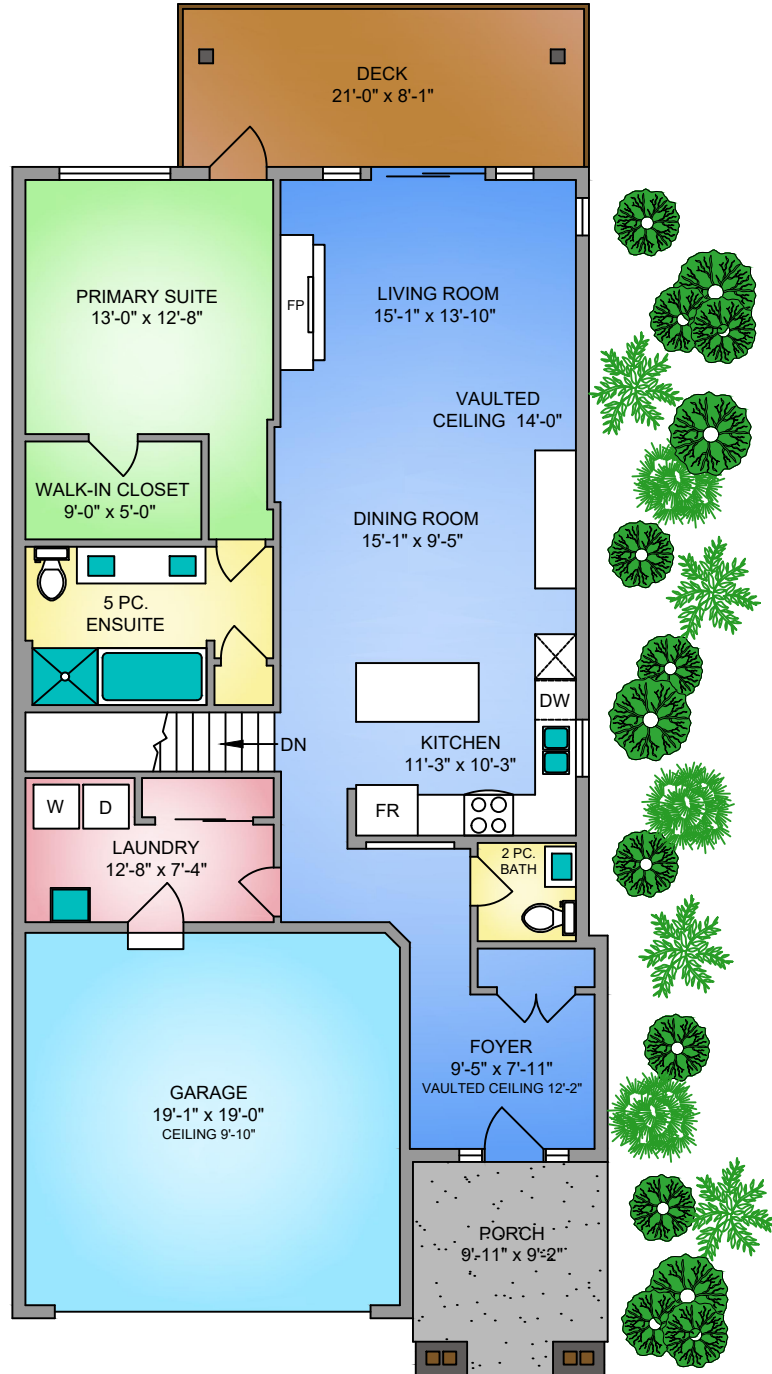
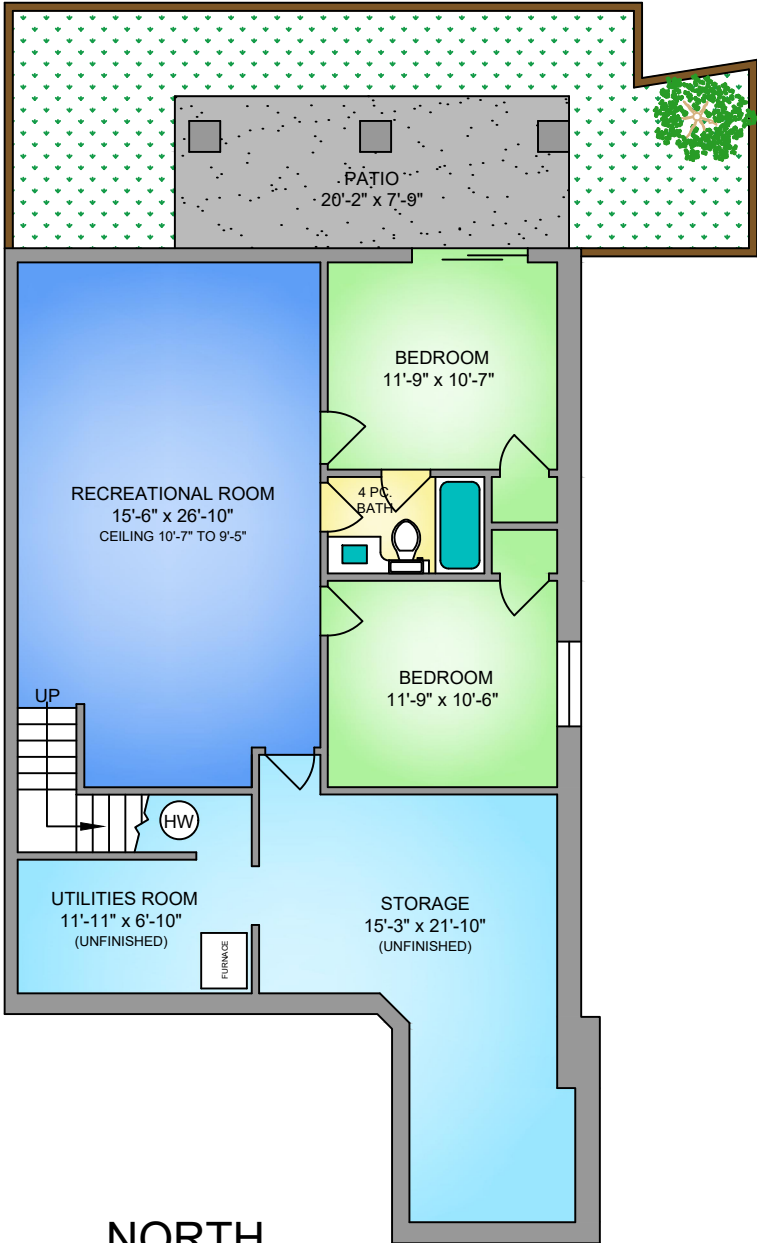

NORTH

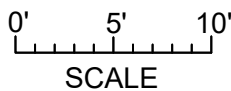
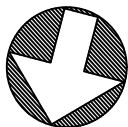

106 - 3451 BURKE VILLAGE PROMENADE, COQUITLAM
SEPTEMBER 28, 2020

PREPARED BY PROPER MEASURE FOR THE EXCLUSIVE USE OF DAN WAGNER.
PLANS MAY NOT BE 100% ACCURATE, IF CRITICAL BUYER TO VERIFY.
DIMENSIONS AND MEASUREMENTS ARE APPROXIMATE. THE FLOOR PLAN IS NOT INTENDED FOR ARCHITECTURAL OR CONSTRUCTION USE.

FLOOR	AREA (SQ. FT.)			
	FINISHED	UNFINISHED	GARAGE	DECK / PATIO
MAIN	1238	-	381	256
LOWER	833	405	-	156
TOTAL	2071	405	381	412

TOTAL SQ.FT. = 2475 (FINISHED + UNFINISHED)