

303 - 619 5TH AVENUE, NEW WESTMINSTER, BC

MAIN FLOOR TOTAL: 842 SQ. FT
DECK: 566 SQ. FT
VESTIBULE: 111 SQ. FT

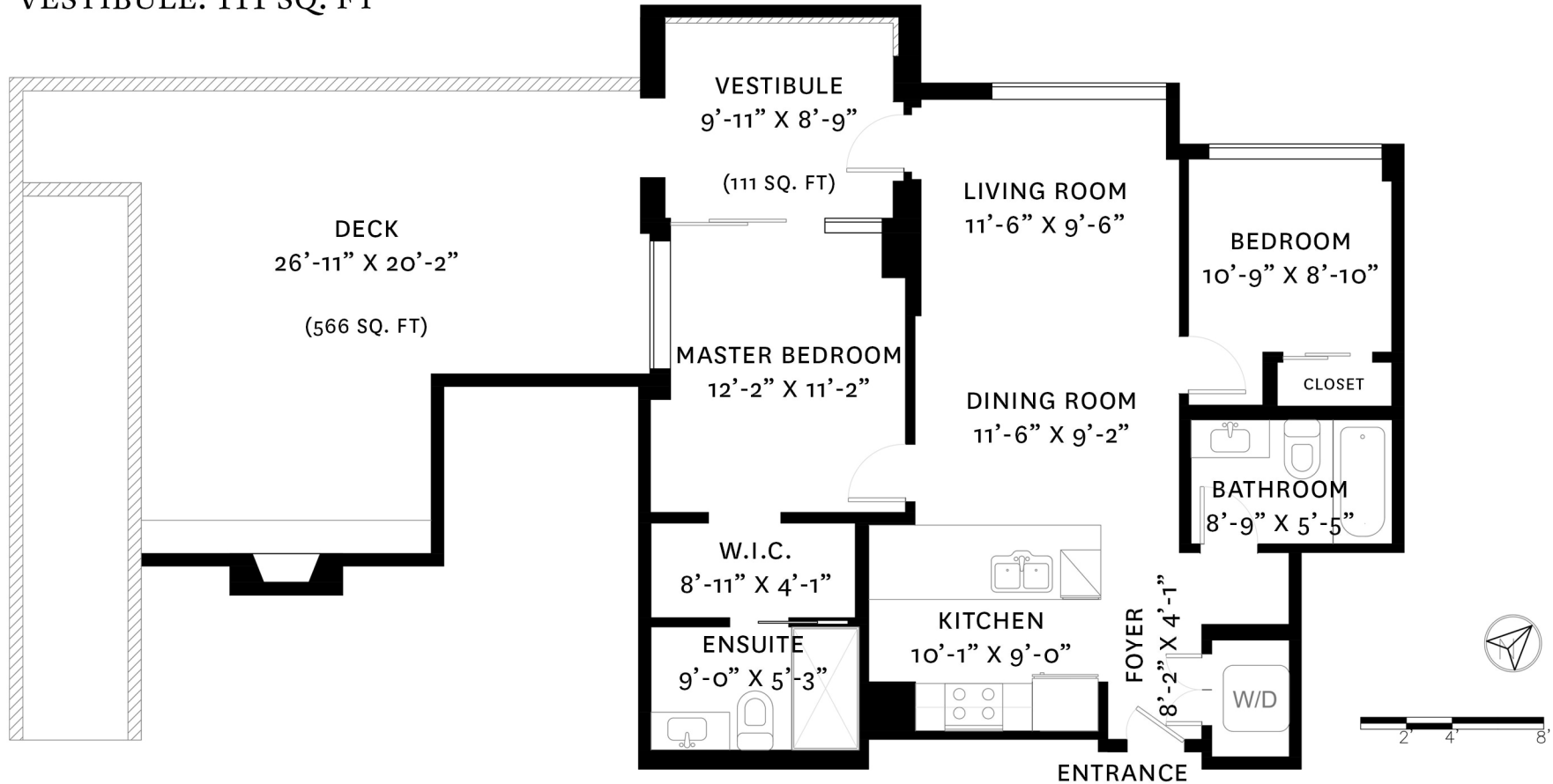

MAIN FLOOR PLAN
Ceiling Height: 7'-11"

RE/MAX
CREST REALTY

Donald McDougall
778-998-4820
donald@donaldmcdougall.ca

floor plan designed by
ishot.ca Enterprises Inc.
604-368-7979
<http://ishot.ca>

*PERSONAL REAL ESTATE CORPORATION. THE FLOOR PLAN ILLUSTRATION IS NOT SUITABLE FOR CONSTRUCTION/ARCHITECTURAL PURPOSES.
MEASUREMENTS ARE APPROXIMATE AND MAY NOT BE TO SCALE. E&O INSURED.