

**MAIN FLOOR**

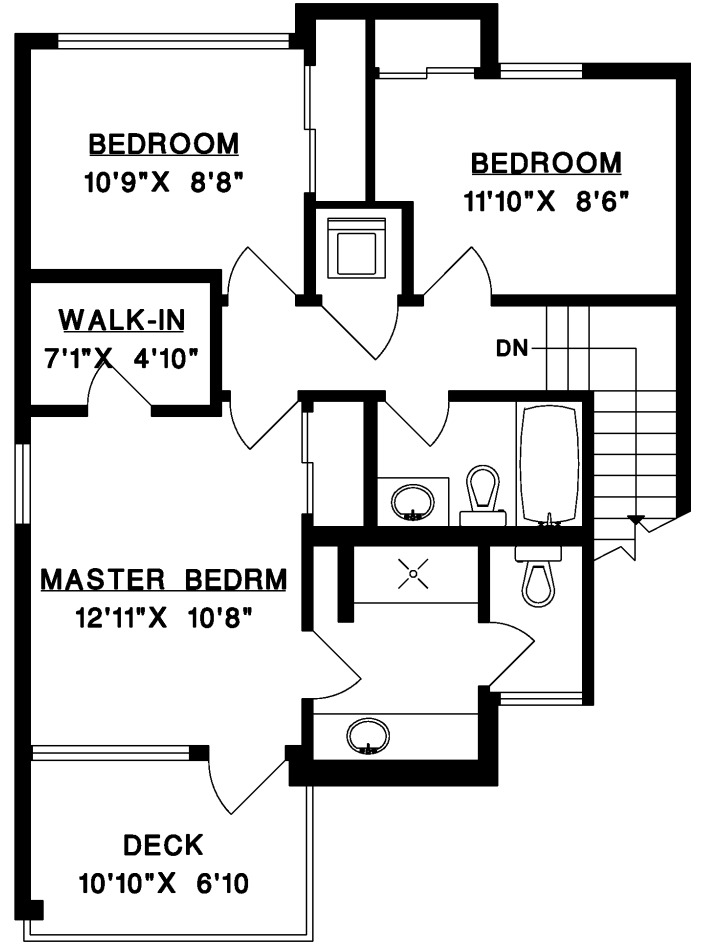

**UPPER FLOOR**

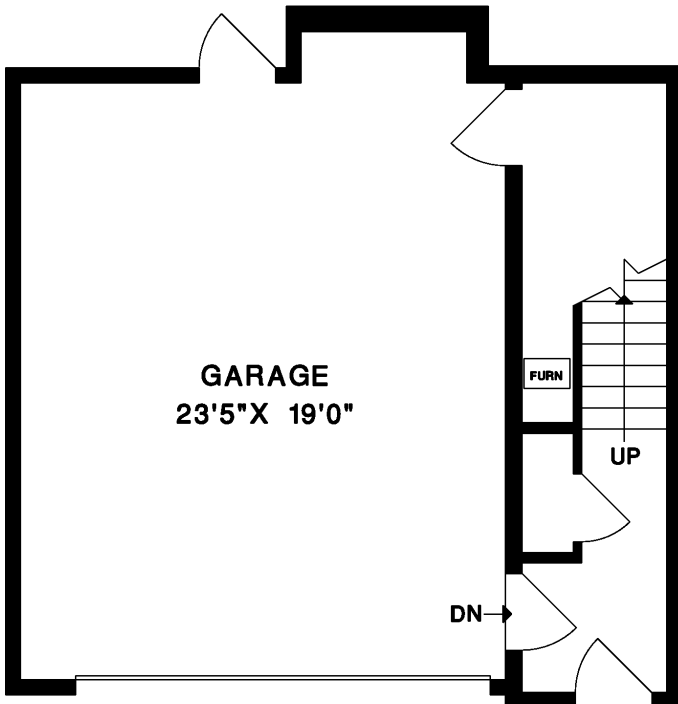

**LOWER FLOOR**



**#9 - 3595 SALAL DRIVE  
NORTH VANCOUVER**

MAIN FLOOR	734 SQ.FT.
UPPER FLOOR	734 SQ.FT.
LOWER FLOOR	165 SQ.FT.
<b>* TOTAL</b>	<b>1,633 SQ.FT.</b>

GARAGE	507 SQ.FT.
DECKS	399 SQ.FT.

\*AS PER STRATA MEASUREMENTS

