



Gina Rossi

Personal Real Estate Corporation

778-863-4462
gina@ginarossi.ca
www.ginarossi.ca



#31-120 POWELL ST VANCOUVER, BC

3 BEDROOMS + 2 BATHROOMS

TOTAL INTERIOR: 2,791 SQ.FT.

CEILING HEIGHT: 8'-8"

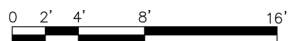
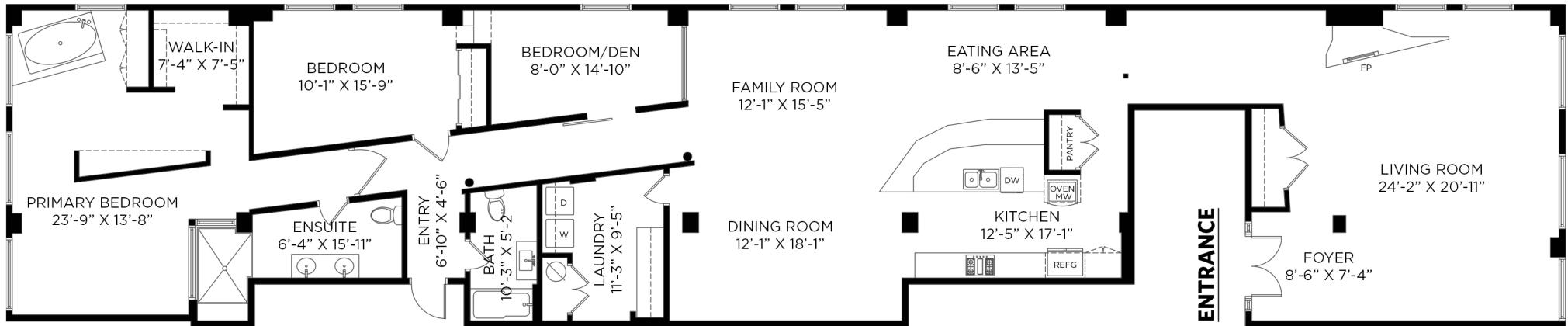

Floor plan not suitable for architectural/construction purposes. ANSI Z765 stand used to calculate square footage. Buyer to verify. E&O insured for \$1,000,000.



Scan QR code for
4K Matterport virtual tour

