

3211 Chatham

R 86-274

PLAN OF CONCRETE FOUNDATION WALLS ON  
 LOT 5 BLOCK 18 SECTION 3 BLOCK 3 NORTH  
 RANGE 7 WEST N.W.10  
 PLAN 249

ELEV. 1/2 ROAD 2.14  
 TOP FOUN. SECTOR 2.20

SCALE 1/250

LANE  
 10.06

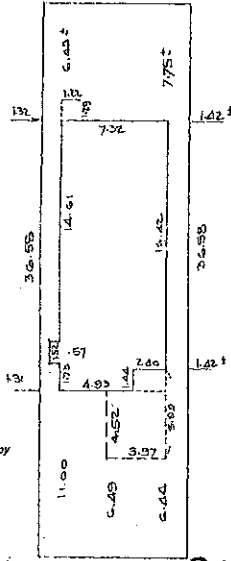
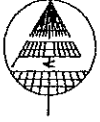

Inspected and revised this 3rd day  
 of JULY 1986.

*Handwritten signature*  
 B.C. Land Surveyor.

Certified correct this 18th day of  
 JUNE 1986

*Handwritten signature*  
 B.C. Land Surveyor.

NOTE:  
 This plan is intended only to show the position of  
 certain improvements within the subject parcel.  
 No other information is implied.  
 In particular this is not to be used for the location  
 of property lines or for building modifications.  
 We accept no responsibility for any unauthorized use.

3211 CHATHAM  
 ROAD

MATSON, PECK & TOPLISS  
 British Columbia Land Surveyors  
 Professional Civil Engineers  
 8211 Cook Road, Richmond, B.C. V6Y 1V3  
 Phone 270-9331

<b>1 DESIGN DATA</b> TYP: CBA 086 & NREC/CNCC LUMBER INC/7016 AUM 1.47 SCLL/CVC= 1.20 KW/80H SCLL/CRC= 0.80 KW/80H SCLL/CNC= 0.80 KW/80H SCLL/CHE= 0.50 KW/60H		<b>5 MAX. PLATING SPANS (mm)</b>	
<b>2 MAX. CHORD LUMBER SPANS (mm)</b>		JOINT NO. SPAN PORTEE (MM) PLATE SIZE DIM. DE PLAQUE (MM) LOCATION (MM) EMBLACEMENT 42 X 88 25 X 78	
<b>3 WEB REQUIREMENTS (mm)</b>		JOINT NO. SPAN PORTEE (MM) PLATE SIZE DIM. DE PLAQUE (MM) LOCATION (MM) EMBLACEMENT 42 X 88 25 X 78	
<b>4 FORCE INFORMATION L=SPAN (mm)</b>		JOINT NO. SPAN PORTEE (MM) PLATE SIZE DIM. DE PLAQUE (MM) LOCATION (MM) EMBLACEMENT 42 X 88 25 X 78	

REFER TO NREC SPAN TABLES FOR S-P-F LIMITATIONS HOUSING AND SMALL BUILDINGS PART 7 NREC HABITATION ET PETITS BATIMENTS PART 7 CNCC

CBA 086 COLOR FORMULAE HAVE NOT BEEN USED IN THE TOP CHORD ANALYSIS.  
 LES FORMULES DE LA COULEUR DU CHORD N'ONT PAS ETE EMPLOYEES A L'ANALYSE DU CHEVON.  
 SE REFERER AUX TABLEAUX DE PORTEE DE CHOC POUR LES LIMITATIONS DES PORTES ANALYSEES AU S-P-F.

NOTES:  
 1. Certain members in bay.  
 2. Center of plates on both sides of joint unless S or Y location is specified.  
 3. All plates must be secure fastened into members.  
 4. The truss designer is responsible to provide plating for the bay as required. See Slope Guide.  
 5. See Table 3 for web lateral bracing requirements.  
 6. Indicated chord supports shall be located 1/8 of the panel length (10%) measured from a joint.

8 mm BEARING UNLESS NOTED IN TABLE 2

DWG No: 6-000514

TRUSS TYPE: 701

HYDRONAIR  
 INGENIEUR/INGENIEIROLOGO  
 CONCORD, ONTARIO  
 TELEPHONE (416) 640-8647

This document is a copy from the records of the City of Richmond. It is not acceptable for a permit application. Information contained in City records may not be accurate or represent the current status of the property or buildings constructed therein.  
 This information has been provided subject to the Federal Copyright Act and in accordance with the Freedom of Information and Protection of Privacy Act.