

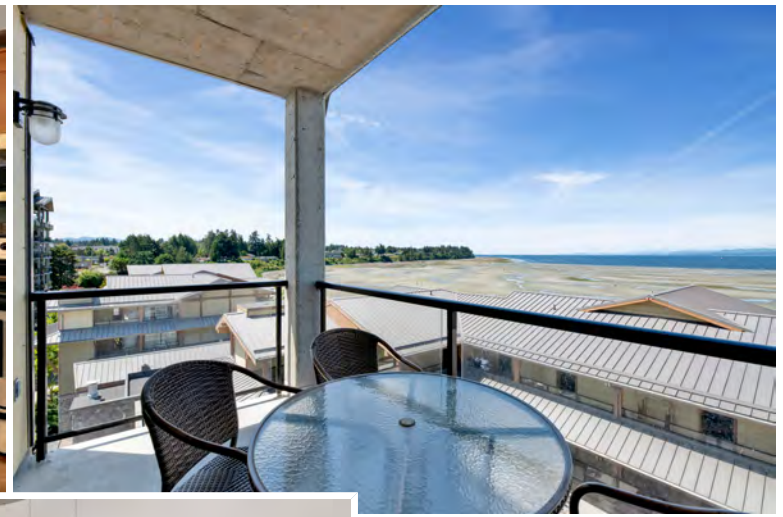

#601/602B - 181 Beachside Drive
Parksville, BC

\$99,500

Beds: 2 | Baths: 3 | 1,240 sq ft | Year Built: 2008 | MLS: 869375



Welcome to the Beach Club! Resort living at its finest. Centrally located in Parksville, this unit's spacious 2 bedroom, 3 bathroom Azure floor plan offers breathtaking views of the Pacific Ocean and Mainland Mountains. Comes fully furnished with in-suite laundry and offers a full kitchen for preparing meals to enjoy on either of the two included ocean view patios. Located just a short walk from this quaint neighbourhood's shops and amenities, as well as the popular Summer by The Sea Street Market. Steps away from Parksville's 1.5 km Waterfront Walkway. In the building, enjoy fine west coast dining at the Pacific Prime Restaurant, relax at the Stonewater Spa, and recreate on the ocean with reservable kayaks. When not staying during your ownership week, the building's rental pool brings hotel booking revenue. Includes Quarter Share of Unit 601 and 602 – use both, stay in one and rent out the other, or rent out both! Many other amenities including spa, pool, and fitness centre. Call today for more information!



Beds: 2 | Baths: 3 | 1,240 sq ft | Year Built: 2008 | MLS: 869375

Sutton sutton group
WestCoast Realty™

Jordan Michael
778-995-4103
jordanmichael@sutton.com

Resort Layout



FLOORPLATES

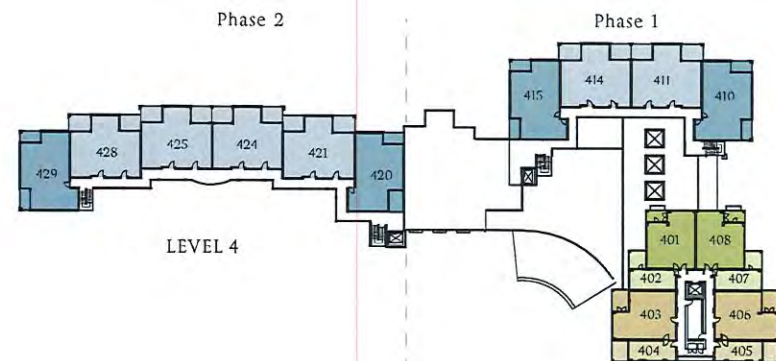
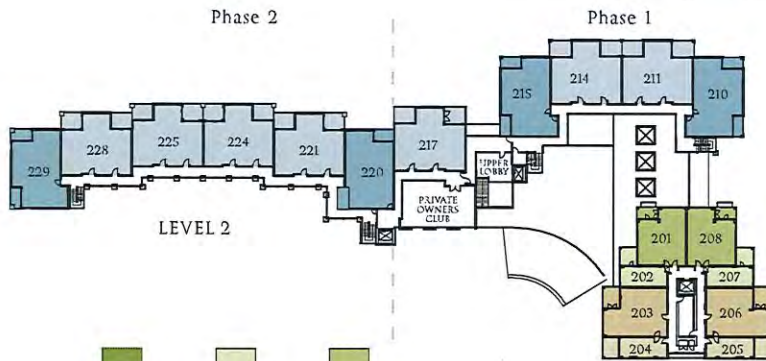
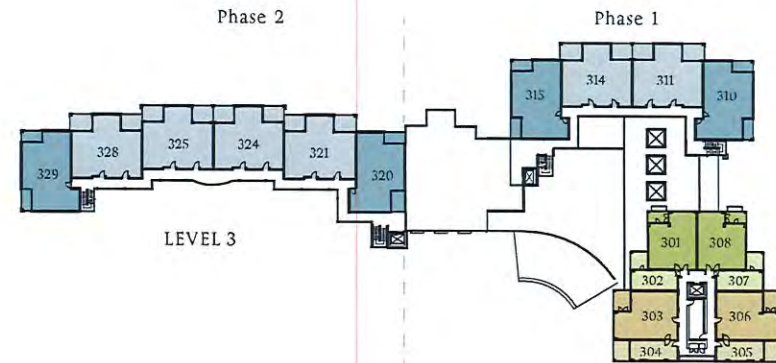
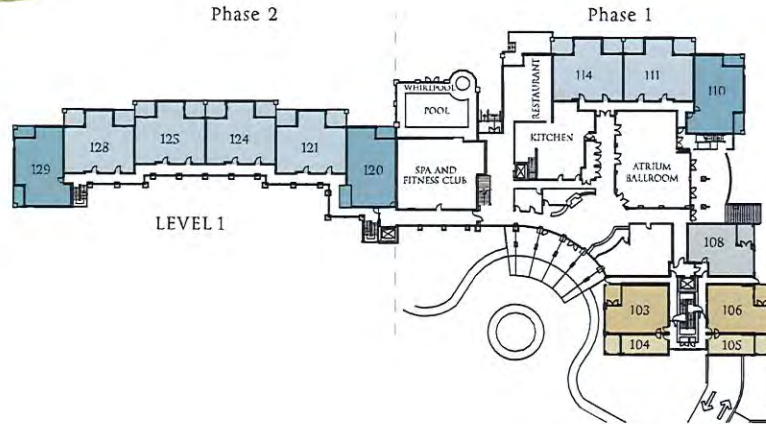

- THE AZURE Plan A 2 Bedroom
- THE AZURE Plan A1 Studio
- THE AZURE Plan A2 1 Bedroom
- THE BEACHES Plan B 2 Bedroom
- THE BEACHES Plan B1 Studio
- THE BEACHES Plan B2 1 Bedroom
- THE CRANE Plan C 2 Bedroom
- THE DRIFTWOOD Plan D 2 Bedroom
- THE EBB TIDE Plan E 1 Bedroom

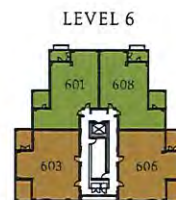
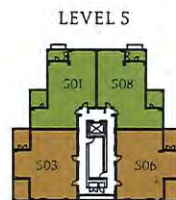

In our continuing effort to meet the challenge of product improvement and maintaining the high standards of The Beach Club Resort, we reserve the right to make modifications and changes to the building design, specifications, floorplans, and prices without prior notice. Illustrations are approximate representations of features described and are intended as a general reference only. Room sizes and square footages are based on surveyor's measurements. Floor plans to the right are for specific offering details. E & O. E.

Unit Layout

THE AZURE



A PLAN

1,240 square feet

A1 344 square feet

A2 896 square feet

Beachfront Tower

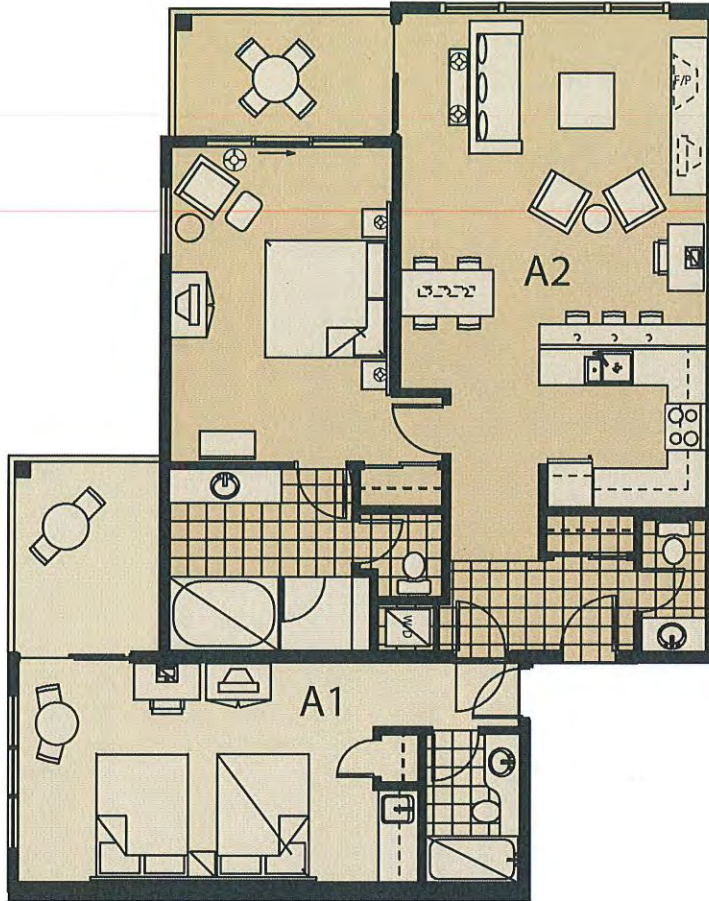

LEVELS 2, 3 & 4

A1 - Studio available on levels 2 - 4

A2 - 1 Bedroom available on levels 2 - 4

LEVELS 5, 6, 7, 8 & 9

2 Bedroom includes 1 bedroom and studio

A: Comprised of A1 & A2

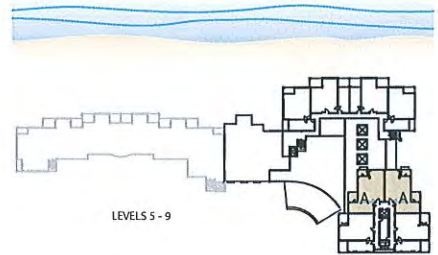
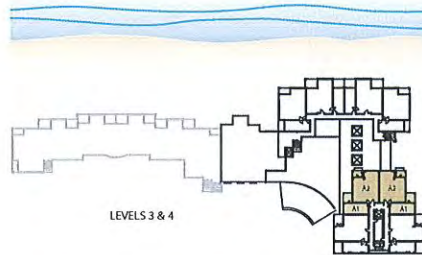
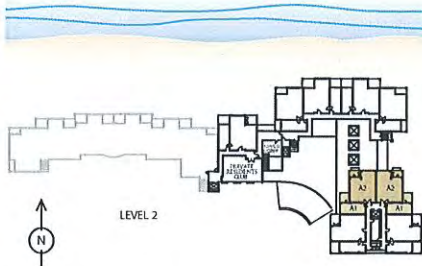

In our continuing effort to meet the challenge of product improvement and maintaining the high standard of The Beach Club Resort, we reserve the right to make modifications and changes to the building design, specifications, floorplans, and prices without prior notice. Illustrations are approximate representations of features described and are intended as a general reference only. Room sizes and square footages are based on surveyor's measurements. Please refer to the disclosure statement for specific offering details. E & O.E.