

1605 Whitesails Drive
Bowen Island, BC

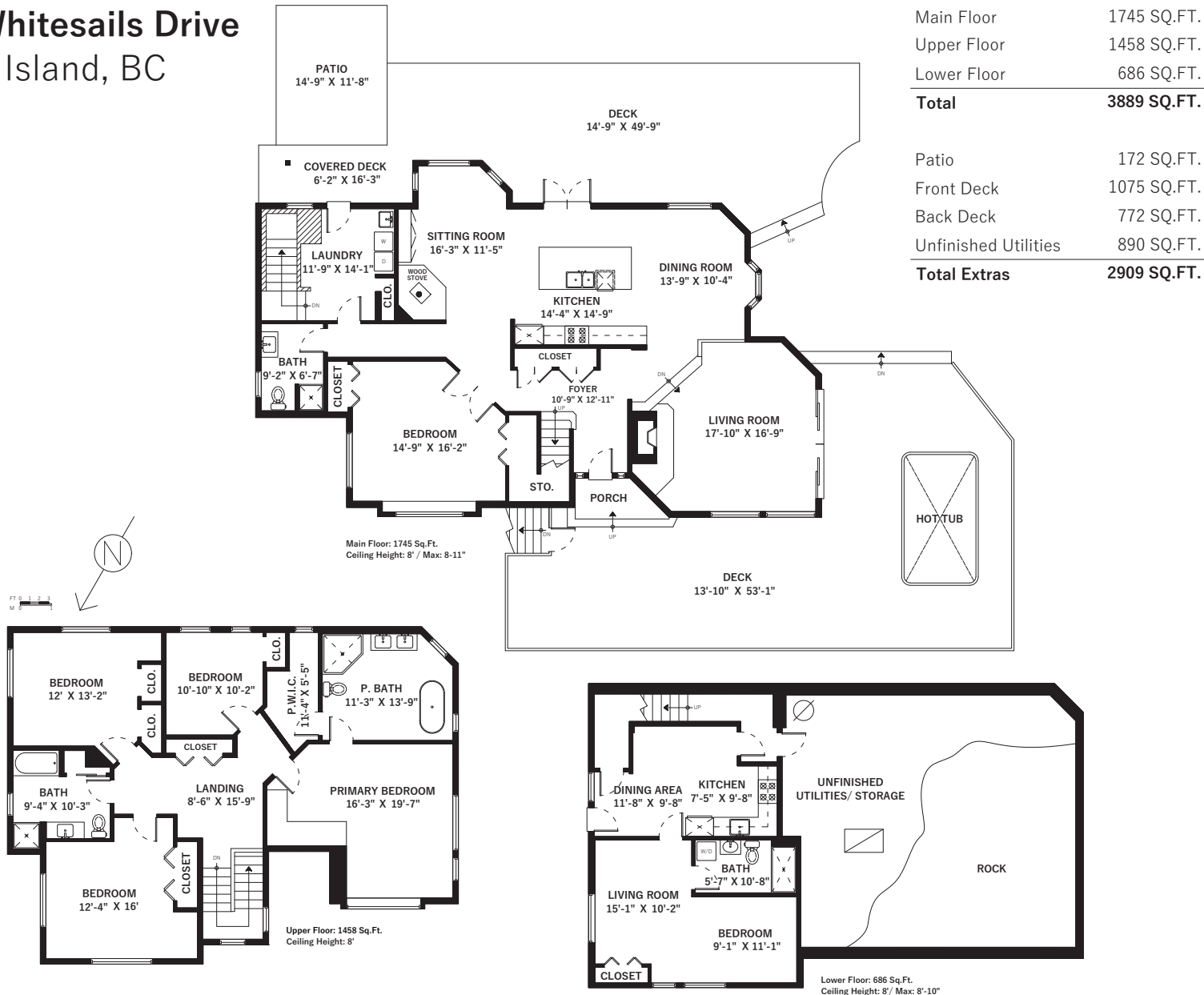

| | |
|--------------|--------------------|
| Main Floor | 1745 SQ.FT. |
| Upper Floor | 1458 SQ.FT. |
| Lower Floor | 686 SQ.FT. |
| Total | 3889 SQ.FT. |

| | |
|----------------------|--------------------|
| Patio | 172 SQ.FT. |
| Front Deck | 1075 SQ.FT. |
| Back Deck | 772 SQ.FT. |
| Unfinished Utilities | 890 SQ.FT. |
| Total Extras | 2909 SQ.FT. |