

Office For Lease

5824 – 2nd Street SW

PRESTIGE
COMMERCIAL GROUP

RE/MAX
COMMERCIAL®

Rethinking Commercial Real Estate

403-204-9323



This brochure is intended for information purposes only and should not be relied upon for accurate factual information by the recipient hereof. The information contained herein is based on information which Prestige Commercial deems reliable. However, Prestige Commercial assumes no responsibility for the degree of accuracy of such information, nor does Prestige Commercial represent or warrant information contained herein. Recipient should conduct their own investigation to determine the accuracy of information contained herein. The information herein is subject to change without notice.

Kimberly Kimball, Senior Associate

403-701-0459

kimberly@kimballcommercialrealestate.com

5824 – 2nd Street SW

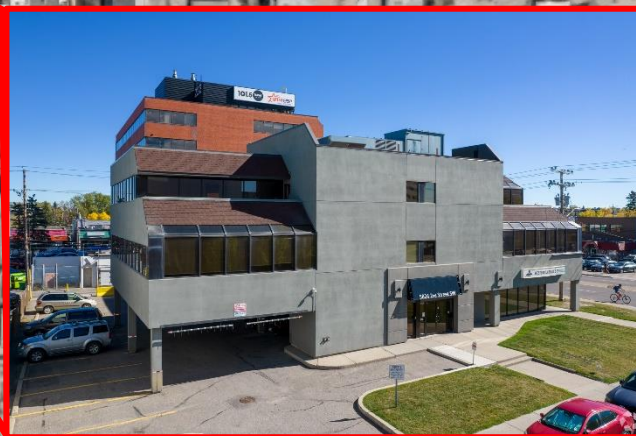
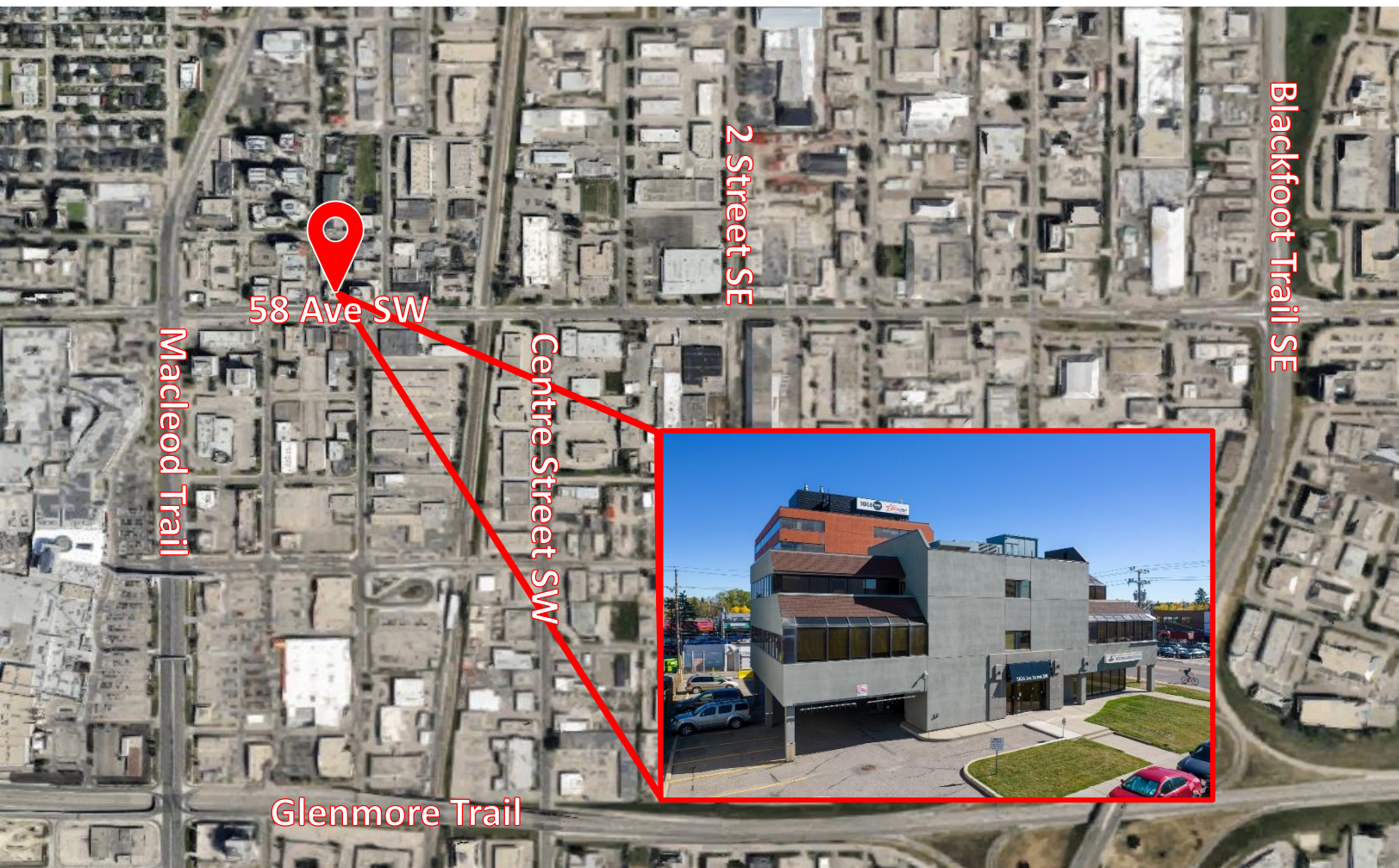

Address:	5824 – 2 nd Street SW
Subdivision:	Manchester
Zoning:	C-O (Commercial Office)
Basement:	1,015± to 2,321± SqFt
2nd Floor:	1,676± SqFt (Suite 230)
3rd Floor:	Up to 3,938± SqFt
Lease Rate:	\$12.00/SqFt (from \$1,676.00/mth)
Operating Cost:	\$14.47/sf (est. 2023) (\$4,748.57/mth) + 5% Management Fee
Term:	5 - 10 Years
Availability:	Immediate
Parking:	- 1:700 SqFt @ \$60/stall - 2-hour street parking in vicinity - Paid parking in area

- Professionally managed building.
- Build to suit opportunities.
- Attractive show suite with a reception, 3 offices and kitchen for the 2nd floor.
- 2 private terraces exclusive to the 3rd floor.
- Abundant of natural light with 58th Avenue (SW) exposure.
- Prominent building signage available.
- 2 blocks from Chinook Centre Mall and LRT Station
- Bus stop on 58th Avenue in front of the building.
- Easy access to Macleod, Glenmore and Deerfoot Trail.
- 10 minutes to downtown.

Kimberly Kimball, Senior Associate

403-701-0459

kimberly@kimballcommercialrealestate.com

5824 – 2nd Street SW

2nd Floor



Kimberly Kimball, Senior Associate

403-701-0459

kimberly@kimballcommercialrealestate.com

5824 – 2nd Street SW

3rd Floor



Kimberly Kimball, Senior Associate

403-701-0459

kimberly@kimballcommercialrealestate.com

5824 – 2nd Street SW

Floor Plan: 2nd Floor

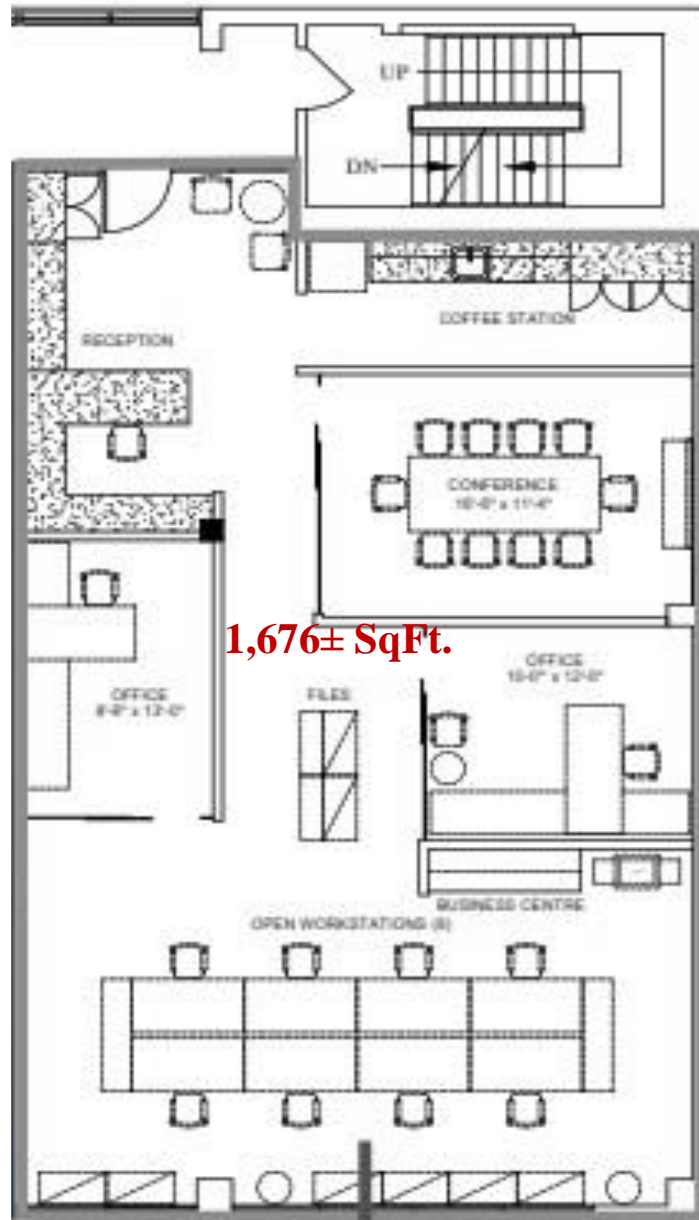

1,676± SqFt.

Show Suite

Floor plans may not be exactly as illustrated and are subject to change.

Kimberly Kimball, Senior Associate

403-701-0459

kimberly@kimballcommercialrealestate.com

5824 – 2nd Street SW

Floor Plan: 3rd Floor

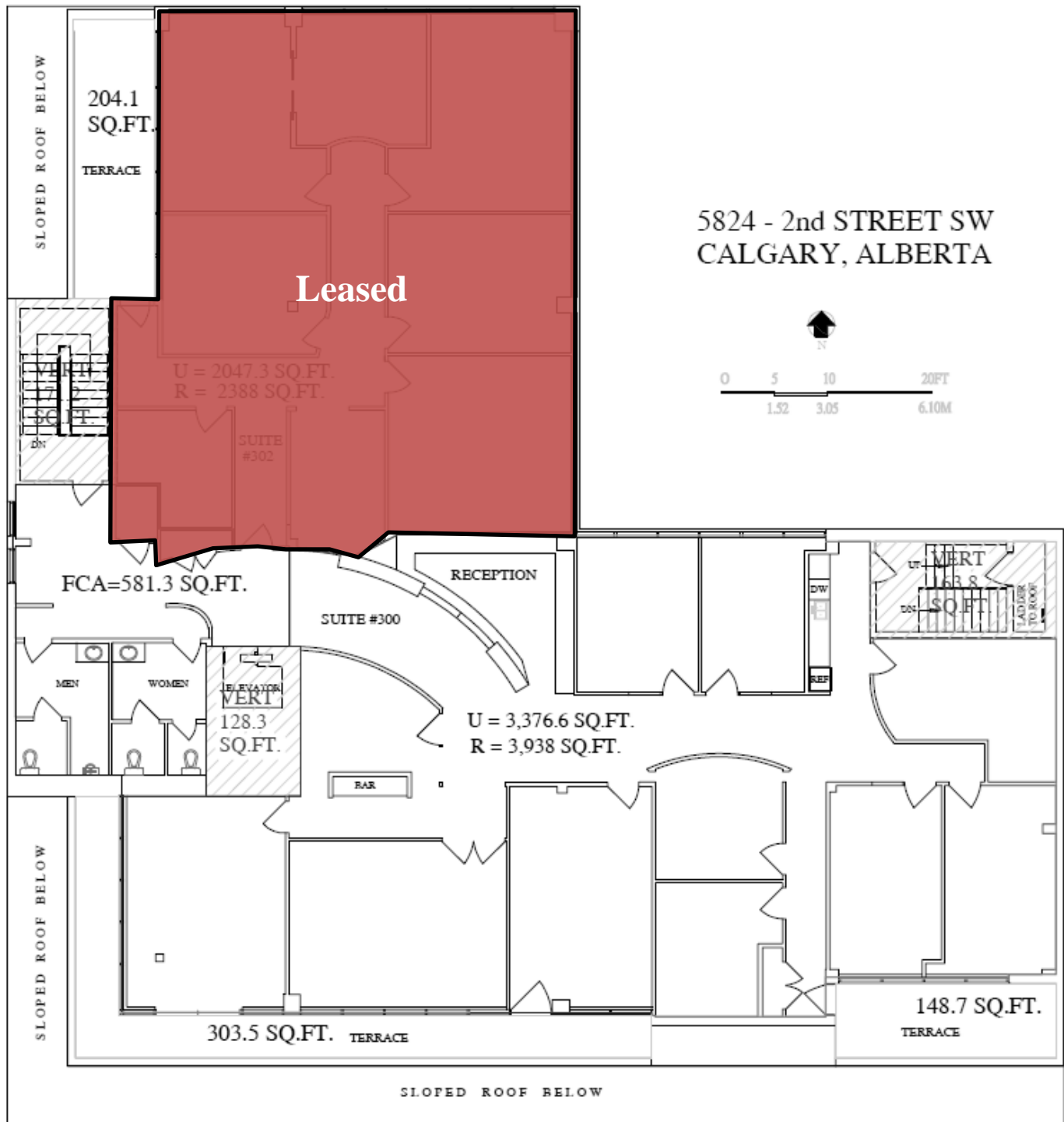

Floor plans may not be exactly as illustrated and are subject to change.

Kimberly Kimball, Senior Associate

403-701-0459

kimberly@kimballcommercialrealestate.com

5824 – 2nd Street SW

Floor Plan: Basement

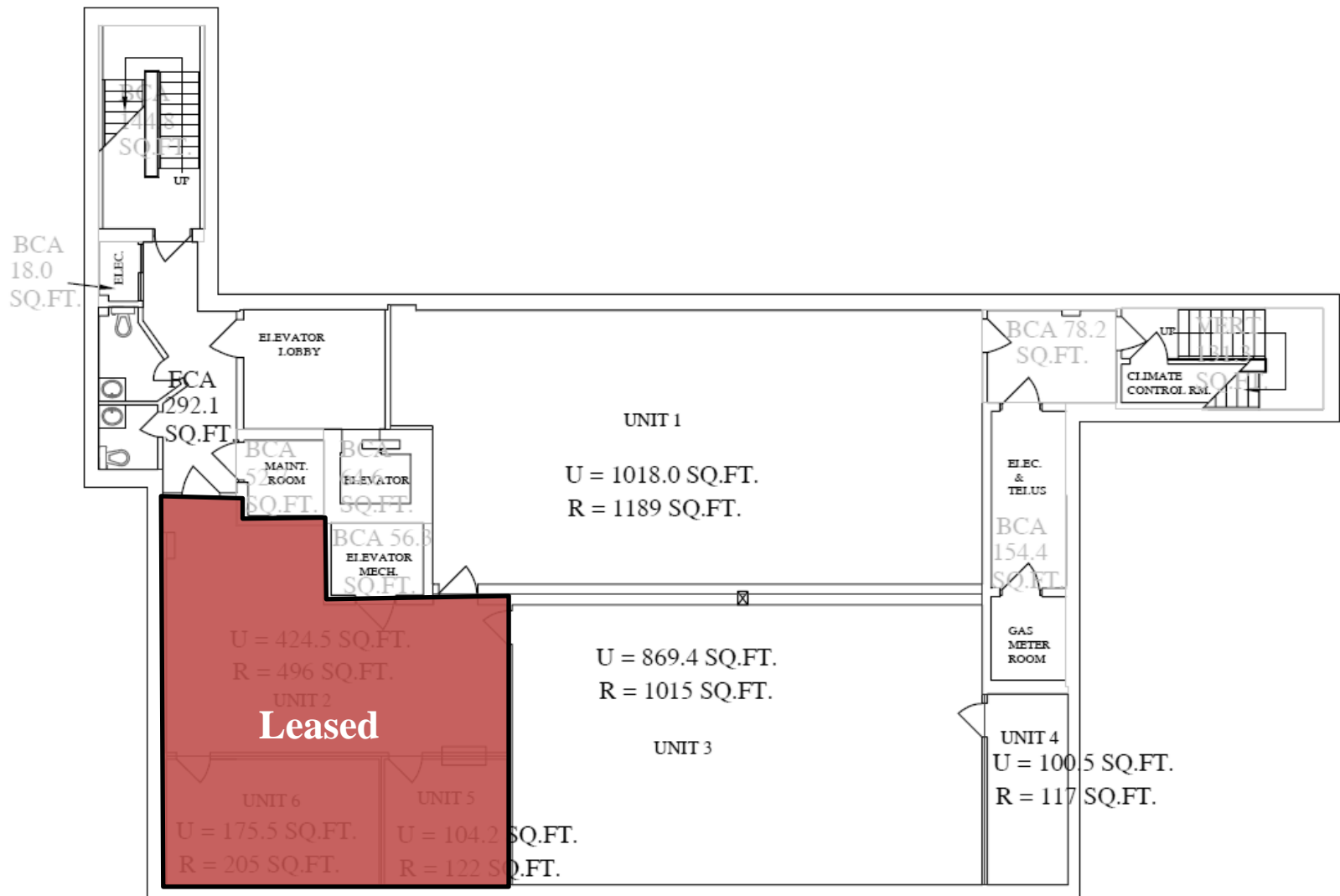

Floor plans may not be exactly as illustrated and are subject to change.

Kimberly Kimball, Senior Associate

403-701-0459

kimberly@kimballcommercialrealestate.com

PRESTIGE COMMERCIAL GROUP

RE/MAX
COMMERCIAL®

RE/MAX
COMMERCIAL®
AUCTIONS



RE/MAX
Complete Realty

11450 – 29th Street SE, Unit 201
Calgary, Alberta T2Z 3V5

This brochure is intended for information purposes only and should not be relied upon for accurate factual information by the recipient hereof. The information contained herein is based on information which Prestige Commercial deems reliable. However, Prestige Commercial assumes no responsibility for the degree of accuracy of such information, nor does Prestige Commercial represent or warrant information contained herein. Recipient should conduct their own investigation to determine the accuracy of information contained herein. The information herein is subject to change without notice.

Kimberly Kimball, Senior Associate

403-701-0459

kimberly@kimballcommercialrealestate.com