

# Office For Lease

## 5824 – 2<sup>nd</sup> Street SW

**PRESTIGE**  
COMMERCIAL GROUP

**RE/MAX**  
COMMERCIAL®



**Rethinking Commercial Real Estate**

**Kimberly Kimball**, Senior Associate

**403-701-0459**

[kimberly@kimballcommercialrealestate.com](mailto:kimberly@kimballcommercialrealestate.com)

# 5824 – 2<sup>nd</sup> Street SW

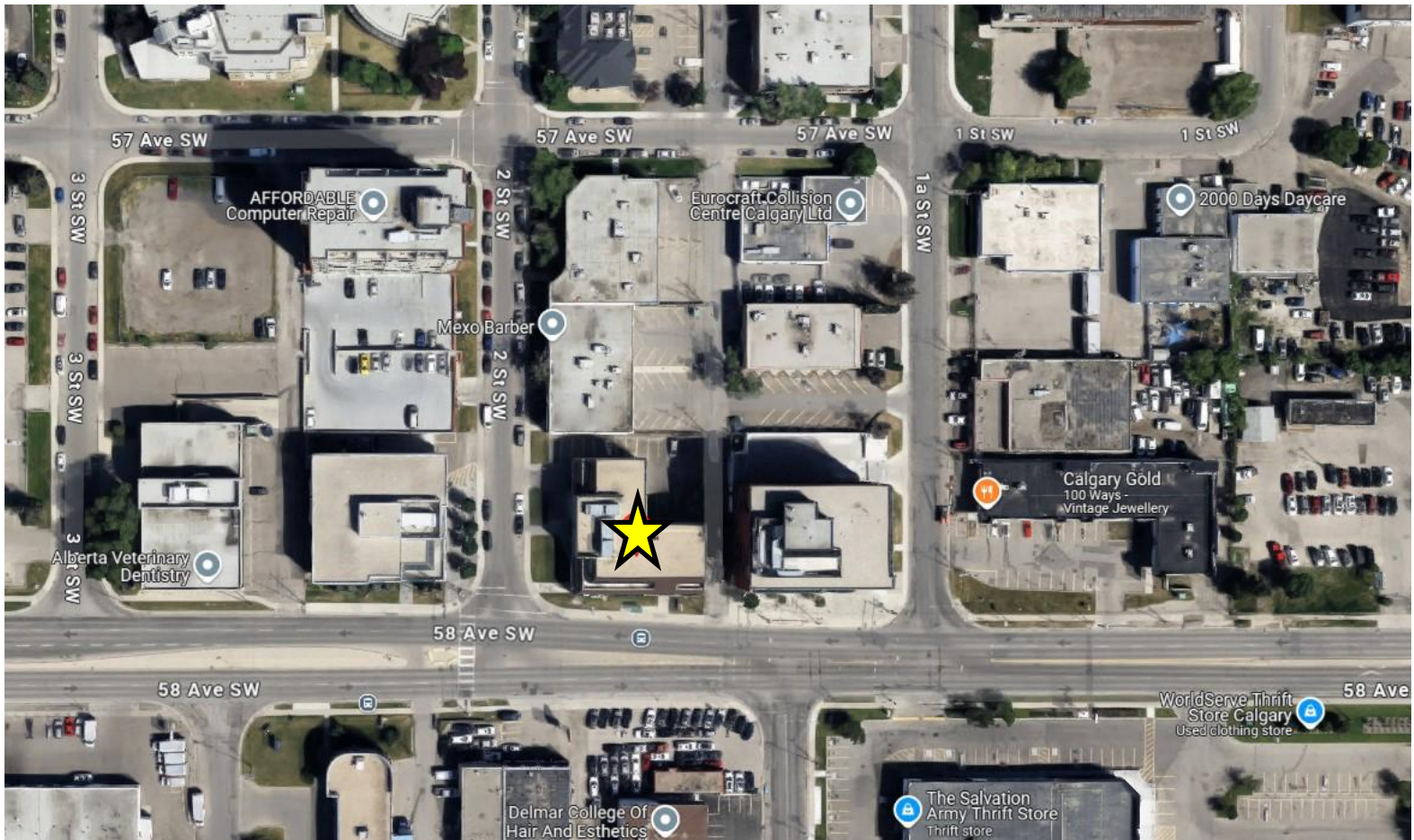

<b>Subdivision:</b>	Manchester
<b>Zoning:</b>	C-O (Commercial Office)
<b>Lower Level:</b>	1,015 to 2,204 Square Feet
<b>2<sup>nd</sup> Floor:</b>	#200 - 1,317 ± Square Feet #210 - 1,606 ± Square Feet #200/#210 – 2,923 ± Square Feet
<b>3<sup>rd</sup> Floor:</b>	LEASED
<b>Lease Rate:</b>	Market
<b>Operating Cost:</b>	\$15.31/Sq Ft/Annum (For 2025)
<b>Term:</b>	3 to 5 Years
<b>Availability:</b>	Immediate
<b>Parking:</b>	1:700 Sq Ft 2-hour street parking in the vicinity

- Professionally managed building with direct exposure to 58th Avenue SW
- 2nd floor space directly across from the elevator, potentially from 1,317 Square Feet or 2,923 Square Feet
- Mix of private and open bullpen areas
- Abundant of natural light
- Assigned parking at reasonable rates, and street parking on 2nd Street
- Lower-level space also available
- Bus stop directly in front of building on 58th Ave.
- 2 blocks from Chinook Centre Mall, LRT Station, and Blackfoot Deerfoot Trail. 5 minutes to downtown and 20 minutes to Calgary Airport

**Kimberly Kimball**, Senior Associate

**403-701-0459**

[kimberly@kimballcommercialrealestate.com](mailto:kimberly@kimballcommercialrealestate.com)

# 5824 – 2<sup>nd</sup> Street SW



Office Area



Office Area



Office Area



Office Area



Office Area



Kitchen

**Kimberly Kimball**, Senior Associate

**403-701-0459**

[kimberly@kimballcommercialrealestate.com](mailto:kimberly@kimballcommercialrealestate.com)

# 5824 – 2<sup>nd</sup> Street SW

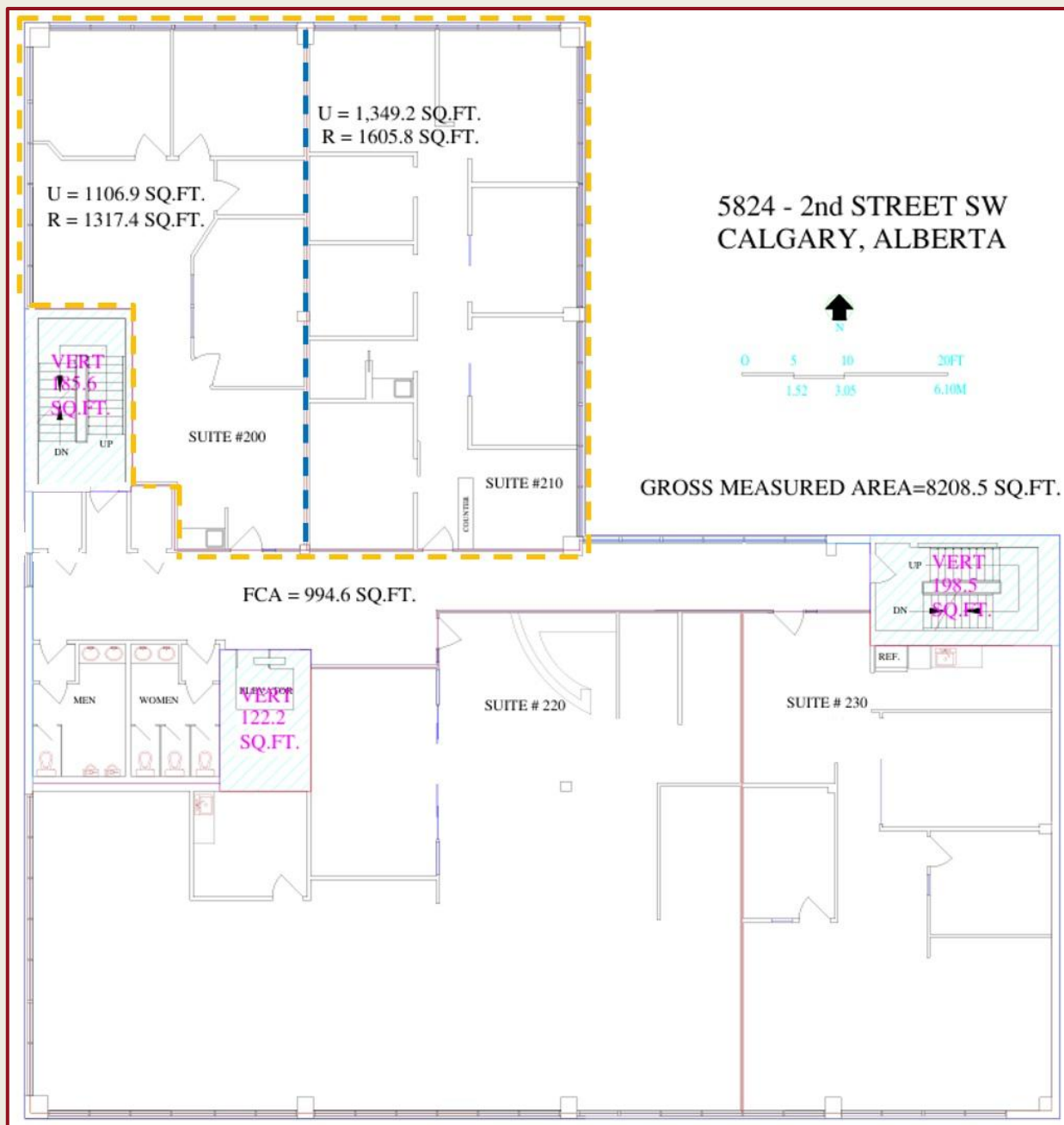

*Floor plans may not be exactly as illustrated and are subject to change.*

**Kimberly Kimball**, Senior Associate

**403-701-0459**

[kimberly@kimballcommercialrealestate.com](mailto:kimberly@kimballcommercialrealestate.com)

# 5824 – 2<sup>nd</sup> Street SW

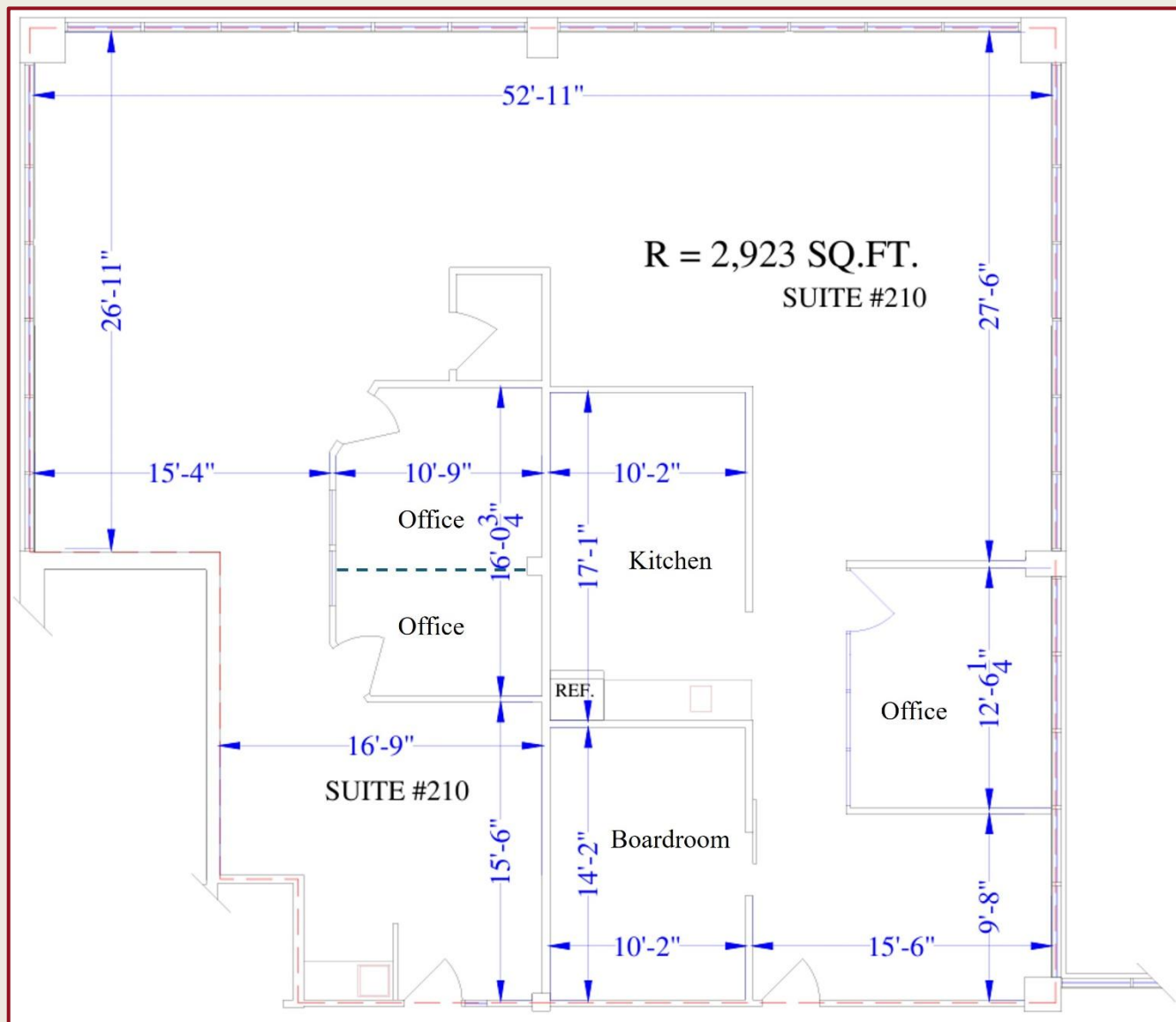

Current Floor Plan

*Floor plans may not be exactly as illustrated and are subject to change.*

**Kimberly Kimball,** Senior Associate

**403-701-0459**

[kimberly@kimballcommercialrealestate.com](mailto:kimberly@kimballcommercialrealestate.com)

# 5824 – 2<sup>nd</sup> Street SW

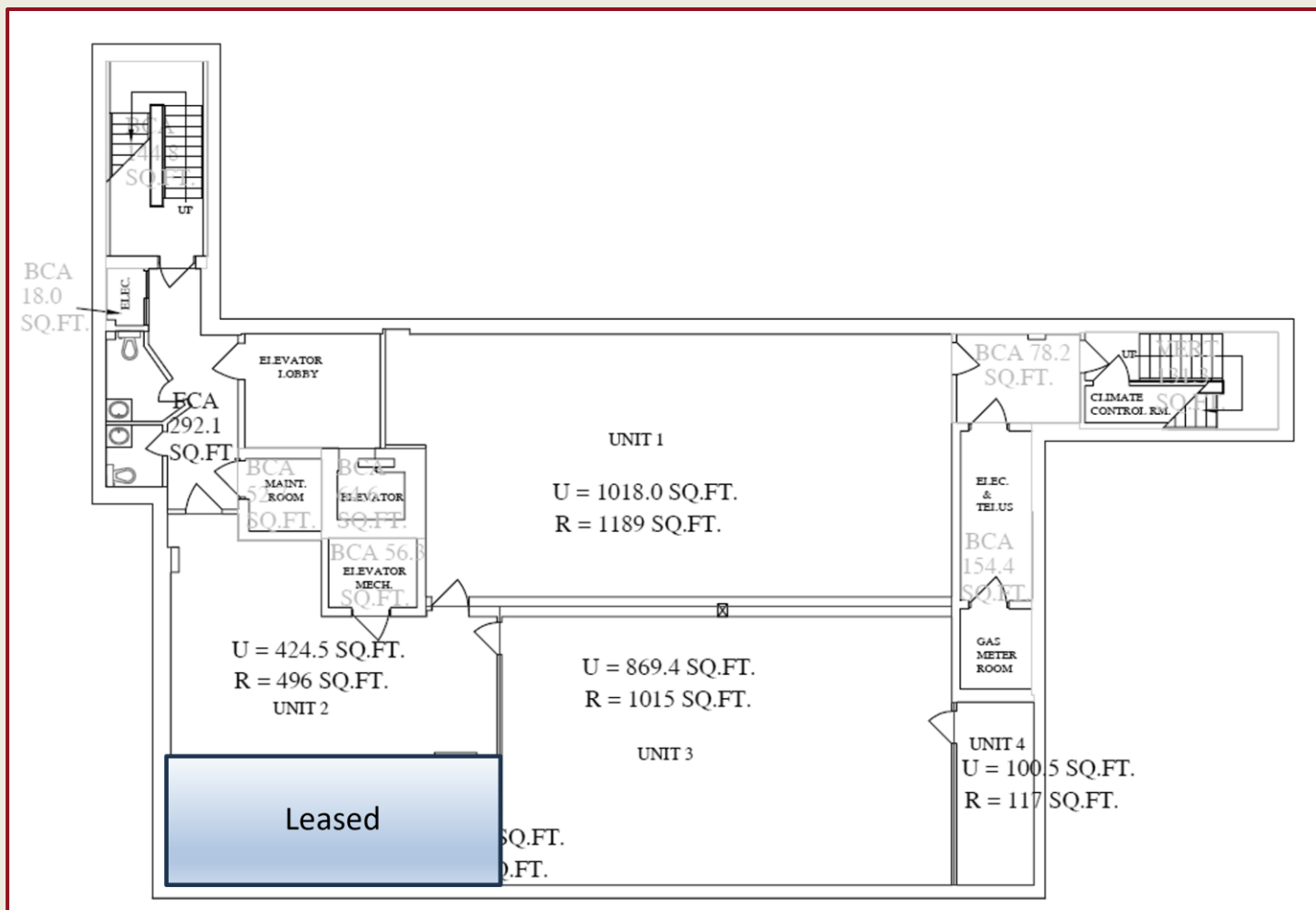

Lower Level

Floor plans may not be exactly as illustrated and are subject to change.

**Kimberly Kimball**, Senior Associate

**403-701-0459**

[kimberly@kimballcommercialrealestate.com](mailto:kimberly@kimballcommercialrealestate.com)

**PRESTIGE**  
COMMERCIAL GROUP

**RE/MAX**  
COMMERCIAL®

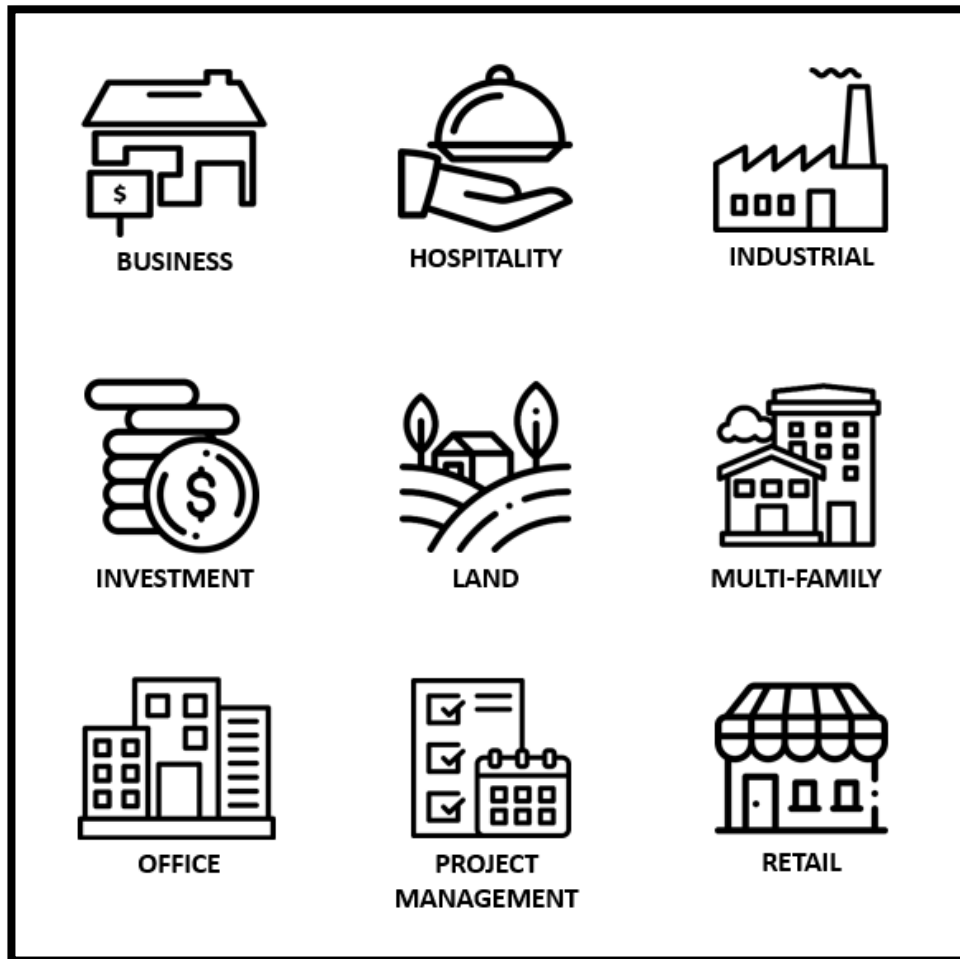

**RE/MAX**  
Complete Realty

**11450 – 29<sup>th</sup> Street SE, Unit 201  
Calgary, Alberta T2Z 3V5**

This brochure is intended for information purposes only and should not be relied upon for accurate factual information by the recipient hereof. The information contained herein is based on information which Prestige Commercial deems reliable. However, Prestige Commercial assumes no responsibility for the degree of accuracy such information, nor does Prestige Commercial represent or warrant information contained herein. Recipient should conduct their own investigation to determine the accuracy of information contained herein. The information herein is subject to change without notice.

**Kimberly Kimball, Senior Associate**

**403-701-0459**

[kimberly@kimballcommercialrealestate.com](mailto:kimberly@kimballcommercialrealestate.com)